

# Customer Information Sheet

DRAWING No.: M22-307XX00

IF IN DOUBT - ASK

(C)

NOT TO SCALE

THIRD ANGLE PROJECTION

ALL DIMENSIONS IN mm

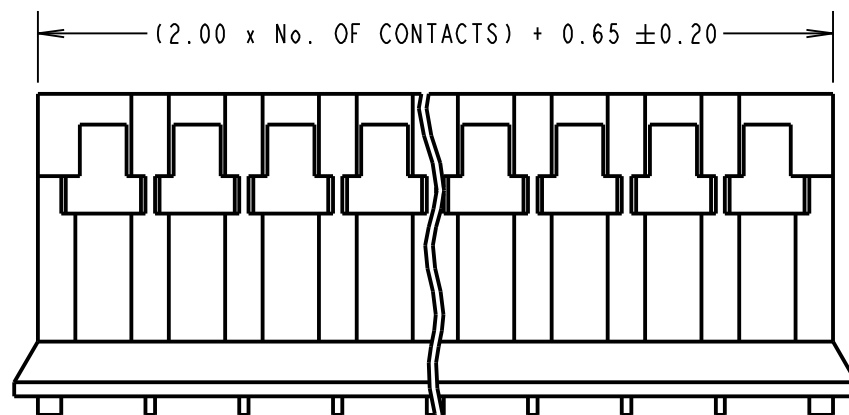
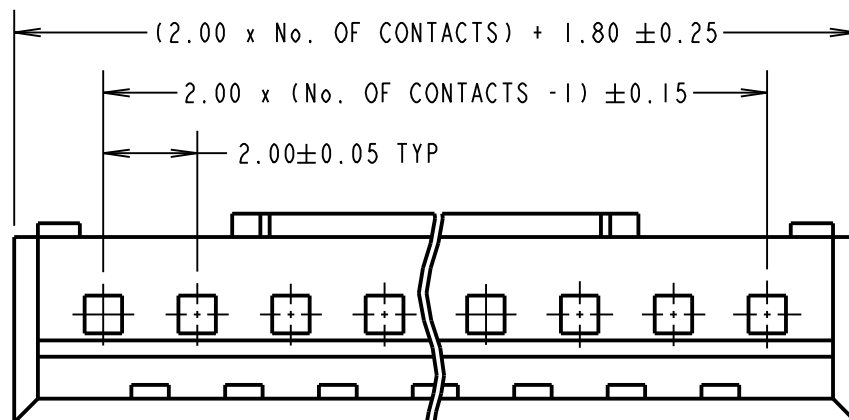

**SPECIFICATION:**

MATERIAL = NYLON 66, UL94V-0, NATURAL  
 ELECTRICAL:  
 VOLTAGE RATING = 100V AC/DC  
 CURRENT RATING = 1A  
 DIELECTRIC WITHSTANDING = 800V AC/MINUTE  
 INSULATION RESISTANCE = 1000MΩ/MINUTE  
 MECHANICAL:  
 INSERTION FORCE = 6.9N MAX  
 DURABILITY = 1 OPERATION  
 ENVIRONMENTAL:  
 TEMPERATURE RANGE = -25°C TO +95°C  
 FOR COMPLETE SPECIFICATION, SEE COMPONENT SPECIFICATION C018XX (LATEST ISSUE).

ORDER CODE:

**M22-307XX00**

No. OF CONTACTS:   
02 TO 10

**NOTES:**

1. THIS MOULDING IS FOR USE WITH M22-30600XX AND M22-30800XX CRIMP TERMINALS.
2. THE ABOVE SPECIFICATIONS APPLY WHEN USED WITH THESE CRIMP TERMINALS.
3. ALL TOLERANCES  $\pm 0.15$  UNLESS OTHERWISE STATED.
4. M22-307XX CONNECTORS ARE NOT DESIGNED TO BE PULLED APART OR SEPARATED EASILY. CONNECTORS ARE IDEAL FOR ONE CYCLE ONLY.

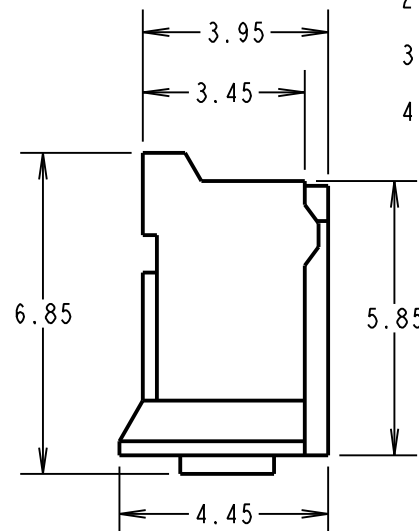

MSP	8	15.06.15	12803
NAME	ISS.	DATE	C/NOTE
APPROVED:		M. PERREN	
CHECKED:		S. BENNETT	
DRAWN:		D. BECK	
CUSTOMER REF.:			
ASSEMBLY DRG:			

**HARWIN**

[www.harwin.com](http://www.harwin.com)  
[technical@harwin.com](mailto:technical@harwin.com)

THIS DRAWING AND ANY INFORMATION OR DESCRIPTIVE MATTER SET OUT HEREON ARE CONFIDENTIAL AND COPYRIGHT PROPERTY OF THE HARWIN GROUP AND MUST NOT BE DISCLOSED, LOANED, COPIED OR USED FOR MANUFACTURING, TENDERING OR FOR ANY OTHER PURPOSE WITHOUT THEIR WRITTEN PERMISSION.

**TOLERANCES**  
~~$X = \pm 1\text{mm}$   
 $X.X = \pm 0.50\text{mm}$   
 $X.XX = \pm 0.10\text{mm}$   
 $X.XXX = \pm 0.01\text{mm}$   
 ANGLES =  $\pm 5^\circ$   
 UNLESS STATED~~

**MATERIAL:**  
 SEE ABOVE  
**FINISH:** CLEAN  
**S/AREA:** mm<sup>2</sup>

**TITLE:** 2mm CRIMP TERMINAL MOULDING  
**DRAWING NUMBER:** M22-307XX00

## X-ON Electronics

Largest Supplier of Electrical and Electronic Components

*Click to view similar products for [Headers & Wire Housings](#) category:*

*Click to view products by [Harwin](#) manufacturer:*

Other Similar products are found below :

[892-18-020-10-001101](#) [58102-G61-06LF](#) [582553-1](#) [0009485154](#) [009176003701906](#) [0050291907](#) [LY20-4P-DT1-P1E-BR](#) [02.125.8002.8](#)  
[609-3404](#) [61062-3](#) [622-0430](#) [622-3653LF](#) [63453-116](#) [636-1030](#) [636-1427](#) [636-3427](#) [636-4007](#) [641938-9](#) [641991-4](#) [644827-2](#) [65817-010LF](#)  
[65817-015LF](#) [65863-015LF](#) [66207-023LF](#) [67095-007LF](#) [67601157](#) [68648-049](#) [70.362.1628.0](#) [70-4210](#) [70-4226B](#) [70-4853B](#) [707-5020](#) [707-](#)  
[5028](#) [71.350.2428.0](#) [71918-208LF](#) [71961-016LF](#) [733-134](#) [733-162](#) [754199-000](#) [760-3052](#) [787-8014-00](#) [79531-3000](#) [FCN-360C032-B](#) [FCN-](#)  
[367T-T012/H](#) [FCN-723D010/2](#) [80.063.4001.1](#) [800-90-001-10-001000](#) [800-90-010-10-002000](#) [801-43-002-10-013000](#) [801-43-006-10-002000](#)