

# Customer Information Sheet

DRAWING No.: M50-20X0005

SHEET 2 OF 2

IF IN DOUBT - ASK

(C)

NOT TO SCALE

THIRD ANGLE PROJECTION

ALL DIMENSIONS IN mm

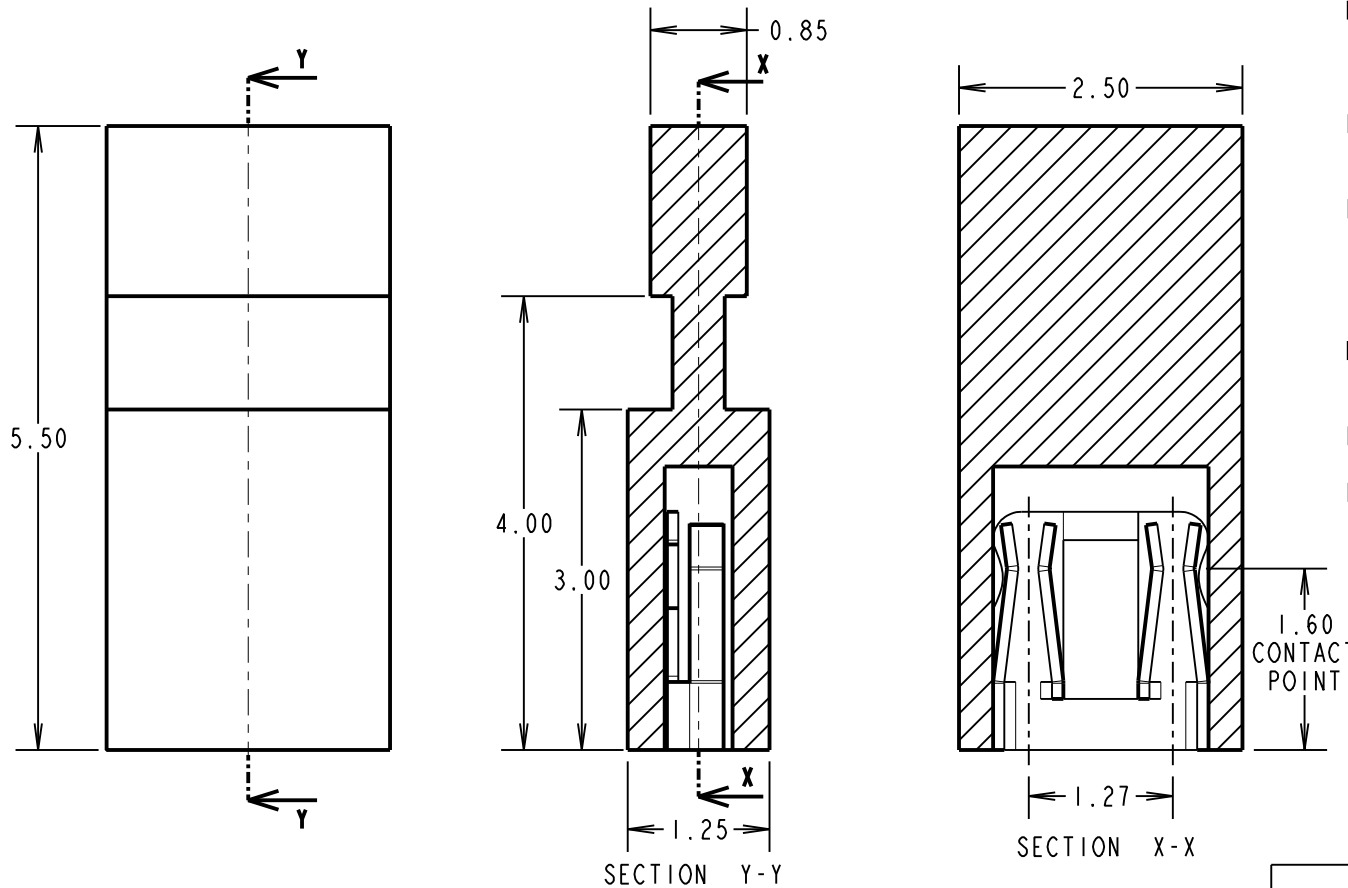

**SPECIFICATION.**

**MATERIAL:**

INSULATOR = PBT, UL94V-0  
FOR COLOUR SEE TABLE

CONTACT = COPPER ALLOY

**FINISH:**

0.025 $\mu$  MIN GOLD FLASH OVER  
0.81 $\mu$  MIN NICKEL

**ELECTRICAL:**

CURRENT RATING = 1 AMP  
INSULATION RESISTANCE = 1000M  $\Omega$  MIN.  
CONTACT RESISTANCE = 20m  $\Omega$  MAX  
DIELECTRIC VOLTAGE = 500V AC FOR ONE MINUTE

**MECHANICAL:**

INSERTION FORCE = 10.0N MAX  
WITHDRAWAL FORCE = 0.6N MIN

**DURABILITY:**

300 OPERATIONS

**ENVIRONMENTAL:**

OPERATING TEMPERATURE = -40°C TO +105°C

NOTES:  
1. ALL TOLERANCES ARE  $\pm 0.12$  UNLESS OTHERWISE STATED.

PART No.	COLOUR
M50-2000005	BLACK
M50-2020005	RED
M50-2030005	BLUE

MSP	3	18.04.17	20396
NAME	ISS.	DATE	C/NOTE
APPROVED:		M. PERREN	
CHECKED:		S. BENNETT	
DRAWN:		R. ADDE	
CUSTOMER REF.:			
ASSEMBLY DRG:			

**HARWIN**

www.harwin.com  
technical@harwin.com

THIS DRAWING AND ANY INFORMATION OR DESCRIPTIVE MATTER SET OUT HEREON ARE CONFIDENTIAL AND COPYRIGHT PROPERTY OF THE HARWIN GROUP AND MUST NOT BE DISCLOSED, LOANED, COPIED OR USED FOR MANUFACTURING, TENDERING OR FOR ANY OTHER PURPOSE WITHOUT THEIR WRITTEN PERMISSION.

~~TOLERANCES~~  
X =  $\pm 1$ mm  
X.X =  $\pm 0.50$ mm  
X.XX =  $\pm 0.10$ mm  
X.XXX =  $\pm 0.01$ mm  
ANGLES =  $\pm 5^\circ$   
UNLESS STATED

MATERIAL:  
SEE ABOVE  
FINISH: SEE ABOVE  
S/AREA: mm<sup>2</sup>

TITLE:  
1.27mm JUMPER SOCKET  
(WITH HANDLE)  
DRAWING NUMBER:  
**M50-20X0005**

SHT  
2 OF 2

## X-ON Electronics

Largest Supplier of Electrical and Electronic Components

*Click to view similar products for [Headers & Wire Housings](#) category:*

*Click to view products by [Harwin](#) manufacturer:*

Other Similar products are found below :

[892-18-020-10-001101](#) [58102-G61-06LF](#) [582553-1](#) [0009485154](#) [009176003701906](#) [0050291907](#) [LY20-4P-DT1-P1E-BR](#) [02.125.8002.8](#)  
[609-3404](#) [61062-3](#) [622-0430](#) [622-3653LF](#) [63453-116](#) [636-1030](#) [636-1427](#) [636-3427](#) [636-4007](#) [641938-9](#) [641991-4](#) [644827-2](#) [65817-010LF](#)  
[65817-015LF](#) [65863-015LF](#) [66207-023LF](#) [67095-007LF](#) [67601157](#) [68648-049](#) [70.362.1628.0](#) [70-4210](#) [70-4226B](#) [70-4853B](#) [707-5020](#) [707-5028](#) [71.350.2428.0](#) [71918-208LF](#) [71961-016LF](#) [733-134](#) [733-162](#) [754199-000](#) [760-3052](#) [787-8014-00](#) [79531-3000](#) [FCN-360C032-B](#) [FCN-367T-T012/H](#) [FCN-723D010/2](#) [80.063.4001.1](#) [800-90-001-10-001000](#) [800-90-010-10-002000](#) [801-43-002-10-013000](#) [801-43-006-10-002000](#)