

Customer Information Sheet

DRAWING No.: P13-XX23

SHEET 2 OF 2

IF IN DOUBT - ASK

(C)

NOT TO SCALE

THIRD ANGLE PROJECTION

ALL DIMENSIONS IN mm

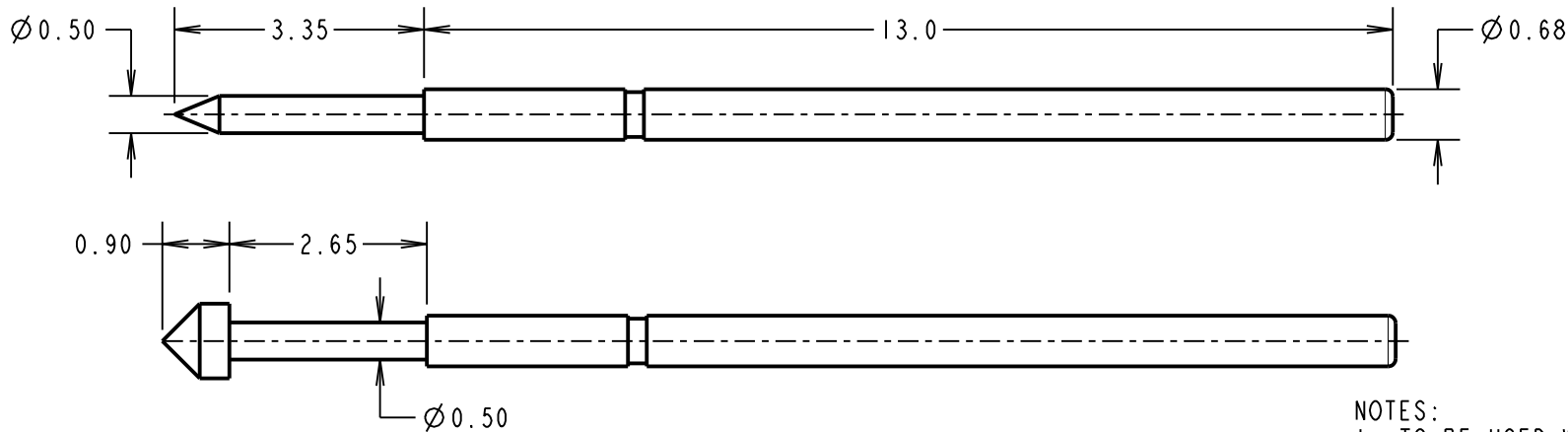

ORDER CODE
P13-XX23
PROBE HEAD
VARIANT (SEE TABLE)

NOTES:

1. TO BE USED WITH SLEEVE S13-503.
2. SUITABLE FOR A MINIMUM DISTANCE BETWEEN CENTRES OF 1.27mm.

SPECIFICATIONS:

MATERIAL:
PLUNGER:

P13-0123 = STEEL
P13-1123, P13-2123 & P13-4023 = BERYLLIUM COPPER

BARREL = PHOSPHOR BRONZE

SPRING:

P13-0123 = MUSIC WIRE
P13-1123, P13-2123 & P13-4023 = STAINLESS STEEL

FINISH:

PLUNGER, BARREL AND SPRING = GOLD

ELECTRICAL:

CURRENT RATING = 1.5A

CONTACT RESISTANCE = 100mΩ MAX AT 2/3 TRAVEL

MECHANICAL:

DURABILITY = 100,000 CYCLES MIN

FULL TRAVEL = 2.65mm

SPRING FORCES:

AT FULL TRAVEL = 1.18N ± 0.24N (120g ± 20%)

AT 2/3 TRAVEL = 0.88N ± 0.18N (90g ± 20%)

ENVIRONMENTAL:

OPERATING TEMPERATURE = -40°C TO +180°C

PROBE HEAD VARIANTS

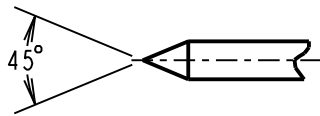

SPEAR HEAD
P13-0123

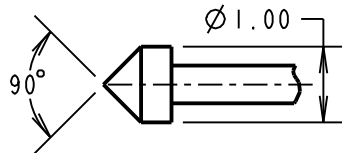

CONVEX HEAD
P13-2123

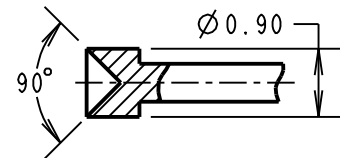

CONCAVE HEAD
P13-1123

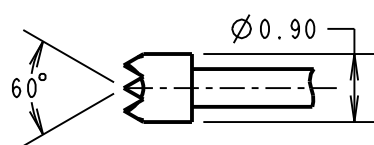

SERRATED HEAD
P13-4023

MSP	7	21.07.17	20124
NAME	ISS.	DATE	C/NOTE
APPROVED:		M. PERREN	
CHECKED:		M. PLESTED	
DRAWN:		W. J. BOURNE	
CUSTOMER REF.:			
ASSEMBLY DRG:			

HARWIN

www.harwin.com
technical@harwin.com

THIS DRAWING AND ANY INFORMATION OR DESCRIPTIVE MATTER SET OUT HEREON ARE CONFIDENTIAL AND COPYRIGHT PROPERTY OF THE HARWIN GROUP AND MUST NOT BE DISCLOSED, LOANED, COPIED OR USED FOR MANUFACTURING, TENDERING OR FOR ANY OTHER PURPOSE WITHOUT THEIR WRITTEN PERMISSION.

TOLERANCES

X. = ±1mm
X.X = ±0.50mm
X.XX = ±0.10mm
X.XXX = ±0.01mm
ANGLES = ±5°
UNLESS STATED

MATERIAL:

SEE ABOVE

FINISH: SEE ABOVE

S/AREA: mm²

TITLE:

1.27mm MIN. CENTRE
TWO-PIECE SPRING PROBE

DRAWING NUMBER:

P13-XX23

SHT
2 OF 2

X-ON Electronics

Largest Supplier of Electrical and Electronic Components

Click to view similar products for [Test Probes](#) category:

Click to view products by [Harwin](#) manufacturer:

Other Similar products are found below :

[6214](#) [6474](#) [815003](#) [923832-BK-B](#) [P-KIT-1](#) [KT-MS001](#) [925250-R](#) [923848-C](#) [973368101](#) [972318101](#) [972318100](#) [MXHQ87WJ3000](#) [PK106-3](#) [PK2-5MM-102](#) [382254](#) [TAS90](#) [VL1735/45](#) [973368100](#) [972327100](#) [972327101](#) [973995100](#) [973995101](#) [CT3982B-120](#) [CT4386](#) [PP023-1](#) [PK1-5MM-125](#) [PK1-5MM-127](#) [PP026-1](#) [PK103](#) [PK-ZS-013](#) [P6139B-PK10](#) [PQ215](#) [PQ219](#) [PQ218](#) [RT-ZI10C](#) [TT-SI 8071](#) [TT-SI 8050](#) [TT-SI 8010A](#) [TT-SI 7005](#) [GE.3421](#) [GE.3121](#) [GE.1511](#) [GE.1521](#) [GE.2511](#) [HVP15B](#) [TT-SI7002](#) [4005](#) [4011](#) [4012](#) [4013](#)