

- NOTES-
1. MATERIAL SEE TABLE;
 2. ELECTRICAL PERFORMANCES:
 - 2-1. RATED CURRENT: 0.3A;
 - 2-2. CONTACT RESISTANCE: 90mΩ Max. with AC 20mV, 1kHz and 1mA;
 - 2-3. INSULATION RESISTANCE: 50mΩ min. With DC 100v;
 3. MECHANICAL PERFORMANCES:
 - 3-1. DURABILITY: 30 CYCLES;
 - 3-2. OPERATION TEMPERATURE: -35°C To +85°C;

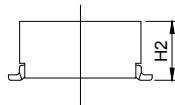
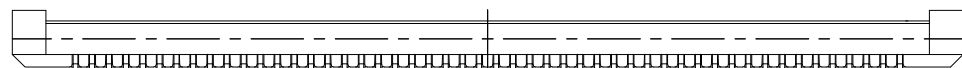

Ass'y High(H)	Plastic High	
	Male (H1)	Female (H2)
1.50	1.14	1.40
2.00	1.14	1.90
2.50	1.14	2.40
3.00	1.14	2.90
3.50	1.14	3.40
4.00	1.14	3.90

Ordering Information

HC-PBB40C - NDS - 0.4V - ** - 02

No.of Pins: 10~120Pin
 Nature: DS=Female
 PITCH: 0.4W=0.4mm
 High (H): 1.5~1.50mm, 2.0~2.00mm, 2.5~2.50mm, 3.0~3.00mm, 3.5~3.50mm, 4.0~4.00mm

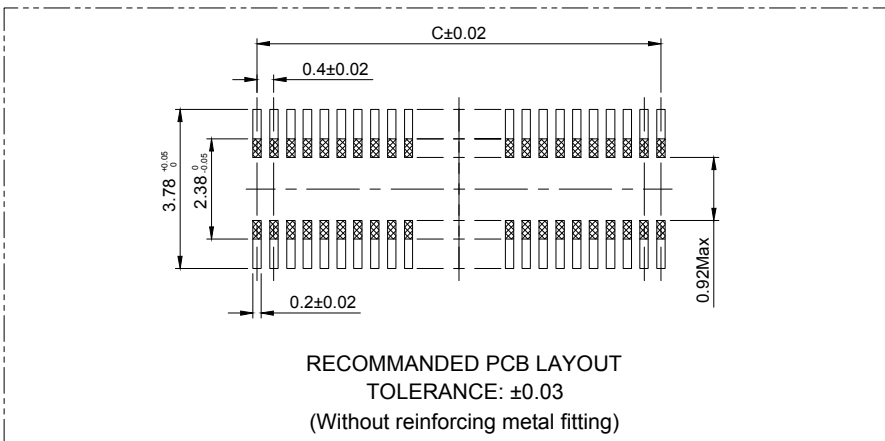

Pin	10	12	20	24	30	34	40	44	50	60	70	80	90	100	120
A	4.60	5.00	6.60	7.40	8.60	9.40	10.60	11.40	12.60	14.60	16.60	18.60	20.60	22.60	26.60
B	-	-	1.93	2.43	3.18	3.68	5.08	5.86	5.50	6.00	7.00	8.00	9.00	10.00	14.00
C	1.60	2.00	3.60	4.40	5.60	6.40	7.60	8.40	9.60	11.60	13.60	15.60	17.60	19.60	23.60
D	1.00	1.00	1.00	1.20	1.50	2.30	3.20	3.20	3.20	3.20	3.20	3.20	3.20	3.20	3.20

2	Housing	1	LCP	Glass:30%	Black
1	Terminal	N	C5240ESH	Ni 50~90u"UNDERPLATING, GOLD FLASH OVER ALL	
ITEM	Part Name	Q'TY	MATERIAL	MATERIAL	REMARK

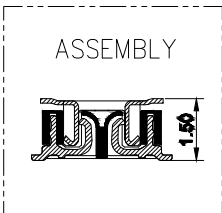

			GENREL TOLERANCE	制 图 DRAWING	深圳市华灿天禄电子有限公司 ShenzhenhuacantianluELECTRONICS CO., LTD			
			DIM TOL	审 核 CHECK	产品名称 TITLE	0.4 双槽 贴片 母座 (BTB)	版 本 REV.	A
			X.X ±0.30	批 准 APPROVAL	产品料号 PART NO.	HC-PBB40C=NDS-0.4V-XX-02	单 位 UNITS	mm
1	初版发行		X.XX ±0.20	比 例 SCALE	材 料 MATERIAL		页 次 SHEET	1/1
序号 No.	变更内容 MODIFY CONTENT	日期 MODIFY DATE	X.XXX ±0.10	投 影 Projection				
			Angle ±3.0°					

X-ON Electronics

Largest Supplier of Electrical and Electronic Components

Click to view similar products for [Board to Board & Mezzanine Connectors](#) category:

Click to view products by [HCTL](#) manufacturer:

Other Similar products are found below :

[589158040000018](#) [MDF7C-18P-2.54DSA\(55\)](#) [FCN-268F036-G/BD](#) [FCN-268M012-G/0D](#) [FCN-268M024-G/1D](#) [MIS-048-01-F-D-DP-K](#)
[832-10-034-10-001000](#) [FX4C-80S-1.27DSA](#) [93696-330](#) [224393](#) [FCN-235D050-G/C](#) [210-93-314-41-105000](#) [MDF7-40DP-2.54DSA\(55\)](#)
[MIT-114-03-F-D-K](#) [55323-1519](#) [026-6203-PDB](#) [027-6203-PDB](#) [069159702701000](#) [101A10019X](#) [105061100000861+](#) [55650-0588-C](#) [75140-](#)
[7012](#) [87471-650](#) [YTW-30-07-H-Q-410-140](#) [YTT-112-01-H-Q](#) [063209](#) [10124054-515LF](#) [68685-603](#) [8-1616154-3](#) [MIS-019-01-F-D](#) [YTQ-](#)
[12103HQ](#) [541371078](#) [IL-WX-10PB-HF-B-E1000E](#) [FCN-214J100-G/0](#) [FCN-230C068-E/S](#) [354184](#) [MIT-019-04-F-D-K](#) [P50-028-DDS-TG](#)
[53309-2471](#) [54546-2071](#) [1586617-1](#) [504208-3010](#) [504208-5010](#) [504248-1010](#) [504248-1210](#) [504248-2010](#) [LST-115-07-S-D](#) [LST-105-07-G-](#)
[D](#) [9159005551906](#) [NDS100-004-BF](#)