

Recommended P.C.B Layout(Top Side)  
(PCB BOARD TOLERANCE± 0.05)

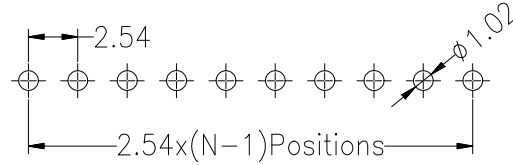
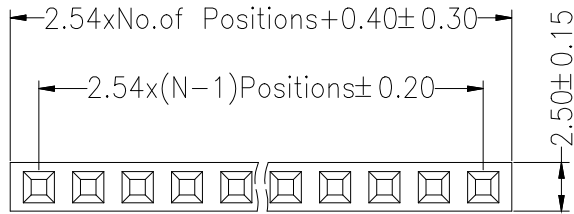

SPECIFICATIONS  
 Rated Current:3.0AMP  
 Contact Resistance:20mΩMax  
 Withstand Voltage:1000V AC/DC  
 Insulation Resistance:1000MΩMin  
 Operation Temperature:-40°c to +105°c

Contact Material:Copper Alloy  
 Contact Plating:Au or Sn Over Ni  
 Insulator Material:Polyester(UL94V-0)  
 Standard: PA6T  
 Max.Processing Temp: 260°C±5°C 5S

Pitch	塑高 (mm)
2.54mm	3.4
	3.5
	5.0
	5.7
	5.9
	6.8
	7.1
	8.0
	8.5
	11.0
13.5	

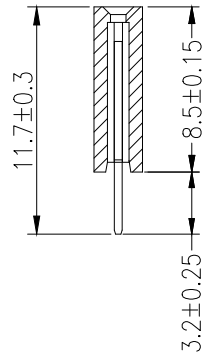
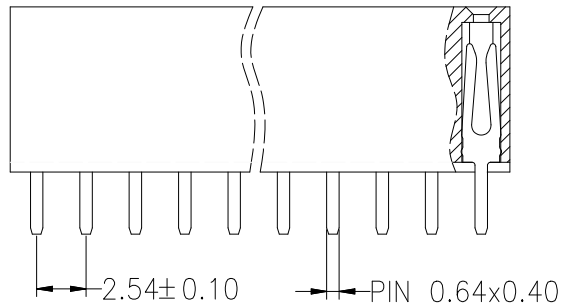

**Ordering Information**

PM 254 - \* - N - \* - \* - \*\*

No. of Rows  
 1=Single Row  
 2=Dual Row

No. of Pins  
 2-40Pin

Type  
 2=直针  
 3=弯针  
 4=立脚  
 5=穿脚  
 6=反穿

Length (mm)  
 00:Gold Flash  
 G1:1u" Gold  
 G2:2.5u" Gold  
 G3:5u" Gold  
 G4:10u" Gold  
 G5:15u" Gold  
 G6:30u" Gold  
 S0:Gold Flash/Tin  
 S1:Tin

			GENERAL TOLERANCE		制图 DRAWING		深圳市华灿天禄电子有限公司 ShenzhenhuacantianluELECTRONICS CO., LTD			
			DIM	TOL	审核 CHECK		产品名称 TITLE	2.54 单排 排母 直针 塑高8.5	版本 REV.	A
			X.X	±0.30	批准 APPROVAL		产品料号 PART NO.	PM254-1-N-Z-8.5-XX(L11.7)	单位 UNITS	mm
			X.XX	±0.20	比例 SCALE				页次 SHEET	1/1
			X.XXX	±0.10	投影 Projection		材料 MATERIAL			
序号 No.	变更内容 MODIFY CONTENT	日期 MODIFY DATE	Angle	±3.0°						

## X-ON Electronics

Largest Supplier of Electrical and Electronic Components

*Click to view similar products for [Headers & Wire Housings](#) category:*

*Click to view products by [HCTL](#) manufacturer:*

Other Similar products are found below :

[57102-F02-18ULF](#) [58102-G61-06LF](#) [582553-1](#) [009176003701906](#) [01.001.5753.1](#) [0050291907](#) [02.125.8002.8](#) [609-3404](#) [61062-3](#)  
[CSU011177004](#) [622-0430](#) [622-3653LF](#) [63453-116](#) [636-1030](#) [636-1427](#) [636-3427](#) [636-4007](#) [641938-9](#) [644827-2](#) [65495-038](#) [65692-001LF](#)  
[65781-018](#) [65781-047](#) [65817-010LF](#) [65817-015LF](#) [66207-023LF](#) [67095-007LF](#) [67601157](#) [68631-112](#) [68645-018](#) [699319-000](#)  
[M90C108951C](#) [70.362.1628.0](#) [70-4210](#) [70-4226B](#) [70-4853B](#) [707-5028](#) [71.350.2428.0](#) [71961-016LF](#) [733-134](#) [733-162](#) [754199-000](#) [760-](#)  
[3052](#) [80.063.4001.1](#) [800-90-001-10-001000](#) [800-90-010-10-002000](#) [801-43-002-10-013000](#) [801-43-006-10-002000](#) [803-41-018-10-001000](#)  
[803-43-024-10-001000](#)