

| 修 订 | 标 记 | 修 改 描 要              | 签 名       | 日 期        |
|-----|-----|----------------------|-----------|------------|
| REV | NO  | REVISION DESCRIPTION | SIGNATURE | DATE       |
|     |     | NEW DRG              |           | 2016-03-12 |

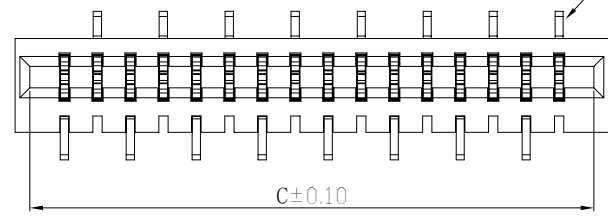
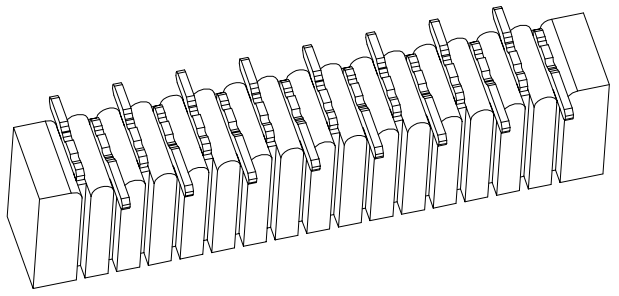

定义正脚位

性能：  
 额定电流：0.5A  
 额定电压：50V  
 耐电压：500V  
 接触电阻：30mΩ  
 绝缘电阻：800MΩ  
 工作温度：-20℃~+85℃

塑件（材质）：LCP BLACK, UL94V-0  
 插簧（材质）：磷青铜, 镀锡/镀金

| 孔位 | A     | B     | C     |
|----|-------|-------|-------|
| 4  | 6.00  | 3.00  | 5.10  |
| 5  | 7.00  | 4.00  | 6.10  |
| 6  | 8.00  | 5.00  | 7.10  |
| 7  | 9.00  | 6.00  | 8.10  |
| 8  | 10.00 | 7.00  | 9.10  |
| 9  | 11.00 | 8.00  | 10.10 |
| 10 | 12.00 | 9.00  | 11.10 |
| 11 | 13.00 | 10.00 | 12.10 |
| 12 | 14.00 | 11.00 | 13.10 |
| 13 | 15.00 | 12.00 | 14.10 |
| 14 | 16.00 | 13.00 | 15.10 |
| 15 | 17.00 | 14.00 | 16.10 |
| 16 | 18.00 | 15.00 | 17.10 |
| 17 | 19.00 | 16.00 | 18.10 |
| 18 | 20.00 | 17.00 | 19.10 |
| 19 | 21.00 | 18.00 | 20.10 |
| 20 | 22.00 | 19.00 | 21.10 |
| 21 | 23.00 | 20.00 | 22.10 |
| 22 | 24.00 | 21.00 | 23.10 |
| 23 | 25.00 | 22.00 | 24.10 |
| 24 | 26.00 | 23.00 | 25.10 |
| 25 | 27.00 | 24.00 | 26.10 |
| 26 | 28.00 | 25.00 | 27.10 |
| 27 | 29.00 | 26.00 | 28.10 |
| 28 | 30.00 | 27.00 | 29.10 |
| 29 | 31.00 | 28.00 | 30.10 |
| 30 | 32.00 | 29.00 | 31.10 |
| 31 | 33.00 | 30.00 | 32.10 |
| 32 | 34.00 | 31.00 | 33.10 |
| 33 | 35.00 | 32.00 | 34.10 |
| 34 | 36.00 | 33.00 | 35.10 |
| 35 | 37.00 | 34.00 | 36.10 |

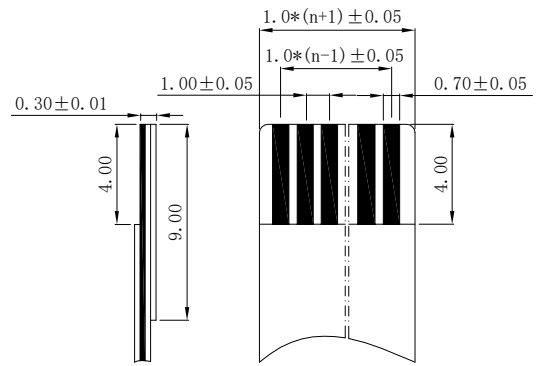
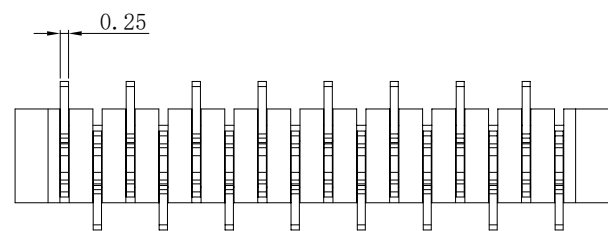
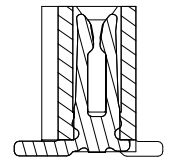
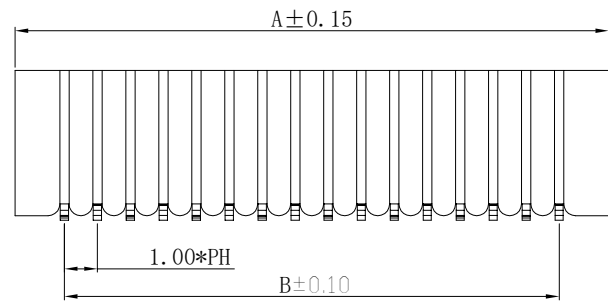
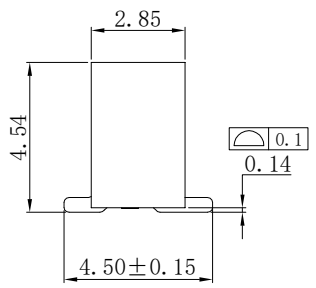

适用扁平电缆

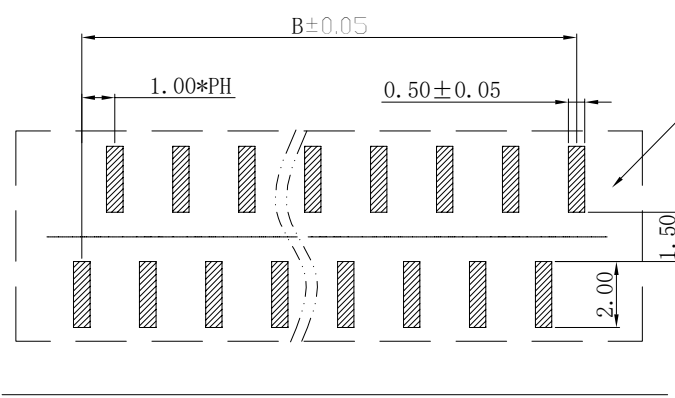

正脚基准

PCB LAYOUT



**深圳市华德共创科技有限公司**  
 Shenzhen Huade co-create Technology Co.,LTD  
 电话：0755-23304126 传真：0755-29940187

| -TOLERANCES-<br>UNLESS OTHERWISE SPECIFIED<br>公差参数表 |       |   |     | TITLE:<br>产品名称：1.0mm FPC(双面接) 立贴正脚 |                            |       |      |             |
|---|-------|---|-----|------------------------------------|----------------------------|-------|------|-------------|
| X.X   | ±0.30 | X.X*  | ±3° | APPD:<br>核准:                       | PART NO:<br>产品编号：1.0-B-nPB |       |      |             |
| X.XX  | ±0.20 | X.XX*   | ±2° | CHECK:<br>校对: 王建业                  | DATE                       | SCALE | UNIT | CODE NUMBER |
| X.XXX   | ±0.10 | X.XXX*  | ±1° | DRAW:<br>绘图: 黄艳兰                   | 2014-03-16                 | 1:1   | mm   | A001        |

## X-ON Electronics

Largest Supplier of Electrical and Electronic Components

*Click to view similar products for [FFC & FPC Connectors](#) category:*

*Click to view products by [HDGC](#) manufacturer:*

Other Similar products are found below :

[00-6200-227-022-800](#) [006205250500825+](#) [006205280500825+](#) [FPH-1602G](#) [086222026001800](#) [52610-0675](#) [62674-201121DLF](#) [52746-1671-TR250](#) [10051922-1610EHLF](#) [10051922-2810EHLF](#) [686322124422](#) [XF3M-2915-1B-R100](#) [AYF353125A](#) [AYF530665TA](#) [AYF534065TA](#) [20FLH-RSM1-TB](#) [PCA-7F-25-HL-3-G](#) [207356-1](#) [52807-0430](#) [FFC05011-10SBB114W5M](#) [502250-8027](#) [FH28K-40S-0.5SH](#) [200528-0260](#) [FH28K-10S-0.5SH](#) [501951-1250](#) [X05B20U43T](#) [0.5K-DX-30PWB](#) [DS1020-08-10VBT12](#) [THD0515-34CL-GF](#) [X05A10L28G](#) [ECC2841061EU](#) [20539-030E-01](#) [1.0K-DHQX-16PWB](#) [1.0K-DHQX-30PWB](#) [1775333-6](#) [10054365-202110ELF](#) [10054365-242110ELF](#) [10054365-282110ELF](#) [10064555-392220HLF](#) [59453-041110EBHLF](#) [59453-091110EDHLF](#) [62674-241141ALF](#) [62684-432100ALF](#) [62684-451100AHLF](#) [62684-5721N0ALF](#) [HFW11R-1STE1MTLF](#) [HFW12R-1STE9LF](#) [HFW14R-1STE9MTLF](#) [HFW18S-2STE9LF](#) [HFW20R-1STAE1HLF](#)