

| 修订 | 标记 | 修改摘要 | 签名 | 日期 |
|-----|----|----------------------|-----------|------------|
| REV | NO | REVISION DESCRIPTION | SIGNATURE | DATE |
| | | NEW DRG | | 2016-03-12 |

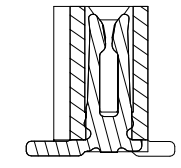
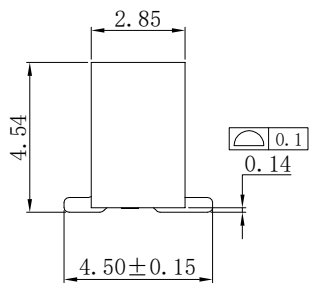
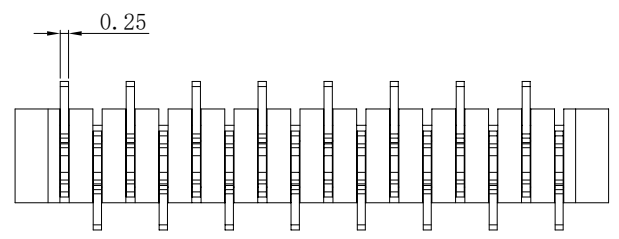
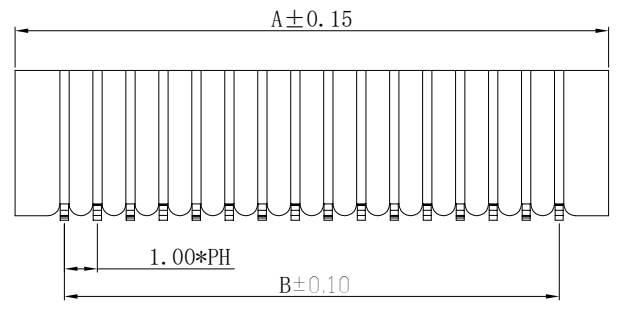

性能:
 额定电流: 0.5A
 额定电压: 50V
 耐电压: 500V
 接触电阻: 30mΩ
 绝缘电阻: 800MΩ
 工作温度: -20℃~+85℃

塑件(材质): LCP BLACK, UL94V-0
 插簧(材质): 磷青铜, 镀锡/镀金

| 孔位 | A | B | C |
|----|-------|-------|-------|
| 4 | 6.00 | 3.00 | 5.10 |
| 5 | 7.00 | 4.00 | 6.10 |
| 6 | 8.00 | 5.00 | 7.10 |
| 7 | 9.00 | 6.00 | 8.10 |
| 8 | 10.00 | 7.00 | 9.10 |
| 9 | 11.00 | 8.00 | 10.10 |
| 10 | 12.00 | 9.00 | 11.10 |
| 11 | 13.00 | 10.00 | 12.10 |
| 12 | 14.00 | 11.00 | 13.10 |
| 13 | 15.00 | 12.00 | 14.10 |
| 14 | 16.00 | 13.00 | 15.10 |
| 15 | 17.00 | 14.00 | 16.10 |
| 16 | 18.00 | 15.00 | 17.10 |
| 17 | 19.00 | 16.00 | 18.10 |
| 18 | 20.00 | 17.00 | 19.10 |
| 19 | 21.00 | 18.00 | 20.10 |
| 20 | 22.00 | 19.00 | 21.10 |
| 21 | 23.00 | 20.00 | 22.10 |
| 22 | 24.00 | 21.00 | 23.10 |
| 23 | 25.00 | 22.00 | 24.10 |
| 24 | 26.00 | 23.00 | 25.10 |
| 25 | 27.00 | 24.00 | 26.10 |
| 26 | 28.00 | 25.00 | 27.10 |
| 27 | 29.00 | 26.00 | 28.10 |
| 28 | 30.00 | 27.00 | 29.10 |
| 29 | 31.00 | 28.00 | 30.10 |
| 30 | 32.00 | 29.00 | 31.10 |
| 31 | 33.00 | 30.00 | 32.10 |
| 32 | 34.00 | 31.00 | 33.10 |
| 33 | 35.00 | 32.00 | 34.10 |
| 34 | 36.00 | 33.00 | 35.10 |
| 35 | 37.00 | 34.00 | 36.10 |

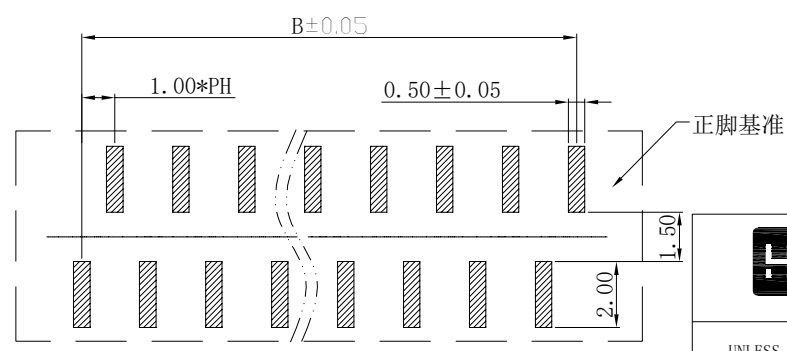

PCB LAYOUT

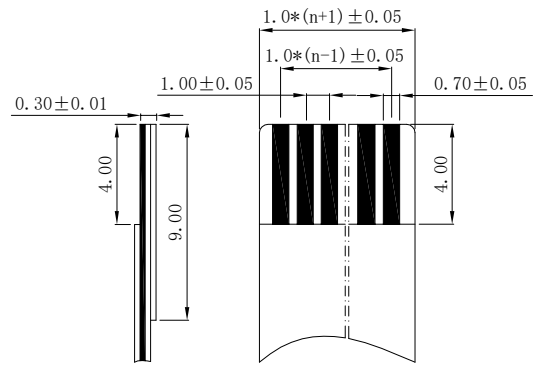

适用扁平电缆



深圳市华德共创科技有限公司
 Shenzhen Huade co-create Technology Co.,LTD
 电话: 0755-23304126 传真: 0755-29940187

| -TOLERANCES- UNLESS OTHERWISE SPECIFIED 公差参数表 | | TITLE: 产品名称: 1.0mm FPC(双面接) 立贴正脚 | |
|---|------------|-------------------------------------|------------------------------|
| X.X ±0.30 | X.X* ±3° | APPD: 核准: | PART NO: 产品编号: 1.0-B-nPBG |
| X.XX ±0.20 | X.XX* ±2° | CHECK: 校对: 王建业 | DATE SCALE UNIT CODE NUMBER |
| X.XXX ±0.10 | X.XXX* ±1° | DRAW: 绘图: 黄艳兰 | 2014-03-16 1:1 mm A001 |

X-ON Electronics

Largest Supplier of Electrical and Electronic Components

Click to view similar products for [FFC & FPC Connectors](#) category:

Click to view products by [HDGC](#) manufacturer:

Other Similar products are found below :

[00-6200-227-022-800](#) [006205250500825+](#) [006205280500825+](#) [FPH-1602G](#) [086222026001800](#) [52610-0675](#) [62674-201121DLF](#) [52746-1671-TR250](#) [10051922-1610EHLF](#) [10051922-2810EHLF](#) [686322124422](#) [XF3M-2915-1B-R100](#) [AYF353125A](#) [AYF530665TA](#) [AYF534065TA](#) [20FLH-RSM1-TB](#) [207356-1](#) [SFW12R-5STE9LF](#) [SFW18R-1STAE9LF](#) [SFW4R-5STE9LF](#) [52807-0430](#) [046283021002868+](#) [FFC05011-10SBB114W5M](#) [502250-8027](#) [67000-008LF](#) [200528-0260](#) [FH28K-10S-0.5SH](#) [FH52K-6S-0.5SH](#) [0.5K-DX-30PWB](#) [DS1020-08-10VBT12](#) [THD0515-34CL-GF](#) [X05A10L28G](#) [ECC2841061EU](#) [1.0K-DHQX-16PWB](#) [1.0K-DHQX-30PWB](#) [1775333-6](#) [10054365-202110ELF](#) [10054365-242110ELF](#) [10054365-282110ELF](#) [10064555-392220HLF](#) [59453-041110EBHLF](#) [59453-091110EDHLF](#) [62674-241141ALF](#) [62684-432100ALF](#) [62684-451100AHLF](#) [62684-5721N0ALF](#) [HFW11R-1STE1MTLF](#) [HFW12R-1STE9LF](#) [HFW14R-1STE9MTLF](#) [HFW18S-2STE9LF](#)