

A B C D E F

修 订 REV NO	标 记 MARK	修 改 描 要 REVISION DESCRIPTION	签 名 SIGNATURE	日 期 DATE
		NEW DWG		2016-03-12

**SPECIFICATIONS**

Current Rating: 3Amps  
 Insulator resistance: 5000 Megohms min.  
 Dielectric Withstanding: AC 500V  
 Operating Temperature: -40°C TO +105°C  
 Insulator Material: PA6T  
 Contact Material: Brass  
 Plating: Gold flash  
 UNSPECIFIED TOLERANCE: ±0.20

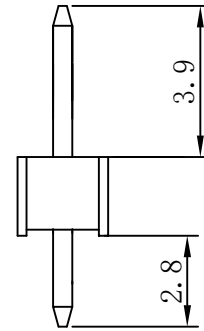
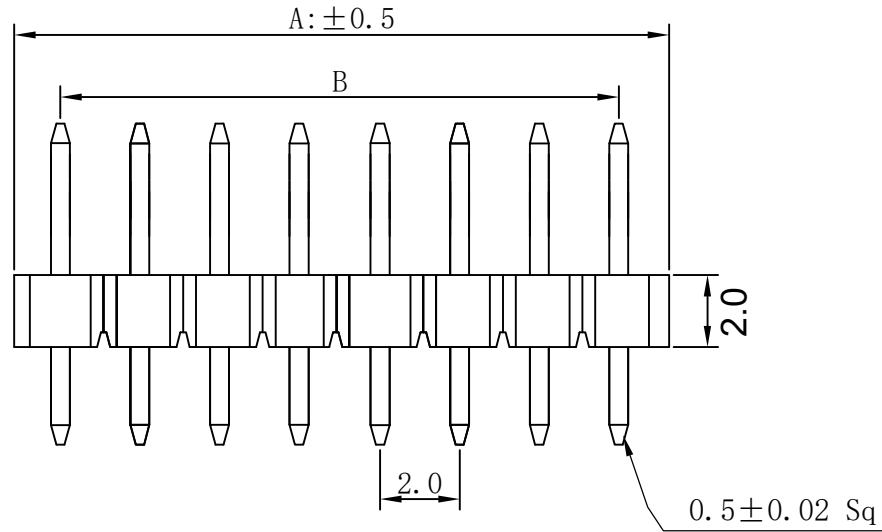
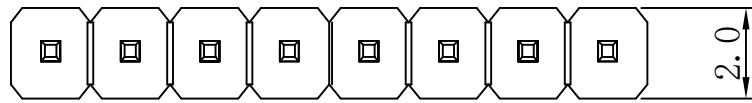

**Dimensions list**

Contacts Per row	Dimensions		Contacts Per row	Dimensions	
	A	B		A	B
2*1	2.0	0	21	42.0	40.0
2	4.0	2.0	22	44.0	42.0
3	6.0	4.0	23	46.0	44.0
4	8.0	6.0	24	48.0	46.0
5	10.0	8.0	25	50.0	48.0
6	12.0	10.0	26	52.0	50.0
7	14.0	12.0	27	54.0	52.0
8	16.0	14.0	28	56.0	54.0
9	18.0	16.0	29	58.0	56.0
10	20.0	18.0	30	60.0	58.0
11	22.0	20.0	31	62.0	60.0
12	24.0	22.0	32	64.0	62.0
13	26.0	24.0	33	66.0	64.0
14	28.0	26.0	34	68.0	66.0
15	30.0	28.0	35	70.0	68.0
16	32.0	30.0	36	72.0	70.0
17	34.0	32.0	37	74.0	72.0
18	36.0	34.0	38	76.0	74.0
19	38.0	36.0	39	78.0	76.0
20	40.0	38.0	40	80.0	78.0

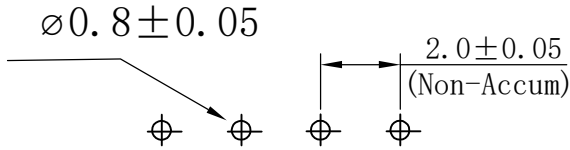

PCB Layout

**深圳市华德共创科技有限公司**  
 Shenzhen Huade co-create Technology Co., LTD  
 电话: 0755-27111216 传真: 0755-29940187

-TOLERANCES- UNLESS OTHERWISE SPECIFIED 公差参数表			TITLE: 产品名称: 2.0直插排针L8.7/2.8/3.9			
X.X ±0.30	X.X* ±3°	APPD: 核准:	PART NO: 产品编号: HDGCPH20-PZ1-X			
X.XX ±0.20	X.XX* ±2°	CHECK: 校对: 王建业	DATE	SCALE	UNIT	CODE NUMBER
X.XXX ±0.10	X.XXX* ±1°	DRAW: 绘图: 黄艳兰	2016-03-12	1:1	mm	A001

A B C D E F

## X-ON Electronics

Largest Supplier of Electrical and Electronic Components

*Click to view similar products for [Headers & Wire Housings](#) category:*

*Click to view products by [HDGC](#) manufacturer:*

Other Similar products are found below :

[57102-F02-18ULF](#) [58102-G61-06LF](#) [582553-1](#) [009176003701906](#) [01.001.5753.1](#) [0050291907](#) [02.125.8002.8](#) [609-3404](#) [61062-3](#)  
[CSU011177004](#) [622-0430](#) [622-3653LF](#) [63453-116](#) [636-1030](#) [636-1427](#) [636-3427](#) [636-4007](#) [641938-9](#) [644827-2](#) [65495-038](#) [65692-001LF](#)  
[65781-018](#) [65781-047](#) [65817-010LF](#) [65817-015LF](#) [66207-023LF](#) [67095-007LF](#) [67601157](#) [68631-112](#) [68645-018](#) [699319-000](#)  
[M90C108951C](#) [70.362.1628.0](#) [70-4210](#) [70-4226B](#) [70-4853B](#) [707-5028](#) [71.350.2428.0](#) [71961-016LF](#) [733-134](#) [733-162](#) [754199-000](#) [760-](#)  
[3052](#) [80.063.4001.1](#) [800-90-001-10-001000](#) [800-90-010-10-002000](#) [801-43-002-10-013000](#) [801-43-006-10-002000](#) [803-41-018-10-001000](#)  
[803-43-024-10-001000](#)