

修 订 REV NO	标 记 MARK	修 改 描 要 REVISION DESCRIPTION	签 名 SIGNATURE	日 期 DATE
		NEW DWG		2016-03-12

SPECIFICATION

1. Electrical characteristics

Contact Current Rating: 0.5 A

Dielectric Withstanding Voltage: 300V AC

Insulation Resistance: a. Mate 100MΩ MIN at 500V/DC

b. Unmate 10MΩ MIN at 150V/DC

Contact Resistance: 30mΩ MAX

Temperature Range: -20° C to +85° C

2. Mechanical

Mating Face: 44.1N MAX

Unmating Face: 9.8N MIN; 39.2N MAX

Durability: 10000 Cycles

3. material:

HOUSING: THERMOPLASTICS HIGH TEMP LCP+GLASS

FIBER BLACK COLOR, UL94V-0

CONTACT: Copper Alloy, T=0.20MM

SHELL: C2680, T=0.50MM

4. PLATING:

CONTACT: 1~30u" GOLD/TIN PLATING ON CONTACT AREA

100u" MIN, TIN PLATING ON SOLDER TAILS

50u" MIN, NICKEL UNDERPLATING OVER ALL

SHELL: 80u", NICKEL UNDERPLATING OVER ALL

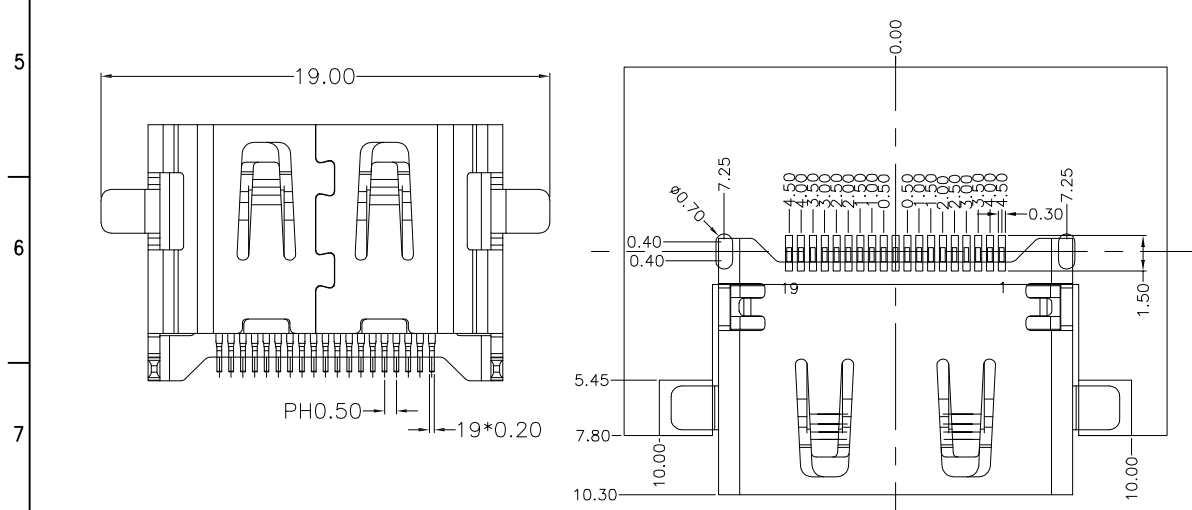
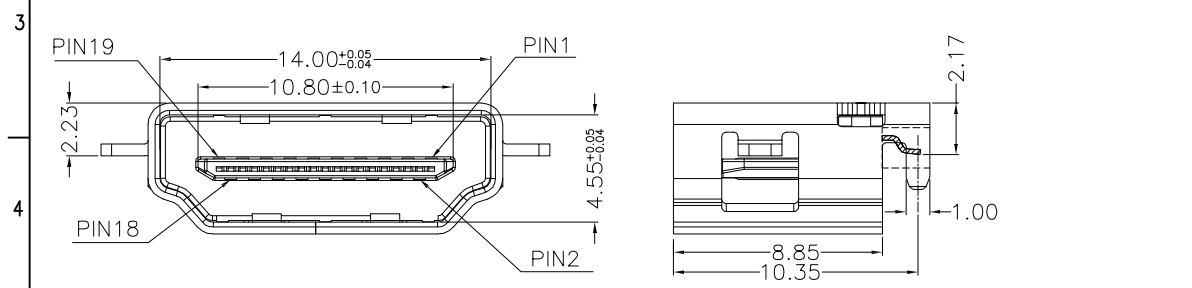
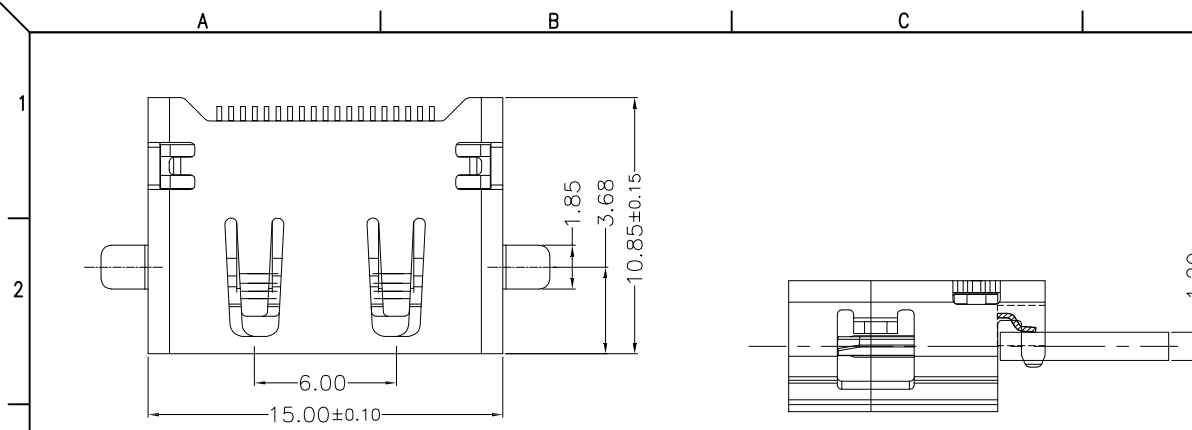

RECOMMEND PCB LAYOUT
TOLERANCE: ±0.05 T=1.2
TOP VIEW

MATERIAL LIST:

3	SHELL	1	SPCC	NI PLATED	
2	CONTACT	19	COPPER ALLOY	AU/TIN PLATED	
1	HOUSING	1	THERMOPLASTIC(LCP)	(UL 94V-0) BLACK	
No	PAPT	NAMF	QTY	MATFRIAL	RFMARK



深圳市华德共创科技有限公司

Shenzhen Huade co-create Technology Co., LTD

电话: 0755-23304126 传真: 0755-29940187

-TOLERANCES- UNLESS OTHERWISE SPECIFIED 公差参数表		TITLE: 产品名称: HDMI AF SMT沉板母座1.2铁壳镀镍黑胶	
X.X	±0.30	X.X*	±3°
X.XX	±0.20	X.XX*	±2°
X.XXX	±0.10	X.XXX*	±1°
APPD: 核准:	王建国	PART NO: 产品编号:	HDMI-GD-109PWB
CHECK: 校对:	黄艳兰	DATE	SCALE
DRAW: 绘图:	2016-03-12	UNIT	CODE NUMBER
	1:1	mm	A001

X-ON Electronics

Largest Supplier of Electrical and Electronic Components

Click to view similar products for [HDMI, Displayport & DVI Connectors](#) category:

Click to view products by [HDGC](#) manufacturer:

Other Similar products are found below :

[30-528](#) [30-504](#) [33DVIR-24S1B](#) [47648-2000](#) [TC142X](#) [1932649-1](#) [HAGBH](#) [AABII](#) [ABIBG](#) [AAIBH](#) [52355](#) [XHLJQ-00026](#) [HDMI-019R](#)
[G46M2013201AWEU](#) [ST-0277D00-052-142](#) [HC-PJ-320A-3P-D](#) [HC-PJ-3133-5P-D](#) [PJ-342](#) [141](#) [PJ-320A-4P DIP](#) [HC-PJ-325C-5P](#) [HC-PJ-](#)
[320D-4P-S](#) [HC-PJ-3133-6P-S](#) [D-SUB-DR-9PCM-CB](#) [ST-0275S00-082-182](#) [HC-PJ-320A-4P-D](#) [HC-PJ-325A-5P](#) [HC-PJ-3134-6P-D](#) [HDR-](#)
[HX-102DIP](#) [HDMI-GD-121PWB](#) [C2939191](#) [C2939584](#) [PJ-208](#) [PJ-2040](#) [PJ-3580A-6A](#) [PJ-399M](#) [PJ-3200A-3A](#) [PJ-328B-4B](#) [PJ-3930-7A](#)
[PJ-615-5A](#) [PJ-332-6A](#) [KH-HDMI-0001](#) [KH-PJ-209-SMT](#) [KH-HDMI-0035-XK](#) [KH-PJ-328A-5P](#) [KH-PJ-322](#) [KH-PJ-327E-SMT](#) [KH-PJ-](#)
[320A-5.6](#) [KH-HDR15P-F3.08](#) [KH-HDMI-0005A-SMT](#) [KH-HDMI-0021-JBS](#)