

CATEGORY	DESCRIPTION	P/N #
CONNECTOR	Modular Jack, 8P8C, 1X1PORT	MU88-XX11-HLSV6-X

由原料号 MU88-BX11-HLSV6
变更为 MU88-XX11-HLSV6-X

REV.	ECN NO	DESCRIPTION	REVISED	DATE
A01	—	New Release	XSY	2015.09.18
A02	—	区分塑胶颜色及包装方式	XSY	2017.10.30

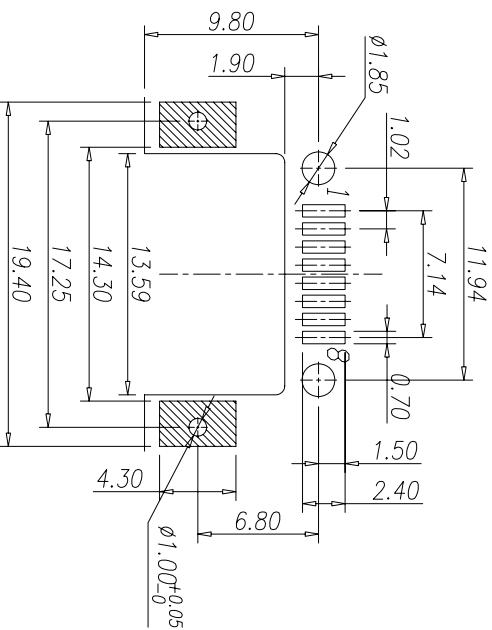
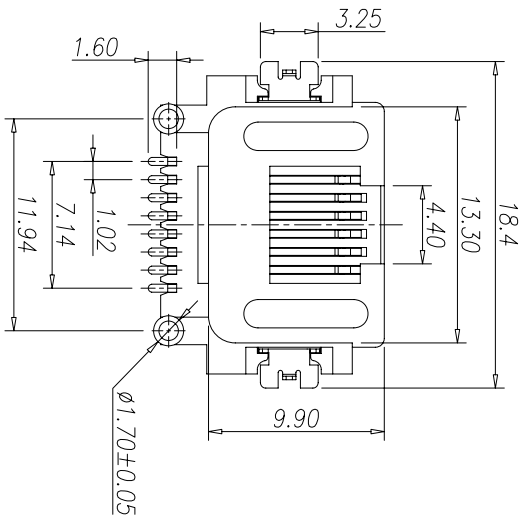
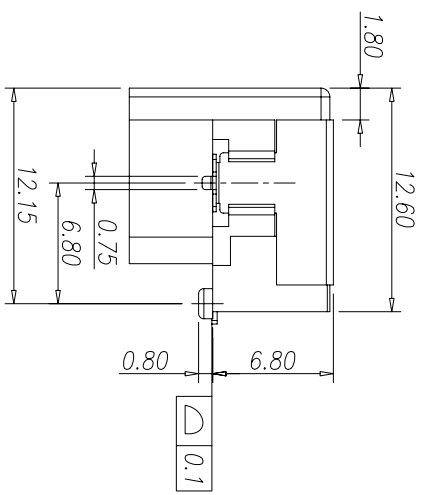
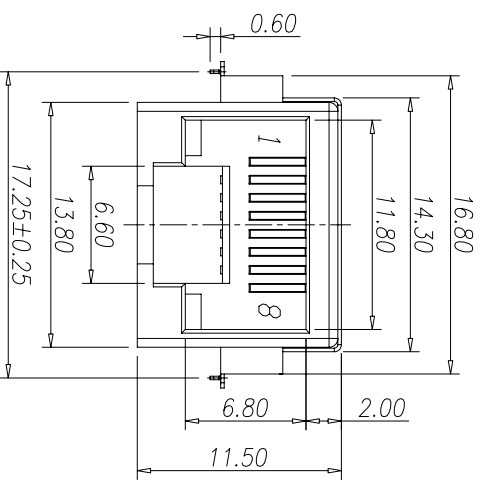

Recommend PCB Layout
(Jack Top View)
Tolerance: $\pm 0.05\text{mm}$

- NOTE:
1. Voltage: 150V AC RMS
 2. Current Rating: 1.5A
 3. Contact Resistance: 40mΩ MAX.
 4. Insulation Resistance: 500MΩ MIN.
 5. Dielectric Withstand Voltage: 1000V AC
 6. Operate Temperature: -40°C~80°C
 7. Durability: 750 Mating Cycles MIN.

Table 1

X	Housing Color	Housing Material
B	Black	LCP UL94V-0
W	White	PA9T UL94V-0

X	包装方式
C	卷带包装
P	吸塑盒包装

Table 2

X	Material & Plating
0	Au 1u" Plating
1	Au 3u" Plating
2	Au 6u" Plating
3	Au 15u" Plating

c	Shielding	1	Brass T=0.2mm
b	Terminal	8	Phosphor Bronze T=0.3mm
a	Housing	1	See Table 1
NO.	PART NAME	Q'TY	MATERIAL

	Plating	See Table 2
	Color	See Table 2
	Plating & Color	See Table 2
	Remark	Remark

UNLESS OTHERWISE SPECIFIED TOLERANCES	DECIMALS:	ANGLES:
	X : ± 0.5	X : $\pm 2^\circ$
	X.X : ± 0.3	X.X : $\pm 1'$
	X.XX : ± 0.2	

东莞市合陵电子有限公司
 DongGuan Heling Electronic Co.,LTD

SCALE: 1/1	UNIT: mm	DWG. NO:
SIZE: A3	PAGE: 1 OF 1	REV: A02
APPROVED BY	CHECKED BY	PREPARED BY
DICK	XSY	XSY
CUSTOMER COPY		

X-ON Electronics

Largest Supplier of Electrical and Electronic Components

Click to view similar products for [Modular Connectors](#) / [Ethernet Connectors](#) category:

Click to view products by [Heling](#) manufacturer:

Other Similar products are found below :

[RJE231881317T](#) [MP1010RX-1000](#) [MP44RX-1000](#) [GAX-3-66](#) [GAX-8-62](#) [93606-0253](#) [GD-A-44](#) [GDCX-PA-66-50](#) [GDCX-PN-64](#) [GDCX-PN-66](#) [GDCX-PN-66-50](#) [GDLX-A-66](#) [GDLX-A-88](#) [GDLX-N-66](#) [GDLX-S-88K](#) [GDTX-S-88-50](#) [GDX-PA-1010](#) [GLX-N-1010M-BLK](#) [GLX-N-44M](#) [GLX-S-88M-BLK](#) [GMX-N-1010](#) [GMX-S-1010](#) [GMX-S-66](#) [GMX-SMT2-N-1010](#) [GMX-SMT2-N-64-50](#) [GMX-SMT2-S6-88](#) [GMX-SMT4-N-88](#) [GPX-2-64](#) [GRT1-BT1-5](#) [GSGX-N-2-88](#) [GSX-NS2-88-3.05](#) [GSX-NS2-88-3.05-50](#) [GSX-NS-88-3.05-30](#) [GSX-NS-88-3.05-50](#) [GSX-NS-88-3.68](#) [1-1775629-2](#) [GWLX-S-88-GR](#) [GWLX-S9-88-YG](#) [1300500326](#) [1300500227](#) [1300530003](#) [1300570002](#) [1324640-4](#) [RJ11FTVC2G](#) [RJ11FTVC2N](#) [RJFTVX2SA1G](#) [132764-001](#) [1400000](#) [1413176](#) [1413235](#)