

| | | |
|-----------|---------------------|----------------------|
| CATEGORY | DESCRIPTION | P/N # |
| CONNECTOR | RJ45超薄全包沉板H4-3带灯无内弹 | MJ88K-BX11-HXRVLX1-X |

| | | | | |
|------|--------|-------------|---------|------------|
| REV. | ECN NO | DESCRIPTION | REVISED | DATE |
| A01 | | New Release | Luke | 2021.09.23 |

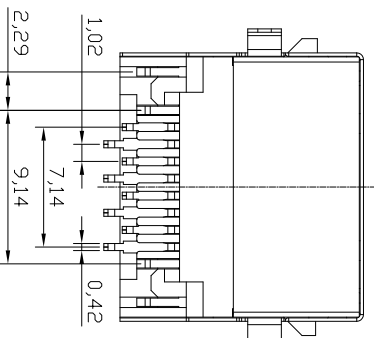
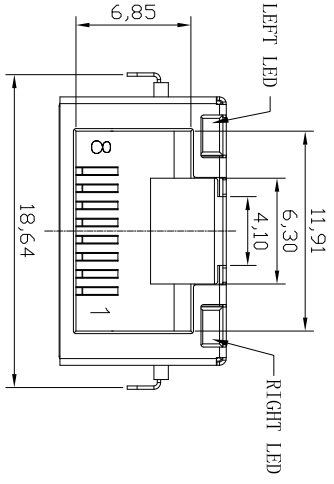
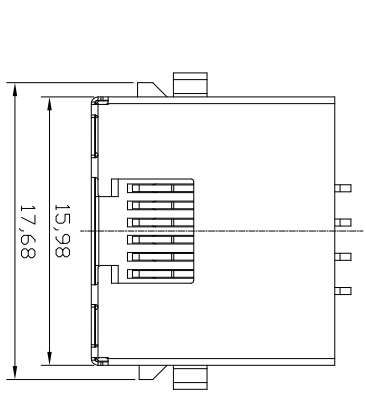

| | |
|---|------------------|
| X | Terminal Plating |
| 0 | Au 1u" Plating |
| 1 | Au 3u" Plating |
| 2 | Au 6u" Plating |
| 3 | Au 15u" Plating |
| 4 | Au 30u" Plating |

| | | |
|---|--------|--------|
| X | LED-L | LED-R |
| 1 | GREEN | YELLOW |
| 2 | YELLOW | GREEN |
| 3 | ORANGE | GREEN |

| | |
|---|---------------|
| X | Housing Color |
| 9 | PA 9T |
| L | LCP |

MJ88K-BX11-HXRVLX1-X

| | |
|---|------|
| X | 包装方式 |
| C | 卷带包装 |
| P | 吸塑包装 |

- NOTE:
1. Voltage: 150V AC RMS
 2. Current Rating: 1.5A
 3. Contact Resistance: 40mΩ MAX.
 4. Insulation Resistance: 500MΩ MIN.
 5. Dielectric Withstand Voltage :500V AC
 6. Operate Temperature: -40°C~80°C
 7. Durability: 750 Mating Cycles MIN.

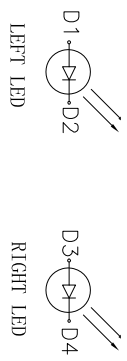
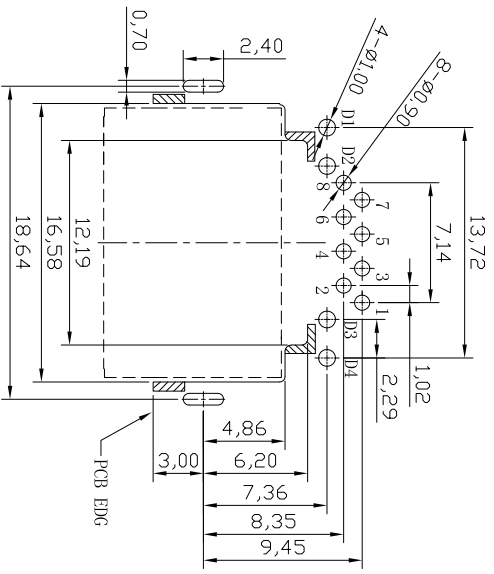
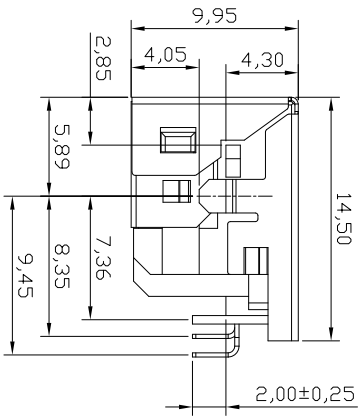

P.C.B RECOMMENDED HOLE LAYOUT SEEN FROM COMPONENT SIDE.
ALL CENTERLINE DIMENSIONS ARE BASIC

| | | | | | |
|-----|--------------|-----|--------------------------|-----------------|--------|
| f | LED-R | 1 | SEE TABLE | Tin PALTING | |
| e | LED-L | 1 | SEE TABLE | Tin PALTING | |
| d | Bottom SHELL | 1 | SUS T=0.15mm | Ni PALTING | |
| c | Upper SHELL | 1 | SUS T=0.2mm | Ni PALTING | |
| b | TERMINAL | 8 | PHOSPHOR BRONZE T=0.25mm | Au/Tin PALTING | |
| a | HOUSING | 1 | SEE TABLE UL94V-0 | BLACK | |
| NO. | PART NAME | QTY | MATERIAL | PLATING & COLOR | Remark |

UNLESS OTHERWISE SPECIFIED TOLERANCES:
DECIMALS: ANGLES:
X.X :±0.30 X :±2
X.XX :±0.20 X.X :±1
X.XXX :±0.10

东莞市合陵电子有限公司
 Dongguan Heling Electronic Co.,LTD
 SCALE:1/1 UNIT: mm DWG.NO:
 SIZE: A3 PAGE:1 OF 1 REV:A01
 APPROVED BY: _____ CHECKED BY: _____ PREPARED BY: _____
 DICK: XSY LUK
CUSTOMER COPY

X-ON Electronics

Largest Supplier of Electrical and Electronic Components

Click to view similar products for [Modular Connectors](#) / [Ethernet Connectors](#) category:

Click to view products by [Heling](#) manufacturer:

Other Similar products are found below :

[8949-H88/06BLKA/SN](#) [74441-0010/BKN](#) [PHP-6P6C-5](#) [GAX-3-66](#) [GDCX-PN-66](#) [GLX-A-44](#) [GLX-N-1010M-BLK](#) [GLX-S-88M-BLK](#)
[GMX-SMT4-N-88](#) [GSGX-N-2-88](#) [GSGX-N-4-88](#) [GSX-NS2-88-3.05](#) [GSX-NS-88-3.68](#) [PT-108A-8C-UL](#) [PTS-J531-8CS-50UL](#) [A-2014-0-4](#)
[GWLX-S9-88-YG](#) [DC-1021-8-WH-6](#) [1300530003](#) [1324640-4](#) [132764-001](#) [1413235](#) [MPS88RX-5000](#) [E5288-S000K3-L](#) [155302-001](#)
[AX101050](#) [AX101063](#) [AX101065](#) [AX101072](#) [AX101307](#) [AX101315](#) [AX101318](#) [AX102271](#) [AX102277](#) [AX102651](#) [AX102660](#) [AX104024](#)
[203475](#) [PC4D0018P](#) [KIT38082NI](#) [8949-B88/6](#) [2-6609208-5](#) [30-8956](#) [30-8964-100](#) [SM85](#) [SM99S01VBNN04G7](#) [17-103540](#) [191587](#) [PDI-68-RV](#) [PHP-8P8C-S-5](#)