

H3-MABACT0040

5-1218MHz 75Ω 1:1 Balun

• APPLICATIONS

• Ideally suited for high volume CATV/Broadband applications.

• FEATURES

- Surface mount
- Impedance ratio: 1:1
- Available on tape and reel
- RoHS compliant and Pb free
- 260°C reflow compatible

DIMENSIONS

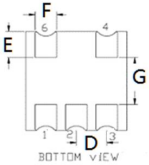
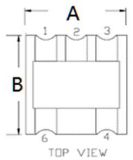

Land Pattern

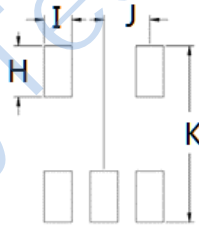

A	B	C	D	H	I	J
4.21	4.21	2.70Max	1.27	1.40	0.76	1.27
E	F	G	K			
1.11	0.90	2.00	4.83			

Unless otherwise stated dimensions are in mm

Tolerance: .xx ± 0.25, .xxx ± 0.05

ELECTRICAL SPECIFICATIONS@25°C:

Parameters (P#: ENA PORT)	frequency band	Min.	Typ.	Max.	Unit
Port Impedance, Z ₀			75		Ohm
Insertion Loss	5-1218MHz		1.0	1.6	dB
Amplitude Balance	5-1000MHz		0.7	±0.5	dB
	1000-1218MHz			±0.7	dB
Phase Balance (Nominal 180°)	5-1218MHz		2.5	±10	°
Input Return Loss	5-1218MHz	16	22		dB

FUNCTIONAL SCHEMATIC

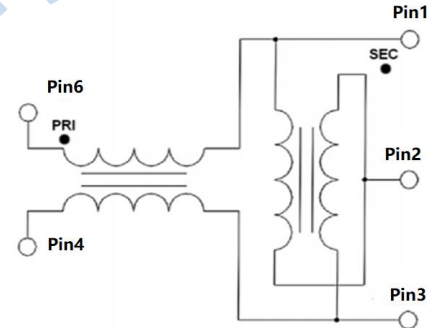

PIN CONFIGURATION

Pin No.	Function
1	Secondary Dot (output 1)
2	Secondary center tap (ground)
3	Secondary (output 2)
4	Primary (ground)
6	Primary Dot (input)

APPLICATION & TEST CIRCUIT

Z₀=75 Ω

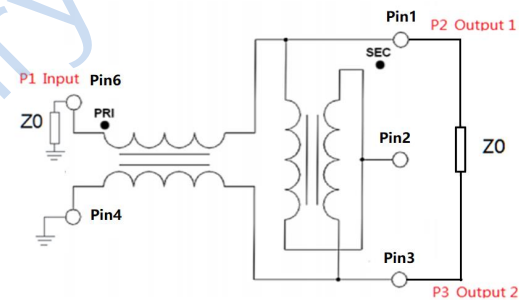

ABSOLUTE MAXIMUM RATINGS

Parameter	Value
Input Power	500mW MAX
DC Current	500mA MAX
Operating Temperature Range	-40 to 105°C

TEST CURVE

Insertion Loss: Pin 6 to Pin 3

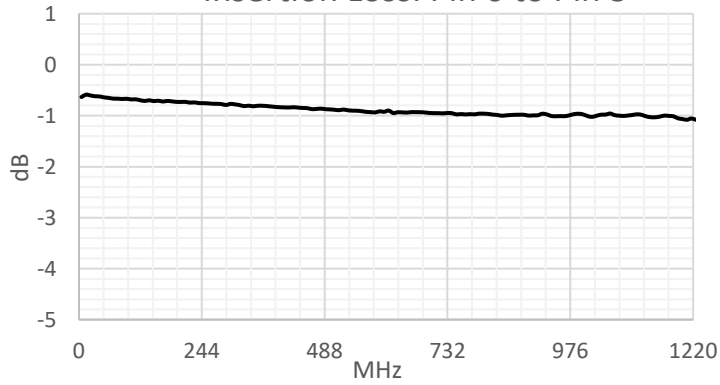

Insertion Loss: Pin 6 to Pin 1

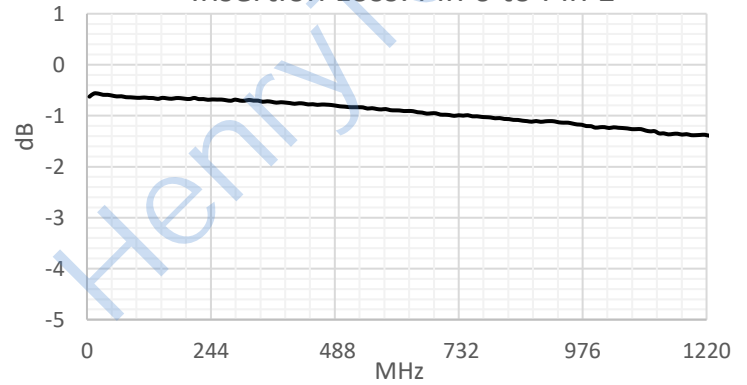

Amplitude Balance

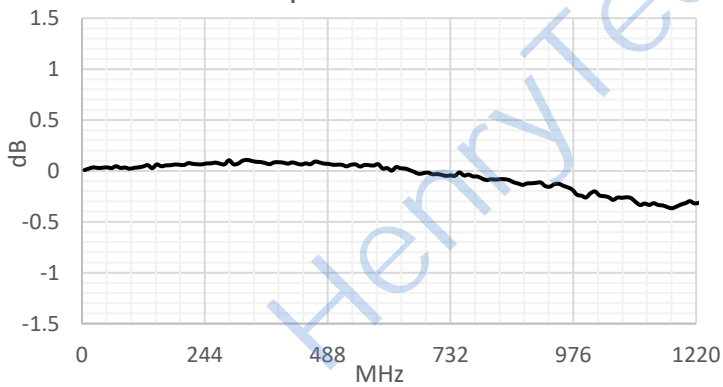

Phase Balance

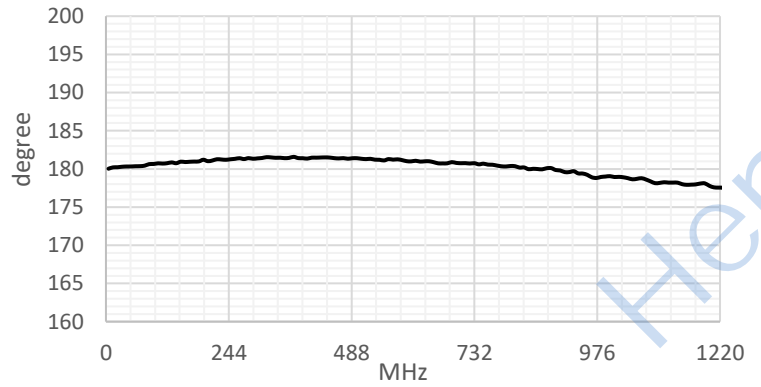

Input Return Loss: Pin 6

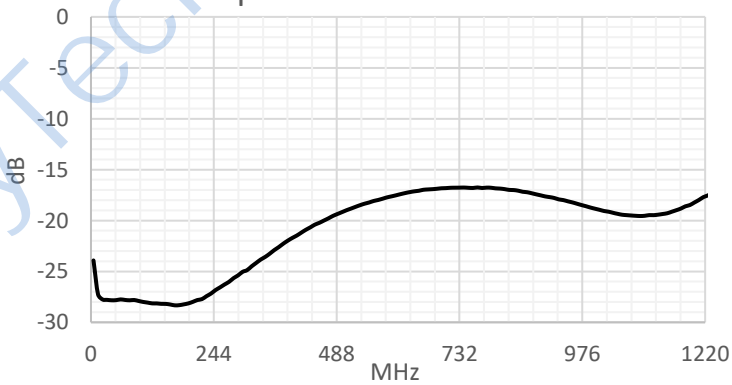

X-ON Electronics

Largest Supplier of Electrical and Electronic Components

Click to view similar products for [Signal Conditioning](#) category:

Click to view products by [HenryTech](#) manufacturer:

Other Similar products are found below :

[PD0409J5050S2HF](#) [HHS-109-PIN](#) [AFS14A35-1591.50-T3](#) [JP510S](#) [LFB322G45SN1A504](#) [SF2159E](#) [FM-104-PIN](#) [CER0813B](#)
[MAPDCC0005](#) [3A325](#) [BD0810N50100AHF](#) [DC0710J5005AHF](#) [DC2327J5005AHF](#) [LFL15869MTC1B787](#) [X3C19F1-20S](#)
[CDBLB455KCAX39-B0](#) [RF1353C](#) [051157-0000](#) [PD0922J5050D2HF](#) [600S150FTRB](#) [1E1305-3](#) [1F1304-3S](#) [TP-103-PIN](#)
[BD1222J50200AHF](#) [BD1722J50100AHF](#) [2450DP39K5400E](#) [BD0810J50150AHF](#) [BD1722J50200AHF](#) [DS-327-PIN](#) [MACP-008125-](#)
[CK07F0](#) [DS-329-PIN](#) [DS-313-PIN](#) [TP-104-PIN](#) [TP-101-PIN](#) [HH-128-PIN](#) [8594810000](#) [T-1000-N](#) [JP506S](#) [XC0900P-10S](#) [XC0900B-30S](#)
[CHE1260-QAG](#) [11305-10](#) [5962-9091202MXA](#) [3A412S](#) [X3C06A4-03S](#) [B39000Z3410A4](#) [DSS-333-PIN](#) [PD2425J5050S2HF](#)
[B39242B4360P810](#) [B39781B8005P810](#)