

## H3-MACP-010388-CK0A40

**5-1200MHz 75Ω 20dB Coupler**

### • APPLICATIONS

• Ideally suited for CATV Broadband applications.

### • FEATURES

- Surface mount
- 20dB Coupler
- RoHS compliant and Pb free
- Available on tape and reel

### DIMENSIONS

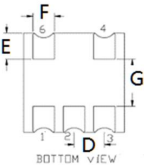
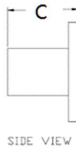
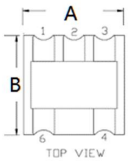

### Land Pattern

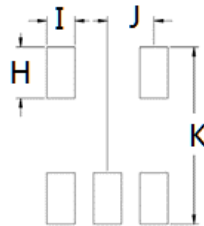

A	B	C	D	H	I	J
4.30	4.30	2.65	1.27	1.40	0.76	1.27
E	F	G		K		
1.11	0.90	2.00		4.83		

Unless otherwise stated dimensions are in mm

Tolerance: .xx ±0.25, .xxx ±0.05

### ELECTRICAL SPECIFICATIONS@25°C:

Parameters (P#: ENA PORT)	frequency band	Min.	Typ.	Max.	Unit
Port Impedance, Z0			75		Ohm
Coupling	5 - 870 MHz	19.2	20.2	20.8	dB
	870 - 1002 MHz	19.1	19.4	20.8	dB
	1002 - 1200 MHz	18.4	19.2	20.8	dB
Main Line Loss	5 - 50 MHz		0.42	0.7	dB
	50 - 870 MHz		0.45	0.65	dB
	870 - 1002 MHz		0.6	0.7	dB
	1002 - 1200 MHz		0.65	0.85	dB
Input Return Loss	5 - 1002 MHz	19	27		dB
	1002 - 1200 MHz	16	19		dB
Output Return Loss	5 - 1002 MHz	20	30		dB
	1002 - 1200 MHz	17	20		dB
Coupled Return Loss	5 - 1002 MHz	17	28		dB
	1002 - 1200 MHz	15	17		dB
Directivity	5 - 200 MHz	20	25		dB
	200 - 870 MHz	10	16		dB
	870 - 1002 MHz	8	11		dB
	1002 - 1200 MHz	7	10		dB

### FUNCTIONAL SCHEMATIC

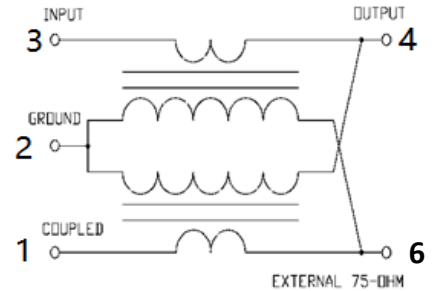

### PIN CONFIGURATION

Pin No.	Function
1	Coupled
2	Ground
3	Input
4	Output
6	External 75 Ohm

### ABSOLUTE MAXIMUM RATINGS

Parameter	Value
RF Power	250 mW Max
DC Current	200mA Max
Operating Temperature Range	-40 to 85°C
Storage Temperature	-55 to 125°C

Tel: +86-28-85589664

E-mail: mr\_li@henglitaitech.com

Web: www.hltchips.com

Adress:No.198 Tianqin East Street, Gaoxin West District, Chengdu City

## TEST CURVE

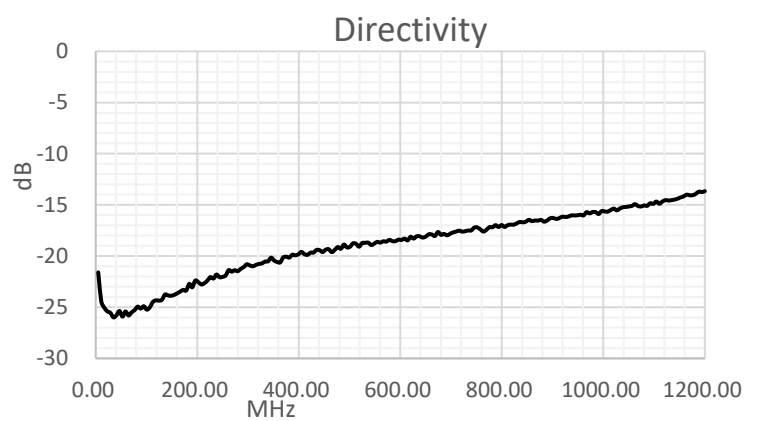
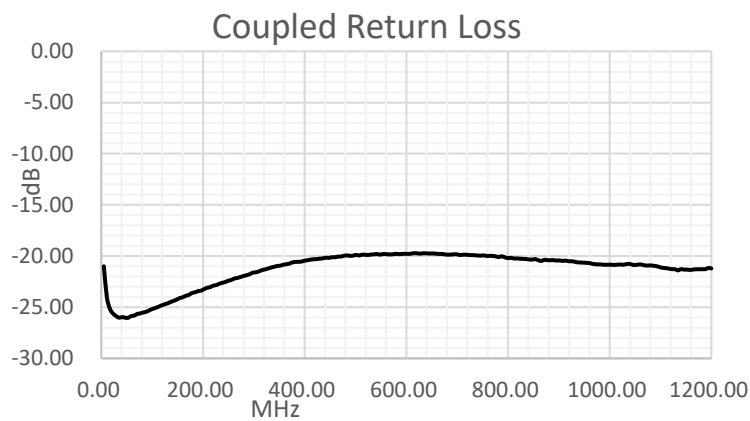
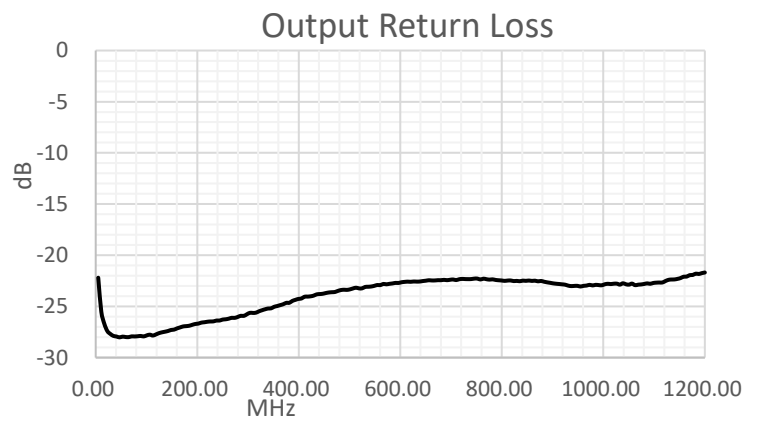
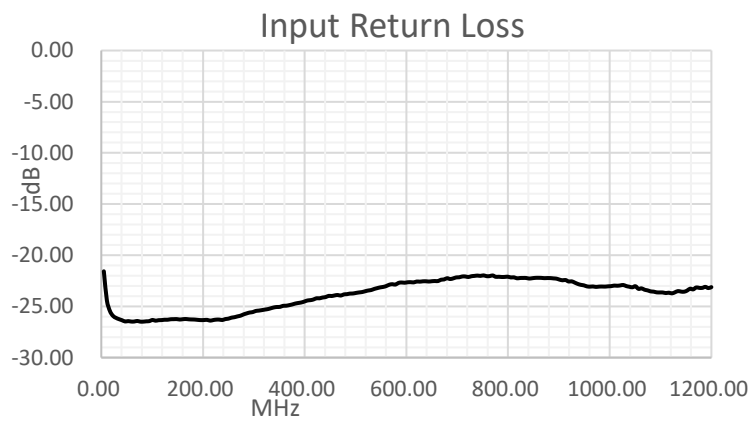
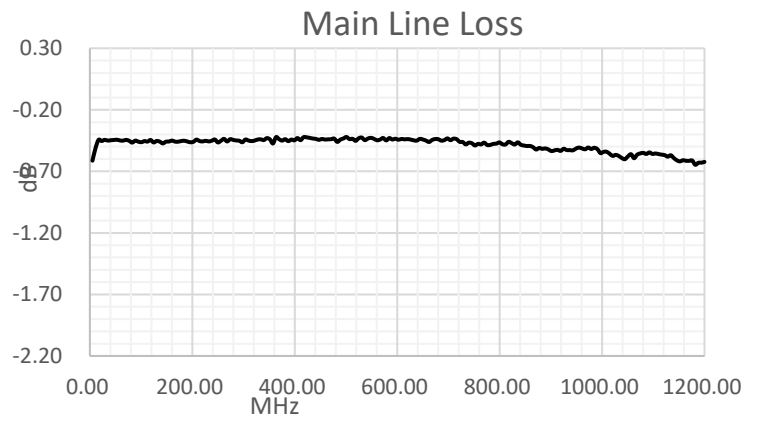
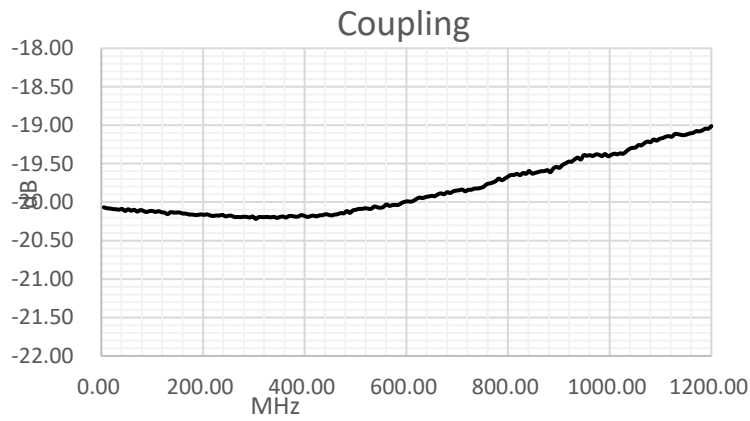

## X-ON Electronics

Largest Supplier of Electrical and Electronic Components

*Click to view similar products for [Signal Conditioning](#) category:*

*Click to view products by [HenryTech](#) manufacturer:*

Other Similar products are found below :

[PD0409J5050S2HF](#) [HHS-109-PIN](#) [AFS14A35-1591.50-T3](#) [JP510S](#) [LFB322G45SN1A504](#) [SF2159E](#) [FM-104-PIN](#) [CER0813B](#)

[MAPDCC0005](#) [3A325](#) [BD0810N50100AHF](#) [DC0710J5005AHF](#) [DC2327J5005AHF](#) [LFL15869MTC1B787](#) [X3C19F1-20S](#)

[CDBLB455KCAX39-B0](#) [RF1353C](#) [051157-0000](#) [PD0922J5050D2HF](#) [600S150FTRB](#) [1E1305-3](#) [1F1304-3S](#) [TP-103-PIN](#)

[BD1222J50200AHF](#) [BD1722J50100AHF](#) [2450DP39K5400E](#) [BD0810J50150AHF](#) [BD1722J50200AHF](#) [DS-327-PIN](#) [MACP-008125-](#)

[CK07F0](#) [DS-329-PIN](#) [DS-313-PIN](#) [TP-104-PIN](#) [TP-101-PIN](#) [HH-128-PIN](#) [8594810000](#) [T-1000-N](#) [JP506S](#) [XC0900P-10S](#) [XC0900B-30S](#)

[CHE1260-QAG](#) [11305-10](#) [5962-9091202MXA](#) [3A412S](#) [X3C06A4-03S](#) [B39000Z3410A4](#) [DSS-333-PIN](#) [PD2425J5050S2HF](#)

[B39242B4360P810](#) [B39781B8005P810](#)