

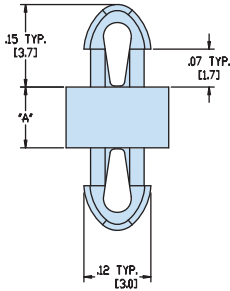

# Heyco® Nylon PCB Supports - Metric Spacing



TEARDROP SNAP LOCK /  
TEARDROP SNAP LOCK

**HSP-MDL-1**

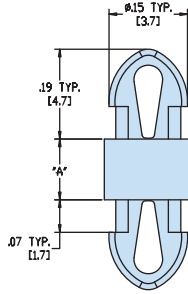

TEARDROP SNAP LOCK /  
TEARDROP SNAP LOCK

**HSP-MDL-2**

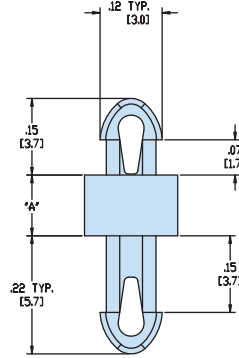

TEARDROP SNAP LOCK /  
TEARDROP SNAP LOCK

**HSP-MDLS-1**

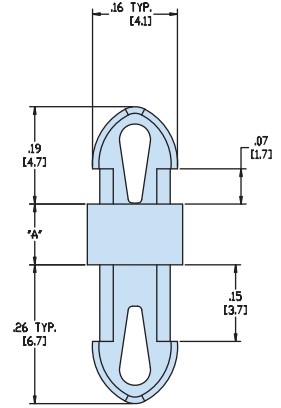

TEARDROP SNAP LOCK /  
TEARDROP SNAP LOCK

**HSP-MDLS-2**

	Maximum Thickness		Mounting Hole Diameter		Maximum Thickness		Mounting Hole Diameter		Maximum Thickness		Mounting Hole Diameter		Maximum Thickness		Mounting Hole Diameter	
	in.	mm.	in.	mm.	in.	mm.	in.	mm.	in.	mm.	in.	mm.	in.	mm.	in.	mm.
<b>PCB</b>	.062	1,6	.098	2,5	.062	1,6	.137	3,5	.062	1,6	.098	2,5	.062	1,6	.137	3,5
<b>Chassis</b>	.062	1,6	.098	2,5	.062	1,6	.137	3,5	.141	3,6	.098	2,5	.141	3,6	.137	3,5

A mm.	PART NO. Natural	DESCRIPTION	PART NO. Natural	DESCRIPTION	PART NO. Natural	DESCRIPTION	PART NO. Natural	DESCRIPTION
2,0	<b>10444</b>	HSP-MDL-1-02M	<b>10461</b>	HSP-MDL-2-02M	<b>10478</b>	HSP-MDLS-1-02M	<b>10493</b>	HSP-MDLS-2-02M
3,0	<b>10445</b>	HSP-MDL-1-03M	<b>10462</b>	HSP-MDL-2-03M	<b>10479</b>	HSP-MDLS-1-03M	<b>10494</b>	HSP-MDLS-2-03M
4,0	<b>10446</b>	HSP-MDL-1-04M	<b>10463</b>	HSP-MDL-2-04M	<b>10480</b>	HSP-MDLS-1-04M	<b>10495</b>	HSP-MDLS-2-04M
5,0	<b>10447</b>	HSP-MDL-1-05M	<b>10464</b>	HSP-MDL-2-05M	<b>10481</b>	HSP-MDLS-1-05M	<b>10496</b>	HSP-MDLS-2-05M
6,0	<b>10448</b>	HSP-MDL-1-06M	<b>10465</b>	HSP-MDL-2-06M	<b>10482</b>	HSP-MDLS-1-06M	<b>10497</b>	HSP-MDLS-2-06M
7,0	<b>10449</b>	HSP-MDL-1-07M	<b>10466</b>	HSP-MDL-2-07M	<b>10483</b>	HSP-MDLS-1-07M	<b>10498</b>	HSP-MDLS-2-07M
8,0	<b>10450</b>	HSP-MDL-1-08M	<b>10467</b>	HSP-MDL-2-08M	<b>10484</b>	HSP-MDLS-1-08M	<b>10499</b>	HSP-MDLS-2-08M
9,0	<b>10451</b>	HSP-MDL-1-09M	<b>10468</b>	HSP-MDL-2-09M				
10,0	<b>10452</b>	HSP-MDL-1-10M	<b>10469</b>	HSP-MDL-2-10M	<b>10485</b>	HSP-MDLS-1-10M	<b>10500</b>	HSP-MDLS-2-10M
12,0	<b>10453</b>	HSP-MDL-1-12M	<b>10470</b>	HSP-MDL-2-12M	<b>10486</b>	HSP-MDLS-1-12M	<b>10501</b>	HSP-MDLS-2-12M
14,0	<b>10454</b>	HSP-MDL-1-14M	<b>10471</b>	HSP-MDL-2-14M	<b>10487</b>	HSP-MDLS-1-14M	<b>10502</b>	HSP-MDLS-2-14M
16,0	<b>10455</b>	HSP-MDL-1-16M	<b>10472</b>	HSP-MDL-2-16M	<b>10488</b>	HSP-MDLS-1-16M	<b>10503</b>	HSP-MDLS-2-16M
18,0	<b>10456</b>	HSP-MDL-1-18M	<b>10473</b>	HSP-MDL-2-18M	<b>10489</b>	HSP-MDLS-1-18M	<b>10504</b>	HSP-MDLS-2-18M
20,0	<b>10457</b>	HSP-MDL-1-20M	<b>10474</b>	HSP-MDL-2-20M	<b>10490</b>	HSP-MDLS-1-20M	<b>10505</b>	HSP-MDLS-2-20M
22,0	<b>10458</b>	HSP-MDL-1-22M	<b>10475</b>	HSP-MDL-2-22M	<b>10491</b>	HSP-MDLS-1-22M	<b>10506</b>	HSP-MDLS-2-22M
26,5	<b>10459</b>	HSP-MDL-1-26.5M	<b>10476</b>	HSP-MDL-2-26.5M				

Standard color natural. For special order parts in UL 94V-0 natural material, add the suffix "F" to Part No.

Quick  
Specs

Material Nylon 6/6  
Flammability Rating 94V-2  
Temperature Range .4°F (-18°C) to 185°F (85°C)

## X-ON Electronics

Largest Supplier of Electrical and Electronic Components

*Click to view similar products for [Circuit Board Hardware - PCB category](#):*

*Click to view products by [Heyco manufacturer](#):*

Other Similar products are found below :

[8919-0-00-15-00-00-03-0](#) [0135-0-15-01-30-27-04-0](#) [5970-1-15-01-32-14-04-0](#) [0149-0-15-15-30-27-04-0](#) [MBI 1 BLUE](#) [7305-0-15-15-47-14-10-0](#) [MLN 150/1 BLACK](#) [8579-0-15-80-11-27-10-0](#) [8579-1-15-15-11-27-10-0](#) [8830-0-15-01-22-14-10-0](#) [8836-0-00-21-00-00-03-0](#) [PRUEF 2 RED](#) [9976-0-00-00-00-00-03-0](#) [PW1616](#) [1215-3-05-00-00-00-01-0](#) [1231](#) [1303-0-15-15-47-14-04-0](#) [1404-3](#) [1404-4](#) [1406-4](#) [1407-3](#) [1406-3](#) [1407-4](#) [1408-3](#) [1424-4](#) [1427-3](#) [1419-4](#) [1426-4](#) [1548-103](#) [1938-0-00-00-00-00-03-0](#) [1942-0-00-00-00-00-03-0](#) [2101-3-00-44-00-00-07-0](#) [2108-2-00-50-00-00-07-0](#) [2109-2-00-44-00-00-07-0](#) [2110-2-00-44-00-00-07-0](#) [2111-2-00-00-00-00-07-0](#) [2113-4-00-44-00-00-07-0](#) [2301-3-00-44-00-00-07-0](#) [2308-1-00-50-00-00-07-0](#) [2313-2-00-00-00-00-07-0](#) [2315-2-01-44-00-00-07-0](#) [2333-1-00-50-00-00-07-0](#) [9000-0-00-00-00-00-03-0](#) [2506-2-00-50-00-00-07-0](#) [2507-2-01-44-00-00-07-0](#) [2508-2-00-44-00-00-07-0](#) [2561-2-00-44-00-00-07-0](#) [9220](#) [9234-0-15-15-30-14-10-0](#) [LAS S G BLACK](#)