

## Heyco® Stainless Steel Cable Clamps

- For clamping cable or tubing securely into place, especially in **harsh environments**.
- Smooth "coined clamp" edges prevent damage to cable insulation.
- Constructed from corrosion resistant 304 stainless steel.
- Coated parts are constructed from 304 stainless steel and coated with polyolefin a thermoplastic co-polymer.
- Coating provides a durable non-toxic, odorless coating that has very good low temperature flexibility and excellent electrical properties. This coating also has **FDA food contact** approval.
- All parts require a .203" (5,2 mm) mounting hole suitable for a #10 screw.
- Not for use in a marine salt water environment. Contact Heyco for alternative materials.
- DFARS Compliant

PART DIMENSION A			STANDARD		COATED	
in.	mm.	PART NO.	DESCRIPTION	PART NO.	DESCRIPTION	
.19	4,7	<b>S3373</b>	CC H 3/16 SS	<b>S3323</b>	CC H 3/16 SS Coated	<b>NEW!</b>
.25	6,3	<b>S3374</b>	CC H 1/4 SS	<b>S3324</b>	CC H 1/4 SS Coated	
.38	9,5	<b>S3376</b>	CC H 3/8 SS	<b>S3326</b>	CC H 3/8 SS Coated	
.50	12,7	<b>S3378</b>	CC H 1/2 SS	<b>S3328</b>	CC H 1/2 SS Coated	
.63	15,9	<b>S3380</b>	CC H 5/8 SS	<b>S3330</b>	CC H 5/8 SS Coated	
.75	19,1	<b>S3382</b>	CC H 3/4 SS	<b>S3332</b>	CC H 3/4 SS Coated	
.88	22,2	<b>S3384</b>	CC H 7/8 SS	<b>S3334</b>	CC H 7/8 SS Coated	

Consult Heyco for additional sizes.

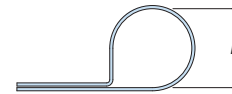
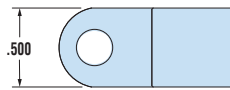

## Heyco® Steel Cushion Clamps

- Light to heavy duty steel clamp.
- E.P.D.M. cushion for electrical insulation and vibration absorption.
- Steel clamps are zinc electroplated for corrosion resistance.
- Color - Silver with durable black cushion.

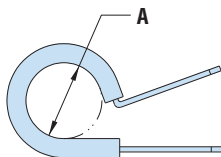

MOUNTING HOLE DIA.		SCREW SIZE	PART DIMENSION A		PART NO.	DESCRIPTION
in.	mm.		in.	mm.		
<b>.650" (16,5 mm) Overall Width, .031" (0,8 mm) Steel Thickness</b>						
.265	6,7	1/4	0.19	4,7	<b>12300</b>	CCSC L 3/16
			0.25	6,3	<b>12301</b>	CCSC L 1/4
			0.31	7,9	<b>12302</b>	CCSC L 5/16
			0.38	9,5	<b>12303</b>	CCSC L 3/8
			0.44	11,1	<b>12304</b>	CCSC L 7/16
			0.50	12,7	<b>12305</b>	CCSC L 1/2
			0.56	14,3	<b>12306</b>	CCSC L 9/16
			0.63	15,9	<b>12307</b>	CCSC L 5/8
			0.69	17,4	<b>12308</b>	CCSC L 11/16
			0.75	19,1	<b>12309</b>	CCSC L 3/4
			0.88	22,2	<b>12310</b>	CCSC L 7/8
			1.00	25,4	<b>12311</b>	CCSC L 1
			1.13	28,6	<b>12312</b>	CCSC L 1-1/8
			1.25	31,8	<b>12313</b>	CCSC L 1-1/4
			1.50	38,1	<b>12314</b>	CCSC L 1-1/2
			2.00	50,8	<b>12315</b>	CCSC L 2
2.50	63,5	<b>12316</b>	CCSC L 2-1/2			
3.00	76,2	<b>12317</b>	CCSC L 3			
<b>.750" (19,1 mm) Overall Width, .047" (1,2 mm) Steel Thickness</b>						
.406	10,3	7/16	0.25	6,3	<b>12331</b>	CCSC H 1/4
			0.31	7,9	<b>12332</b>	CCSC H 5/16
			0.38	9,5	<b>12333</b>	CCSC H 3/8
			0.44	11,1	<b>12334</b>	CCSC H 7/16
			0.50	12,7	<b>12335</b>	CCSC H 1/2
			0.63	15,9	<b>12337</b>	CCSC H 5/8
			0.69	17,4	<b>12338</b>	CCSC H 11/16
			0.88	22,2	<b>12340</b>	CCSC H 7/8
			1.00	25,4	<b>12341</b>	CCSC H 1
			1.25	31,8	<b>12343</b>	CCSC H 1-1/4
			1.50	38,1	<b>12344</b>	CCSC H 1-1/2
			2.00	50,8	<b>12345</b>	CCSC H 2
			2.50	63,5	<b>12346</b>	CCSC H 2-1/2
			3.00	76,2	<b>12347</b>	CCSC H 3



Quick Specs

Material	<b>CC H</b> 304 Stainless Steel	<b>CCSC</b> Zinc Plated Steel with a UV resistant EPDM Sleeve
Temperature Range	0°C (32°F) to 60°C (140°F)	-40°C (-40°F) to 100°C (212°F)

## **X-ON Electronics**

Largest Supplier of Electrical and Electronic Components

*Click to view similar products for [Cable Mounting & Accessories](#) category:*

*Click to view products by [Heyco](#) manufacturer:*

Other Similar products are found below :

[8945](#) [8950](#) [8961](#) [582603-1](#) [009333-000](#) [CXA-0069](#) [D-150-0175CS2902](#) [70.060.1628.0](#) [727844N003](#) [770-1004](#) [770-1102](#) [770-1204](#) [770-1205-10](#) [770-1301-10](#) [770-1306](#) [770-1422](#) [770-1602](#) [770-1603](#) [770-1604](#) [770-1607](#) [790-1002](#) [809090N001](#) [843188-000](#) [8666](#) [PVC10512-BLACK-500](#) [PVC1056-BLACK-500](#) [DB-11](#) [1301800416](#) [1302030548](#) [1302264450](#) [1300830184](#) [1300830729](#) [1300900039](#) [1301580036](#) [1301850553](#) [1301860900](#) [1301860939](#) [1302000074](#) [1302261315](#) [1302264431](#) [APA18-AK](#) [MSK-0001](#) [1-787307-1](#) [1868](#) [HP-6N](#) [C-202-C](#) [202C221-13-0](#) [CA7308-000](#) [229408-1](#) [KC-201](#)