

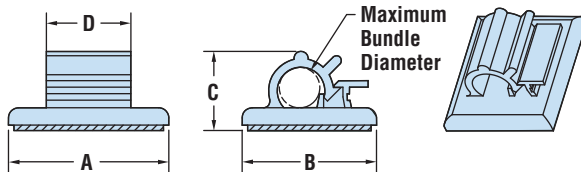

HEYClip™ Locking Releasable Wire Clips - Adhesive-Back Mount

MAXIMUM BUNDLE DIAMETER	RATED STATIC LOAD	PART NO. Adhesive	DESCRIPTION		FOOTPRINT		OVERALL HEIGHT		CLAMP WIDTH			
			Standard	Super	A x B		C		D			
in. mm.	lb.	Gray Black	Gray	Black	in.	mm.	in.	mm.	in.	mm.		
WCA Series												
.19	4,7	1/2	3857	3917	-	WCA 187-500	.74 x .62	18,8 x 15,7	.34	8,6	.39	9,9
.25	6,4	3/4	3858	3918	3918A	WCA 250-750	1.00 x .87	25,4 x 22,1	.42	10,7		
.38	9,5	1	3859	3919	3919A	WCA 375-1000	1.00 x 1.00	25,4 x 25,4	.50	12,7	.63	16,0
.50	12,7	1-1/4	3860	3920	3920A	WCA 500-1250	1.00 x 1.21	25,4 x 30,7	.68	17,3		
.75	19,1	1-3/4	3861	3921	-	WCA 750-1750	1.15 x 1.45	29,2 x 36,8	.99	25,1	.64	16,3
1.00	25,4	4	3867	3923	-	WCA1000-4000	1.98 x 2.24	50,3 x 56,9	1.37	34,8	1.26	32,0
1.50	38,1	6	3868	3930	-	WCA 1500-6000	2.42 x 2.95	61,5 x 74,9	1.77	45,0	1.31	33,3

Standard color gray or black. Super duty adhesive backing available as shown.



- Adhesive backing on part has a tab for easy removal.
- Releasable and reusable clips for easy wire bundle routing.
- Quick and easy installation—simply peel off backing and press into place.
- Multiple sizes for bundles from .19” (4,7 mm) to 1.50” (38,1 mm) in diameter.
- Static Loads pertain to parts fastened to a flat, clean, and dry surface.
- Three sizes in Super Adhesive Black.



HEYClip™ Locking Releasable Wire Clips - Adjustable



MAXIMUM BUNDLE DIAMETER RANGE				PART NO.	DESCRIPTION	OVERALL HEIGHT		FOOTPRINT		
A		Natural				D *		B x C		
Minimum	Maximum	in.	mm.			in.	mm.	in.	mm.	
WCLP Series - Arrowhead Mount										
.47	11,9	.55	14,0	4335	WCLP 562	1.17	29,8	.50 x 1.24	12,7 x 31,5	
.58	14,7	.75	19,1	4336	WCLP 750	1.36	34,5	.50 x 1.48	12,7 x 37,6	
WCLA Series - Adhesive Mount**										
.22	5,5	.26	6,5	4323	WCLA 258	.74	18,8	.65 x .85	16,5 x 21,6	
.31	7,9	.41	10,3	4324	WCLA 406	.90	22,8	.75 x 1.00	19,1 x 25,4	
.47	11,9	.56	14,3	4325	WCLA 562	1.12	28,5	.75 x 1.24	19,1 x 31,5	
.58	14,7	.75	19,1	4326	WCLA 750	1.32	33,6	.75 x 1.50	19,1 x 38,1	
.87	22,2	1.00	25,4	4327	WCLA 1000	1.78	45,3	1.00 x 1.97	25,4 x 50,1	

Standard color natural. *At maximum wire capacity. **Adhesive-Back is 1/16” (1,6 mm) thick.

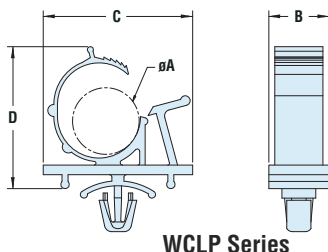

WCLP Series

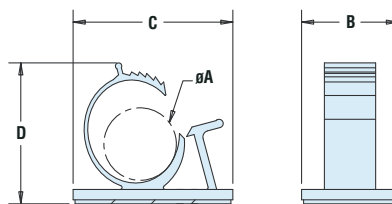

WCLA Series

Material	Nylon 6/6
Flammability Rating	94V-2
Temperature Range	-20°F (-29°C) to 150°F (66°C) (Adhesive-Back) -40°F (-40°C) to 185°F (85°C) (Adjustable)

Quick Specs

X-ON Electronics

Largest Supplier of Electrical and Electronic Components

Click to view similar products for [Cable Mounting & Accessories](#) category:

Click to view products by [Heyco](#) manufacturer:

Other Similar products are found below :

[582603-1](#) [009333-000](#) [727844N003](#) [747](#) [809090N001](#) [843188-000](#) [8666](#) [967279N002](#) [DB-11](#) [1300840039](#) [1300900096](#) [1301800416](#)
[1302264450](#) [1300830184](#) [1300830729](#) [1300900039](#) [1301580036](#) [1301850553](#) [1301860939](#) [1302000074](#) [1302261315](#) [1302264431](#)
[1337706-2](#) [APA18-AK](#) [1724](#) [1-787307-1](#) [185491N001](#) [1868](#) [HP-6N](#) [C-202-C](#) [202C221-13-0](#) [CA7308-000](#) [8S23-75FR-CS8184](#) [2684](#) [9648](#)
[3089](#) [988382-000](#) [A72821-000](#) [AA401](#) [173506-000](#) [202C292-13-0](#) [202C302-13-0](#) [2109](#) [300625](#) [3330](#) [3412](#) [M9142](#) [M9143](#) [529732-000](#)
[561-50D1187](#)