



Heyco®-Tite EMC-2 Brass Liquid Tight Cordgrips Straight-Thru, Metric Hubs

EMC Nickel-Plated Brass with Contact Sleeve

The Ultimate in Liquid Tight Strain Relief Protection

- **Ideal for applications where Electromagnetic Interference (EMI) protection or Electromagnetic Compatibility (EMC) is needed.**
- **Innovative contact spring**, due to strong clamping, virtually guarantees a secure shielded tap connection.
- Contact spring can be precisely positioned due to its clearly defined limit stop, making installation simple.
- Clamping technique ensures the cable can be rotated, pushed and easily dismantled during mounting.
- Excellent 360° shield contact with contact sleeve due to braided shield which runs into the gland.
- Combination of the sealing insert and the contact socket guarantees a constant contact quality with minimal transfer impedance.
- For use in clearance or threaded holes.
- EMC Locknuts available see page 3-40.
- DFARS Compliant

| CABLE DIA. RANGE | | | | PART NO. | THREAD SIZE | UL or IEC | PART DIMENSIONS | | | | | | | |
|------------------|-----|---------|-----|----------|-------------|-----------|--------------------------|-----|-----------------------|-----|--------------------|-----|------------------------------|--|
| Minimum | | Maximum | | | | | A Clearance Hole Dia. | | B Max. O.A. Length | | C Thread Length | | D Wrenching Nut Flat Size | |
| in. | mm. | in. | mm. | | | in. | mm. | in. | mm. | in. | mm. | in. | mm. | |

Standard Thread

| | | | | | | | | | | | | | | |
|------|------|-------|------|-------------|-----------|-------|-------|------|------|------|-----|------|------|------|
| .138 | 3,5 | .197 | 5,0 | 4594 | M12 x 1,5 | cULus | .472 | 12,0 | 1.26 | 32,0 | .39 | 10,0 | .59 | 15,0 |
| .197 | 5,0 | .256 | 6,5 | 4595 | | | | | | | | | | |
| .236 | 6,0 | .413 | 10,5 | 4596 | M16 x 1,5 | cULus | .643 | 16,0 | 1.38 | 35,0 | .39 | 10,0 | .71 | 18,0 |
| .315 | 8,0 | .591 | 15,0 | 4597 | M20 x 1,5 | cULus | .747 | 20,0 | 1.46 | 37,0 | .39 | 10,0 | .94 | 24,0 |
| .492 | 12,5 | .807 | 20,5 | 4598 | M25 x 1,5 | cULus | .984 | 25,0 | 1.73 | 44,0 | .43 | 11,0 | 1.18 | 30,0 |
| .669 | 17,0 | 1.004 | 25,4 | 4599 | M32 x 1,5 | cULus | 1.260 | 32,0 | 1.81 | 46,0 | .51 | 13,0 | 1.42 | 36,0 |

Short Thread — ALL NEW PRODUCTS!

| | | | | | | | | | | | | | | |
|------|------|-------|------|--------------|-----------|-------|-------|------|------|------|-----|-----|------|------|
| .138 | 3,5 | .197 | 5,0 | 14594 | M12 x 1,5 | cULus | .472 | 12,0 | 1.06 | 27,0 | .20 | 5,0 | .59 | 15,0 |
| .197 | 5,0 | .256 | 6,5 | 14595 | | | | | | | | | | |
| .236 | 6,0 | .413 | 10,5 | 14596 | M16 x 1,5 | cULus | .630 | 16,0 | 1.18 | 30,0 | .20 | 5,0 | .71 | 18,0 |
| .315 | 8,0 | .591 | 15,0 | 14597 | M20 x 1,5 | cULus | .787 | 20,0 | 1.30 | 33,0 | .24 | 6,0 | .94 | 24,0 |
| .492 | 12,5 | .807 | 20,5 | 14598 | M25 x 1,5 | cULus | .984 | 25,0 | 1.57 | 40,0 | .28 | 7,0 | 1.18 | 30,0 |
| .669 | 17,0 | 1.004 | 25,5 | 14599 | M32 x 1,5 | cULus | 1.260 | 32,0 | 1.61 | 41,0 | .31 | 8,0 | 1.42 | 36,0 |

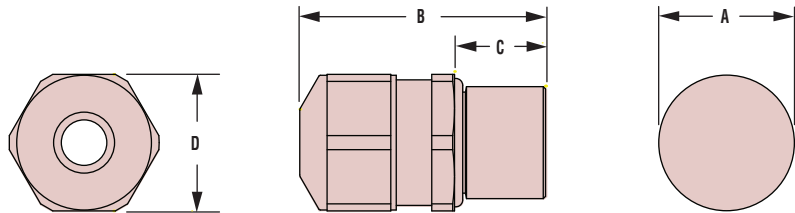

Quick Specs

| | |
|-------------------|---|
| Material | Nickel-Plated Brass W/TPE Sealing Gland |
| Certifications | cULus Recognized under the Component Program of Underwriters' Laboratories File E51579 to both Canadian and U.S. requirements |
| Temperature Range | -40°F (-40°C) to 212°F (100°C) |
| IP Rating | IP 68, IP 69K |

X-ON Electronics

Largest Supplier of Electrical and Electronic Components

Click to view similar products for [Cable Mounting & Accessories](#) category:

Click to view products by [Heyco](#) manufacturer:

Other Similar products are found below :

[582603-1](#) [009333-000](#) [727844N003](#) [747](#) [809090N001](#) [843188-000](#) [8666](#) [967279N002](#) [DB-11](#) [1300840039](#) [1300900096](#) [1301800416](#)
[1302264450](#) [1300830184](#) [1300830729](#) [1300900039](#) [1301580036](#) [1301850553](#) [1301860939](#) [1302000074](#) [1302261315](#) [1302264431](#)
[1337706-2](#) [APA18-AK](#) [1724](#) [1-787307-1](#) [185491N001](#) [1868](#) [HP-6N](#) [C-202-C](#) [202C221-13-0](#) [CA7308-000](#) [8S23-75FR-CS8184](#) [2684](#) [9648](#)
[3089](#) [988382-000](#) [A72821-000](#) [AA401](#) [173506-000](#) [202C292-13-0](#) [202C302-13-0](#) [2109](#) [300625](#) [3330](#) [3412](#) [M9142](#) [M9143](#) [529732-000](#)
[561-50D1187](#)