



- One-piece solution with smooth internal surfaces provides for easier wire routing, protection, and installation.
- Easy, permanent assembly: the installer twists the tubing over the connector ferrule.
- Unique locking fingers accommodate various panel thicknesses.
- All nylon construction is resistant to salt water, weak acids, gasoline, alcohol, oil, grease, and common solvents. (This feature is not assessed by UL certification and testing.)
- Suitable for a wide array of electrical applications:
  - Commercial and Industrial HVAC Systems
  - Motorized Equipment
  - Enclosed Power Sources
  - Garage Door Openers
  - Major Appliances
- Finishing collars available to neaten rough cut tubing ends.
- Assembly Tool available for assembling Quick Twist Fittings into HF1 and HF2 Conduit and Tubing (see page 2-14)

**Snap-In Hubs**

- Snap-in Fittings are UL recognized for use with Heyco-Flex II Tubing.
- Suitable for dry location only.

**NPT Hubs**

- NPT threaded fittings are UL approved for use with Heyco-Flex I & II Conduit and Tubing.
- If using a tapped hole, Teflon® tape is needed on the threads of the connector, for all other applications an O-ring and Locknut are needed to attain liquid tight.
- **Locknuts not included.** To order nylon or metal locknuts separately, see pages 2-17 and 2-18.
- See page 2-20 for O-Rings.

## Heyco-Flex™ Quick Twist Conduit Fittings

For use with Heyco-Flex™ I and II Conduit and Tubing  
**Straight-Thru, Snap-In and NPT Hubs**

FITS TUBING TRADE SIZE	PART NO.			DESCRIPTION	PART DIMENSIONS									
	Black	Black w/ Finishing Collar*	Gray		A Mounting Hole Dia.		B Overall Length		C Body Length		D Wrenching Nut Thickness		E Wrenching Nut Flat Size	
					in.	mm.	in.	mm.	in.	mm.	in.	mm.	in.	mm.

Snap-In Hubs - For use with Heyco-Flex™ II Tubing

1/4	8515	–	8516	HFC 1/4-S-Twist	.540	13,7	1.33	33,8	.34	8,7	.09	2,3	.75	19,1
3/8	8485	8485FC	8486	HFC 3/8-S-Twist	.875	22,2	1.38	35,0	.39	9,9	.09	2,3	1.00	25,4
1/2	8490	8490FC	8491	HFC 1/2-S-Twist										
3/4	8495	8495FC	8496	HFC 3/4-S-Twist	1.109	28,2	1.50	38,0	.39	9,9	.09	2,3	1.25	31,8

NPT Hubs - For use with Heyco-Flex™ I and II Conduit and Tubing

1/4	8517	–	8518	HFC 1/4-Twist	.540	13,7	1.56	39,6	.47	11,8	.20	5,1	.75	19,1
3/8	8487	8487FC	8488	HFC 3/8-Twist	.875	22,2	1.72	43,7	.63	15,9	.20	5,1	1.18	30,0
1/2	8493	8493FC	8494	HFC 1/2-Twist										
3/4	8497	8497FC	8498	HFC 3/4-Twist	1.109	27,8	1.84	46,7	.63	15,9	.20	5,1	1.37	34,8

Standard colors black and gray.

\*Collar not assembled.

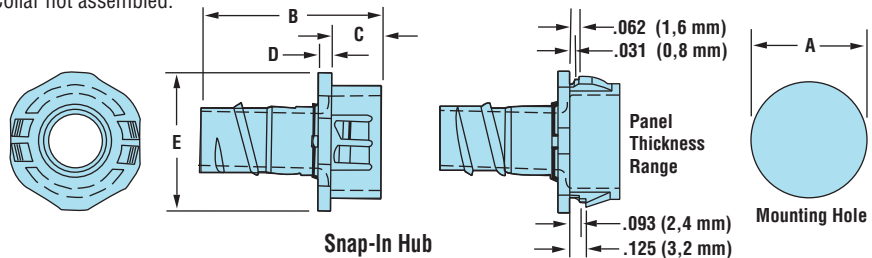

NPT Hub

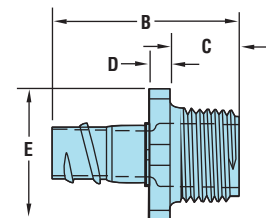
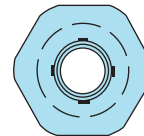

SU

## Heyco-Flex™ Quick Twist Finishing Collars

For use with Heyco-Flex™ I and II Conduit



FITS CONDUIT/ TRADE SIZE	PART NO.		DESCRIPTION
	Black	Gray	
3/8	8474	8482	HFC TWIST 3/8 COLLAR
1/2	8475	8483	HFC TWIST 1/2 COLLAR
3/4	8476	8484	HFC TWIST 3/4 COLLAR

Standard colors black and gray. Consult Heyco for other colors. (Not available in 1/4").

Material	Nylon 6/6
Certifications	Recognized under the Component Program of Underwriters' Laboratories File E121095 (Snap-in Hubs) UL Listed under Underwriters' Laboratories File E28430 (NPT Hubs)
Flammability Rating	94V-2
Temperature Range	-22°F (-30°C) to 221°F (105°C)

## X-ON Electronics

Largest Supplier of Electrical and Electronic Components

*Click to view similar products for [Conduit Fittings & Accessories](#) category:*

*Click to view products by [Heyco](#) manufacturer:*

Other Similar products are found below :

[M3231GAB](#) [M3231GAC](#) [M3231GAE](#) [M3231GL](#) [M3231GN](#) [M3231GT](#) [VC-937-16/RED](#) [VC-562-16/RED](#) [VC-1125-16/RED](#) [DM0240-1/2A](#) [3408B](#) [G6002](#) [M4340GAE](#) [C2016-P](#) [C2012-P](#) [3407B](#) [1660-P](#) [561-87BG11BLK](#) [561-75BG11B](#) [BVNV-P428](#) [BVBV-P366](#) [2276](#) [2663-P](#) [3405B](#) [C2070-P](#) [3582V](#) [4975](#) [2644-P](#) [2955](#) [M50](#) [2404-P](#) [2291](#) [2133-P](#) [3048F](#) [VC12516](#) [RC156-0500](#) [DM0523-1/2A](#) [1035A](#) [DMS0250-1A](#) [DMS0313-1A](#) [1040A](#) [1050A](#) [R1/8A](#) [DMPC0490-1/2A](#) [DMPC0521-1/2A](#) [DMPC0552-1/2A](#) [1070A](#) [R1/2A](#) [E1-7/8B](#) [061A](#) [R3/4A](#)