

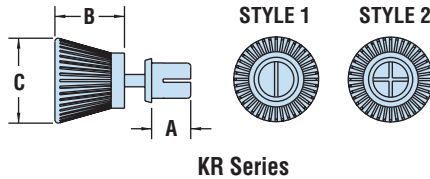

HEYClip™ Releasable Type T Rivets

| WILL FIT THESE PANELS | | | | PART NO. | | DESCRIPTION | PART DIMENSIONS | | | | | | STYLE | | | |
|-----------------------|---------------------------|-----|------|----------|-------|-------------|-----------------|------------|-------------|---------------|-----|-----|-------|------|-----|--|
| MOUNTING HOLE DIA. | ASSEMBLED PANEL THICKNESS | | | | Black | | White | A | | B | | C | | | | |
| | in. | mm. | Min. | Max. | | | | Length | Head Height | Head Diameter | in. | mm. | | in. | mm. | |
| KR Series | | | | | | | | | | | | | | | | |
| .122 | 3,1 | .04 | 1,0 | .08 | 2,0 | 9088 | 9089 | KR 122-039 | .14 | 3,5 | | | | | | |
| | | .08 | 2,0 | .12 | 3,0 | 9090 | 9091 | KR 122-079 | .18 | 4,5 | | | | | | |
| | | .12 | 3,0 | .16 | 4,0 | 9092 | 9093 | KR 122-118 | .22 | 5,5 | | | | | | |
| | | .16 | 4,0 | .20 | 5,0 | 9094 | 9095 | KR 122-157 | .26 | 6,5 | .32 | 8,0 | .39 | 10,0 | 1 | |
| | | .20 | 5,0 | .24 | 6,0 | 9194 | 9195 | KR 122-197 | .30 | 7,5 | | | | | | |
| | | .22 | 5,5 | .26 | 6,5 | 9096 | 9097 | KR 122-217 | .32 | 8,0 | | | | | | |
| .142 | 3,6 | .04 | 1,0 | .08 | 2,0 | 9098 | 9099 | KR 142-039 | .14 | 3,5 | | | | | | |
| | | .08 | 2,0 | .12 | 3,0 | 9100 | 9101 | KR 142-079 | .18 | 4,5 | | | | | | |
| | | .12 | 3,0 | .16 | 4,0 | 9102 | 9103 | KR 142-118 | .22 | 5,5 | | | | | | |
| | | .14 | 3,5 | .18 | 4,5 | 9104 | 9105 | KR 142-137 | .24 | 6,0 | .32 | 8,0 | .39 | 10,0 | 2 | |
| | | .18 | 4,5 | .22 | 5,5 | 9106 | 9107 | KR 142-177 | .28 | 7,0 | | | | | | |
| | | .22 | 5,5 | .26 | 6,5 | 9196 | 9197 | KR 142-217 | .32 | 8,0 | | | | | | |
| .161 | 4,1 | .10 | 2,5 | .14 | 3,5 | 9108 | 9109 | KR 161-098 | .20 | 5,0 | | | | | | |
| | | .14 | 3,5 | .18 | 4,5 | 9110 | 9111 | KR 161-137 | .24 | 6,0 | | | | | | |
| | | .18 | 4,5 | .22 | 5,5 | 9112 | 9113 | KR 161-177 | .28 | 7,0 | | | | | | |
| | | .22 | 5,5 | .26 | 6,5 | 9114 | 9115 | KR 161-217 | .32 | 8,0 | .32 | 8,0 | .47 | 12,0 | 2 | |
| | | .26 | 6,5 | .30 | 7,5 | 9198 | 9199 | KR 161-256 | .35 | 9,0 | | | | | | |
| | | .30 | 7,5 | .34 | 8,5 | 9116 | 9117 | KR 161-295 | .39 | 10,0 | | | | | | |

Standard colors black and white.



- The “T” style rivet is designed with a **large finger grip**, knob-shaped head for optimal installation and removal by simply pushing or pulling the rivet from the hole.
- Can be used multiple times.
- Part Description Key: KR X-Y where X = Mounting Hole Diameter (inches) and Y = minimum Panel Thickness (inches).
- Standard Material: Nylon 6. Nylon 6/6 UL 94V-0 available by special order, consult Heyco.
- Standard Pack - 1,000/bag.

HEYClip™ Type P Snap Rivets

Polysulfone High Temperature Snap Rivets



| WILL FIT THESE PANELS | | | | PART NO. | | DESCRIPTION | PART DIMENSIONS | | | | | | STYLE | | |
|-----------------------|---------------------------|------|------|----------|-------|-------------|-----------------|-----|-----|--------|-------------|---------------|-------|-----|-----|
| MOUNTING HOLE DIA. | ASSEMBLED PANEL THICKNESS | | | | Black | | A | B | C | Length | Head Height | Head Diameter | | | |
| | in. | mm. | Min. | Max. | | | | | | | | | | in. | mm. |
| PRP Series | | | | | | | | | | | | | | | |
| .122 | 3,1 | .078 | 2,0 | .118 | 3,0 | 9349 | PRP 122-079 | .18 | 4,5 | | | | | | |
| | | .118 | 3,0 | .157 | 4,0 | 9350 | PRP 122-118 | .22 | 5,6 | .06 | 1,6 | .25 | 6,4 | 1 | |
| | | .157 | 4,0 | .197 | 5,0 | 9351 | PRP 122-157 | .26 | 6,5 | .04 | 1,0 | .28 | 7,0 | 2 | |

Standard color black.

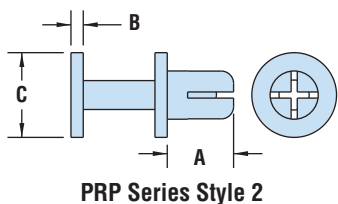
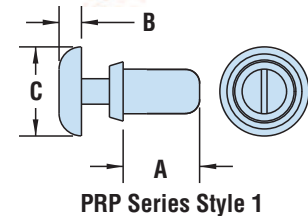

| | KR Series | PRP |
|---------------------|-------------------------------|-----------------------------|
| Material | Nylon 6 | Polysulfone (PSU) |
| Flammability Rating | 94V-2 | 94-HB |
| Temperature Range | -.4°F (-18°C) to 185°F (85°C) | 32°F (0°C) to 302°F (150°C) |

X-ON Electronics

Largest Supplier of Electrical and Electronic Components

Click to view similar products for [Screws & Fasteners](#) category:

Click to view products by [Heyco](#) manufacturer:

Other Similar products are found below :

[5721-1440-1/4-SS](#) [593503FX](#) [0098.0094](#) [0098.9206](#) [0098.9219](#) [0098.9262](#) [596-2114-013](#) [59781-6](#) [0098.0026](#) [0098.9210](#) [0098.9212](#) [60227-01](#) [60227-04](#) [60227-08](#) [60687-01](#) [LOCK WASHER Black](#) [62153-03](#) [62153-11](#) [M316-KSSTMCZ100](#) [M3440-SS](#) [M3442-SS](#) [M3448-SS](#) [6292-1](#) [6-306105-9](#) [6-306131-4](#) [690432-1](#) [699161-000](#) [7230-3](#) [7244](#) [7248-1](#) [7248-2](#) [745564-1](#) [F1209](#) [751-00001](#) [7680](#) [809704-1](#) [8700](#) [8860220](#) [9047](#) [9521](#) [992326-6](#) [992763-3](#) [1-18024-0](#) [1-18028-2](#) [A168P1](#) [A495P1](#) [1-24921-1](#) [125416-1](#) [1260](#) [13-0036](#) [1301810148](#)