

Aug.1.2021 Copyright 2021 HIROSE ELECTRIC CO., LTD. All Rights Reserved.  
In case of consideration for using Automotive equipment / device which demand high reliability, kindly contact our sales window correspondents.

| COUNT | DESCRIPTION OF REVISIONS | B | Y | CHKD | DATE | COUNT | DESCRIPTION OF REVISIONS | B | Y | CHKD | DATE |
|-------|--------------------------|---|---|------|------|-------|--------------------------|---|---|------|------|
| △     |                          |   |   |      |      | △     |                          |   |   |      |      |
| △     |                          |   |   |      |      | △     |                          |   |   |      |      |
| △     |                          |   |   |      |      | △     |                          |   |   |      |      |

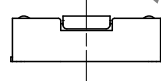
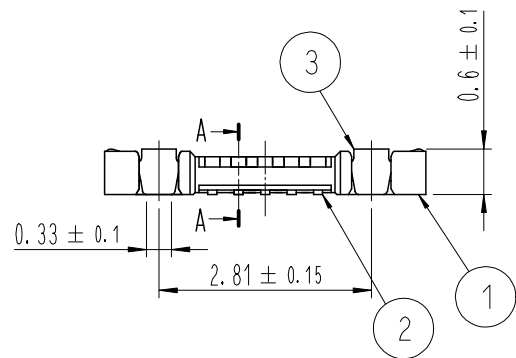
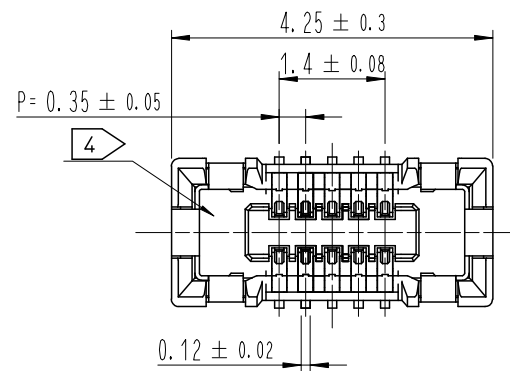

HRS DRAWING FOR REFERENCE

DRAWING FOR REFERENCE  
This is subject to change without notice

A-A (50:1)

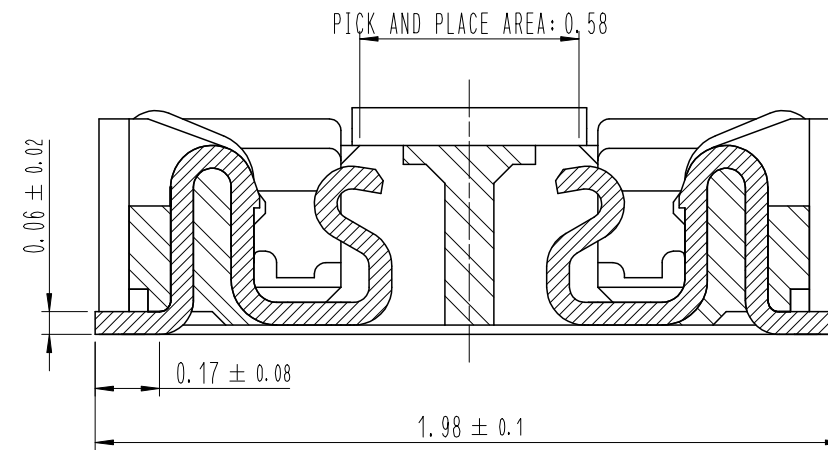

ENGAGEMENT FIGURE (50:1)

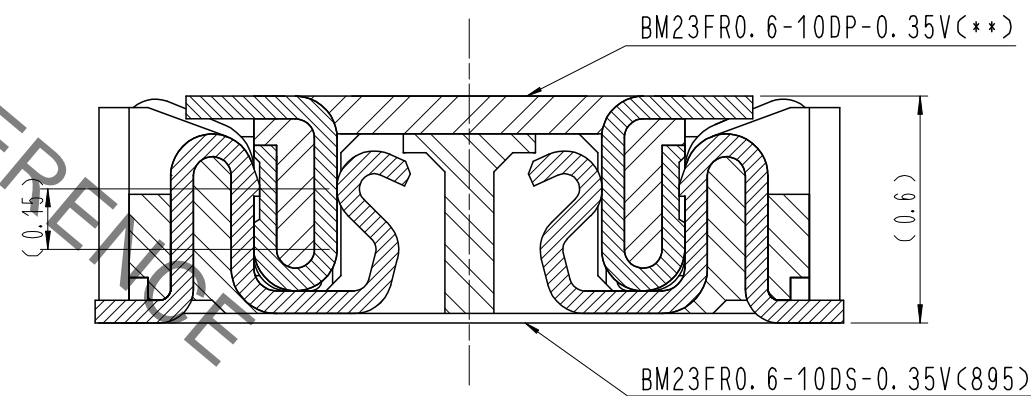

- NOTE
- 1 . ALL LEAD CO-PLANARITY SHALL BE 0.08mm MAX.
  - 2 > CONTACT PLATING SPECIFICATIONS.  
CONTACT AREA : GOLD 0.05 μm MIN.  
SMT LEAD : GOLD 0.05 μm MIN.  
UNDERPLATING : NICKEL 1 μm MIN.  
( SURFACE : SEALING )
  - 3 > MATAL FITTING PLATING SPECIFICATIONS.  
SMT LEAD : GOLD 0.05 μm MIN.  
UNDERPLATING : NICKEL 1 μm MIN.  
( SURFACE : SEALING )
  - 4 > HRS MARK AND CAV NO. ARE INDICATED IN APPROX POSITION SHOWN.

| 4   | PS           | CLEAR (EMBOSSD CARRIER TAPE) |     |           |                              |
|-----|--------------|------------------------------|-----|-----------|------------------------------|
| 3   | COPPER ALLOY | 3 >                          | 7   | PS        | CLEAR (REINFORCEMENT COLLAR) |
| 2   | COPPER ALLOY | 2 >                          | 6   | PS        | BLACK (PLASTIC REEL)         |
| 1   | LCP          | UL94 V-0, BLACK              | 5   | POLYESTER | CLEAR (COVER TAPE)           |
| NO. | MATERIAL     | FINISH , REMARKS             | NO. | MATERIAL  | FINISH , REMARKS             |

| REMARKS |  | DRAWN      | DESIGNED   | CHECKED    | APPROVED   | RELEASED   |
|---------|--|------------|------------|------------|------------|------------|
|         |  | S. H. JUNG | S. H. JUNG | H. W. JO   | T. S. KANG | 17. 05. 08 |
|         |  | 17. 05. 08 | 17. 05. 08 | 17. 05. 08 | 17. 05. 08 |            |

|                |       |                            |             |          |                           |
|----------------|-------|----------------------------|-------------|----------|---------------------------|
| CODE NO. (OLD) |       | DRAWING NO.                | EDC3-631862 | PART NO. | BM23FR0.6-10DS-0.35V(895) |
|                | SCALE | HRS HIROSE KOREA CO., LTD. |             | CODE NO  | CL 6644-0011-0-895        |
|                | 10:1  |                            |             |          | 1/3                       |
|                | UNITS |                            |             |          |                           |
|                | mm    |                            |             |          |                           |

Aug.1.2021 Copyright 2021 HIROSE ELECTRIC CO., LTD. All Rights Reserved.  
In case of consideration for using Automotive equipment / device which demand high reliability, kindly contact our sales window correspondents.

6 RECOMMENDED PCB LAYOUT

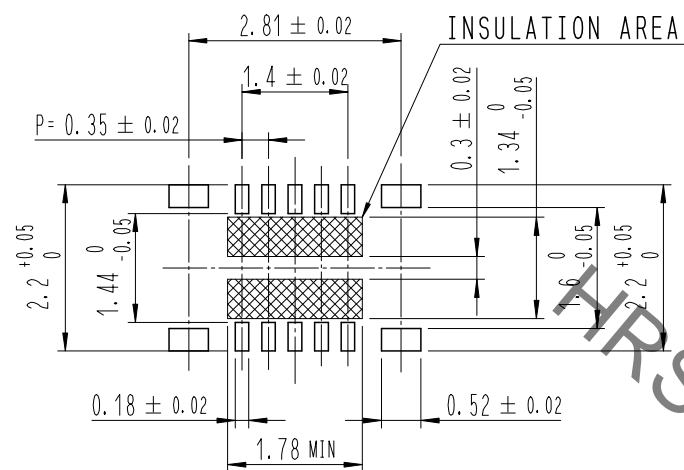

RECOMMENDED METAL MASK DIMENSIONS  
METAL MASK THICKNESS : 100 μm

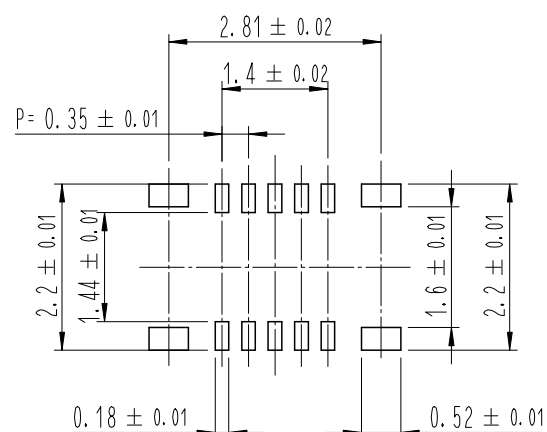

5 RECOMMENDED REFLOW TEMPERATURE PROFILE USING LEAD-FREE SOLDER PASTE.

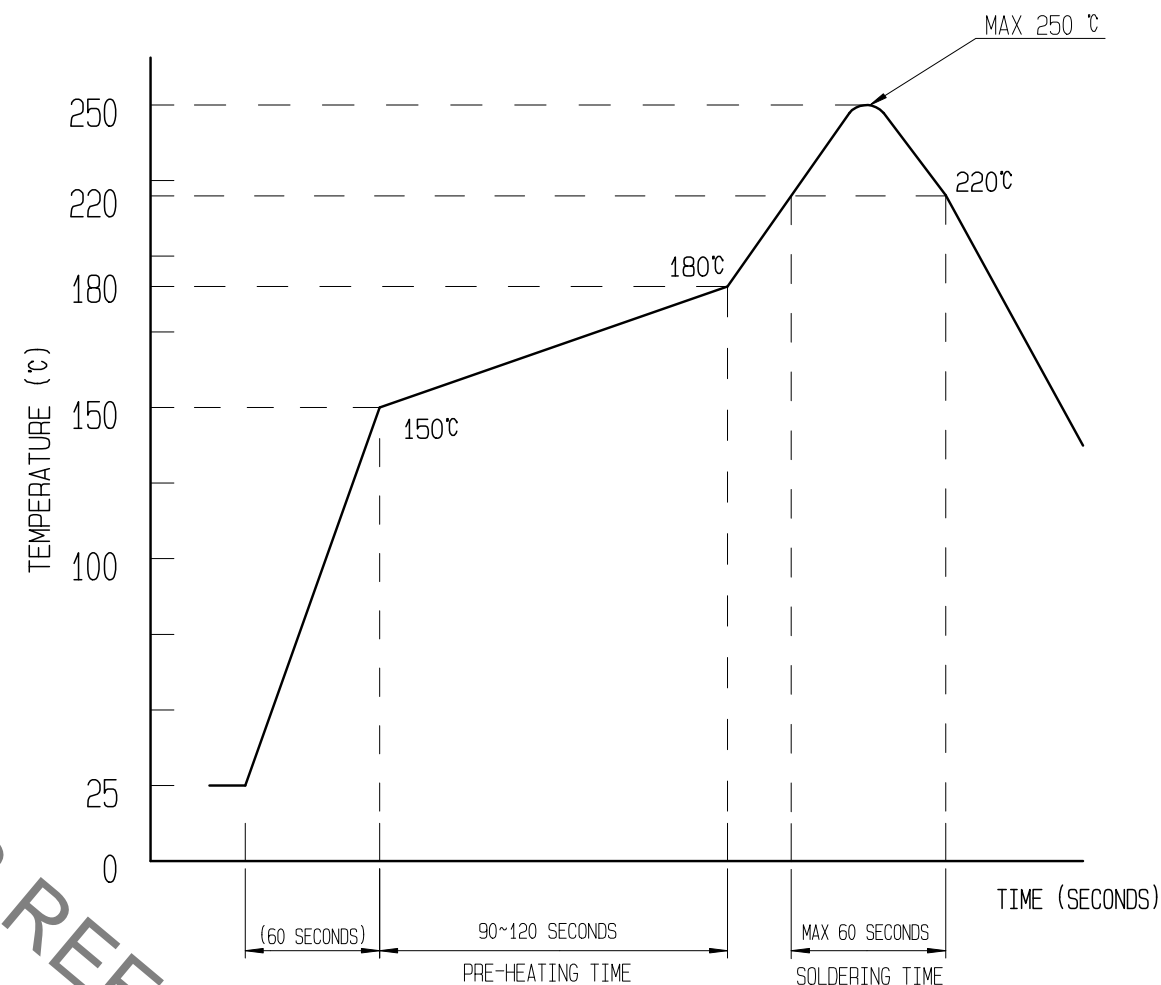

REFLOW METHOD: N2 REFLOW  
NUMBER OF REFLOW CYCLES: 2 CYCLES MAX.  
1) REFLOW TIME  
DURATION ABOVE 220°C: 60 SEC MAX.  
(PEAK TEMPERATURE: 250°C MAX)  
2) PRE-HEAT TIME  
PRE-HEAT TEMPERATURE(MIN): 150°C  
PRE-HEAT TEMPERATURE(MAX): 180°C  
PRE-HEAT TIME: 90-120 SEC.

- 5 THIS TEMPERATURE PROFILE IS PER THE CONDITIONS SHOWN ABOVE. ADDITIONAL FACTORS, SUCH AS SOLDER PASTE TYPE, PCB SIZE AND OTHER MOUNTED COMPONENTS COULD AFFECT THE PROFILE. THEREFORE, A THOROUGH EVALUATION OF MOUNTING CONDITION IS REQUIRED PRIOR TO PRODUCTION. TEMPERATURE IS MEASURED AT CONTACT LEAD.
- 6 PLEASE CONTACT US IN CASE YOU WILL MAKE DIFFERENT SETTINGS FROM OUR RECOMMENDATION.

|       |             |             |                            |                           |     |
|-------|-------------|-------------|----------------------------|---------------------------|-----|
|       | DRAWING NO. | EDC3-631862 | PART NO.                   | BM23FR0.6-10DS-0.35V(895) |     |
|       | SCALE       | 10:1        | CODE NO                    | CL 6644-0011-0-895        | 2/3 |
| UNITS | mm          |             | HRS HIROSE KOREA CO., LTD. |                           |     |

Aug.1.2021 Copyright 2021 HIROSE ELECTRIC CO., LTD. All Rights Reserved.  
In case of consideration for using Automotive equipment / device which demand high reliability, kindly contact our sales window correspondents.

STYLE AND DIMENTION OF REEL (FREE)

EMBOSSED CARRIER TAPE PACKAGING (5:1)

C-C (5:1)

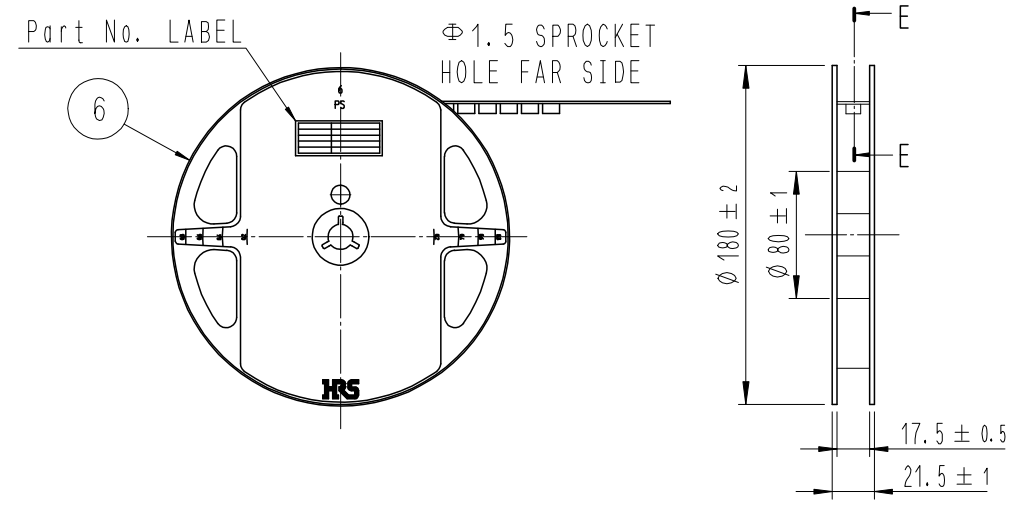
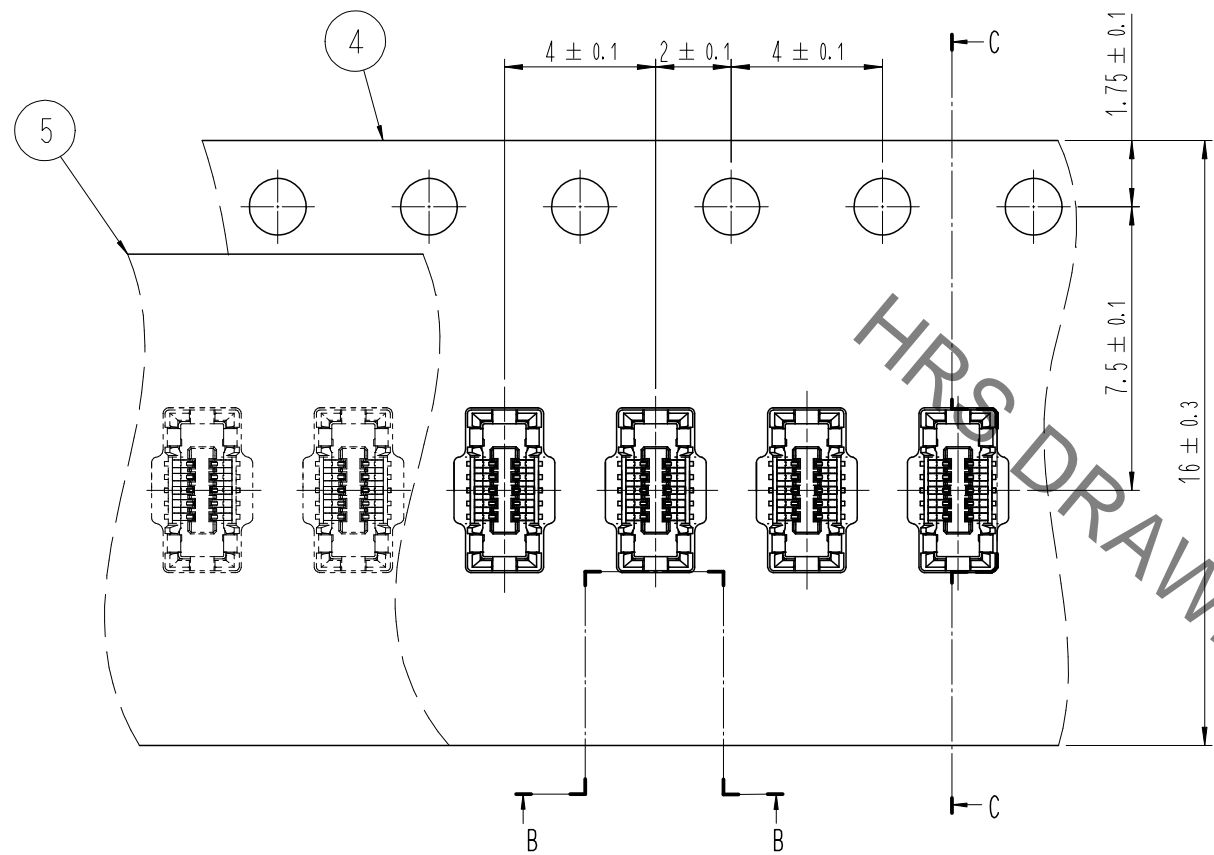

E-E (FREE)

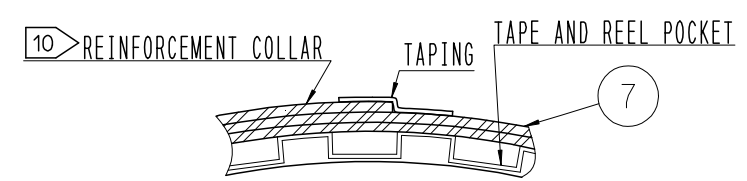

B-B (5:1)

DIRECTION OF UNREELING

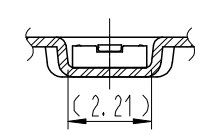

9 TAPING(FREE)

D (10:1)

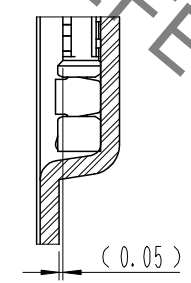

DETAIL OF PART No. LABEL

|          |                           |          |              |                      |
|----------|---------------------------|----------|--------------|----------------------|
| SUPPLIER | QUANTITY                  | PART NO. | CODE NO.     | DATE OF MANUFACTURED |
| 生産月日     | 年月日                       | 図番       | ** ** *      |                      |
| 品名       | BM23FR0.6-10DS-0.35V(895) | 納入数量     | 1,000個       | 納入者                  |
|          |                           |          | HIROSE KOREA |                      |

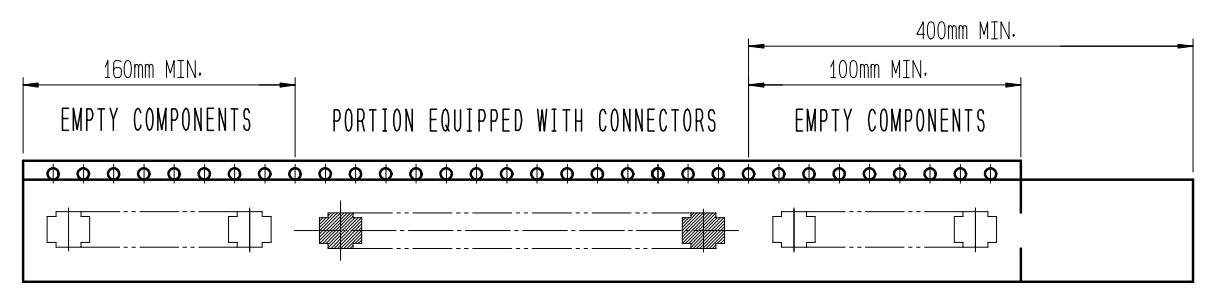

- 7 . PER REEL 1,000 CONNECTORS.
- 8 . THE DIMENSIONS IN PARENTHESES ARE FOR REFERENCE.
- 9 REFER TO JIS C 0806, IEC-60286-3 (PACKAGING OF COMPONENTS FOR AUTOMATIC HANDLING)
- 10 AFTER PACKAGING, ROLL 2 METERS OF THE REINFORCEMENT COLLAR TO OUTER CIRCUMFERENCE OF TAPE AND REEL POCKET. AND TAPE DOWN AT THE END THE COLLAR.

|                            |                                       |                                |     |
|----------------------------|---------------------------------------|--------------------------------|-----|
| DRAWING NO.<br>EDC3-631862 | PART NO.<br>BM23FR0.6-10DS-0.35V(895) | CODE NO.<br>CL 6644-0011-0-895 | 3/3 |
|                            |                                       |                                |     |
| HIROSE KOREA CO., LTD.     |                                       |                                |     |

## X-ON Electronics

Largest Supplier of Electrical and Electronic Components

*Click to view similar products for [Board to Board & Mezzanine Connectors](#) category:*

*Click to view products by [Hirose](#) manufacturer:*

Other Similar products are found below :

[589158040000018](#) [MDF7C-18P-2.54DSA\(55\)](#) [FCN-230C068-11](#) [FCN-268F012-G/BD](#) [FCN-268F036-G/BD](#) [FCN-268M012-G/0D](#) [FCN-268M024-G/1D](#) [FCN-723J004/1](#) [MIS-048-01-F-D-DP-K](#) [832-10-034-10-001000](#) [FX4C-80S-1.27DSA](#) [FCN-214Q030-G/0](#) [FCN-234P048-G/0](#) [FCN-235D050-G/C](#) [210-93-314-41-105000](#) [2-22603-0](#) [MDF7-40DP-2.54DSA\(55\)](#) [AXG720047](#) [MIT-114-03-F-D-K](#) [55323-1519](#) [DF33-2P-3.3DSA\(24\)](#) [YFT-20-05-H-03-SB-K](#) [503308-3040](#) [026-6203-PDB](#) [027-6203-PDB](#) [069159702701000](#) [10123981-102LF](#) [101A10019X](#) [55650-0588-C](#) [68682-310LF](#) [68684-306](#) [75140-7012](#) [87471-650](#) [YTW-30-07-H-Q-410-140](#) [FCN-268F024-G0D](#) [10124054-515LF](#) [68685-603](#) [8-1616154-3](#) [MIS-019-01-F-D](#) [FCN-268M024-G/3D](#) [FCN-268M036-G/BD](#) [20021832-06016C1LF](#) [KX15-20KLDL-E1000E](#) [AXE810124](#) [FCN-214J100-G/0](#) [FCN-230C068-E/S](#) [AXE812124](#) [AXE816124](#) [AXE720127](#) [354184](#)