

Jul.1.2021 Copyright 2021 HIROSE ELECTRIC CO., LTD. All Rights Reserved.  
 In case of consideration for using Automotive equipment / device which demand high reliability, kindly contact our sales window correspondents.

| COUNT | DESCRIPTION OF REVISIONS | B     | Y     | CHKD | DATE     | COUNT | DESCRIPTION OF REVISIONS | B | Y | CHKD | DATE |
|-------|--------------------------|-------|-------|------|----------|-------|--------------------------|---|---|------|------|
| 3     | RE-6-0649                | J.S.H | J.H.W |      | 16.06.23 |       |                          |   |   |      |      |
|       |                          |       |       |      |          |       |                          |   |   |      |      |
|       |                          |       |       |      |          |       |                          |   |   |      |      |

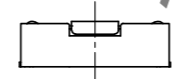
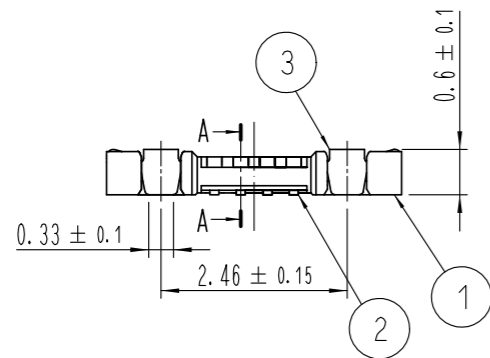
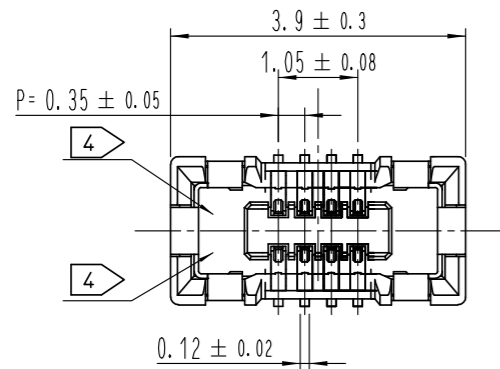

HRS DRAWING FOR REFERENCE

A-A (50:1)

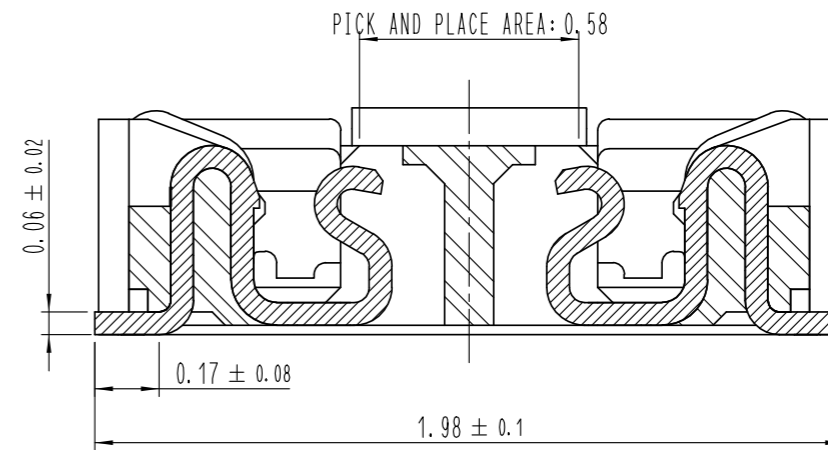

ENGAGEMENT FIGURE (50:1)

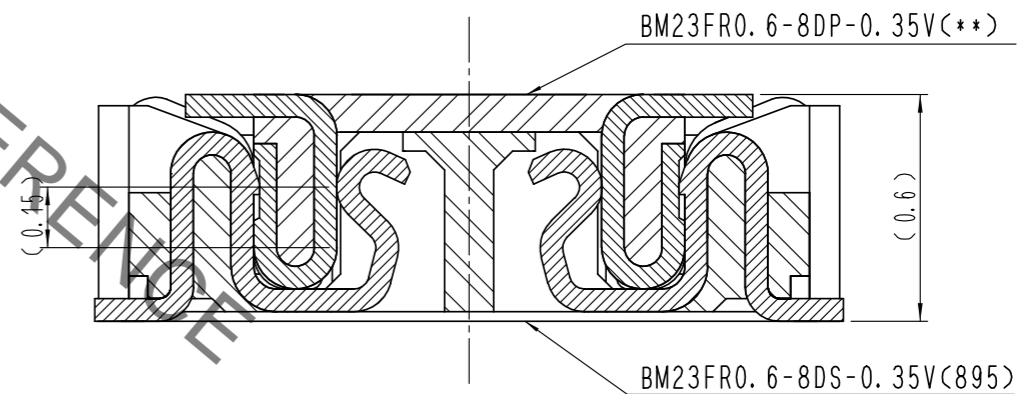

- NOTE
- 1 . ALL LEAD CO-PLANARITY SHALL BE 0.08mm MAX.
  - 2 CONTACT PLATING SPECIFICATIONS.  
 CONTACT AREA : GOLD 0.05 μm MIN.  
 SMT LEAD : GOLD 0.05 μm MIN.  
 UNDERPLATING : NICKEL 1 μm MIN.  
 ( SURFACE : SEALING )
  - 3 MATAL FITTING PLATING SPECIFICATIONS.  
 SMT LEAD : GOLD 0.05 μm MIN.  
 UNDERPLATING : NICKEL 1 μm MIN.  
 ( SURFACE : SEALING )
  - 4 HRS MARK AND CAV NO. ARE INDICATED IN APPROX POSITION SHOWN.

| 4              | PS                         | CLEAR (EMBOSSD CARRIER TAPE) |                                   |            |                              |
|----------------|----------------------------|------------------------------|-----------------------------------|------------|------------------------------|
| 3              | PHOSPHOR BRONZE            | 3                            | 7                                 | PS         | CLEAR (REINFORCEMENT COLLAR) |
| 2              | PHOSPHOR BRONZE            | 2                            | 6                                 | PS         | BLACK (PLASTIC REEL)         |
| 1              | LCP                        | UL94 V-0, BLACK              | 5                                 | POLYESTER  | CLEAR (COVER TAPE)           |
| NO.            | MATERIAL                   | FINISH, REMARKS              | NO.                               | MATERIAL   | FINISH, REMARKS              |
| REMARKS        |                            |                              | DRAWN                             | DESIGNED   | CHECKED                      |
|                |                            |                              | J. S. PARK                        | J. S. PARK | H. W. JO                     |
|                |                            |                              | 17.08.09                          | 17.08.09   | 17.08.09                     |
|                |                            |                              | APPROVED                          | RELEASED   |                              |
|                |                            |                              | T. S. KANG                        |            | 17.08.09                     |
| CODE NO. (OLD) | DRAWING NO. EDC3-632161    |                              | PART NO. BM23FR0.6-8DS-0.35V(895) |            |                              |
| SCALE 10:1     | HRS HIROSE KOREA CO., LTD. |                              | CODE NO. CL 6644-0075-3-895       |            | 1/3                          |
| UNITS mm       |                            |                              |                                   |            |                              |

Jul.1.2021 Copyright 2021 HIROSE ELECTRIC CO., LTD. All Rights Reserved.  
 In case of consideration for using Automotive equipment / device which demand high reliability, kindly contact our sales window correspondents.

6 RECOMMENDED PCB LAYOUT

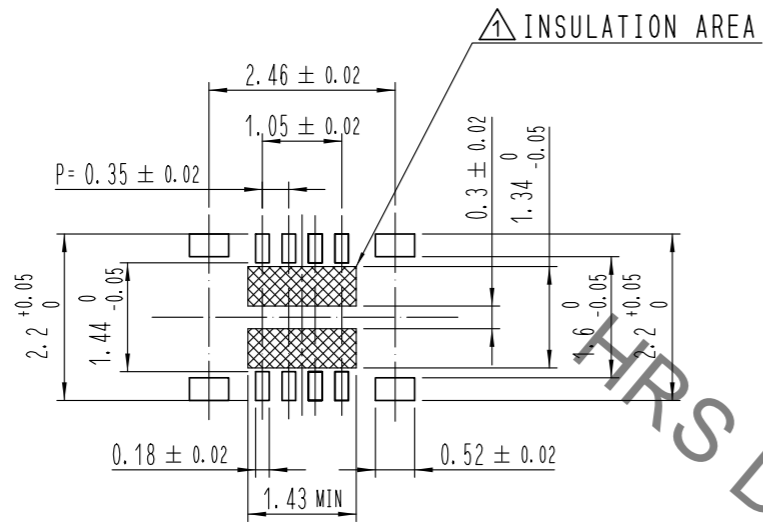

RECOMMENDED METAL MASK DIMENSIONS  
 METAL MASK THICKNESS : 100 μm

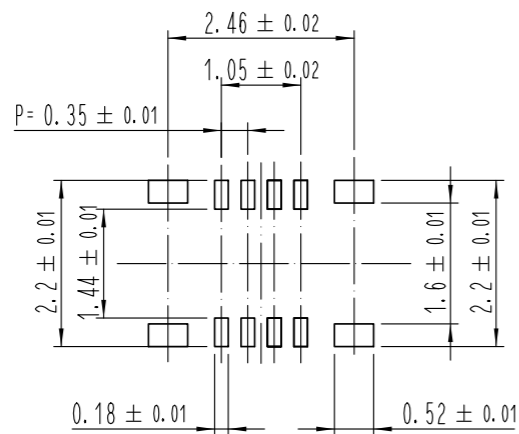

5 RECOMMENDED REFLOW TEMPERATURE PROFILE USING LEAD-FREE SOLDER PASTE.

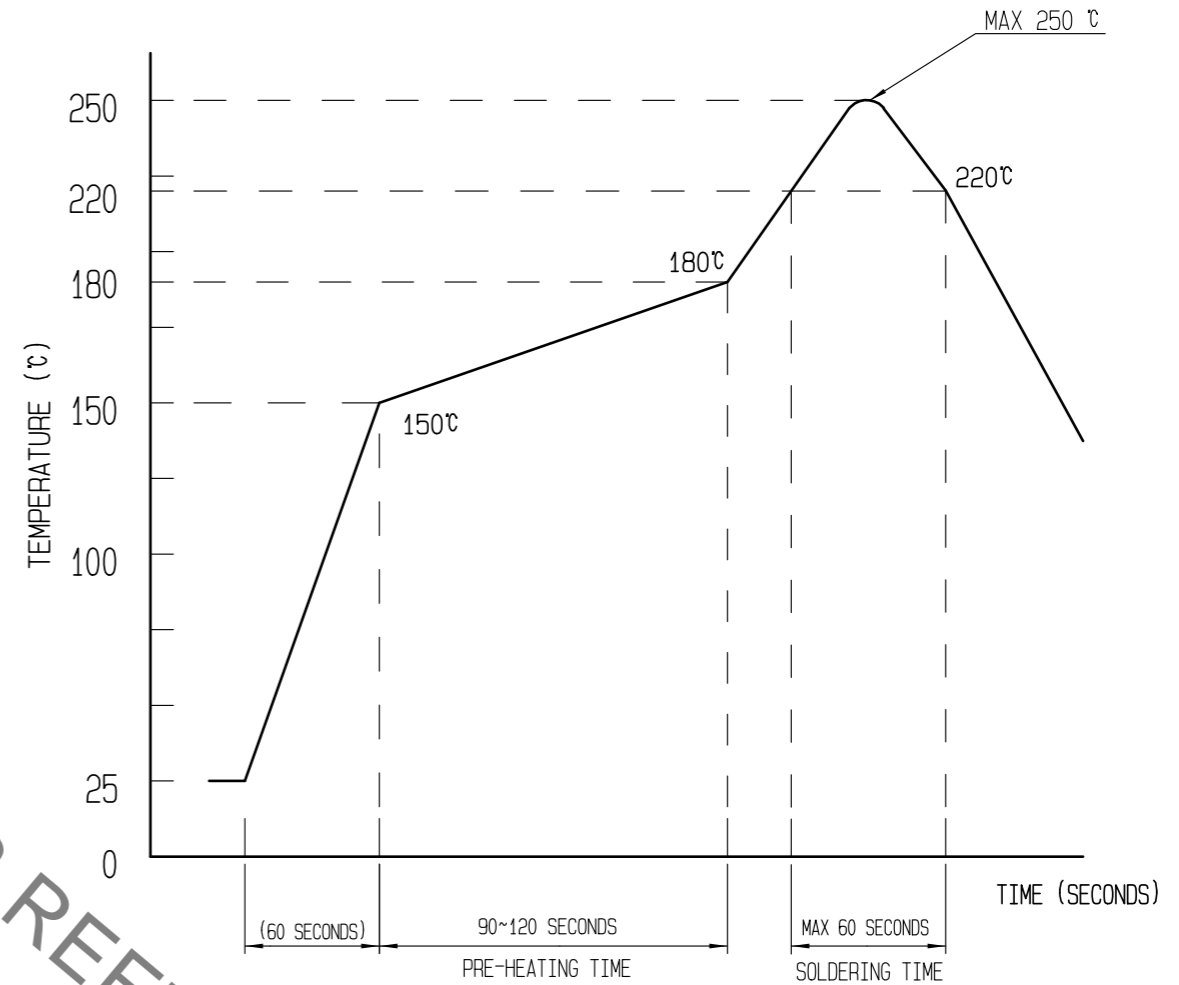

REFLOW METHOD: N<sub>2</sub> REFLOW  
 NUMBER OF REFLOW CYCLES: 2 CYCLES MAX.  
 1) REFLOW TIME  
 DURATION ABOVE 220°C: 60 SEC MAX.  
 (PEAK TEMPERATURE: 250°C MAX)  
 2) PRE-HEAT TIME  
 PRE-HEAT TEMPERATURE(MIN): 150°C  
 PRE-HEAT TEMPERATURE(MAX): 180°C  
 PRE-HEAT TIME: 90-120 SEC.

- 5 THIS TEMPERATURE PROFILE IS PER THE CONDITIONS SHOWN ABOVE. ADDITIONAL FACTORS, SUCH AS SOLDER PASTE TYPE, PCB SIZE AND OTHER MOUNTED COMPONENTS COULD AFFECT THE PROFILE. THEREFORE, A THOROUGH EVALUATION OF MOUNTING CONDITION IS REQUIRED PRIOR TO PRODUCTION. TEMPERATURE IS MEASURED AT CONTACT LEAD.
- 6 PLEASE CONTACT US IN CASE YOU WILL MAKE DIFFERENT SETTINGS FROM OUR RECOMMENDATION.

|                            |                         |                                   |     |
|----------------------------|-------------------------|-----------------------------------|-----|
| <br>SCALE 10:1<br>UNITS mm | DRAWING NO. EDC3-632161 | PART NO. BM23FR0.6-8DS-0.35V(895) | 2/3 |
|                            | HIROSE KOREA CO., LTD.  |                                   |     |

Jul.1.2021 Copyright 2021 HIROSE ELECTRIC CO., LTD. All Rights Reserved.  
 In case of consideration for using Automotive equipment / device which demand high reliability, kindly contact our sales window correspondents.

STYLE AND DIMENTION OF REEL (FREE)

EMBOSSED CARRIER TAPE PACKAGING (5:1)

C-C (5:1)

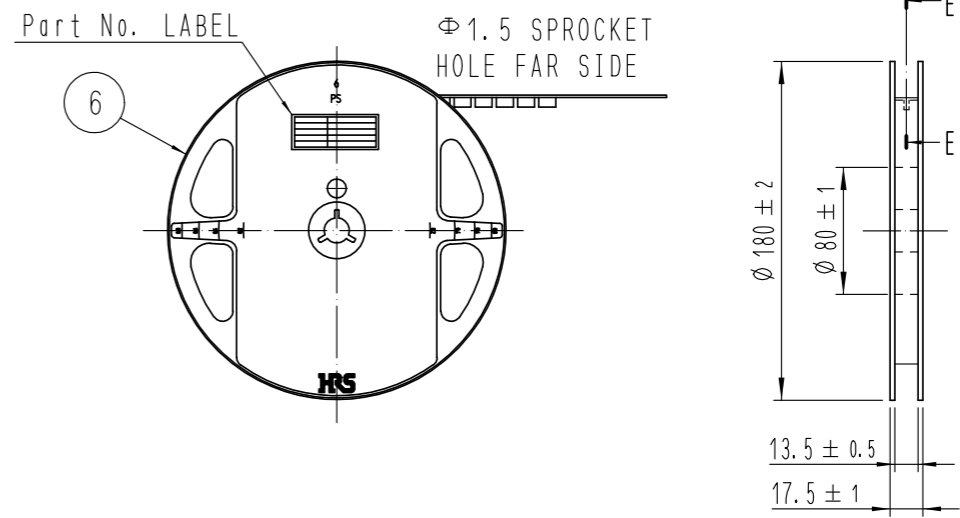
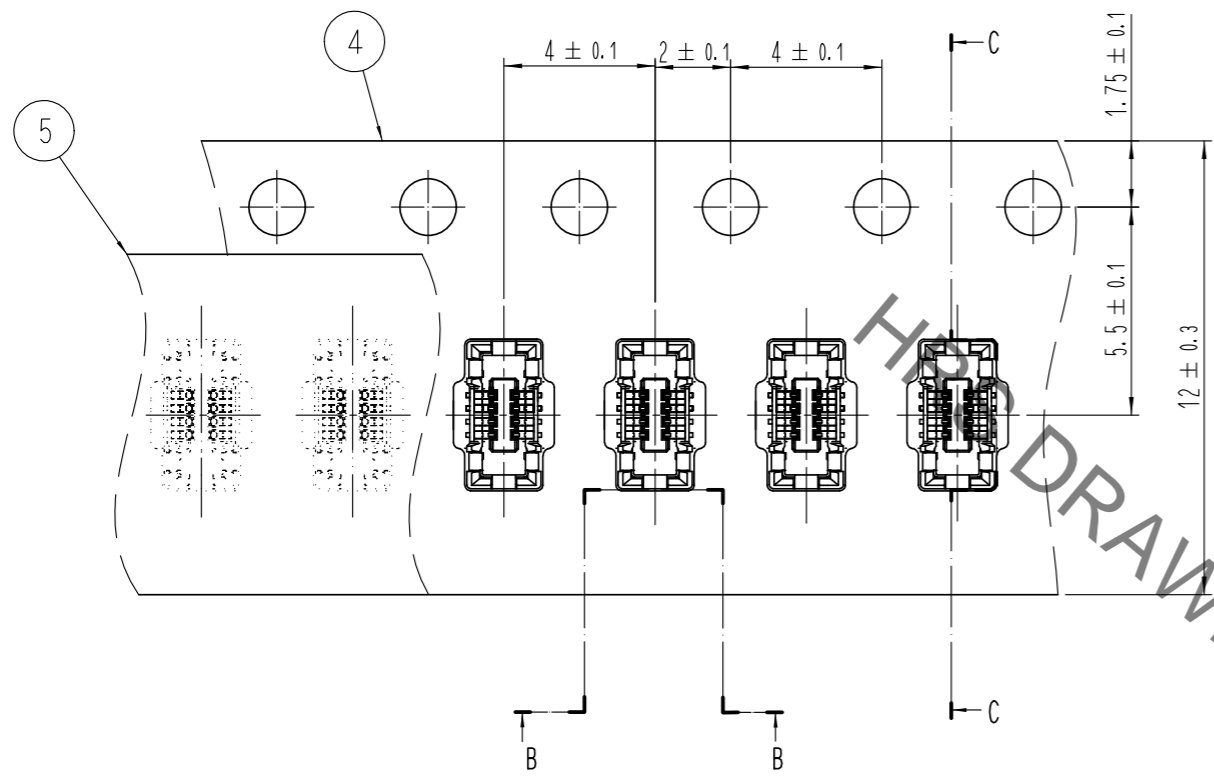

E-E (FREE)

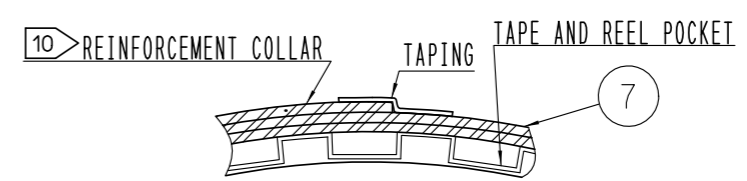

B-B (5:1)

DIRECTION OF UNREELING



9 TAPING(FREE)

D (10:1)

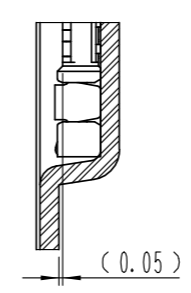

DETAIL OF PART No. LABEL

|                      |                          |
|----------------------|--------------------------|
| SUPPLIER             |                          |
| QUANTITY             |                          |
| PART NO.             |                          |
| CODE NO.             |                          |
| DATE OF MANUFACTURED |                          |
| 生産月日                 | 年 月 日                    |
| 図番                   | ** ** *                  |
| 品名                   | BM23FR0.6-8DS-0.35V(895) |
| 納入数量                 | 1,000個                   |
| 納入者                  | HIROSE KOREA             |

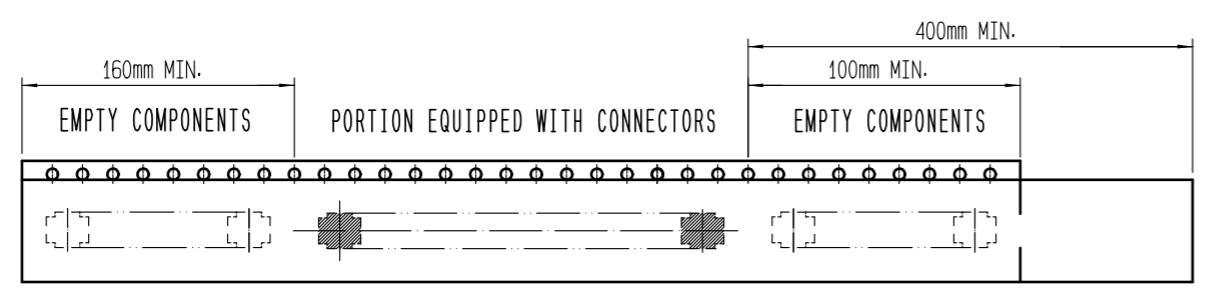

- 7 . PER REEL 1,000 CONNECTORS.
- 8 . THE DIMENSIONS IN PARENTHESES ARE FOR REFERENCE.
- 9 REFER TO JIS C 0806, IEC-60286-3 (PACKAGING OF COMPONENTS FOR AUTOMATIC HANDLING)
- 10 AFTER PACKAGING, ROLL 2 METERS OF THE REINFORCEMENT COLLAR TO OUTER CIRCUMFERENCE OF TAPE AND REEL POCKET. AND TAPE DOWN AT THE END THE COLLAR.

|                                  |                        |             |          |                          |
|----------------------------------|------------------------|-------------|----------|--------------------------|
| <br>SCALE<br>10:1<br>UNITS<br>mm | DRAWING NO.            | EDC3-632161 | PART NO. | BM23FR0.6-8DS-0.35V(895) |
|                                  | HIROSE KOREA CO., LTD. |             | CODE NO. | CL 6644-0075-3-895       |

3/3

## X-ON Electronics

Largest Supplier of Electrical and Electronic Components

*Click to view similar products for [Board to Board & Mezzanine Connectors](#) category:*

*Click to view products by [Hirose](#) manufacturer:*

Other Similar products are found below :

[589158040000018](#) [MDF7C-18P-2.54DSA\(55\)](#) [FCN-230C068-11](#) [FCN-268F012-G/BD](#) [FCN-268F036-G/BD](#) [FCN-268M012-G/0D](#) [FCN-268M024-G/1D](#) [FCN-723J004/1](#) [MIS-048-01-F-D-DP-K](#) [832-10-034-10-001000](#) [FX4C-80S-1.27DSA](#) [FCN-214Q030-G/0](#) [FCN-234P048-G/0](#) [FCN-235D050-G/C](#) [210-93-314-41-105000](#) [2-22603-0](#) [MDF7-40DP-2.54DSA\(55\)](#) [AXG720047](#) [MIT-114-03-F-D-K](#) [55323-1519](#) [DF33-2P-3.3DSA\(24\)](#) [YFT-20-05-H-03-SB-K](#) [503308-3040](#) [026-6203-PDB](#) [027-6203-PDB](#) [069159702701000](#) [10123981-102LF](#) [101A10019X](#) [55650-0588-C](#) [68682-310LF](#) [68684-306](#) [75140-7012](#) [87471-650](#) [YTW-30-07-H-Q-410-140](#) [FCN-268F024-G0D](#) [10124054-515LF](#) [68685-603](#) [8-1616154-3](#) [MIS-019-01-F-D](#) [FCN-268M024-G/3D](#) [FCN-268M036-G/BD](#) [20021832-06016C1LF](#) [KX15-20KLDL-E1000E](#) [AXE810124](#) [FCN-214J100-G/0](#) [FCN-230C068-E/S](#) [AXE812124](#) [AXE816124](#) [AXE720127](#) [354184](#)