

HRS Coaxial Lightning Arrester

CP Series

◆ Features

1. Prevents damage to coaxial antenna power line caused by dielectric lightning
2. Variations available
 - Technology types: Quarter wave short-circuit stub, Coil, Gas discharge tube (GDT), Semiconductor*
 - Interface types: N, SMA, TNC, BNC, U.FL etc.
3. Covers wide frequency range: DC to 12.5 GHz (with GDT type)
4. RoHS compliant



*Development will be studied upon request.

◆ Gas Discharge Tube Type (CP-N-PJG-3)

N Plug to N Jack

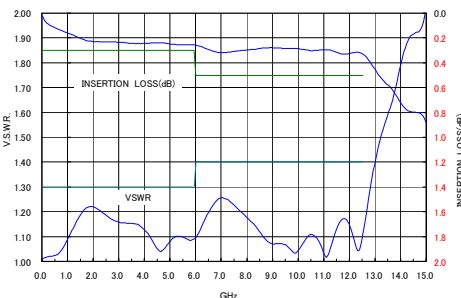
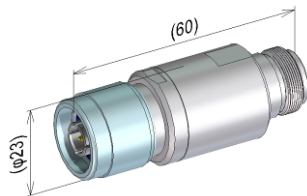

◆ Coil Type (CP-HRMJU.FLJC-1A)

SMA Jack to U.FL Jack

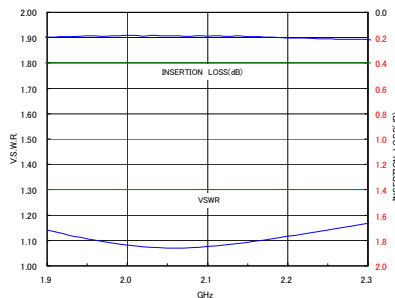
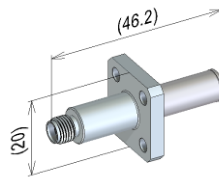

◆ Quarter Wave Short-circuit Stub Type (CP-N-JJS-1)

N Jack to N Jack

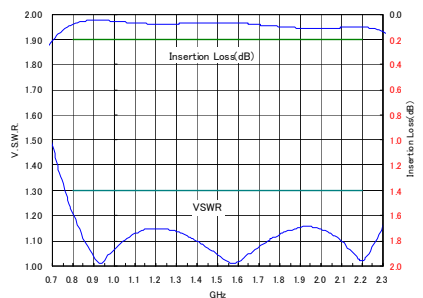
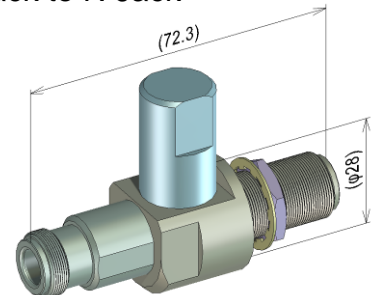

Item	CP-N-PJG-3	CP-HRMJU.FLJC-1A	CP-N-JJS-1
Lightning Arrester Type	Gas Discharge Tube (GDT)	Coil	Quarter Wave Short-circuit Stub
Connector	N Plug to N Jack	SMA Jack to U.FL Jack	N Jack to N Jack
Characteristic Impedance	50 Ω	50 Ω	50 Ω
Frequency Range	DC to 12.5 GHz	2.12 to 2.17 GHz	0.8 to 2.2 GHz
Operating Temperature Range	-40 °C to +70 °C	-40 °C to +85 °C	-40 °C to +85 °C
Storage Temperature Range	-40 °C to +70 °C	-40 °C to +85 °C	-40 °C to +85 °C
Power	2 W	1 W	100 W
V.S.W.R.	1.30 Max. (DC to 6 GHz)	1.30 Max.	1.30 Max.
Insertion Loss	0.3 dB Max. (DC to 6 GHz)	0.4 dB Max.	0.2 dB Max.
DC Breakdown Voltage (100V/s)	150 V to 500 V	-	-
Impulse Breakdown Voltage (1kV/μs)	700 V Max.	-	-
Impulse Max. Peak Current	8/20 μs • 2kA	8/20 μs • 2kA	8/20 μs • 5 kA
Insulation Resistance (DC100V)	1,000 MΩ	-	-

Specifications herein are subject to change without notice. Contact Hirose for latest specifications, drawings or availabilities.

X-ON Electronics

Largest Supplier of Electrical and Electronic Components

Click to view similar products for [RF Adapters - In Series](#) category:

Click to view products by [Hirose](#) manufacturer:

Other Similar products are found below :

[5916-1103-603](#) [5918-1103-000](#) [5919-1503-000](#) [651A505](#) [82-5552](#) [9030-9523-502](#) [A0407000](#) [R114703000W](#) [R125704000](#) [R125771001](#)
[R141710000W](#) [R141723161](#) [R141730000](#) [R143730700](#) [R143770000](#) [R161703000W](#) [R161730000](#) [R161753000W](#) [R161791530W](#)
[R201705000](#) [R222705200](#) [R222M40010W](#) [R316754000](#) [R405006000](#) [R443162000](#) [AD78TL](#) [HRM-513S](#) [1996352-2](#) [2157155-1](#) [252169-75](#)
[AD158](#) [2101130-1](#) [252186](#) [R114704000W](#) [R114720000W](#) [R125705001](#) [R125705701](#) [R125771000](#) [R125771001W](#) [R125791501W](#)
[R127704001](#) [R127.870.001](#) [R127872001](#) [R141717000](#) [R142710000](#) [R142723000](#) [R143703000](#) [R143704000](#) [R143705700](#) [R143710000](#)