

Aug.1.2021 Copyright 2021 HIROSE ELECTRIC CO., LTD. All Rights Reserved.
 In case of consideration for using Automotive equipment / device which demand high reliability, kindly contact our sales window correspondents.

| COUNT | DESCRIPTION OF REVISIONS | BY | CHKD | DATE | COUNT | DESCRIPTION OF REVISIONS | BY | CHKD | DATE |
|-------|--------------------------|----|------|------|-------|--------------------------|----|------|------|
| △ | | | | | △ | | | | |
| △ | | | | | △ | | | | |
| △ | | | | | △ | | | | |

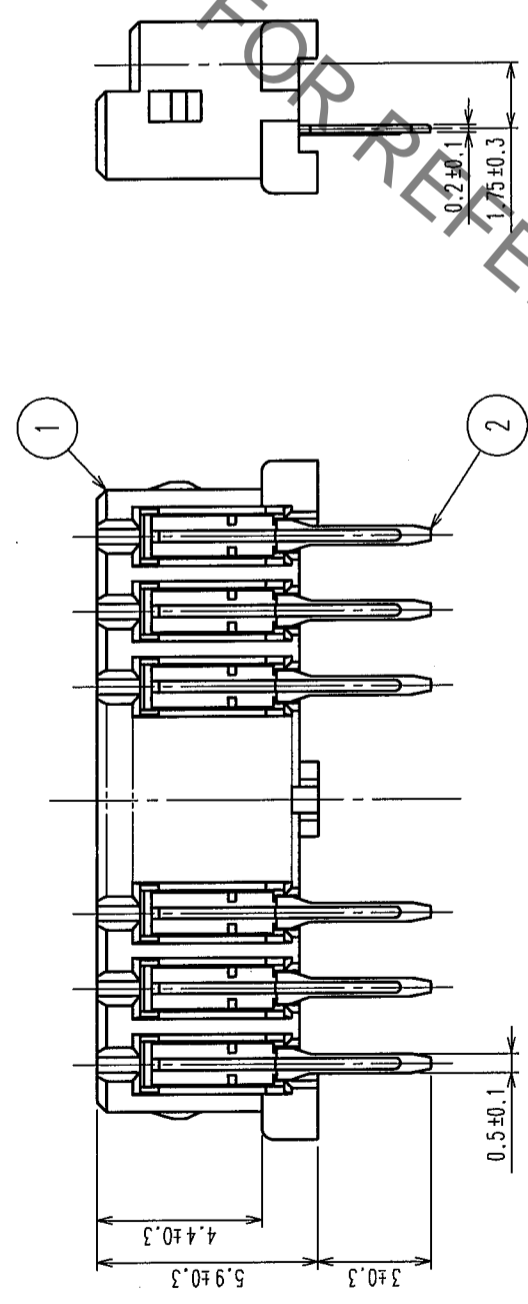

RECOMMENDED PATTERN

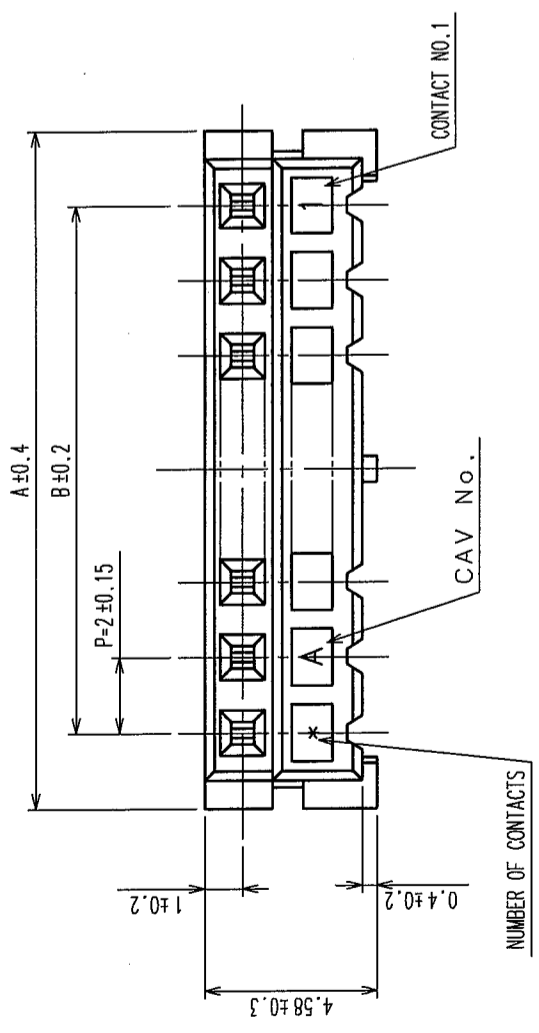
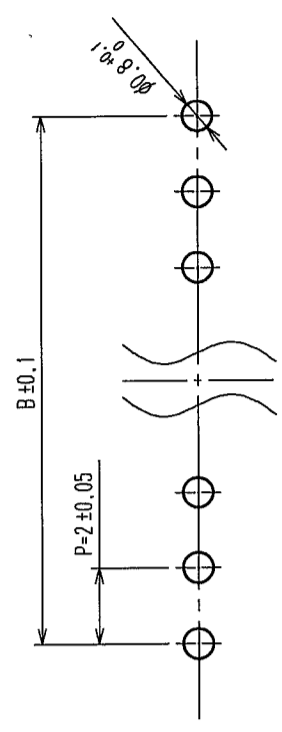

| CODE NO. | PART NO. | NUMBER OF CONTACT | A | B |
|-----------------|------------------|-------------------|------|------|
| CL543-0048-6-55 | DF3-2S-2DSA(55) | 2 | 6.0 | 2.0 |
| CL543-0049-9-55 | DF3-3S-2DSA(55) | 3 | 8.0 | 4.0 |
| CL543-0050-8-55 | DF3-4S-2DSA(55) | 4 | 10.0 | 6.0 |
| CL543-0051-0-55 | DF3-5S-2DSA(55) | 5 | 12.0 | 8.0 |
| CL543-0052-3-55 | DF3-6S-2DSA(55) | 6 | 14.0 | 10.0 |
| CL543-0053-6-55 | DF3-7S-2DSA(55) | 7 | 16.0 | 12.0 |
| CL543-0054-9-55 | DF3-8S-2DSA(55) | 8 | 18.0 | 14.0 |
| CL543-0055-1-55 | DF3-9S-2DSA(55) | 9 | 20.0 | 16.0 |
| CL543-0056-4-55 | DF3-10S-2DSA(55) | 10 | 22.0 | 18.0 |
| CL543-0057-7-55 | DF3-11S-2DSA(55) | 11 | 24.0 | 20.0 |
| CL543-0058-0-55 | DF3-12S-2DSA(55) | 12 | 26.0 | 22.0 |
| CL543-0059-2-55 | DF3-13S-2DSA(55) | 13 | 28.0 | 24.0 |
| CL543-0060-1-55 | DF3-14S-2DSA(55) | 14 | 30.0 | 26.0 |
| CL543-0061-4-55 | DF3-15S-2DSA(55) | 15 | 32.0 | 28.0 |

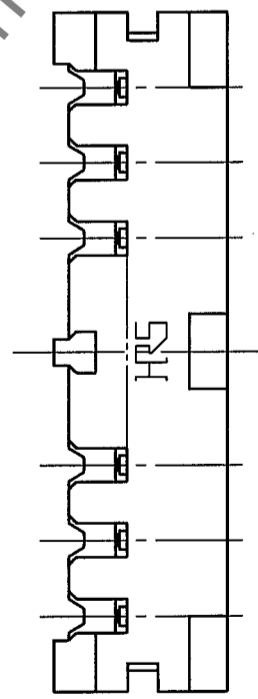

| | | | |
|---|-----------------|--|---------------------------------|
| 2 | PHOSPHOR BRONZE | CONTACT AREA: GOLD PLATED 0.2μm min LEAD AREA: TIN PLATED 1μm min UNDER PLATING: NICKEL PLATED 1μm min | STOPPER |
| 1 | POLYAMIDE | UL94V-0 (BLACK) | ELECTROSTATIC PROTECTION, CLEAR |

| NO. | MATERIAL | FINISH, REMARKS | NO. | MATERIAL | FINISH, REMARKS |
|-----|----------|-----------------|-----|-------------------------|-----------------|
| 4 | S. PVC | | 3 | RIGID POLYVINYLCHLORIDE | |

| DESIGNED | CHECKED | APPROVED | RELEASED |
|-------------|------------|----------|----------|
| M. Nakamoto | H. Imehara | J. Oka | |

| | | | |
|-------------|----------------|----------|----------------|
| DRAWING NO. | EDC3-162329-11 | PART NO. | DF3-S-2DSA(55) |
| SCALE | 5 : 1 | DATE | 04.03.24 |
| UNITS | mm | CODE NO. | CL543- |

| | |
|---------------------------|--------------|
| HIROSE ELECTRIC CO., LTD. | FORM NO. 229 |
|---------------------------|--------------|

TO

In case of consideration for using Automotive equipment / device which demand high reliability, kindly contact our sales window correspondents.

| COUNT | DESCRIPTION OF REVISIONS | BY | CHKD | DATE | COUNT | DESCRIPTION OF REVISIONS | BY | CHKD | DATE |
|-------|--------------------------|----|------|------|-------|--------------------------|----|------|------|
| △ | | | | | △ | | | | |
| △ | | | | | △ | | | | |
| △ | | | | | △ | | | | |

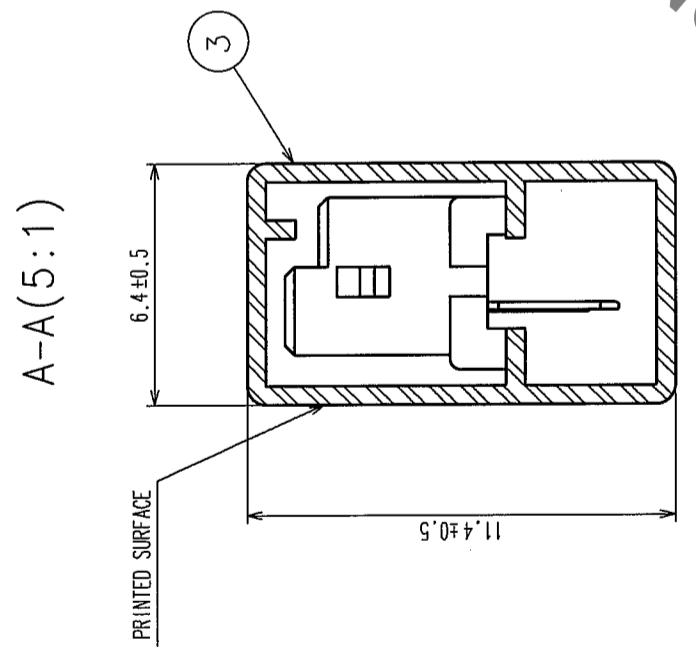
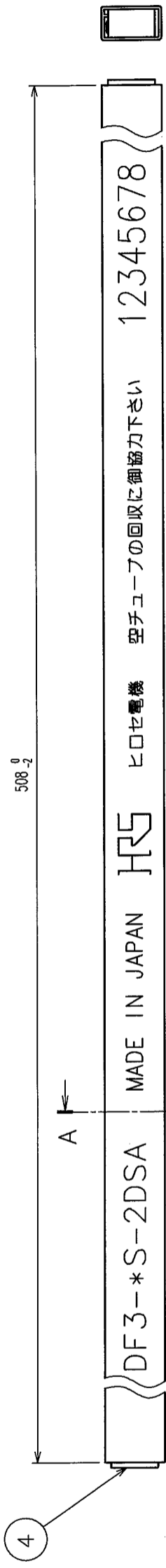

NOTES 1. NUMBER OF CONNECTERS PER A MAGAZINE CASE SHALL BE IN ACCORDANCE WITH THE LIST.

2. THESE CONNECTORS SHALL BE ON SALED IN ACCORDANCE WITH THE MULTIPLE QUANTITY ON THE LIST.

| CODE NO. | PART NO. | NUMBER OF CONNECTORS |
|-----------------|------------------|----------------------|
| CL543-0048-6-55 | DF3-2S-2DSA(55) | 80 |
| CL543-0049-9-55 | DF3-3S-2DSA(55) | 60 |
| CL543-0050-8-55 | DF3-4S-2DSA(55) | 48 |
| CL543-0051-0-55 | DF3-5S-2DSA(55) | 40 |
| CL543-0052-3-55 | DF3-6S-2DSA(55) | 34 |
| CL543-0053-6-55 | DF3-7S-2DSA(55) | 30 |
| CL543-0054-9-55 | DF3-8S-2DSA(55) | 27 |
| CL543-0055-1-55 | DF3-9S-2DSA(55) | 24 |
| CL543-0056-4-55 | DF3-10S-2DSA(55) | 21 |
| CL543-0057-7-55 | DF3-11S-2DSA(55) | 20 |
| CL543-0058-0-55 | DF3-12S-2DSA(55) | 18 |
| CL543-0059-2-55 | DF3-13S-2DSA(55) | 17 |
| CL543-0060-1-55 | DF3-14S-2DSA(55) | 16 |
| CL543-0061-4-55 | DF3-15S-2DSA(55) | 15 |

| NO. | MATERIAL | FINISH, REMARKS | NO. | MATERIAL | FINISH, REMARKS |
|-------------|----------|-----------------|----------|----------|-----------------|
| CL | | | | | |
| DRAWN | | M. Nakamoto | DESIGNED | | H. Uehara |
| DATE | | '04.03.24 | CHECKED | | T. Nagayoshi |
| DRAWING NO. | | EDC3-162329-11 | APPROVED | | J. Oka |
| SCALE | | FR:EE | RELEASED | | |
| UNITS | | mm | DATE | | '04.03.24 |
| PART NO. | | DF3-*S-2DSA(55) | CODE NO. | | CL543- |
| DRAWING NO. | | EDC3-162329-11 | CODE NO. | | CL543- |
| SCALE | | FR:EE | CODE NO. | | CL543- |
| UNITS | | mm | CODE NO. | | CL543- |

DRAWING FOR REFERENCE

TO

X-ON Electronics

Largest Supplier of Electrical and Electronic Components

Click to view similar products for [Headers & Wire Housings](#) category:

Click to view products by [Hirose](#) manufacturer:

Other Similar products are found below :

[892-18-020-10-001101](#) [58102-G61-06LF](#) [582553-1](#) [0009485154](#) [009176003701906](#) [0050291907](#) [LY20-4P-DT1-P1E-BR](#) [02.125.8002.8](#)
[609-3404](#) [61062-3](#) [622-0430](#) [622-3653LF](#) [63453-116](#) [636-1030](#) [636-1427](#) [636-3427](#) [636-4007](#) [641938-9](#) [641991-4](#) [644827-2](#) [65817-010LF](#)
[65817-015LF](#) [65863-015LF](#) [66207-023LF](#) [67095-007LF](#) [67601157](#) [68648-049](#) [70.362.1628.0](#) [70-4210](#) [70-4226B](#) [70-4853B](#) [707-5020](#) [707-](#)
[5028](#) [71.350.2428.0](#) [71918-208LF](#) [71961-016LF](#) [733-134](#) [733-162](#) [754199-000](#) [760-3052](#) [787-8014-00](#) [79531-3000](#) [FCN-360C032-B](#) [FCN-](#)
[367T-T012/H](#) [FCN-723D010/2](#) [80.063.4001.1](#) [800-90-001-10-001000](#) [800-90-010-10-002000](#) [801-43-002-10-013000](#) [801-43-006-10-002000](#)