

Sep.1.2021 Copyright 2021 HIROSE ELECTRIC CO., LTD. All Rights Reserved.
In case of consideration for using Automotive equipment / device which demand high reliability, kindly contact our sales window correspondents.

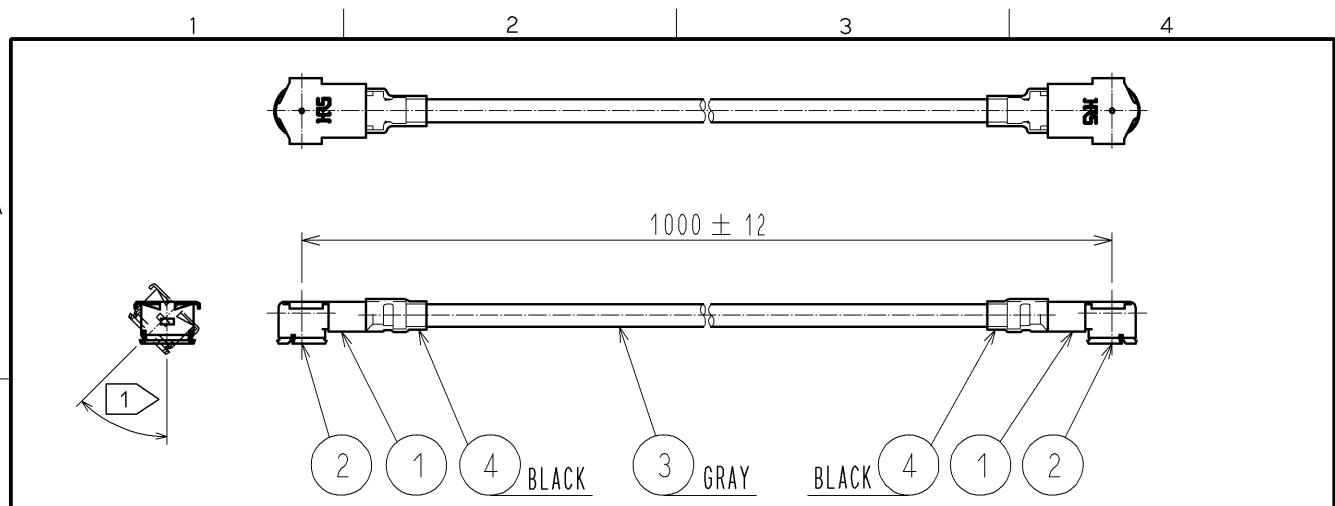

【PRECAUTIONS FOR HANDLING】

- Connector insertion and extraction
 - Connector shall be extracted vertically by specialised extraction JIG.
Part No. :H.FL-LP-N (CL331-0551-7)
Never hold the cable when extracting the cable because it damages the connector.
 - Insert the connector as perpendicularly to the mating surface as possible by aligning the mating axes of both connectors. Do not excessively slant the connectors when inserting.
- Allowable loads on the cable after the connectors are mated.
The figures below show the maximum allowable loads on the cable. Do not apply loads exceeding these values to the cable.
- Use all component within 6 months after the delivery.
Store in manufacturer's package or tightly re-closed box with the following conditions.
Use this product within 6 months after receipt.
Temperature: -10℃ To +40℃
Humidity : 15 To 85% RH.
- Environment condition
Do not use the product under the environmental condition as shown below due to possible product deterioration.
Special gas atmosphere (hydrogen sulfide gas, sulfur sulfide gas and hydrogen chloride gas)
Place attention required : heating system, area near hot spring, volcanic mountain and alike
Water splashed and condensation places.
Place attention required : harsh temperature change.

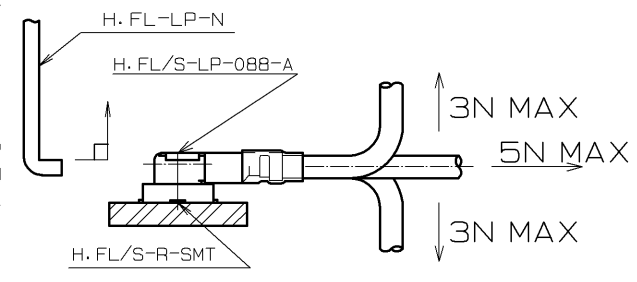

【 DIMENSIONS OF CONNECTOR 】

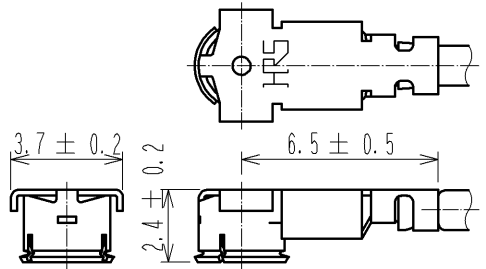

NOTE 1 Angle is optional.

RoHS COMPLIANT

2	H. FL/S-CONTACT	CL331-0804-0	4	SHRINK TUBE(BLACK)	SUMITOMO ELECTRIC INDUSTRIES, LTD.
1	H. FL/S-LP-088-A	CL331-0803-8	3	UL1745-SB-CX-50 30AWG TAD1.37(GRAY)	HITACHI METALS, LTD.
NO.	MATERIAL	FINISH , REMARKS	NO.	MATERIAL	MANUFACTURER

UNITS mm		SCALE FREE	COUNT 	DESCRIPTION OF REVISIONS	DESIGNED	CHECKED	DATE
HIROSE ELECTRIC CO., LTD.				APPROVED : TS. NOBE 13.11.20 CHECKED : NK. NINOMIYA 13.11.20 DESIGNED : YI. FUNADA 13.11.20 DRAWN : YI. FUNADA 13.11.06	DRAWING NO. EDC4-355079-02 PART NO. H. FL/S-2LPA-088H1T-A-1000 CODE NO. CL321-6096-8-02		

X-ON Electronics

Largest Supplier of Electrical and Electronic Components

Click to view similar products for [RF Cable Assemblies](#) category:

Click to view products by [Hirose](#) manufacturer:

Other Similar products are found below :

[73-6352-10](#) [73-6353-3](#) [73-6364-6](#) [R285001001](#) [R288940004](#) [R288940005](#) [145111-05-12.00](#) [1661-C-24](#) [1801171170914KE](#) [24P104C24J1-012](#) [24P104C24P1-006](#) [24P104C24P1-018](#) [24P204C24J1-003](#) [172-2150-EX](#) [1800920920914PJ](#) [FCB-3030-ALT](#) [21117-046](#) [21117-050](#) [PCX-24-50](#) [24P103C24P2-003](#) [25P203C25P2-003](#) [PTWY-24-78](#) [R284008001](#) [R285001021](#) [R285426000](#) [R288940003](#) [R288940008](#) [RF179-74BJ3-77RP1-0305](#) [4814-BB-24](#) [5260-72](#) [JT2N1-CL1-1F](#) [DLP-COAX1](#) [4814-K-48](#) [115101-09-06.00](#) [CCNTN2-MM-LL335-26](#) [73-6351-25](#) [73-6352-3](#) [73-6353-25](#) [1800920920610PJ](#) [GD0BQ0BQ024.0](#) [1-3636-600-5210](#) [TL8A-11SMA-11SMA-01500-51](#) [R284C0351060](#) [R288940009](#) [R284C0351028](#) [R288940002](#) [9702-1SL-1](#) [PT82NSMA](#) [73-6353-10](#) [R285020301W](#)