

# BWA SERIES RF CO-AXIAL CONNECTORS

The BWA series are converter adapters used for connecting connectors of different series.

- (1) Has mating portions compatible in materials and finish with the respective series.
- (2) Conforms in performance to the lower series of the two connectors to be connected.

## Converter adapter list

| Mating portion 1 |                 | Mating portion 2 |                | Part No.        | CL No.           | Remarks          | Shape         |        |
|------------------|-----------------|------------------|----------------|-----------------|------------------|------------------|---------------|--------|
| Series name      | Mating portion  | Series name      | Mating portion |                 |                  |                  |               |        |
| N                | P               | BNC              | P              | NP-BNCP(40)     | 311-0050-7-40    |                  | Fig.1         |        |
|                  |                 |                  | J              | JUG-201A/U(40)  | 311-0007-8-40    |                  | Fig.2         |        |
|                  |                 | M                | J              | NP-MJ(40)       | 311-0019-7-40    |                  | Fig.3         |        |
|                  |                 | S                | J              | N.P-S.J(40)     | 311-0245-6-40    |                  | Fig.4         |        |
|                  |                 | HRM              | P              | HRM-555S(40)    | 311-0125-4-40    |                  | Fig.5         |        |
|                  |                 |                  | J              | HRM-554S(40)    | 311-0123-9-40    |                  | Fig.6         |        |
|                  | J               | BNC              | P              | UG-349/U(40)    | 311-0004-0-40    |                  | Fig.7         |        |
|                  |                 |                  | J              | NJ-BNCJ(40)     | 311-0005-2-40    |                  | Fig.8         |        |
|                  |                 |                  |                | NJ-BNCJ-PA(40)  | 311-0014-3-40    | Panel-mount type | Fig.9         |        |
|                  |                 | M                | P              | NJ-MP(40)       | 311-0018-4-40    |                  | Fig.10        |        |
|                  |                 |                  | J              | NJ-MJ(40)       | 311-0011-5-40    |                  | Fig.11        |        |
|                  |                 | TNC              | P              | N.J-TNC.P(40)   | 311-0225-9-40    |                  | Fig.12        |        |
|                  |                 | HRM              | P              | HRM-553S        | 311-0121-3       |                  | Fig.13        |        |
|                  |                 |                  | J              | HRM-552S        | 311-0119-1       |                  | Fig.15        |        |
|                  |                 | BNC              | P              | M               | P                | BNCP-MP(40)      | 311-0062-6-40 |        |
| J                | BNCP-MJ(40)     |                  |                |                 | 311-0008-0-40    |                  | Fig.18        |        |
| S                | P               |                  |                | SP-BNCP(40)     | 311-0055-0-40    |                  | Fig.19        |        |
|                  | J               |                  |                | SJ-BNCP(40)     | 311-0060-0-40    |                  | Fig.20        |        |
| UM               | J               |                  |                | BNCP-UMJ(40)    | 311-0065-4-40    |                  | Fig.21        |        |
| MSS              | P               |                  |                | BNCP-MSSP(40)   | 311-0107-2-40    |                  | Fig.22        |        |
|                  | J               |                  |                | BNCP-MSSJ(40)   | 311-0082-3-40    |                  | Fig.23        |        |
| HRM              | P               |                  |                | HRM-519(40)     | 311-0101-6-40    |                  | Fig.24        |        |
|                  | J               |                  |                | HRM-518(40)     | 311-0100-3-40    |                  | Fig.25        |        |
| J                | UHF             |                  |                | P               | UG-273/U(40)     | 311-0003-7-40    |               | Fig.26 |
|                  | M               |                  |                | P               | BNCJ-MP(40)      | 311-0009-3-40    |               | Fig.27 |
|                  |                 |                  |                | J               | MJ-BNCJ(40)      | 311-0020-6-40    |               | Fig.28 |
|                  | S               |                  | P              | SP-BNCJ(40)     | 311-0058-9-40    |                  | Fig.29        |        |
|                  |                 |                  | J              | SJ-BNCJ(40)     | 311-0054-8-40    |                  | Fig.30        |        |
|                  | SJ-BNCJ-PA(40)  |                  |                | 311-0108-5-40   | Panel-mount type | Fig.31           |               |        |
|                  | TNC             |                  | J              | BNC.J-TNC.J(40) | 311-0194-7-40    |                  | Fig.32        |        |
|                  | UM              |                  | P              | BNCJ-UMP(40)    | 311-0052-2-40    |                  | Fig.33        |        |
|                  |                 |                  | J              | BNCJ-UMJ(40)    | 311-0053-5-40    |                  | Fig.34        |        |
|                  | BNCJ-UMJ-PA(40) |                  |                | 311-0103-1-40   | Panel-mount type | Fig.35           |               |        |
| MSS              | P               |                  | BNCJ-MSSP(40)  | 311-0081-0-40   |                  | Fig.36           |               |        |
|                  | J               |                  | BNCJ-MSSJ(40)  | 311-0066-7-40   |                  | Fig.37           |               |        |

# BWA SERIES RF CO-AXIAL CONNECTORS

| Mating portion 1  |                  | Mating portion 2 |                   | Part No.         | CL No.                   | Remarks                        | Shape  |
|-------------------|------------------|------------------|-------------------|------------------|--------------------------|--------------------------------|--------|
| Series name       | Mating portion   | Series name      | Mating portion    |                  |                          |                                |        |
| BNC               | J                | HRM              | P                 | HRM-517(40)      | 311-0099-6-40            |                                | Fig.38 |
|                   |                  |                  | J                 | HRM-516(40)      | 311-0102-9-40            |                                | Fig.39 |
|                   |                  | POD              | P                 | BNCJ-PODP(40)    | 311-0160-5-40            |                                | Fig.40 |
|                   |                  |                  | J                 | BNCJ-PODJ(40)    | 311-0161-8-40            |                                | Fig.41 |
|                   |                  | PO6              | J                 | BNCJ-PO6J(40)    | 311-0167-4-40            |                                | Fig.42 |
| S                 | P                | HRM              | P                 | HRM-509(40)      | 311-0093-0-40            |                                | Fig.43 |
|                   |                  |                  | J                 | HRM-508(40)      | 311-0092-7-40            |                                | Fig.44 |
|                   | J                | HRM              | P                 | HRM-507(40)      | 311-0091-4-40            |                                | Fig.45 |
|                   |                  |                  |                   | HRM-512(40)      | 311-0098-3-40            | Panel-mount type               | Fig.46 |
|                   |                  |                  | HRM-512S(40)      | 311-0144-9-40    | Panel-mount type, S type | Fig.46                         |        |
|                   |                  |                  | HRM-506(40)       | 311-0090-1-40    |                          | Fig.47                         |        |
|                   |                  |                  | J                 | HRM-511(40)      | 311-0094-2-40            | Panel-mount type               | Fig.48 |
|                   |                  |                  |                   | HRM-511S(40)     | 311-0143-6-40            | Panel-mount type, S type       | Fig.48 |
| TNC               | J                | HRM              | J                 | HRMJ-TNCJ-PA(40) | 311-0202-3-40            | Panel-mount type               | Fig.49 |
| UM                | P                | HRM              | J                 | UM.P-HRM.J(40)   | 311-0176-5-40            |                                | Fig.50 |
|                   | J                | HRM              | J                 | HRMJ-UMJ(40)     | 311-0164-6-40            |                                | Fig.51 |
| HRM               | P                | POB              | P                 | HRMP-POBP-1(40)  | 311-0169-0-40            |                                | Fig.52 |
|                   |                  |                  | J                 | HRMP-POBJ        | 311-0152-7               |                                | Fig.53 |
|                   |                  | POD              | J                 | HRM.P-POD.J(40)  | 311-0177-8-40            |                                | Fig.54 |
|                   |                  | POD1             | J                 | HRMP-POD1J(40)   | 311-0253-4-40            |                                | Fig.55 |
|                   |                  | PO6              | J                 | HRMP-PO6J(40)    | 311-0172-4-40            |                                | Fig.56 |
|                   |                  | S,FL             | J                 | HRMP-S.FLJ-2(40) | 311-0249-7-40            | For inspecting harnesses parts | Fig.57 |
|                   |                  | H,FL             | J                 | HRMP-H.FLJ(40)   | 311-0232-4-40            | For inspecting harnesses parts | Fig.58 |
|                   |                  | HRMM             | P                 | HRMP-HRMMJ(40)   | 311-0250-6-40            |                                | Fig.59 |
|                   |                  |                  |                   | J                | HRMP-HRMMJ               | 311-0243-0                     |        |
|                   |                  |                  | HRMP-HRMMJ-LA(40) | 311-0226-1-40    |                          | Fig.61                         |        |
|                   |                  | J                | POB               | P                | HRMJ-POBP(40)            | 311-0151-4-40                  |        |
|                   | HRMJ-POBP-PA(40) |                  |                   |                  | 311-0206-4-40            |                                | Fig.63 |
|                   | J                |                  |                   | HRMJ-POBJ(40)    | 311-0149-2-40            |                                | Fig.64 |
|                   |                  |                  |                   | HRMJ-POBJ-PA(40) | 311-0150-1-40            |                                | Fig.65 |
|                   | POD              |                  | P                 | HRMJ-PODP(40)    | 311-0157-0-40            |                                | Fig.66 |
|                   | POD1             |                  | P                 | HRMJ-POD1P-1(40) | 311-0254-7-40            |                                | Fig.67 |
|                   | PO6              |                  | P                 | HRMJ-PO6P(40)    | 311-0173-7-40            |                                | Fig.68 |
|                   | PO51             |                  | P                 | HRMJ-PO51P(40)   | 311-0231-1-40            |                                | Fig.69 |
|                   | FL               |                  | P                 | HRMJ-FLP-1(40)   | 311-0195-0-40            |                                | Fig.70 |
|                   |                  |                  | J                 | HRMJ-FLJ(40)     | 311-0179-3-40            |                                | Fig.71 |
|                   | S,FL             |                  | P                 | HRMJ-S.FLP(40)   | 311-0218-3-40            |                                | Fig.72 |
|                   | H,FL             |                  | P                 | HRMJ-H.FLP-3(40) | 311-0264-0-40            |                                | Fig.73 |
|                   | HRMM             | P                | HRMJ-HRMMJ-2      | 311-0221-8       |                          | Fig.74                         |        |
| HRMJ-HRMMJ-LA(40) |                  |                  | 311-0227-4-40     |                  | Fig.75                   |                                |        |
| J                 |                  | HRMJ-HRMMJ       | 311-0220-5        |                  | Fig.76                   |                                |        |

- Note 1. Part No. NP-BNCP of Fig.1 is shown that series name N, coupling part p (plug) for connecting part 1 and series name BNC, coupling part P (plug) for connecting part 2.
2. Series name of each connecting parts are shown in order to HIROSE's CL numbers.

# BWA SERIES RF CO-AXIAL CONNECTORS

|                                  |                                   |
|----------------------------------|-----------------------------------|
| <p>Fig.1</p> <p>NP-BNCP(40)</p>  | <p>Fig.2</p> <p>UG-201A/U(40)</p> |
| <p>Fig.3</p> <p>NP-MJ(40)</p>    | <p>Fig.4</p> <p>N.P-S.J(40)</p>   |
| <p>Fig.5</p> <p>HRM-555S(40)</p> | <p>Fig.6</p> <p>HRM-554S(40)</p>  |
| <p>Fig.7</p> <p>UG-349/U(40)</p> | <p>Fig.8</p> <p>NJ-BNCJ(40)</p>   |

# BWA SERIES RF CO-AXIAL CONNECTORS

Fig.9

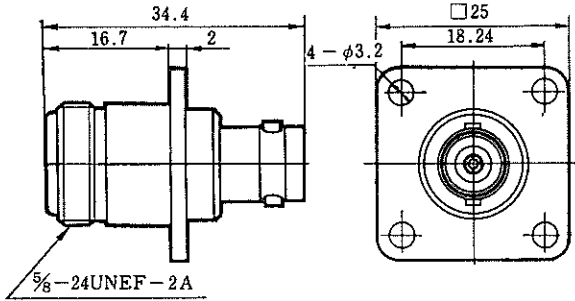

NJ-BNCJ-PA(40)

Fig.10

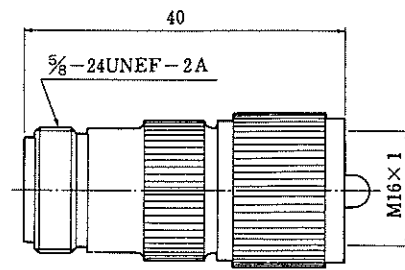

NJ-MP(40)

Fig.11

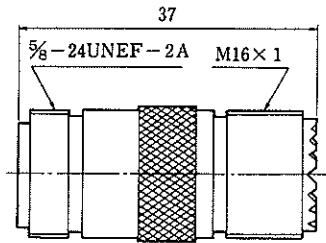

NJ-MJ(40)

Fig.12

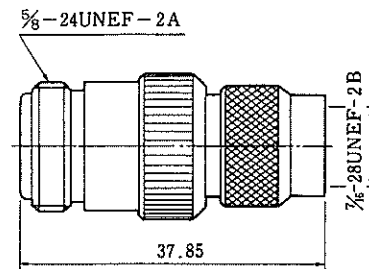

NJ-TNC.P(40)

Fig.13

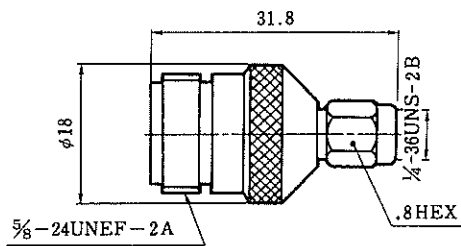

HRM-553S

Fig.15

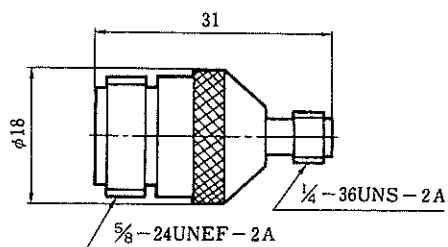

HRM-552S

# BWA SERIES RF CO-AXIAL CONNECTORS

Fig.17

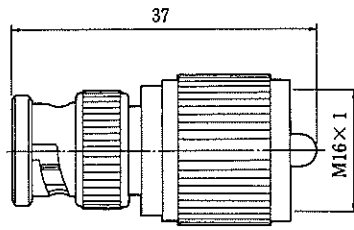

BNCP-MP(40)

Fig.18

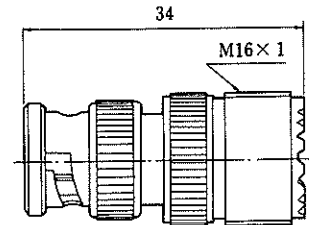

BNCP-MJ(40)

Fig.19

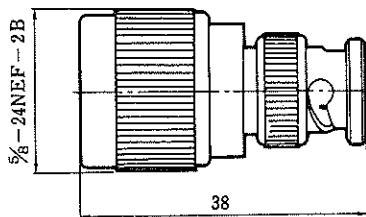

SP-BNCP(40)

Fig.20

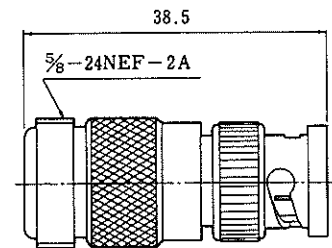

SJ-BNCP(40)

Fig.21

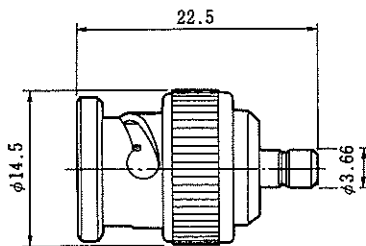

BNCP-UMJ(40)

Fig.22

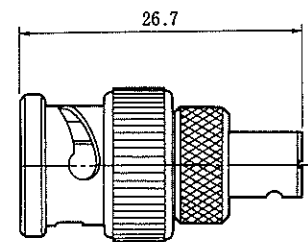

BNCP-MSSP(40)

Fig.23

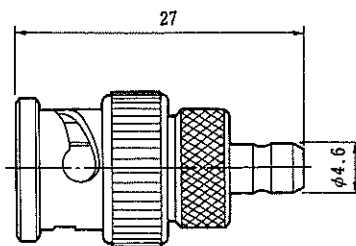

BNCP-MSSJ(40)

Fig.24

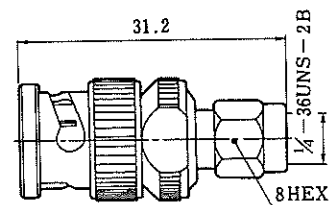

HRM-519(40)

# BWA SERIES RF CO-AXIAL CONNECTORS

Fig.25

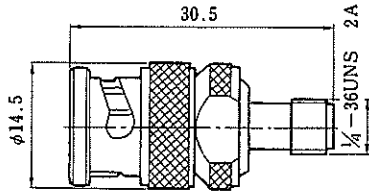

HRM-518(40)

Fig.26

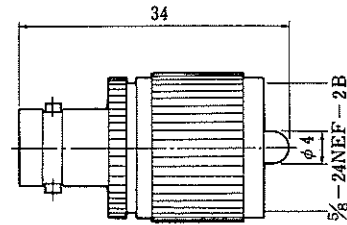

UG-273/U(40)

Fig.27

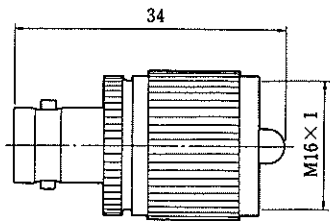

BNCJ-MP(40)

Fig.28

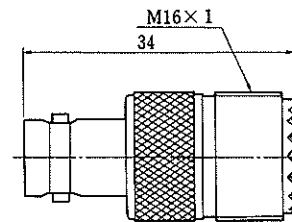

MJ-BNCJ(40)

Fig.29

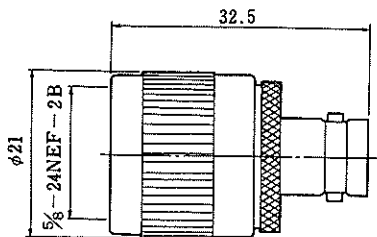

SP-BNCJ(40)

Fig.30

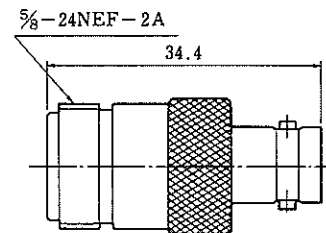

SJ-BNCJ(40)

Fig.31

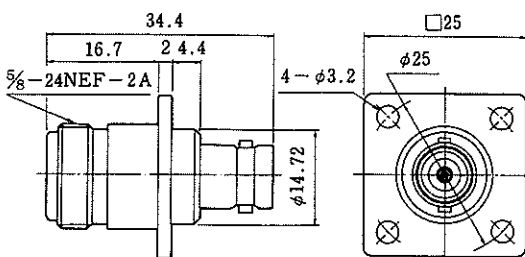

SJ-BNCJ-PA(40)

Fig.32

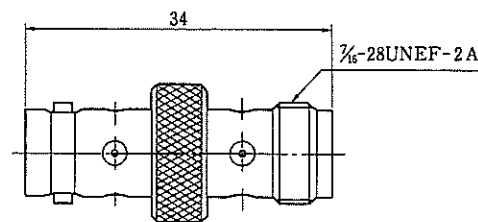

BNCJ-TNCJ(40)

# BWA SERIES RF CO-AXIAL CONNECTORS

Fig.33

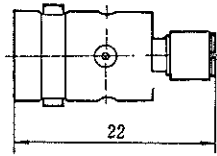

BNCJ-UMP(40)

Fig.34



BNCJ-UMJ(40)

Fig.35

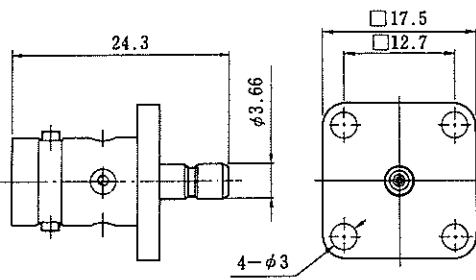

BNCJ-UMJ-PA(40)

Fig.36

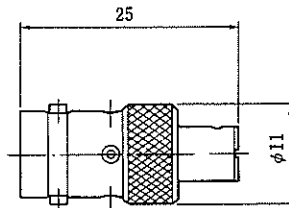

BNCJ-MSSP(40)

Fig.37

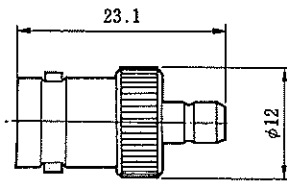

BNCJ-MSSJ(40)

Fig.38

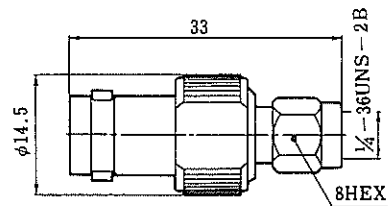

HRM-517(40)

Fig.39

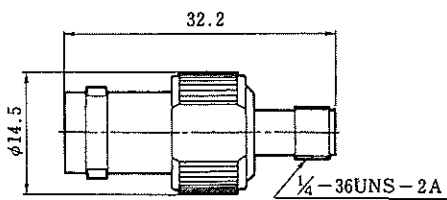

HRM-516(40)

Fig.40

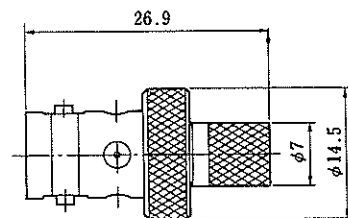

BNCJ-PODP(40)

# BWA SERIES RF CO-AXIAL CONNECTORS

Fig.41

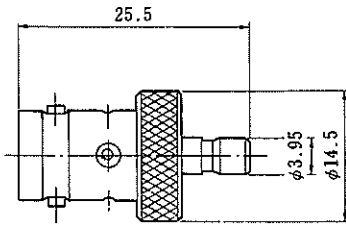

BNCJ-PODJ(40)

Fig.42

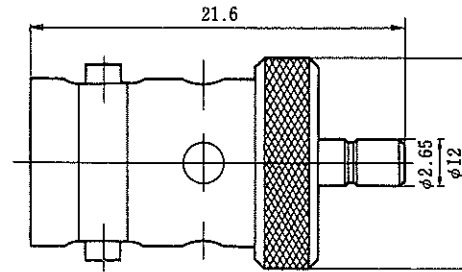

BNCJ-PO6J(40)

Fig.43

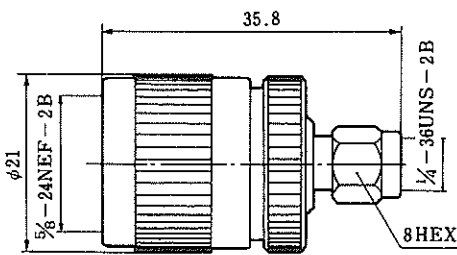

HRM-509(40)

Fig.44

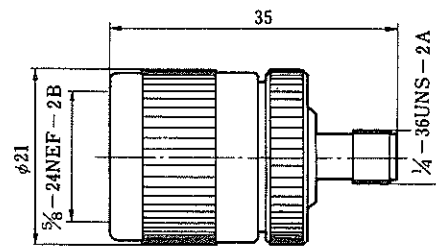

HRM-508(40)

Fig.45

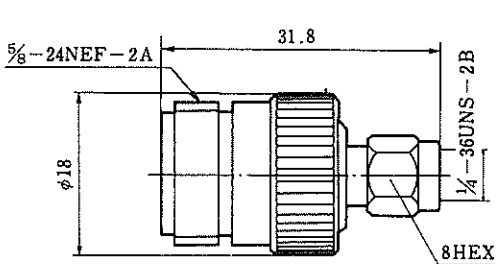

HRM-507(40)

Fig.46

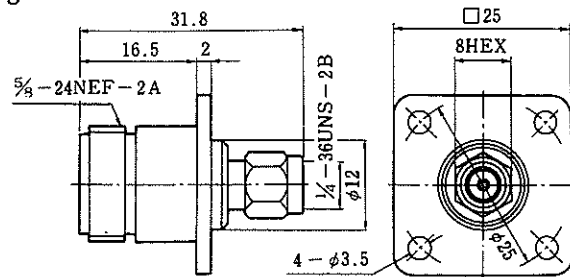

HRM-512(40) HRM-512S(40)

Fig.47

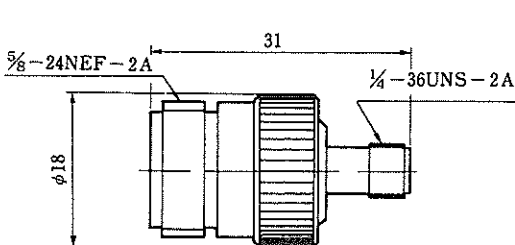

HRM-506(40)

Fig.48

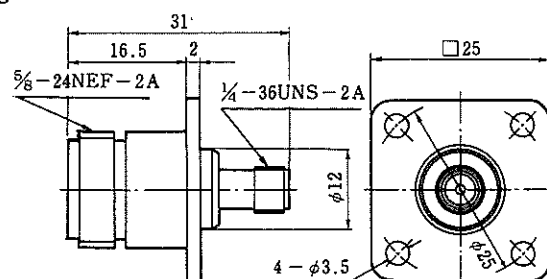

HRM-511(40) HRM-511S(40)



# BWA SERIES RF CO-AXIAL CONNECTORS

Fig.49

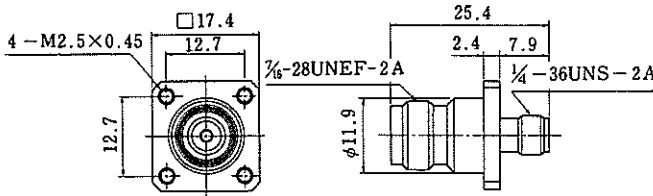

HRMJ-TNCJ-PA(40)

Fig.50

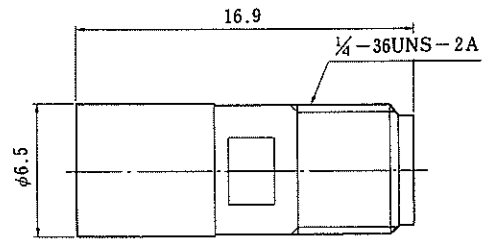

UM.P-HRMJ(40)

Fig.51

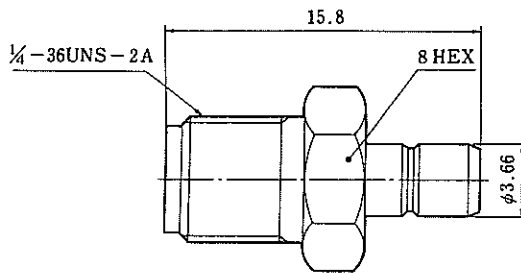

HRMJ-UMJ(40)

Fig.52

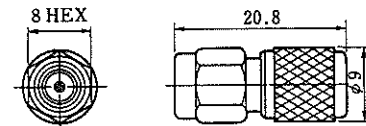

HRMP-POBP-1(40)

Fig.53

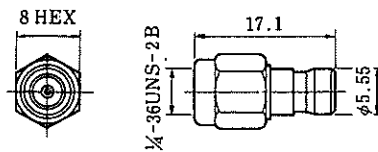

HRMP-POBJ

Fig.54

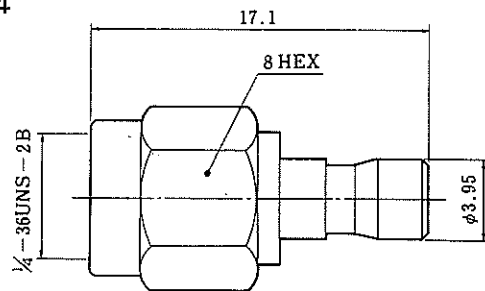

HRM.P-POD.J(40)

Fig.55

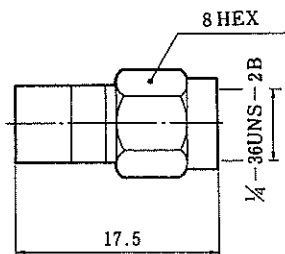

HRMP-POD1J(40)

Fig.56

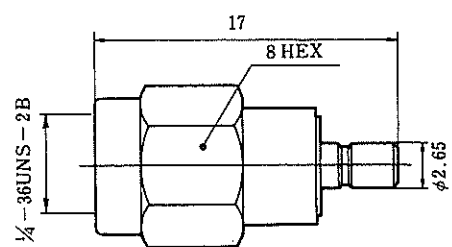

HRMP-PO6J(40)

# BWA SERIES RF CO-AXIAL CONNECTORS

Fig.57

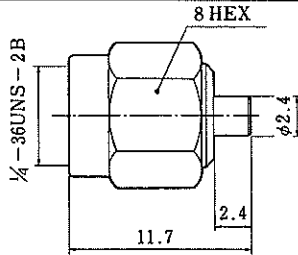

Note : The mating portion on the S. FL side mates with the S. FL and S. FL2 plugs. Having no locking mechanism, however, the S. FL side mating portion can be used only for performance measurement.

HRMP-S.FLJ-2(40)

Fig.58

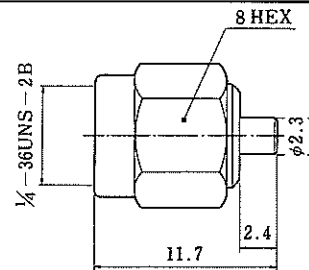

Note : Having no locking mechanism, however, the S. FL side mating portion can be used only for performance measurement.

HRMP-H.FLJ(40)

Fig.59

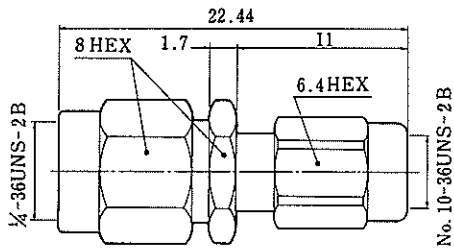

HRMP-HRMP(40)

Fig.60

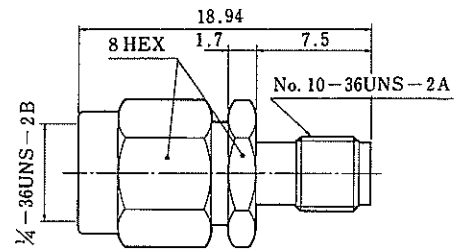

HRMP-HRMM(40)

Fig.61

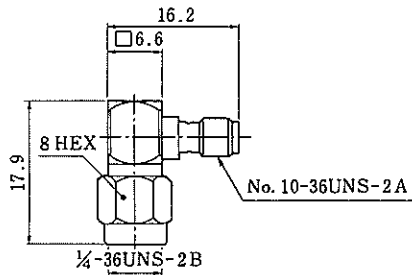

HRMP-HRMMJ-LA(40)

Fig.62

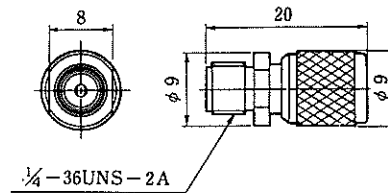

HRMJ-POBP(40)

Fig.63

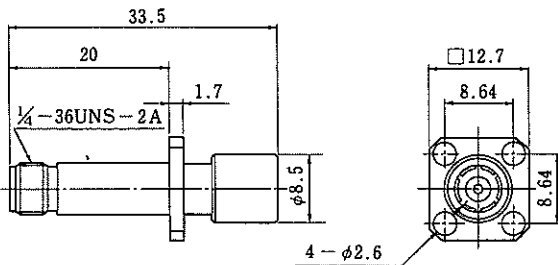

HRMJ-POBP-PA(40)

Fig.64

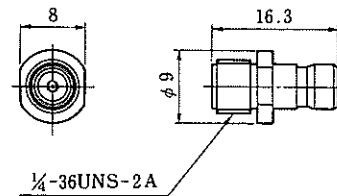

HRMJ-POBJ(40)

# BWA SERIES RF CO-AXIAL CONNECTORS

Fig.65

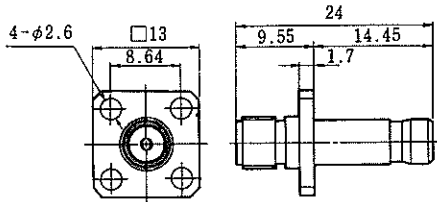

HRMJ-POBJ-PA(40)

Fig.66

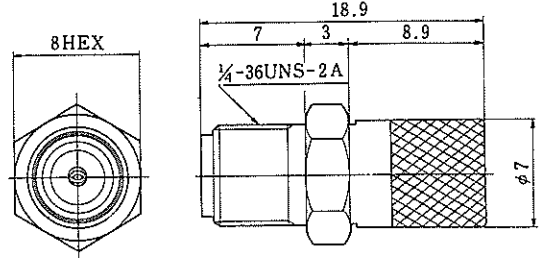

HRMJ-PODP(40)

Fig.67

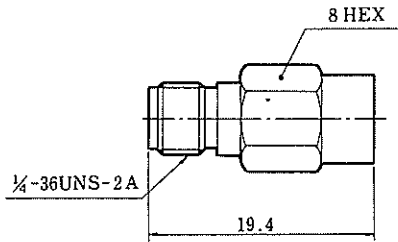

HRMJ-POD1P-1(40)

Fig.68

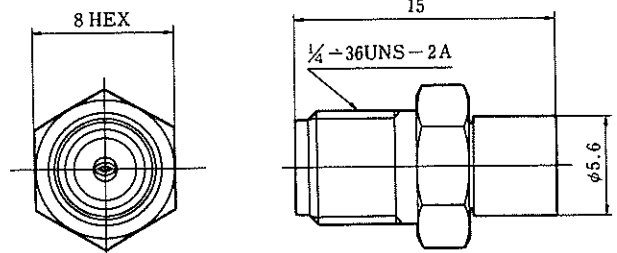

HRMJ-PO6P(40)

Fig.69

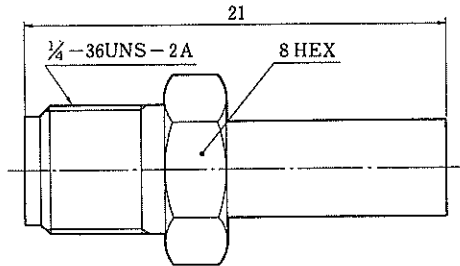

HRMJ-PO51P(40)

Fig.70

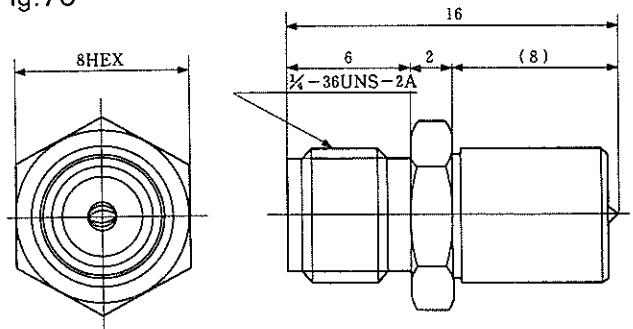

HRMJ-FLP-1(40)

Fig.71

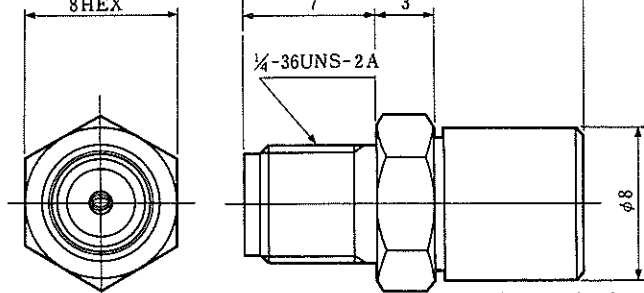

HRMJ-FLJ(40)

Note: Having no locking mechanism, however, the FL side mating portion can be used only for performance measurement.

Fig.72

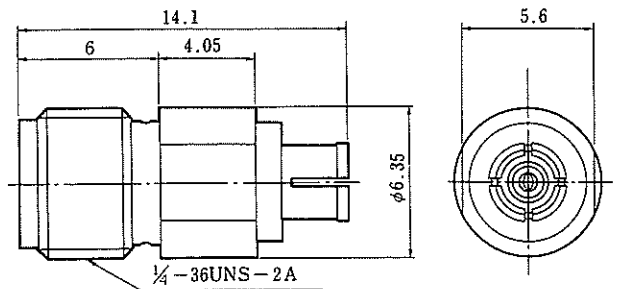

HRMJ-S.FLP(40)

Note: Compatible with S. FL and S. FL2.

# BWA SERIES RF CO-AXIAL CONNECTORS

Fig. 73

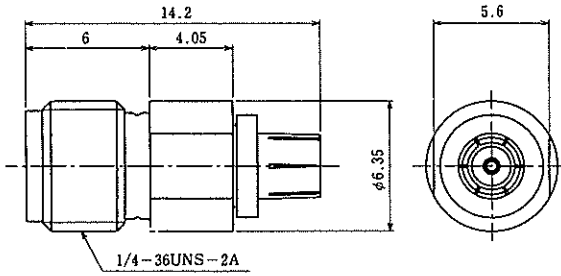

HRMJ-H.FLP-3(40)

Fig. 74

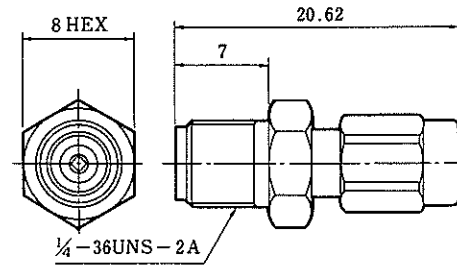

HRMJ-HRMMP-2

Fig. 75

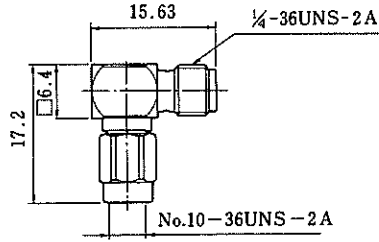

HRMJ-HRMMP-LA(40)

Fig. 76

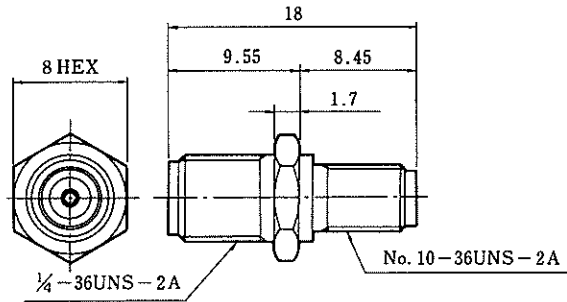

HRMJ-HRMMJ

## X-ON Electronics

Largest Supplier of Electrical and Electronic Components

*Click to view similar products for [RF Connectors / Coaxial Connectors](#) category:*

*Click to view products by [Hirose](#) manufacturer:*

Other Similar products are found below :

[8915-1511-000](#) [89674-0827](#) [6001-7071-019](#) [6002-7051-003](#) [6002-7551-202](#) [6059674-1](#) [619550-1](#) [630059-000](#) [M39030/3-01N](#) [6500-7071-046](#) [6769](#) [CX050L2AQ](#) [7002-1542-011](#) [7004-1512-000](#) [7009-1511-004](#) [7010-1511-000](#) [7029-1511-060](#) [7101-1541-010](#) [7101-1571-002](#) [7105-1521-002](#) [7145-1521-002](#) [7203-1571-003](#) [7209-1511-011](#) [7210-1511-015](#) [7210-1511-019](#) [73137-5015](#) [73216-2241](#) [7325-1512-000](#) [73404-2300](#) [7405-1521-005](#) [7405-1521-802](#) [7406-1521-005](#) [8527](#) [8547](#) [FS11V](#) [8808-1511-001](#) [9049-9513-000](#) [9074-9513-000](#) [9101-9573-002](#) [910A205F](#) [9130-9573-002](#) [PL11SC-026](#) [PL375-33](#) [PL40-5](#) [PL71-9](#) [PL74C-221](#) [PL75MC-217](#) [PL803-7](#) [980-8666-005](#) [1200690078](#)