



GDM Series Rectangular Receptacle Connectors, Type A

Technical Information

Product Description		
Order Designation	GSA 2000 A	GSA 3000 A
		
Description	Male appliance connector with retaining nut, no screws, longitudinal holes, closed nut	Male appliance connector with retaining nut, 2 screws M3 x 10 and 1 screw M3 x 5, open nut
RoHS-Compliant (2011/65/EU)	Yes	
(Construction Type) Standard	DIN EN 175 301-803-A	
Approvals	UR, VDE, SEV, CSA	
Technical Data		
No. of Pins	2 + PE	3 + PE
Ambient Temperature	-40 °C to +125 °C	
Housing/Grip/Screw Coupling	PA	
Contact Holder	PA	
Contact	SN	
Mechanical Data		
Degree of Protection	IP65 (gasket required; only when mounted and mated with Hirschmann/Lumberg counterparts)	
Terminal Type	Solder (ground contact: screw)	
Electrical Data		
Circuit	No protection circuit	
Contact Resistance	≤ 4 mΩ	
Rated Voltage	400 V AC/DC	
Rated Current	16 A	
Pollution Degree	3	
Accessories		
Scope of Delivery or Accessories (incl.)	Items supplied in one package: 200	
Accessories to be Ordered Separately	(NBR) flat gasket GSA 200-4, Order No. 730843002 (EPDM) flat gasket GSA 200-7, Order No. 730268003	

Technical Drawing

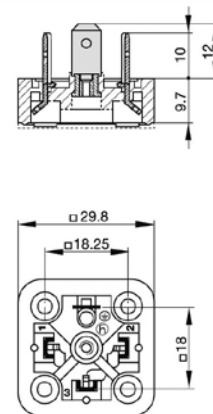
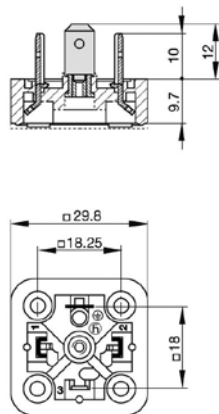

Be Certain with Belden

Order Information

Order No.	Order Designation	No. of Pins	Terminal Type
932592500	GSA 2000 A black	2 + PE	solder (ground contact: screw)
932598500	GSA 3000 A black	3 + PE	solder (ground contact: screw)

X-ON Electronics

Largest Supplier of Electrical and Electronic Components

Click to view similar products for [Sensor Cables / Actuator Cables](#) category:

Click to view products by [Hirschmann](#) manufacturer:

Other Similar products are found below :

[60963](#) [60964](#) [703000D02F2002](#) [703001D02F0602](#) [703001D02F1201](#) [703001D02F300](#) [704000D02F120](#) [MDM21SH001F](#) [773032K02F030](#)
[802027107404-1](#) [802027213811-1](#) [804001A09M150](#) [805001A09M0502](#) [84914-0235](#) [84914-0237](#) [885030A09M010](#) [8R4006A18M010](#)
[8R4J30E03C3003](#) [1200651713](#) [1200660844](#) [1200660845](#) [1200661173](#) [1200680071](#) [1200720053](#) [1200720081](#) [1200720094](#) [1200720099](#)
[1200720217](#) [1200800231](#) [1200860125](#) [1200870123](#) [1200660183](#) [1200660782](#) [1200660849](#) [1200661295](#) [1200661297](#) [1200661342](#)
[1200661343](#) [1200670080](#) [1200680331](#) [1200720252](#) [1200720255](#) [1200720597](#) [1200730184](#) [1200860344](#) [1200870359](#) [1200870643](#)
[1200980008](#) [1200980031](#) [1210502211](#)