

Recommended P.C.B Layout(Top Side)
(PCB BOARD TOLERANCE±0.05)

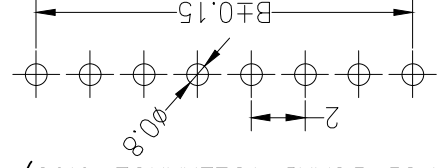

- 43=H4.3mm Plastic high
- No.of Pins Insulator Material Post
- Per Row 01~40P
- Option N=w/o post
- A=PT
- W-with Post
- G1:1U" Gold
- Contact Plating
- Packing code stream 01~99
- O=PE Bag
- M=Roel+Mylor
- R=Tube+Cap
- P=Tube+Cap
- M=Roel+Mylor
- F=LCP
- E=PA9T
- D=PA6
- G5:5U" Gold
- G4:3U" Gold
- G3:2U" Gold
- G2:1.5U" Gold
- A=Try
- 1=Tube
- C=PA6T
- B=PA6
- G6:10U" Gold
- G5:5U" Gold
- G7:15U" Gold
- S0:Gold Flash/Tn
- SN:Tn

Ordering Information

25 43 U-1 XX X W XX S N X 01



深圳市华宇创精密电子有限公司

SCALE:1:1 SIZE: A4
UNIT: mm [inch]
X.X ±2 X.X ±0.5
X.X ±0.30
X.X ±0.25
X.X ±0.15

TOLERANCE:
DRAWN BY: 陈一鸣
DATE: 2014-02-23
PART NAME: 2.00X4.3FH 1XNPIN 180°
CHECKED BY: 马跃
DATE: 2014-02-23
PART NO.: 2543U-1XXXWXXSNX01
APPROVED BY:
DATE: 2014-02-23
DRAW NO.: HYC-1812013910
SHEET NO. 1 OF 1

Contacts	Dimensions	
	A	B
21	42.50	40.00
2	4.50	2.00
3	6.50	4.00
4	8.50	6.00
5	10.50	8.00
6	12.50	10.00
7	14.50	12.00
8	16.50	14.00
9	18.50	16.00
10	20.50	18.00
11	22.50	20.00
12	24.50	22.00
13	26.50	24.00
14	28.50	26.00
15	30.50	28.00
16	32.50	30.00
17	34.50	32.00
18	36.50	34.00
19	38.50	36.00
20	40.50	38.00
38	38.00	36.00
39	39.00	37.00
40	40.00	38.00
76	76.00	74.00
77	77.00	75.00
78	78.00	76.00
79	79.00	77.00
80	80.00	78.00

Dimen Stions List

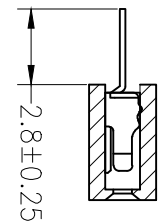

SPECIFICATIONS
 Rated Current:1.5AMP
 Contact Resistance:20mΩ Max
 Withstand Voltage:500V AC/DC
 Insulation Resistance:1000MΩ Min
 Operation Temperature:-40°C to +105°C
 Contact Material:Brass
 Contact Plating:Au or Sn Over Ni
 Insulator Material:Polyester(UL94V-0)
 Standard: PA6T
 Max.Processing Temp: 230°C for 30-60 seconds
 (260°C for 10 seconds)

X-ON Electronics

Largest Supplier of Electrical and Electronic Components

Click to view similar products for [Headers & Wire Housings](#) category:

Click to view products by [HOAUC](#) manufacturer:

Other Similar products are found below :

[95000-104TRLF](#) [10135584-644402LF](#) [DF62W-EP2022PCA](#) [95000-106TRLF](#) [DF62W-2022SCA](#) [DF62W-EP2022PC](#) [2203348](#) [DF62W-2022SC](#) [1084018](#) [1029039](#) [1084017](#) [802-10-012-10-002000](#) [1112640](#) [1112639](#) [891-007-9SS-BST1T](#) [000-34000](#) [0008550134](#) [0009482033](#) [0009507031](#) [57102-F02-18ULF](#) [57102-S06-03LF](#) [57202-S52-04LF](#) [PCN6-15S-2.5E](#) [0039019024](#) [58102-G61-06LF](#) [582553-1](#) [0009485154](#) [0009508121](#) [0022285053](#) [0050291907](#) [018731A](#) [LY20-4P-DT1-P1E-BR](#) [02.125.8002.8](#) [60101931](#) [60598-1 \(Cut Strip\)](#) [M1625-3R/100](#) [61062-3](#) [61082-181009](#) [CSU011177004](#) [636-1427](#) [638009-1](#) [641938-9](#) [641991-4](#) [644168-1](#) [644827-2](#) [647662-1](#) [65039-019ELF](#) [65692-001LF](#) [65781-018](#) [65781-047](#)