

- NOTES:
- FINISH
    - CONTACT: CONTACT AREA: Au 1~3u" Min. GOLD FLASH PLATING ON SOLDER AREA
    - SHELL: SOLDER AREA: Gold flash
  - ELECTRICAL REQUIREMENTS:
    - CURRENT RATING: 0.5A PER PIN.
    - CONTACT RESISTANCE: 50 mOhm MAX.
    - INSULATION RESISTANCE: 1000 MOhm MIN.200 VDC FOR 1 MINUTE.
    - WITHSTANDING STRENGTH: 500V AC FOR 1 MINUTE.
  - MECHANICAL REQUIREMENTS: DURABILITY: 3,000 CYCLES MIN.
  - ENVIRONMENT REQUIREMENTS:
    - OPERATING TEMP.: -30°C TO +85°C
    - STORAGE TEMPERATURE: -40°C TO +85°C
  - RECOMMENDED PROCESS DONDITION: IR-REFLOW, PEAK TEMPERATURE AND TIME: 250°C, 5~10 S.

ITEM	DESCRIPTION	MATERIAL	FINISH	Q'TY
⑥	HOOK	SUS304	NO PLATING	1
⑤	SPRING	SUS	NO PLATING	1
④	SLIDE	PA46	GLASS FILLED(OR EQUAL), UL 94V-0, BLACK	1
③	SHELL	SUS301-H T=0.10	GOLD FLASH PLATED ON SOLDER TAIL AREA. NICKEL 30~100u" UNDER PLATED OVER ALL	1
②	TERMINAL	C5240-SH T=0.10	GOLD PLATED ON CONTACT AREA"A" SEE "PLATED CODE NOTE" GOLD FLASH PLATED ON CONTACT AREA"B" AND SOLDER TAIL AREA NICKEL 50~150u" UNDER PLATED OVER ALL	1
①	HOUSING	LCP	GLASS FILLED(OR EQUAL), UL 94V-0, BLACK	1

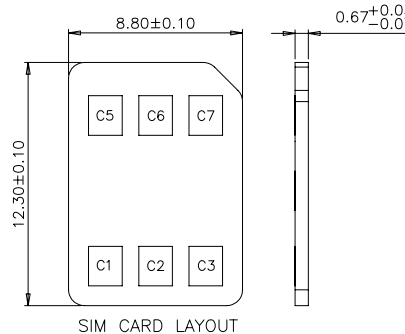

**深圳市华宇创精密电子有限公司**

<b>TOLERANCE:</b> X.X ±0.30 X.XX ±0.25 X.XXX ±0.15 X.* ±2* X.X* ±0.5*	<b>DRAWN BY :</b> 陈一鸣	<b>DATE :</b> 2014-02-23	<b>PART NAME:</b> NANO SIM PUSH 6P 1.25H
	<b>CHECKED BY:</b> 马跃	<b>DATE :</b> 2014-02-23	<b>PART NO.</b> HYC214-SIM06-125
<b>UNIT: mm [inch]</b> SCALE:1:1 SIZE: A4	<b>APPROVED BY:</b> 柯南	<b>DATE :</b> 2014-02-23	<b>DRAW NO:</b> HYC-SIM18120753
		<b>SHEET NO.</b> 1 OF 1	

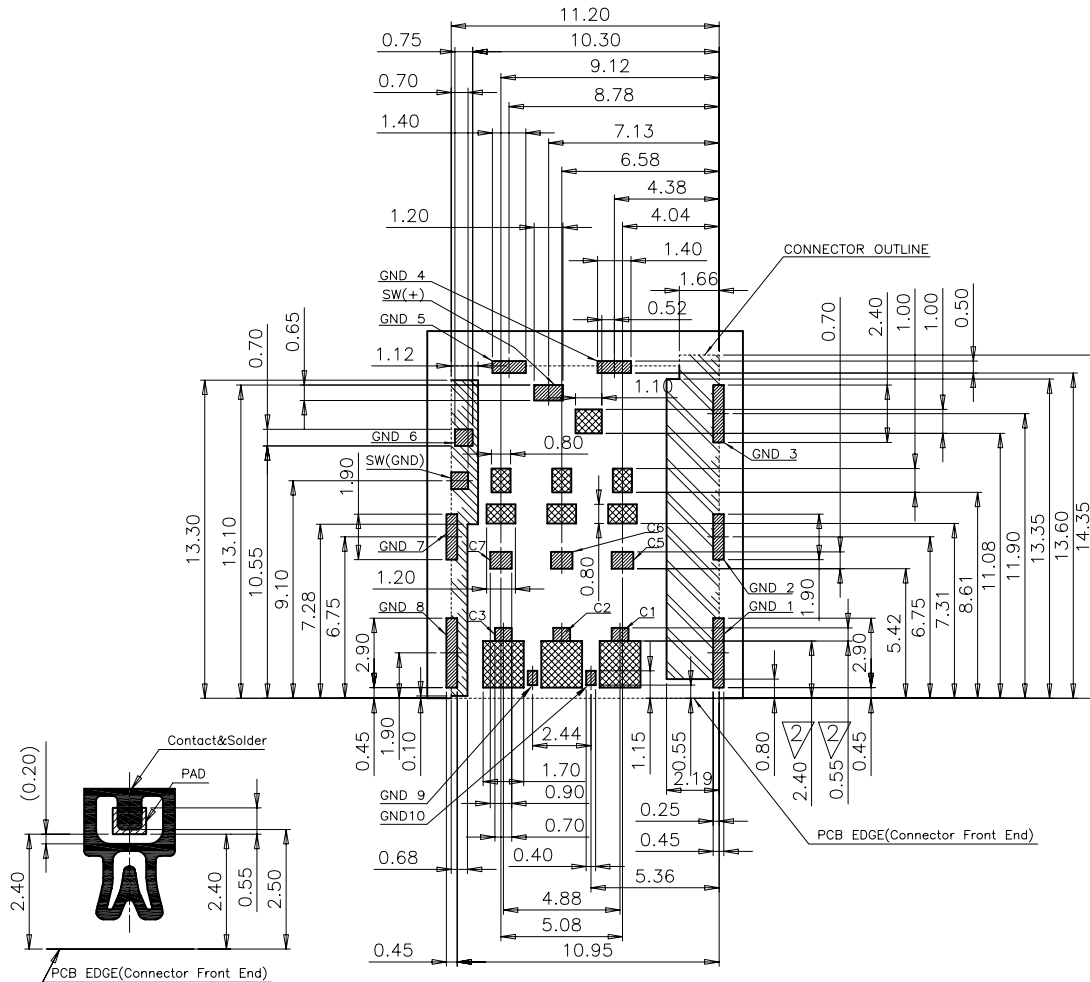

RECOMMENDED PCB LAYOUT TOP VIEW (TOLERANCE:±0.05) NO PATTERN AREA (TOLERANCE: ±0.05)  
RECOMMENDED MATAL MASK T=0.12MM

Connector Pin Assignment

No.	Pin Name	Description
①	C1	Vcc of SIM
②	C2	RST of SIM
③	C3	CLK of SIM
④	C5	GND of SIM
⑤	C6	Vpp of SIM
⑥	C7	I/O of SIM
⑦	SW	Detection Switch

- THIS AREA SHOULD BE FREE OF ANY CONDUCTIVE TRACES
- SMT SOLDER AREA
- OPEN WIRE RESTRICTED AREA (POSSIBLY TOUCH OF COMPONENTS ON PCB)

D/SW CIRCUIT

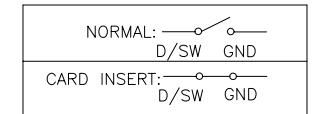

深圳市华宇创精密电子有限公司

<b>TOLERANCE:</b> X.X ±0.30 X.XX ±0.25 X.XXX ±0.15 X.* ±2* X.X* ±0.5*	<b>DRAWN BY :</b> 陈一鸣	<b>DATE :</b> 2014-02-23	<b>PART NAME:</b> NANO SIM PUSH 6P 1.25H
	<b>CHECKED BY:</b> 马跃	<b>DATE :</b> 2014-02-23	<b>PART NO.</b> HYC214-SIM06-125
UNIT: mm [inch] SCALE:1:1 SIZE: A4	<b>APPROVED BY:</b> 柯南	<b>DATE :</b> 2014-02-23	<b>MOLD NO.</b> /
			<b>DRAW NO:</b> HYC-SIM18120753
			<b>SHEET NO.</b> 1 OF 1

PRODUCT PACKAGING DIRECTION  
 CUSTOMER TO USE DIRECTION

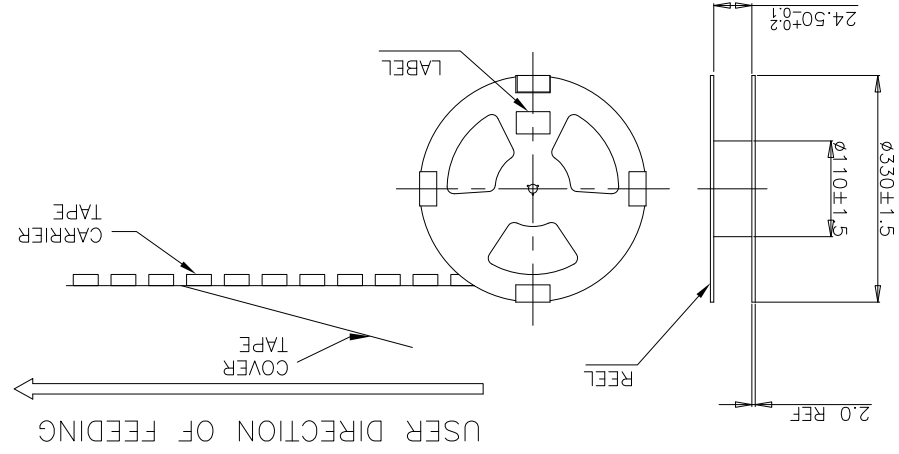
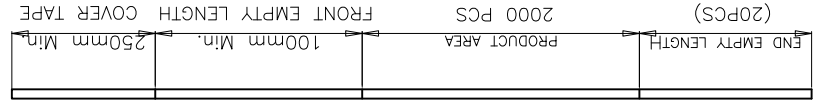
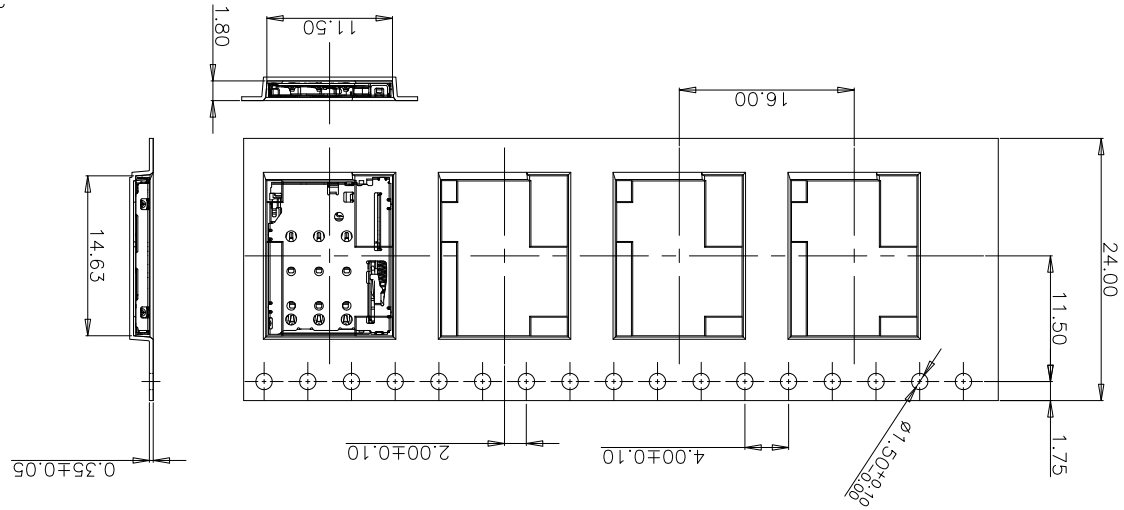

产品料号	一盘产品数量	卷盘数量(N)	一箱产品数量
HXC214-SIM06-125	2000	8	16000 PCS
CONN. PART NO.	CONN. QTY./REEL	REEL QTY./CARTON	CONN. QTY./CARTON

- 1.材料(Material): PET,THICKNESS:0.35±0.05mm,COLOUR:TRANSPARENT
- 2.产品/卷盘/数量表(PRODUCT/REEL/QTY TABLE)
- 3.包装ESD要求:  $10^4 \sim 10^9 \Omega$ (包括载体, 盖带, 卷盘)



深圳市华宇创精密电子有限公司

SCALE:1:1	SIZE: A4	柯南	2014-02-23	SHEET NO.	1 OF 1
UNIT: mm [inch]		马跃	2014-02-23	DRAW NO.	
X.X ±2	X.X ±0.5	陈一鸣	2014-02-23	MOLD NO.	
X.XX ±0.15	X.XX ±0.25	陈一鸣	2014-02-23	PART NO.	
TOLERANCE:		PART NAME: 包装图			
DRAWN BY :	DATE :	DRAWN BY :			
CHECKED BY :	DATE :	CHECKED BY :			
APPROVED BY :	DATE :	APPROVED BY :			

## X-ON Electronics

Largest Supplier of Electrical and Electronic Components

*Click to view similar products for [Standard Card Edge Connectors](#) category:*

*Click to view products by [HOAUC](#) manufacturer:*

Other Similar products are found below :

[6565204-6](#) [PKC-156](#) [1437274-4](#) [147889-1](#) [1489165-4](#) [EBT156-12B1X](#) [EBT15622B2X](#) [EBT156-22R2W](#) [1-582587-1](#) [1-582589-1](#) [2-6437275-9](#) [284-0102-12100](#) [306022901000000](#) [307-012-502-202](#) [307-024-526-201](#) [307-056-520-300](#) [307-080-526-208](#) [1926088-2](#) [245-062-520-350](#) [287-0032-12101](#) [306-010-500-112](#) [306-028-525-102](#) [306-240-318](#) [307-036-502-202](#) [307-036-521-301](#) [307-072-526-202](#) [345-060-559-303](#) [368-004-520-201](#) [392-008-559-201](#) [534671-1](#) [5-530501-5](#) [341-240-317](#) [345-029-520-300](#) [345-030-500-301](#) [345-044-500-300](#) [345-220-058](#) [346-240-318](#) [357-030-526-201](#) [387-012-523-300](#) [395-044-520-300](#) [395-100-524-300](#) [50-12B-10](#) [50-6SN-5](#) [09-07-2032](#) [10035388-106LF](#) [10035388-802LF](#) [10115859-011LF](#) [10122859-009LF](#) [101269333204245CLF](#) [10127905-B04B24BLF](#)