

Detail H (Scale : 5:1)

| Pin No | Signal Name | Mating Sequence | Pin No | Signal Name | Mating Sequence |
|--------|-------------|-----------------|--------|-------------|-----------------|
| A1 | GND | First | B12 | GND | First |
| A2 | TX1+ | Second | B11 | RX1+ | Second |
| A3 | TX1- | Second | B10 | RX1- | Second |
| A4 | Vbus | First | B9 | Vbus | First |
| A5 | CC1 | Second | B8 | SBU2 | Second |
| A6 | D+ | Second | B7 | D- | Second |
| A7 | D- | Second | B6 | D+ | Second |
| A8 | SBU1 | Second | B5 | CC2 | Second |
| A9 | Vbus | First | B4 | Vbus | First |
| A10 | RX2- | Second | B3 | TX2- | Second |
| A11 | RX2+ | Second | B2 | TX2+ | Second |
| A12 | GND | First | B1 | GND | First |
| SHELL | GND | | SHELL | GND | |

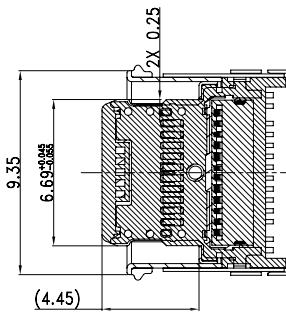
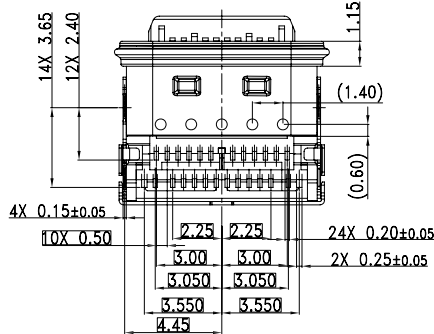
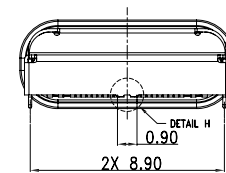
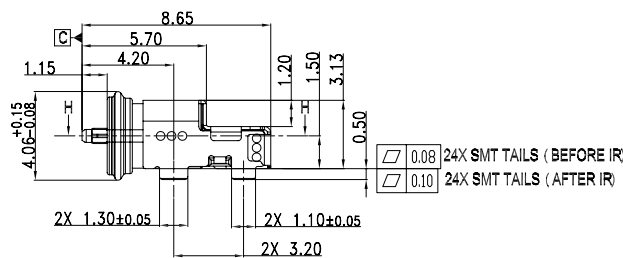
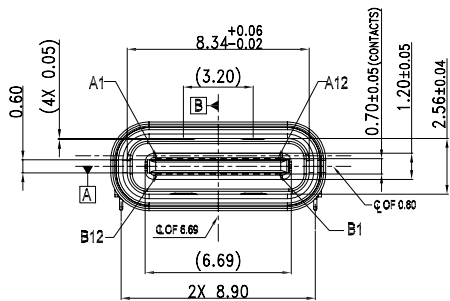

SECTION H-H (SCALE 1:1)

SIDE LASER POINT X3 TOP LASER POINT X10

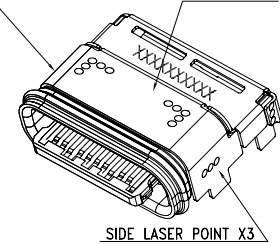

FRONT&BACK LASER POINT 2X5

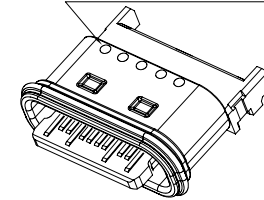

深圳市华宇创精密电子有限公司

| | | | |
|--|--------------------|----------------------|--|
| TOLERANCE: X.X ±0.30 X.XX ±0.25 X.XXX ±0.15 X.' ±2' X.X' ±0.5' | DRAWN BY : 陈一鸣 | DATE : 2014-02-23 | PART NAME: USB TYPE C 母座防水24P CH=1.5mm 双排SMT带铁壳 |
| | CHECKED BY: 马跃 | DATE : 2014-02-23 | PART NO. : HYCW270-USBC24-150B |
| UNIT: mm [inch] SCALE:1:1 SIZE: A4 | APPROVED BY: 邱敏 | DATE : 2014-02-23 | DRAW NO. : HYC-2107191356 |
| | | | SHEET NO. : 1 OF 1 |

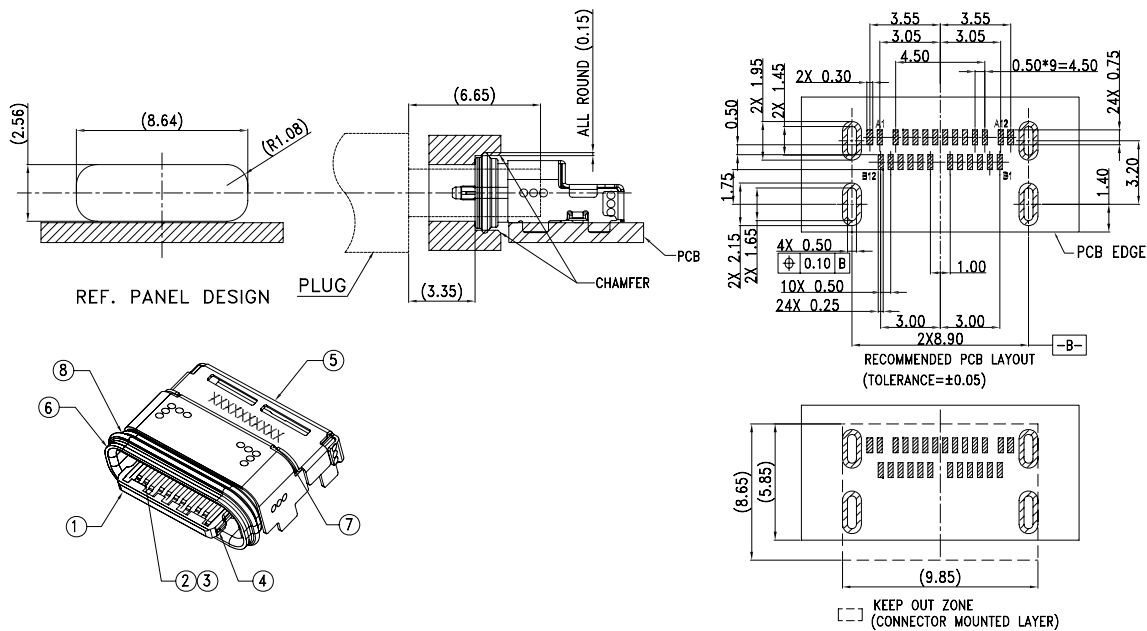

NOTES/注释:

- MATERIAL/材料: SEE TABLE/见下表
- GENERAL SPECIFICATION/通用特性:
 - COPLANARITY /共面度: 0.10 Max.
 - CURRENT RATING: 5A / 额定电流: 5安培
 - CONTACT RESISTANCE: 40mΩ MAX (INITIAL). INSULATION RESISTANCE: 100MΩ Min
接触电阻: 40毫欧最大(初始值) / 绝缘电阻: 100MΩ Min
 - DIELECTRIC WITHSTANDING VOLTAGE: 100 VAC
耐电压: 100伏交流
 - MECHANICAL CHARACTERISTICS:
INSERTION FORCE: 5~20N EXTRACTION FORCE: 8~20N
力率特性: 初始插入力: 5~20N 拔出力: 8~20N
耐久后拔出力: 6~20N
 - DURABILITY: 10000 CYCLES / 耐久性: 10000次
 - PACKAGING TYPE: CARRIER TAPE./ 包装类型: 载带包装
- WATERPROOF CLASS IPX8 /防水等级 IPX8
- DIMENSIONING SHALL BE INTERPRETED PER ASME Y14.5M 1994.
尺寸标注基于ASME Y14.5M 1994标准规范
- MATERIAL SHOULD BE FULFILLED AMPHENOL SPEC.# S-SN-002, FOR HALOGEN FREE PRODUCTS, ALSO NEED TO MEET S-SN-004.
产品材料环保标准为Amphenol SSN#002,如果是无卤产品需满足标准SSN#004

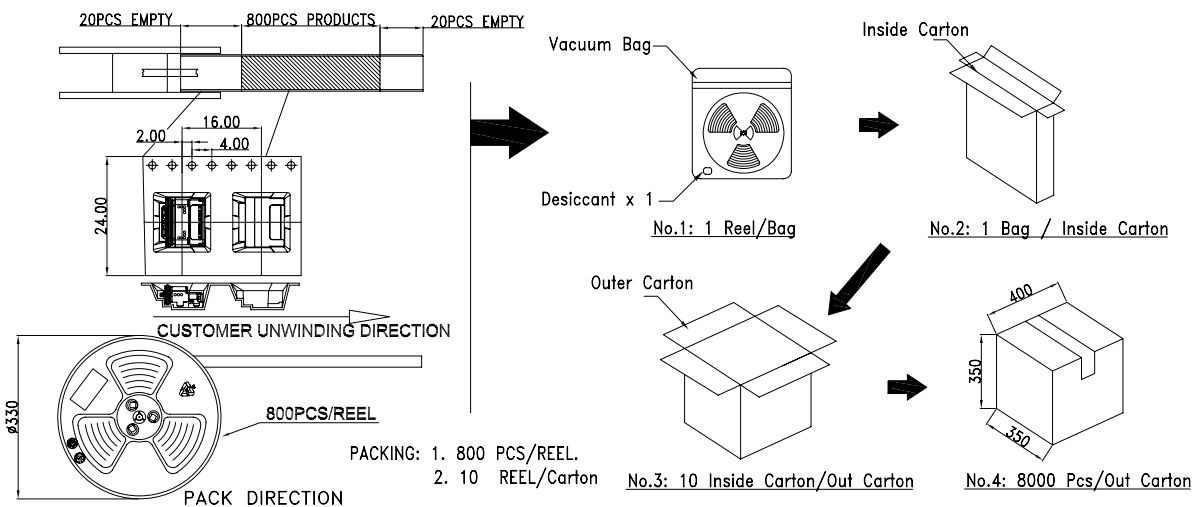

| ITEM | DESCRIPTION | Q'TY | MATERIAL | |
|------|-----------------|------|--------------------------|---|
| 8 | LIM | 1 | CHN-LIMS | BLACK |
| 7 | SMALL SHELL | 1 | STAINLESS STEEL | NI PLATED OR CLEANING |
| 6 | MAIN SHELL | 1 | STAINLESS STEEL | NI PLATED OR CLEANING |
| 5 | OUTOR SHELL | 1 | STAINLESS STEEL | SOLDER NICKEL: 30" MIN |
| 4 | MID PLATE | 1 | STAINLESS STEEL | NICKEL: 30U" MIN |
| 3 | BOTTOM TERMINAL | 1 | COPPER ALLOY | MATING AREA : AU50"MIN SOLDER TAIL:AU 3~8u", 50~150u" NICKEL OVERALL |
| 2 | TOP TERMINAL | 1 | COPPER ALLOY | MATING AREA : AU50"MIN SOLDER TAIL:AU 3~8u", 50~150u" NICKEL OVERALL |
| 1 | MOLDING HOUSING | 1 | HIGH TEMPERATURE PLASTIC | BLACK |
| | | | | |

BILL OF MATERIAL



深圳市华宇创精密电子有限公司

| | | | |
|--|--------------------|----------------------|--|
| TOLERANCE: X.X ±0.30 X.XX ±0.25 X.XXX ±0.15 X." ±2" X.X" ±0.5" | DRAWN BY : 陈一鸣 | DATE : 2014-02-23 | PART NAME: USB TYPE C 母座防水24P CH=1.5mm 双排SMT带铁壳 |
| | CHECKED BY: 马跃 | DATE : 2014-02-23 | PART NO. HYCW270-USBC24-150B |
| UNIT: mm [inch] SCALE:1:1 SIZE: A4 | APPROVED BY: 邱敏 | DATE : 2014-02-23 | MOLD NO. |
| | | | DRAW NO: HYC-2107191356 |
| | | | SHEET NO. 1 OF 1 |

X-ON Electronics

Largest Supplier of Electrical and Electronic Components

Click to view similar products for [USB Connectors](#) category:

Click to view products by [HOAUC](#) manufacturer:

Other Similar products are found below :

[950](#) [MUSBD11135](#) [17-200721](#) [217450-1](#) [KMBVX-TH-5S-B30](#) [KUSBX-AS2N-W](#) [KUSBX-SMT2AP1S-W30](#) [935](#) [957](#) [30-498-6](#) [SK-60A-2](#)
[1734082-1](#) [30-470](#) [30-489](#) [30-541](#) [A-USB A-2P-C](#) [MIKROE-1451](#) [USBFTVSCCG](#) [1-1734084-2](#) [10135326-001LF](#) [4198](#) [USB-A-D-VT](#)
[USB-A-S-RA-TSMT](#) [1310-1023-02](#) [690-024-633-031](#) [UB-20PMFP-LC7001](#) [17-200011](#) [UB-20AFMM-LL7A01](#) [1040870124](#) [CAP-](#)
[WCCMLPB1](#) [CAP-WCCMLPC1](#) [2274475-3](#) [UB-20BMFA-SL8001](#) [914-614A2025S10200](#) [USB3FTV7SAGF059](#) [ZX40-B-5S-1500-](#)
[STDA\(30\)](#) [GSB3116344HR](#) [USB3FTV2SAZNF459](#) [USB3FTV7SAZNF459](#) [U221-041N-1WVS62-F5D](#) [HYCW153-USBD05-500B](#)
[HYCW219-USBD05-075B](#) [HYCW148-USBD05-117B](#) [HYCW149-USBD05-740B](#) [HYCW204-USBD05-108B](#) [HYCW214-USBA04-113B](#)
[HYCW213-USBA04-113B](#) [UB-20AMFM-SL7A01](#) [KMMX-BSMT35S-1-B30TR](#) [2345986-1](#)