



电力系统过流保护 RoHS&Pb-Free  
Power System Overcurrent Protection

好利® 熔断器



# 产品规格书

## PRODUCT SPECIFICATION

HE7EV 750V DC

编号: A01 HLD-PSI-1268 2022/8/11

制定:

颜文瑞

2022.8.9

PREPARED BY

审核:

朱泽江

2022.8.9

CHECKED BY

批准:

苏毅镇

2022.8.9

APPROVED BY



好利来(厦门)电路保护科技有限公司  
Hollyland (Xiamen) Technology Corporation Limited  
福建厦门市翔安区舩山东二路829号361101  
T +86 592 577 2288  
M sdxm@hollyfuse.com  
Www.hollyfuse.com



## 目录

### Table of Contents

一、产品基本资料Basic Information	3
二、产品构造图及尺寸Dimensions	4
三、特性曲线Characteristic curve	4
四、运输和存储 Transportation and Storage	5
五、工作和使用条件 Working and Operating Instructions	5
六、包装要求 Packing details	7

一、产品基本资料 Basic Information

- 1、产品标准 Standard: ISO8820-8、GB/T 31465.6、JASO D622、UL248
- 2、额定电压 Voltage: 750V DC
- 3、额定电流 Current: 10A-100A
- 4、保护类别 Class of Operation: EV
- 5、分断能力 Breaking Capacity: 50kA @10-100A
- 6、环境 Environmental: RoHS Compliant, REACH, ELV
- 7、产品目录编号 Part No.:

序号	目录编号 Part No.	额定电流 RatedCurrent	I <sup>2</sup> T值		功耗 Watts Loss (W)
			Pre-arc	Total	
1	HE7EV10	10A	5.7	65	3.1W
2	HE7EV16	16A	15	170	3.8W
3	HE7EV20	20A	37	425	4.6W
4	HE7EV25	25A	58	695	5.8W
5	HE7EV32	32A	102	1 190	7 W
6	HE7EV40	40A	171	2 030	8.1W
7	HE7EV50	50A	303	3 720	9.2W
8	HE7EV63	63A	485	5 900	10W
9	HE7EV80	80A	810	9 750	12W
10	HE7EV100	100A	1 310	16 600	16W
10-100A 螺栓Bolts: M6 扭矩Torque: 6N.m					

本系列产品为道路汽车用熔断器，其安装空间小、分断能力高。该熔断器有良好的抗强温度冲击、机械振动/冲击、电流脉冲等能力。

This series of products are fuses for electric vehicles, which have small installation space and high breaking capacity. The fuse has good resistance to strong temperature shock, mechanical vibration / shock, current pulse and other capabilities.

## 二、产品构造图及尺寸 Dimensions

Part No.: HE7EV (amp rating)

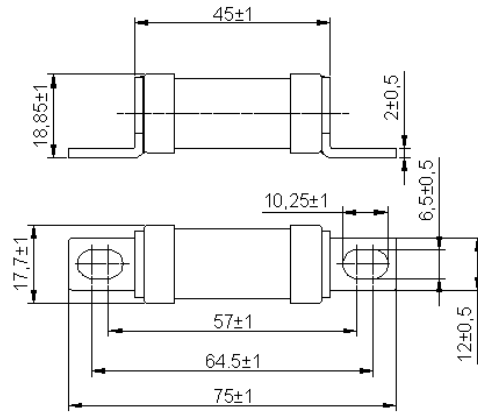

## 三、时间-电流曲线图 THE AVERAGE I-T CHARACTERISTICS CURVE

HE7EV平均 I-T 曲线图 (仅供参考)  
HE7EV AVERAGE I-T CHARACTERISTICS CURVE  
(FOR REFERENCE)

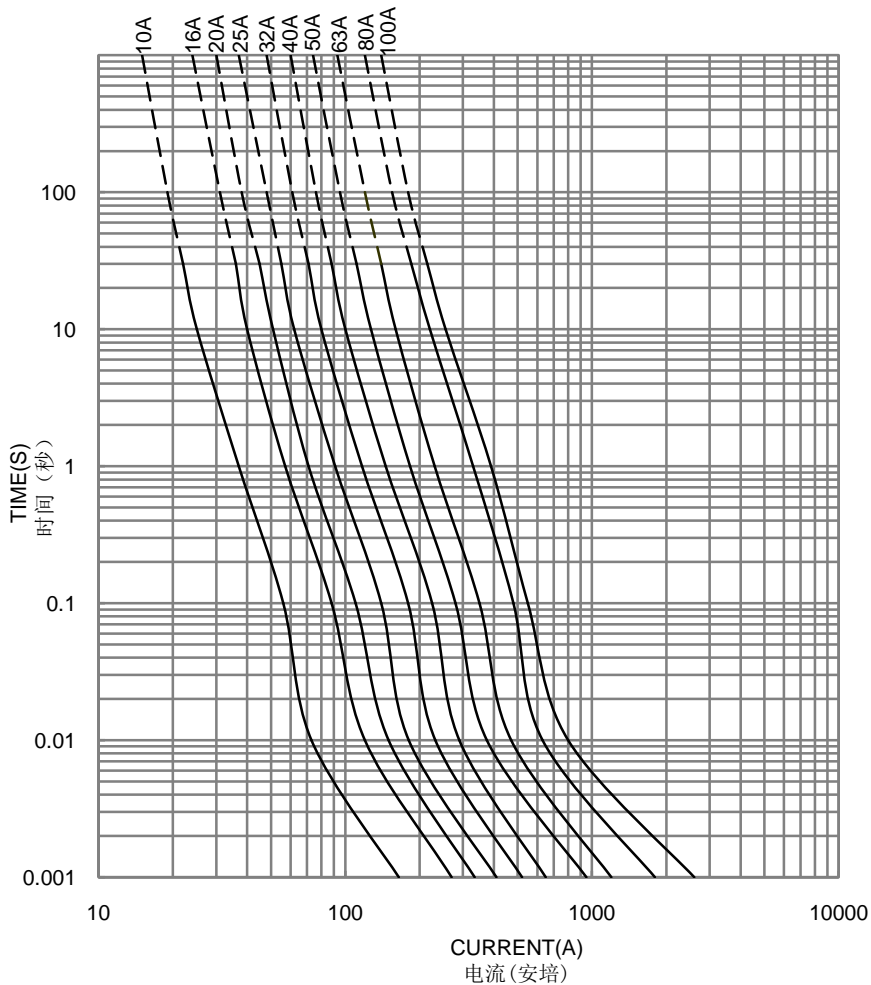

## 四、运输和存储 Transportation and Storage

### 1、运输 Transportation

包装箱运输过程中应避免雨雪侵袭和机械损伤。

Avoid rain and snow invasion and mechanical damage during the transportation of packing cases.

### 2、存储 Storage

产品存储温度：-40℃~+70℃。在 40℃及以上时相对湿度不大于 50%，在 20℃以下，相对湿度不大于 90%。

Product storage temperature: -40 °C ~+70 °C. The relative humidity is not more than 50% at 40 °C and above, and the relative humidity is not more than 90% below 20 °C.

## 五、工作和使用条件 Working and Operating Instructions

### 1、环境温度 Ambient temperature

使用条件 Operating Temperature: -40℃~+125℃

环境温度修正曲线 Ambient temperature correction curve:

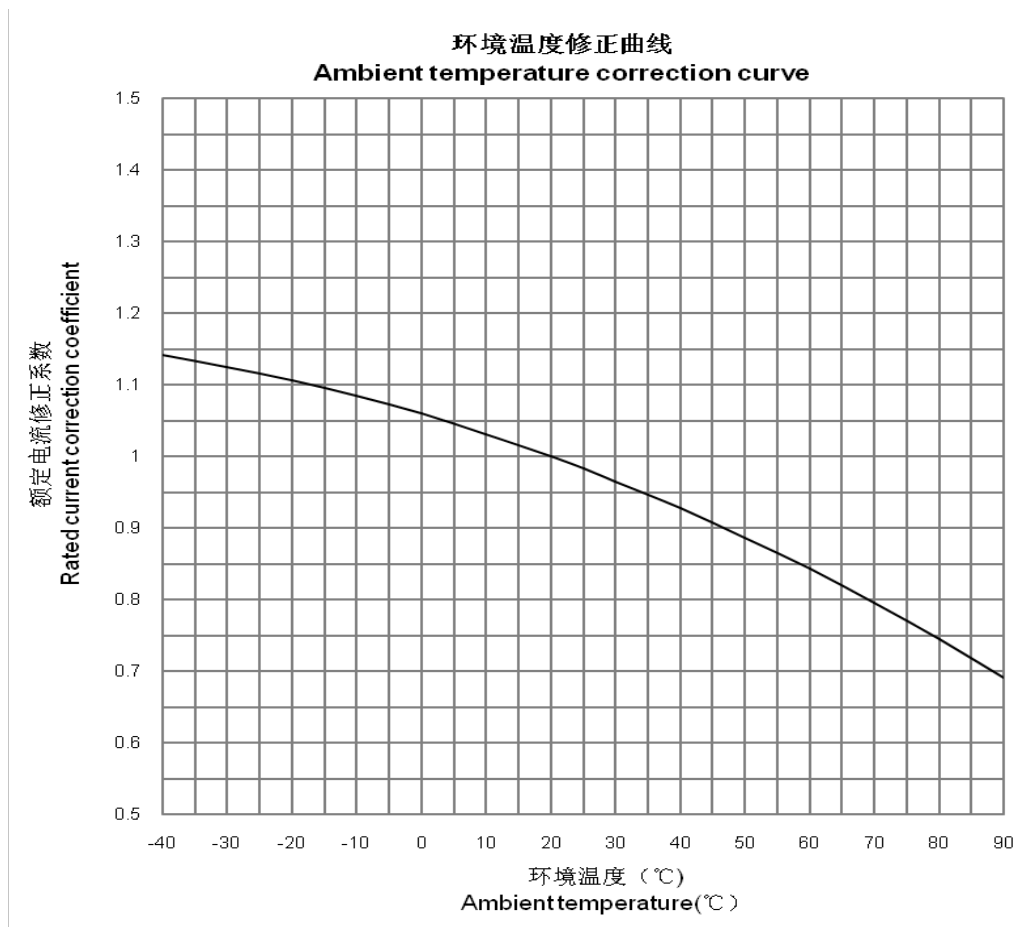

## 2、海拔高度 Altitude

正常使用海拔高度不超过 2000 米，当超过 2000 米，熔断器的额定电流需进行修正：

When fuses are used at high altitudes, the current rating should be corrected, the correction factor is shown in the following table:

$$K = 1 - \left( \frac{h - 2000}{100} \times \frac{0.5}{100} \right)$$

## 3、大气条件 Atmospheric conditions

在最高温度 40° C 时，空气清洁，相对湿度不超过 50%。

在较低的温度下允许较高的相对湿度，例如在 20° C 时为 90%。

在这些条件下，由于温度变化，偶尔会发生中度冷凝

The air is clean and its relative humidity does not exceed 50 % at the maximum temperature of 40 °C.

Higher relative humidity is permitted at lower temperatures, for example, 90 % at 20 °C.

Under these conditions, moderate condensation may occasionally occur due to variation in temperature.

## 4、使用条件 Conditions of use

熔断器安装在无通风的环境，附近有其它发热元件或散热部件，请参照环境温度对熔断器额定电流值进行降容。

熔断器如安装在较小的密闭空间，因散热能力较差，额定电流值建议按 0.8 倍系数修正。

应用在电动车辆时，周围温度变化、负荷有规律或无规律的波动等会引起熔体温度变化，这些循环的温度变化会熔体产生机械疲劳老化，选用时建议对熔断器留有 1.3 倍的安全裕量。

The fuse is installed in an unventilated environment, there are other heating elements or heat dissipation components nearby, please refer to the ambient temperature to reduce the rated current value of the fuse.

If the fuse is installed in a small confined space, due to poor heat dissipation ability, the rated current value is recommended to be corrected by 0.8 times.

When applied to electric vehicles, changes in ambient temperature, regular or irregular fluctuations in load will cause changes in melt temperature, and these cyclic temperature changes will cause mechanical fatigue aging of the melt, and it is recommended to leave a safety margin of 1.3 times for the fuse when selecting.

### 5、抗震能力 Seismic resistance

本系列熔断器有良好的抗振动和冲击的耐受能力，可承受 20g 以上的加速度。

本系列熔断器抗振动和冲击的耐受能力，符合轨道交通 II 类应用环境。

本系列熔断器抗振动和冲击的耐受能力，符合一般机动车辆使用。

振动较为强烈的应用环境，可与我司商议确认。

This series of fuses has good resistance to vibration and shock, and can withstand acceleration of more than 20g.

The resistance of this series of fuses to vibration and shock is in line with the application environment of class II of rail transit.

This series of fuses is resistant to vibration and shock, and is in line with the use of general motor vehicles.

The application environment with strong vibration can be confirmed by consultation with our company.

### 六、包装要求 Packing details

包装方式 PACKING MODE : HE7EV 10A-100A

- 1.小盒参考尺寸Small Box Size: 长×宽×高length × width × height=78×68×26mm。
- 2.外箱参考尺寸External Carton Size: 长×宽×高length × width × height=370×315×318mm。
- 3.包装要求: 3个/小盒; 160小盒/箱。

Packaging requirements: 3 piece / small box; 160 small boxes / box.

所有产品的包装应能达到防潮、抗振的作用，以防在运输或贮存过程中产品受潮或损坏。

The packaging of all products shall be able to resist moisture and vibration, so as to prevent the products from moisture or damage during transportation or storage.

## X-ON Electronics

Largest Supplier of Electrical and Electronic Components

*Click to view similar products for [Specialty Fuses](#) category:*

*Click to view products by [HOLLY](#) manufacturer:*

Other Similar products are found below :

[ECF-1](#) [ECF-1/2](#) [ECF-2](#) [ECF-3](#) [ECF-4](#) [170M1418](#) [N-2-1/2](#) [N-3-2/10](#) [S-2](#) [170M1564D](#) [170M4241](#) [ABS-25](#) [ABS-30](#) [ABS-8](#) [FWP-25A14FI](#)  
[FWP-80A22FI](#) [30CIF06](#) [TJD](#) [TPL-BL](#) [KLC40](#) [NITD25](#) [04450080FX850](#) [NITD16](#) [ECF-5](#) [TDC180-10](#) [TPM-25](#) [170M3509](#) [DEO200](#)  
[004117001](#) [45ET](#) [170M5810D](#) [10H07C](#) [SDL-2](#) [CC12M10A](#) [TDC600-2-R](#) [CBW57-HB-15A-P](#) [CBW58-HL4-30A-5C](#) [CBW58-HS-15A-5C](#)  
[CBW58-HS-20A-5C](#) [0AALBK300-BA](#) [170M8211](#) [STD2](#) [STD4](#) [4D27FB](#) [6H07-660](#) [15.5CAVH1E](#) [170M1360](#) [011-9926](#) [AD32](#) [AD16](#)