

1 2 3 4 5 6 7 8 9

G

F

E

D

C

B

A

G

F

E

D

C

B

A

### SPECIFICATIONS

Current Rating: 1.5 Amps  
 Insulation Resistance: 1000MΩ Min  
 Contact Resistance: 20mΩ Max  
 Withstanding Voltage: AC 500V  
 Operation Temperature: -40° to +105°  
 Contact Material: Brass  
 Standard: PA6T  
 Insulator Material: Polyester  
 Contact Plating: Gold Flash  
 Max. Processing Temp: 240° C for 30-60seconds  
 (260° C for 5 seconds)

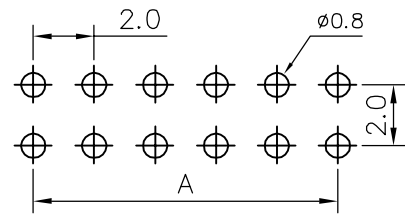
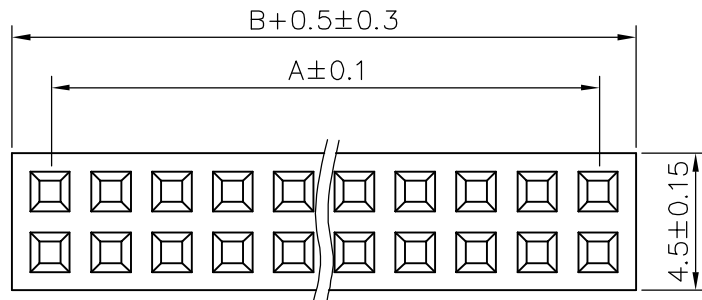

RECOMMEND P. C. B LAYOUT  
 PCB TOLERANCE:  $\pm 0.05$  (TOP VIEW)

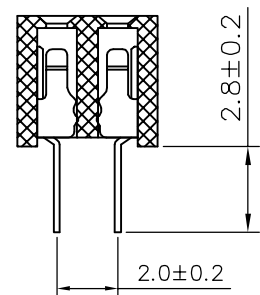
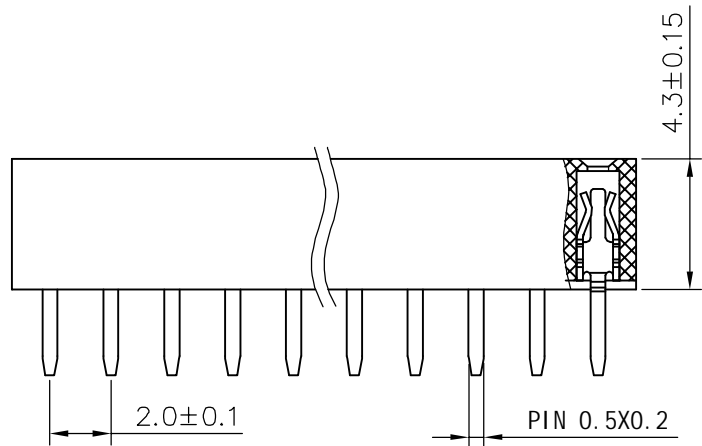

# 深圳市虹成电子有限公司

UNLESS OTHERWISE SPECIFIED TOLERANCE  
 X :  $\pm 0.3$  X° :  $\pm 5^\circ$   
 X.X :  $\pm 0.2$  X.X° :  $\pm 1^\circ$   
 X.XX :  $\pm 0.1$  X.XX° :  $\pm 0.5^\circ$

DRAWING NAME: 2.0FH 2xPi n H4.3 DIP

|      |    |       |     |             |                     |
|------|----|-------|-----|-------------|---------------------|
| SIZE | A4 | SCALE | N:1 | PROJECT NO. | HC-PM200-4.3H-2x9PZ |
| REV  | A  | UNIT  | mm  | PROJECT     | PAGE 1/1            |

CHECKED: LI BEI LIN 12/03/07 CHECKED: / / APPROVED: / /

| No. of | DIM. A | DIM. B | No. of | DIM. A | DIM. B | No. of | DIM. A | DIM. B | No. of | DIM. A | DIM. B |
|--------|--------|--------|--------|--------|--------|--------|--------|--------|--------|--------|--------|
| 1      | 0.00   | 2.00   | 11     | 20.00  | 22.00  | 21     | 40.00  | 42.00  | 31     | 60.00  | 62.00  |
| 2      | 2.00   | 4.00   | 12     | 22.00  | 24.00  | 22     | 42.00  | 44.00  | 32     | 62.00  | 64.00  |
| 3      | 4.00   | 6.00   | 13     | 24.00  | 26.00  | 23     | 44.00  | 46.00  | 33     | 64.00  | 66.00  |
| 4      | 6.00   | 8.00   | 14     | 26.00  | 28.00  | 24     | 46.00  | 48.00  | 34     | 66.00  | 68.00  |
| 5      | 8.00   | 10.00  | 15     | 28.00  | 30.00  | 25     | 48.00  | 50.00  | 35     | 68.00  | 70.00  |
| 6      | 10.00  | 12.00  | 16     | 30.00  | 32.00  | 26     | 50.00  | 52.00  | 36     | 70.00  | 72.00  |
| 7      | 12.00  | 14.00  | 17     | 32.00  | 34.00  | 27     | 52.00  | 54.00  | 37     | 72.00  | 74.00  |
| 8      | 14.00  | 16.00  | 18     | 34.00  | 36.00  | 28     | 54.00  | 56.00  | 38     | 74.00  | 76.00  |
| 9      | 16.00  | 18.00  | 19     | 36.00  | 38.00  | 29     | 56.00  | 58.00  | 39     | 76.00  | 78.00  |
| 10     | 18.00  | 20.00  | 20     | 38.00  | 40.00  | 30     | 58.00  | 60.00  | 40     | 78.00  | 80.00  |

1 2 3 4 5 6 7 8 9

## X-ON Electronics

Largest Supplier of Electrical and Electronic Components

*Click to view similar products for [Headers & Wire Housings](#) category:*

*Click to view products by [Hong Cheng](#) manufacturer:*

Other Similar products are found below :

[0015917161](#) [0022155065](#) [57102-F02-18ULF](#) [58102-G61-06LF](#) [582553-1](#) [01.001.5753.1](#) [0050291907](#) [02.125.8002.8](#) [609-3404](#) [61062-3](#)  
[CSU011177004](#) [622-0430](#) [622-3653LF](#) [63453-116](#) [636-1030](#) [636-1427](#) [636-3427](#) [636-4007](#) [641938-9](#) [65495-038](#) [65692-001LF](#) [65781-018](#)  
[65781-047](#) [65817-010LF](#) [65817-015LF](#) [67095-007LF](#) [67601157](#) [68631-112](#) [68645-018](#) [699319-000](#) [70.362.1628.0](#) [70-4210](#) [70-4226B](#) [70-](#)  
[4853B](#) [71.350.2428.0](#) [733-134](#) [733-162](#) [760-3052](#) [MHR-64-VUAL](#) [80.063.4001.1](#) [800-90-001-10-001000](#) [801-43-002-10-013000](#)  
[801-43-006-10-002000](#) [803-43-024-10-001000](#) [803-93-012-10-001000](#) [8-1437020-4](#) [819-22-004-30-001101](#) [820-22-006-30-001101](#)  
[820-22-008-30-001101](#) [821-22-002-10-001101](#)