

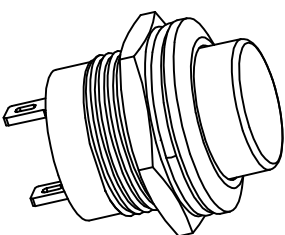

PB-02

受控文件

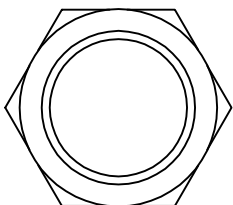

Rating: 6A 125V AC ;
 3A 250V AC ;
 Contact Resistance: 50mΩ Max. ;
 Insulation Resistance:DC 500V 100MΩ Min. ;
 Dielectric Strength:AC 1000V 1 minute
 Total Travel: 2.4±0.4mm
 Operating Force:250±50gf
 Operating Life:50,000 cycles
 Operating Temperature:0°C~85°C
 Function: OFF-(ON)

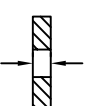
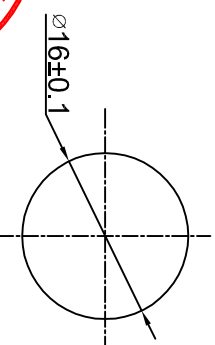
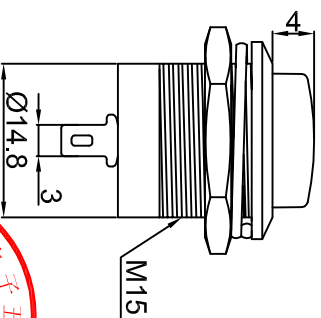
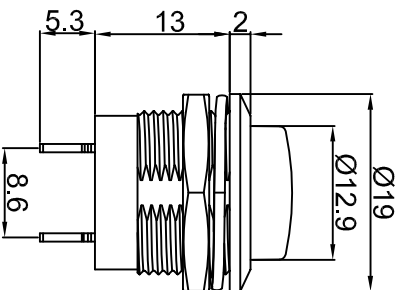

Panel Thickness: 3mm MAX.

CUT-OUT

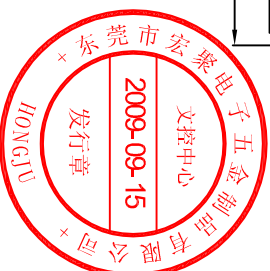

Y	Yellow	黄色
W	White	白色
U	Blue	蓝色
R	Red	红色
O	Orange	橙色
G	Green	绿色
B	Black	黑色
A	Gray	灰色
CAP COLOR (X)		

MATERIAL
 Base: PA66, UL rated :94V-2 Min. ;
 Cap: ABS ;
 Terminal: Copper, Silver or Tin plated ;
 Nut: Brass, Ni plated.

公差 TOLERANCES		.X±0.3	.XX±0.15	角度 ANGLE ±1°	单位 DIMENSION UNIT	mm.	
版本 VERSION	A1	比例尺 SCALE	NONE	日期 DATE	品名 TITLE	图号 DRAWING NO	
批准 APPROVED BY	李新超	核对 CHECKED BY	李伟奇	绘图 DRAWN BY	PB-02-PM-R	PB-02-PM-R_A1	
版本 VER	变更说明 CHANGE DESCRIPTION	日期 DATE	ECN NO.				
A1	图纸重新整理发行	2009.09.15	N/A				
A0	New Issue	2008.07.08	N/A				
版本 VER	变更说明 CHANGE DESCRIPTION	日期 DATE	ECN NO.				

X-ON Electronics

Largest Supplier of Electrical and Electronic Components

Click to view similar products for [Pushbutton Switches](#) category:

Click to view products by [HONGJU](#) manufacturer:

Other Similar products are found below :

[8971K1133](#) [LW1L-M1C10V-A](#) [LW2L-M1C20M-A](#) [M22-D-R-GB0/K11](#) [67081K512X](#) [701PB580](#) [7199K101](#) [810K12910](#) [810KSV30B](#)
[FLT 2U EE 01A](#) [MML21EA2ADK](#) [MML21KA3ABK](#) [MML23KA3AC05K-001](#) [MML23KW3AA01W](#) [8418K2](#) [8442K2](#) [8442K3](#) [8450K1](#)
[860K11911T01A](#) [861901](#) [861K11911T01A07](#) [861K13810T00A14](#) [861K13911](#) [8646AB6X718UL](#) [8646ABUL](#) [9001KXRK](#)
[9533CD4+U574+U4922](#) [95-414.000](#) [99-450.837](#) [99-453.837](#) [PV3H2B0NN-341](#) [A22NZBGANGA](#) [A22NZBMMNGA](#) [A22NZBNANGA](#)
[A22NZMPATRA](#) [A2PMA1X03EC56](#) [A3A-7310](#) [A3A-7340](#) [A3U-TMW-A2C-5M](#) [12037A2ULCSA](#) [1203A2UL](#) [ABGW410-R](#) [ABN400-R](#)
[121382](#) [1213C3](#) [HE3B-M2](#) [121194](#) [1212MRA](#) [1232A6NF](#) [1241.1183.7047](#)