

### 技术参数 SPECIFICATIONS

- 线数 (Poles) : 2~10
- 适用线规 (Applicable wires) : AWG24#~22#
- 适应基板厚度 (Applicable PC board thickness) : 1.2~1.6mm
- 温度范围 (Temperature range) : -25℃~85℃
- 额定电压 (Voltage rating) : 250V.Ac/Dc
- 额定电流 (Current rating) : 2A
- 接触电阻 (Contact resistance) :  $\leq 0.02\Omega$
- 绝缘电阻 (Insulation resistance) :  $\geq 1000M\Omega$
- 耐压 (Withstand voltage) : 1000V.Ac/1min
- 材料 (Material) :  
壳体 (Housing) : 尼龙 (PA66) UL94V-2(0)

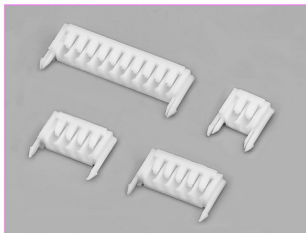

### 适用电线 APPLICABLE WIRE(线扣)

型号 Type	适用线规 Applicable wires mm <sup>2</sup> AWG#	电线外径 O.D of wire ins mm
双绞排接线	0.2~0.33 24~22	1.6

### HX25011-Y(线扣)

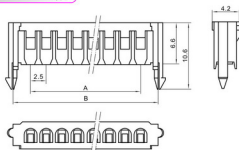

### HX25011-DY(单线扣)

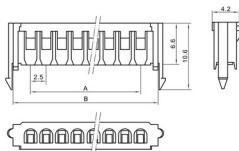

### 适用电线 APPLICABLE WIRE

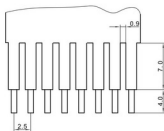

### 安装尺寸 MOUNTING MEASUREMENT

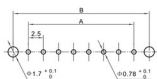
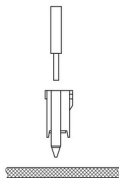

### 壳体 HOUSING(线扣)

线数 Poles	型号 Type	尺寸 Dimensions(mm)	
		A	B
2	HX25011-2Y HX25011-2DY	2.5	7.5
3	HX25011-3Y HX25011-3DY	5.0	10.0
4	HX25011-4Y HX25011-4DY	7.5	12.5
5	HX25011-5Y HX25011-5DY	10.0	15.0
6	HX25011-6Y HX25011-6DY	12.5	17.5
7	HX25011-7Y HX25011-7DY	15.0	20.0
8	HX25011-8Y HX25011-8DY	17.5	22.5
9	HX25011-9Y HX25011-9DY	20.0	25.0
10	HX25011-10Y HX25011-10DY	22.5	27.5

## X-ON Electronics

Largest Supplier of Electrical and Electronic Components

*Click to view similar products for [Headers & Wire Housings](#) category:*

*Click to view products by [Hongxing](#) manufacturer:*

Other Similar products are found below :

[57102-F02-18ULF](#) [58102-G61-06LF](#) [0009485154](#) [009176003701906](#) [0050291907](#) [02.125.8002.8](#) [609-3404](#) [61062-3](#) [622-0430](#) [622-3653LF](#)  
[63453-116](#) [636-1030](#) [636-1427](#) [636-3427](#) [636-4007](#) [641938-9](#) [644827-2](#) [65495-038](#) [65692-001LF](#) [65781-018](#) [65781-047](#) [65817-010LF](#)  
[65817-015LF](#) [66207-023LF](#) [67016-026LF](#) [67095-007LF](#) [68631-112](#) [68645-018](#) [68648-049](#) [699319-000](#) [70.362.1628.0](#) [70-4210](#) [70-4226B](#)  
[70-4853B](#) [707-5020](#) [707-5028](#) [71.350.2428.0](#) [71961-016LF](#) [733-134](#) [754199-000](#) [760-3052](#) [787-8014-00](#) [FCN-367T-T012/H](#) [80.063.4001.1](#)  
[800-90-010-10-002000](#) [801-43-002-10-013000](#) [801-43-006-10-002000](#) [803-41-018-10-001000](#) [803-43-014-20-001000](#) [803-43-024-10-001000](#)