

技术参数 SPECIFICATIONS

- 线数 (Poles) : 2~12
- 适用线规 (Applicable wires) : AWG26#~18#
- 温度范围 (Temperature range) : -25℃~85℃
- 额定电压 (Voltage rating) : 250V.Ac/Dc
- 额定电流 (Current rating) : 7.5A
- 接触电阻 (Contact resistance) : $\leq 0.015\Omega$
- 绝缘电阻 (Insulation resistance) : $\geq 1000M\Omega$
- 耐压 (Withstand voltage) : 1500V.Ac/1min
- 材料 (Material) :
 - 孔座 (Housing) : 尼龙 (Nylon) UL94V-2(0)
 - 针座 (Wafer) : PA-9T UL94V-0
 - 端子 (Terminal) : 磷青铜 (Phos.bronze Tin/plated)
- 包装方式 (Package) : 贴片 (Wafer)
 - 散表 Loosen Package
 - 管装 Pipe Package
 - 磁带 Tape And Reel Package

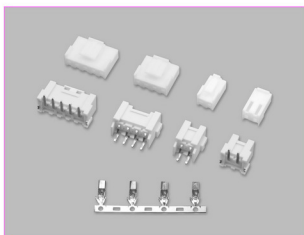

端子 TERMINAL (VH)

型号 Type	适用线规 Applicable wires mm ²	AWG#	电线外径 O.D of wire ins mm	数量 Quantity
HX39600-01PT	0.13~0.33	26~22	1.2~1.8	3000PCS/盘
HX39600-PT	0.33~0.83	22~18	1.7~3.0	3000PCS/盘

HX39600-PT (VH)

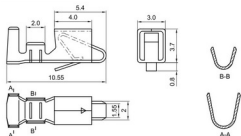

HX39600-Y (VH)

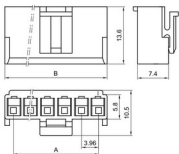

HX39601-AB (VH 立贴)

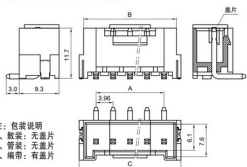

注: 包装说明
1、散表: 无盖片
2、管装: 无盖片
3、磁带: 有盖片

HX39601-AWB (VH 卧贴)

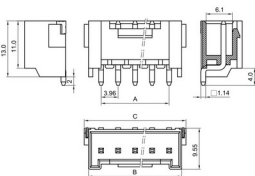

安装尺寸 MOUNTING MEASUREMENT

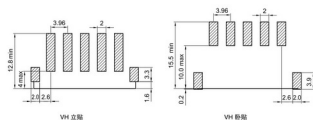

孔座 HOUSING (VH)

线数 Poles	型号 Type	尺寸 Dimensions (mm)	
		A	B
2	HX39600-2Y	3.96	8.06
3	HX39600-3Y	7.92	11.92
4	HX39600-4Y	11.88	15.88
5	HX39600-5Y	15.84	19.84
6	HX39600-6Y	19.80	23.80
7	HX39600-7Y	23.76	27.76
8	HX39600-8Y	27.72	31.72
9	HX39600-9Y	31.68	35.68
10	HX39600-10Y	35.64	39.64
11	HX39600-11Y	39.60	43.60
12	HX39600-12Y	43.56	47.56

针座 WAFER (VH)

线数 Poles	型号 Type			尺寸 Dimensions (mm)		
	立贴 (180°)	卧贴 (90°)		A	B	C
2	HX39601-2AB	HX39601-2AWB		3.96	9.82	11.82
3	HX39601-3AB	HX39601-3AWB		7.92	13.78	15.78
4	HX39601-4AB	HX39601-4AWB		11.88	17.74	19.74
5	HX39601-5AB	HX39601-5AWB		15.84	21.70	23.70
6	HX39601-6AB	HX39601-6AWB		19.80	25.66	27.66
7	HX39601-7AB	HX39601-7AWB		23.76	29.62	31.62
8	HX39601-8AB	HX39601-8AWB		27.72	33.58	35.58
9	HX39601-9AB	HX39601-9AWB		31.68	37.54	39.54
10	HX39601-10AB	HX39601-10AWB		35.64	41.50	43.50
11	HX39601-11AB	HX39601-11AWB		39.60	45.46	47.46
12	HX39601-12AB	HX39601-12AWB		43.56	49.42	51.42



技术参数 SPECIFICATIONS

- 线数 (Poles) : 2~13, 15
- 适用线规 (Applicable wires) : AWG26#~18#
- 适应基板厚度 (Applicable PC board thickness) : 1.6mm
- 温度范围 (Temperature range) : -25°C~85°C
- 额定电压 (Voltage rating) : 250V.Ac/Dc
- 额定电流 (Current rating) : 7.5A
- 接触电阻 (Contact resistance) : $\leq 0.015\Omega$
- 绝缘电阻 (Insulation resistance) : $\geq 1000M\Omega$
- 耐压 (Withstand voltage) : 1500V.Ac/min
- 材料 (Material) :
 - 孔座 (Housing) : 尼龙 (PA66) UL94V-2 (0)
 - 针座 (Wafer) : 尼龙 (PA66) UL94V-2 (0)
 - 端子 (Terminal) : 磷青铜 (Phos.bronze Tin/plated)

端子 (TERMINAL)(VH) 端子与 HX3960-PT (VH) 型端子通用 (P93)

型号 Type	适用线规 Applicable wires	电线外径 O.D of wire ins	数量 Quantity
HX3960-01PT	0.12~0.35 AWG#	26~22	3000PCS/包
HX3960-PT	0.33~0.83	22~18	3000PCS/包

HX39600-Y (VH)



HX39601-BH (VH)



HX39601-WBH (VH)

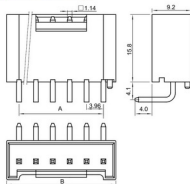

HX39601-WAD (VH)

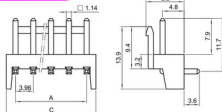

HX39601-WAH (VH)

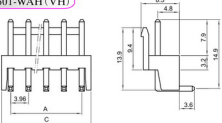

安装尺寸 MOUNTING MEASUREMENT



孔座 HOUSING(VH)

线数 Poles	型号 Type	尺寸Dimensions(mm)	
		A	B
2	HX39600-2Y	3.96	8.06
3	HX39600-3Y	7.92	11.92
4	HX39600-4Y	11.88	15.88
5	HX39600-5Y	15.84	19.84
6	HX39600-6Y	19.80	23.80
7	HX39600-7Y	23.76	27.76
8	HX39600-8Y	27.72	31.72
9	HX39600-9Y	31.68	35.68
10	HX39600-10Y	35.64	39.64
11	HX39600-11Y	39.60	43.60
12	HX39600-12Y	43.56	47.56
13	HX39600-13Y	47.52	51.52
15	HX39600-15Y	55.44	59.44

针座 WAFER(VH)

线数 Poles	型号 Type	尺寸Dimension(mm)			
		定位弯针	加高型针	A B C	
2	HX39601-2WA	HX39601-2BH/WBH	3.96	9.80	7.96
3	HX39601-3WA	HX39601-3BH/WBH	7.92	13.76	11.92
4	HX39601-4WA	HX39601-4BH/WBH	11.88	17.72	15.88
5	HX39601-5WA	HX39601-5BH/WBH	15.84	21.68	19.84
6	HX39601-6WA	HX39601-6BH/WBH	19.80	25.64	23.80
7	HX39601-7WA	HX39601-7BH/WBH	23.76	29.60	27.76
8	HX39601-8WA	HX39601-8BH/WBH	27.72	33.56	31.72
9	HX39601-9WA	HX39601-9BH/WBH	31.68	37.52	35.68
10	HX39601-10WA	HX39601-10BH/WBH	35.64	41.48	39.64
11	HX39601-11WA	HX39601-11BH/WBH	39.60	45.44	43.60
12	HX39601-12WA	HX39601-12BH/WBH	43.56	49.40	47.56
13	HX39601-13WA	HX39601-13BH/WBH	47.52	53.36	51.48
15	HX39601-15WA	HX39601-15BH/WBH	55.44	61.28	59.40

技术参数 SPECIFICATIONS

- 线数 (Poles) : 2~13, 15
- 适用线规 (Applicable wires) : AWG26#~18#
- 适应基板厚度 (Applicable PC board thickness) : 1.6mm
- 温度范围 (Temperature range) : -25°C~85°C
- 额定电压 (Voltage rating) : 250V.Ac/Dc
- 额定电流 (Current rating) : 7.5A
- 接触电阻 (Contact resistance) : $\leq 0.015\Omega$
- 绝缘电阻 (Insulation resistance) : $\geq 1000M\Omega$
- 耐压 (Withstand voltage) : 1500V.Ac/min
- 材料 (Material) :
 - 孔座 (Housing) : 尼龙 (PA66) UL94V-2(0)
 - 针座 (Wafer) : 尼龙 (PA66) UL94V-2(0)
 - 锁片 (Retainer) : 尼龙 (PA66) UL94V-2(0)
 - 端子 (Terminal) : 磷青铜 (PHos.brnz) Tin/plated

端子 TERMINAL(VH)

型号 Type	适用线规 Applicable wires	电线外径 O.D of wire ins	数量 Quantity
HX39600-01PT	0.12~0.35	26~22	3000PCS/盘
HX39600-PT	0.33~0.83	22~18	3000PCS/盘

HX39600-PT (VH)

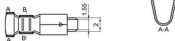
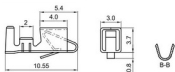

HX39600-Y (VH)

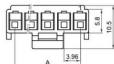

HX39600-HS (VH)

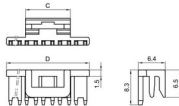

安装尺寸 MOUNTING MEASUREMENT

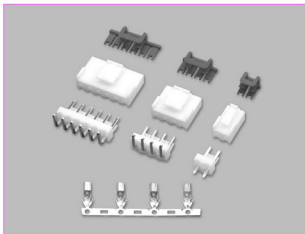
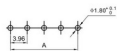

HX39601-A (VH)

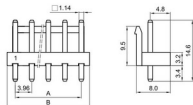

HX39601-WAP (VH)

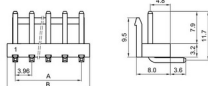

HX39601-WAG (VH)

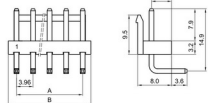

孔座 HOUSIN (VH)

线数 Poles	型号 Type	尺寸 Dimensions(mm)			
		A	B	C	D
2	HX39600-2Y	3.96	8.06	6.85	7.95
3	HX39600-3Y	7.92	11.92	10.7	11.80
4	HX39600-4Y	11.88	15.88	10.7	15.76
5	HX39600-5Y	15.84	19.84	10.7	19.72
6	HX39600-6Y	19.80	23.80	10.7	23.68
7	HX39600-7Y	23.76	27.76	10.7	27.64
8	HX39600-8Y	27.72	31.72	10.7	31.60
9	HX39600-9Y	31.68	35.68	10.7	35.56
10	HX39600-10Y	35.64	39.64	10.7	39.52
11	HX39600-11Y	39.60	43.60	10.7	43.48
12	HX39600-12Y	43.56	47.56	10.7	47.44
13	HX39600-13Y	47.52	51.52		
15	HX39600-15Y	55.44	59.44		

针座 WAFER (VH)

线数 Poles	型号 Type	尺寸 Dimensions(mm)	
		A	B
2	HX39601-2A	3.96	7.92
3	HX39601-3A	7.92	11.88
4	HX39601-4A	11.88	15.84
5	HX39601-5A	15.84	19.80
6	HX39601-6A	19.80	23.76
7	HX39601-7A	23.76	27.72
8	HX39601-8A	27.72	31.68
9	HX39601-9A	31.68	35.64
10	HX39601-10A	35.64	39.60
11	HX39601-11A	39.60	43.56
12	HX39601-12A	43.56	47.52
13	HX39601-13A	47.52	51.48
15	HX39601-15A	55.44	59.40

技术参数 SPECIFICATIONS

- ❑ 线数 (Poles) : 2~15
- ❑ 适用线规 (Applicable wires) : AWG26#~18#
- ❑ 温度范围 (Temperature range) : -25°C~85°C
- ❑ 额定电压 (Voltage rating) : 250V.Ac/Dc
- ❑ 额定电流 (Current rating) : 7.5A
- ❑ 接触电阻 (Contact resistance) : $\leq 0.02\Omega$
- ❑ 绝缘电阻 (Insulation resistance) : $\geq 1000M\Omega$
- ❑ 耐压 (Withstand voltage) : 1500V.Ac/min
- ❑ 材料 (Material) :
 - 插头 (Plug housing) : 尼龙 (PA66) UL94V-2(0)
 - 插座 (Receptacle housing) : 尼龙 (PA66) UL94V-2(0)
 - 插片 (Retainer) : 尼龙 (PA66) UL94V-2(0)
 - 端子 (Terminal) : 磷青铜 (Phos.bronze Tin/plated)
 - 黄铜 (Brass Tin/plated)

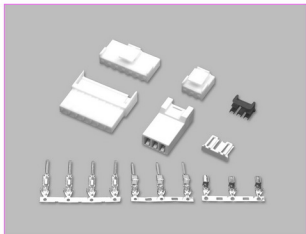

端子 TERMINAL(VH)

型号 Type	适用线规 Applicable wires mm ² / AWG#	电线外径 O.D of wire ins mm	数量 Quantity
HX39600-PT	0.33~0.83	22~18	3000PCS/盘
HX39600-RT	0.33~0.83	22~18	3000PCS/盘
HX39600-GT	0.33~0.83	26~22	3000PCS/盘

端子 TERMINAL

端子与HX39600-PT (VH) 型端子通用 (P93)
Terminal is interchangeable with HX39600-PT (VH) Terminal.(P93)

插头 PLUG HOUSING

孔座与HX39600-Y (VH) 型插头通用 (P93)
Housing is interchangeable with HX39600-Y (VH) Plug housing.(P93)

HX39600-GT (VH)

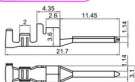

HX39600-G (VH)

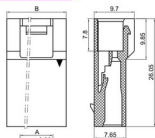

HX39600-GS (VH)

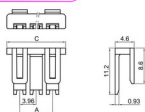

HX39600-RT (VH/SMT396)

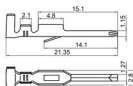

HX39600-R (VH/SMP396)

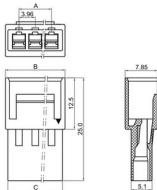

插座 RECEPTACLE HOUSING (VH)

线数 Poles	型号 Type	尺寸 Dimensions (mm)		
		A	B	C
2	HX39600-2G/GS	3.96	10.40	10.24
3	HX39600-3G/GS	7.92	14.36	14.20
4	HX39600-4G/GS	11.88	18.32	18.16
5	HX39600-5G/GS	15.84	22.28	22.12
6	HX39600-6G/GS	19.80	26.24	26.08
7	HX39600-7G/GS	23.76	30.20	30.04
8	HX39600-8G/GS	27.72	34.16	34.0
9	HX39600-9G/GS	31.68	38.12	37.96
10	HX39600-10G/GS	35.64	42.08	41.92
11	HX39600-11G/GS	39.60	46.04	45.88
12	Hx39600-12G/GS	43.56	50.00	49.84
13	HX39600-13G/GS	47.52	53.96	53.80
14	HX39600-14G/GS	51.48	57.92	57.76
15	HX39600-15G/GS	55.44	61.88	61.72

插座 RECEPTACLE HOUSING (VH/SMP396)

线数 Poles	型号 Type	尺寸 Dimensions (mm)		
		A	B	C
2	HX39600-2R	3.96	10.54	9.34
3	HX39600-3R	7.92	14.50	13.30
4	HX39600-4R	11.88	18.46	17.26
5	HX39600-5R	15.84	22.42	21.22
6	HX39600-6R	19.80	26.38	25.18
7	HX39600-7R	23.76	30.34	29.14
8	HX39600-8R	27.72	34.30	33.10
9	HX39600-9R	31.68	38.26	37.06
10	HX39600-10R	35.64	42.22	41.02
11	HX39600-11R	39.60	46.18	44.98
12	HX39600-12R	43.56	50.14	48.94
13	HX39600-13R	47.52	54.10	52.90
14	HX39600-14R	51.48	58.06	56.86
15	HX39600-15R	55.44	62.02	60.82

X-ON Electronics

Largest Supplier of Electrical and Electronic Components

Click to view similar products for [Headers & Wire Housings](#) category:

Click to view products by [Hongxing](#) manufacturer:

Other Similar products are found below :

[57102-F02-18ULF](#) [58102-G61-06LF](#) [582553-1](#) [009176003701906](#) [01.001.5753.1](#) [0050291907](#) [02.125.8002.8](#) [609-3404](#) [61062-3](#)
[CSU011177004](#) [622-0430](#) [622-3653LF](#) [63453-116](#) [636-1030](#) [636-1427](#) [636-3427](#) [636-4007](#) [641938-9](#) [65495-038](#) [65692-001LF](#) [65781-018](#)
[65781-047](#) [65817-010LF](#) [65817-015LF](#) [66207-023LF](#) [67095-007LF](#) [67601157](#) [68631-112](#) [68645-018](#) [699319-000](#) [M90C108951C](#)
[70.362.1628.0](#) [70-4210](#) [70-4226B](#) [70-4853B](#) [707-5028](#) [71.350.2428.0](#) [71961-016LF](#) [733-134](#) [733-162](#) [754199-000](#) [760-3052](#) [80.063.4001.1](#)
[800-90-001-10-001000](#) [800-90-010-10-002000](#) [801-43-002-10-013000](#) [801-43-006-10-002000](#) [803-41-018-10-001000](#) [803-43-024-10-](#)
[001000](#) [803-93-012-10-001000](#)