

## 技术参数 SPECIFICATIONS

- ❑ 线数 (Poles): 2~12
- ❑ 适用线规 (Applicable wires): AWG26#~18#
- ❑ 温度范围 (Temperature range): -25℃~85℃
- ❑ 额定电压 (Voltage rating): 250V.Ac/Dc
- ❑ 额定电流 (Current rating): 7.5A
- ❑ 接触电阻 (Contact resistance):  $\leq 0.015\Omega$
- ❑ 绝缘电阻 (Insulation resistance):  $\geq 1000M\Omega$
- ❑ 耐压 (Withstand voltage): 1500V.Ac/1min
- ❑ 材料 (Material):
  - 孔座 (Housing): 尼龙 (Nylon) UL94V-2(0)
  - 针座 (Wafer): PA-9T UL94V-0
  - 端子 (Terminal): 磷青铜 (Phos. bronze Tin/plated)
- ❑ 包装方式 (Package): 贴片 (Wafer)
  - 散表 Loosen Package
  - 管装 Pipe Package
  - 磁带 Tape And Reel Package

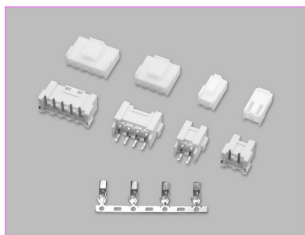

### 端子 TERMINAL (VH)

型号 Type	适用线规 Applicable wires mm <sup>2</sup>	AWG#	电线外径 O.D of wire ins mm	数量 Quantity
HX3960-01PT	0.13~0.33	26~22	1.2~1.8	3000PCS/盘
HX3960-PT	0.33~0.83	22~18	1.7~3.0	3000PCS/盘

### HX3960-PT (VH)

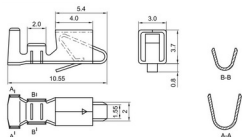

### HX3960-Y (VH)

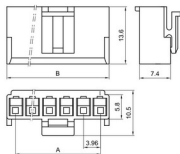

### HX3960-1A (VH 立贴)

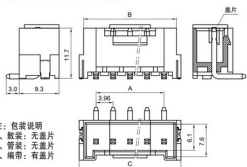

- 注: 包装说明  
1、散表: 无盖片  
2、管装: 无盖片  
3、磁带: 有盖片

### HX3960-1AWB (VH 卧贴)

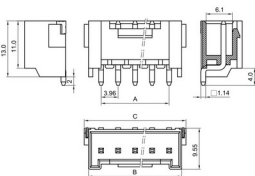

## 安装尺寸 MOUNTING MEASUREMENT

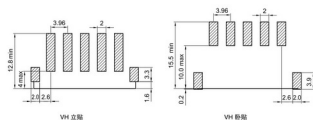

### 孔座 HOUSING (VH)

线数 Poles	型号 Type	尺寸 Dimensions (mm)	
		A	B
2	HX3960-2Y	3.96	8.06
3	HX3960-3Y	7.92	11.92
4	HX3960-4Y	11.88	15.88
5	HX3960-5Y	15.84	19.84
6	HX3960-6Y	19.80	23.80
7	HX3960-7Y	23.76	27.76
8	HX3960-8Y	27.72	31.72
9	HX3960-9Y	31.68	35.68
10	HX3960-10Y	35.64	39.64
11	HX3960-11Y	39.60	43.60
12	HX3960-12Y	43.56	47.56

### 针座 WAFER (VH)

线数 Poles	型号 Type	尺寸 Dimensions (mm)			
		立贴 (180°)	卧贴 (90°)	A B C	
2	HX3960-2AB	HX3960-2AWB	3.96	9.82	11.82
3	HX3960-3AB	HX3960-3AWB	7.92	13.78	15.78
4	HX3960-4AB	HX3960-4AWB	11.88	17.74	19.74
5	HX3960-5AB	HX3960-5AWB	15.84	21.70	23.70
6	HX3960-6AB	HX3960-6AWB	19.80	25.66	27.66
7	HX3960-7AB	HX3960-7AWB	23.76	29.62	31.62
8	HX3960-8AB	HX3960-8AWB	27.72	33.58	35.58
9	HX3960-9AB	HX3960-9AWB	31.68	37.54	39.54
10	HX3960-10AB	HX3960-10AWB	35.64	41.50	43.50
11	HX3960-11AB	HX3960-11AWB	39.60	45.46	47.46
12	HX3960-12AB	HX3960-12AWB	43.56	49.42	51.42



### 技术参数 SPECIFICATIONS

- 线数 (Poles) : 2~13, 15
- 适用线规 (Applicable wires) : AWG26#~18#
- 适应基板厚度 (Applicable PC board thickness) : 1.6mm
- 温度范围 (Temperature range) : -25°C~85°C
- 额定电压 (Voltage rating) : 250V.Ac/Dc
- 额定电流 (Current rating) : 7.5A
- 接触电阻 (Contact resistance) :  $\leq 0.015\Omega$
- 绝缘电阻 (Insulation resistance) :  $\geq 1000M\Omega$
- 耐压 (Withstand voltage) : 1500V.Ac/min
- 材料 (Material) :
  - 孔座 (Housing) : 尼龙 (PA66) UL94V-2 (0)
  - 针座 (Wafer) : 尼龙 (PA66) UL94V-2 (0)
  - 端子 (Terminal) : 磷青铜 (Phos.bronze Tin/plated)

端子 (TERMINAL)(VH) 端子与 HX3960-PT (VH) 型端子通用 (P93)

型号 Type	适用线规 Applicable wires	电线外径 O.D of wire ins	数量 Quantity
HX3960-01PT	0.12~0.35 AWG# 26~22	1.2~1.8 mm	3000PCS/包
HX3960-PT	0.33~0.83 22~18	1.7~3.0	3000PCS/包

HX39600-Y (VH)



HX39601-BH (VH)



HX39601-WBH (VH)

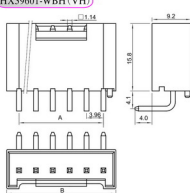

HX39601-WAD (VH)

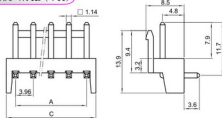

HX39601-WAH (VH)

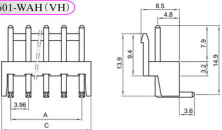

### 安装尺寸 MOUNTING MEASUREMENT



孔座 HOUSING(VH)

线数 Poles	型号 Type	尺寸Dimensions(mm)	
		A	B
2	HX39600-2Y	3.96	8.06
3	HX39600-3Y	7.92	11.92
4	HX39600-4Y	11.88	15.88
5	HX39600-5Y	15.84	19.84
6	HX39600-6Y	19.80	23.80
7	HX39600-7Y	23.76	27.76
8	HX39600-8Y	27.72	31.72
9	HX39600-9Y	31.68	35.68
10	HX39600-10Y	35.64	39.64
11	HX39600-11Y	39.60	43.60
12	HX39600-12Y	43.56	47.56
13	HX39600-13Y	47.52	51.52
15	HX39600-15Y	55.44	59.44

针座 WAFER(VH)

线数 Poles	型号 Type	尺寸Dimension(mm)			
		定位弯针	加高型针	A B C	
2	HX39601-2WA	HX39601-2BH/WBH	3.96	9.80	7.96
3	HX39601-3WA	HX39601-3BH/WBH	7.92	13.76	11.92
4	HX39601-4WA	HX39601-4BH/WBH	11.88	17.72	15.88
5	HX39601-5WA	HX39601-5BH/WBH	15.84	21.68	19.84
6	HX39601-6WA	HX39601-6BH/WBH	19.80	25.64	23.80
7	HX39601-7WA	HX39601-7BH/WBH	23.76	29.60	27.76
8	HX39601-8WA	HX39601-8BH/WBH	27.72	33.56	31.72
9	HX39601-9WA	HX39601-9BH/WBH	31.68	37.52	35.68
10	HX39601-10WA	HX39601-10BH/WBH	35.64	41.48	39.64
11	HX39601-11WA	HX39601-11BH/WBH	39.60	45.44	43.60
12	HX39601-12WA	HX39601-12BH/WBH	43.56	49.40	47.56
13	HX39601-13WA	HX39601-13BH/WBH	47.52	53.36	51.48
15	HX39601-15WA	HX39601-15BH/WBH	55.44	61.28	59.40

### 技术参数 SPECIFICATIONS

- 线数 (Poles) : 2~13, 15
- 适用线规 (Applicable wires) : AWG26#~18#
- 适应基板厚度 (Applicable PC board thickness) : 1.6mm
- 温度范围 (Temperature range) : -25°C~85°C
- 额定电压 (Voltage rating) : 250V.Ac/Dc
- 额定电流 (Current rating) : 7.5A
- 接触电阻 (Contact resistance) :  $\leq 0.015\Omega$
- 绝缘电阻 (Insulation resistance) :  $\geq 1000M\Omega$
- 耐压 (Withstand voltage) : 1500V.Ac/min
- 材料 (Material) :
  - 孔座 (Housing) : 尼龙 (PA66) UL94V-2 (0)
  - 针座 (Wafer) : 尼龙 (PA66) UL94V-2 (0)
  - 锁片 (Retainer) : 尼龙 (PA66) UL94V-2 (0)
  - 端子 (Terminal) : 磷青铜 (PHos. bronze Tin/plated)

### 端子 TERMINAL(VH)

型号 Type	适用线规 Applicable wires	电线外径 O.D of wire ins	数量 Quantity
HX39600-01PT	0.12~0.35	26~22	3000PCS/盘
HX39600-PT	0.33~0.83	22~18	3000PCS/盘

### HX39600-PT (VH)

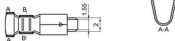
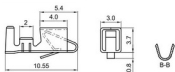

### HX39600-Y (VH)

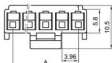
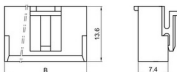

### HX39600-HS (VH)

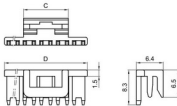

### 安装尺寸 MOUNTING MEASUREMENT

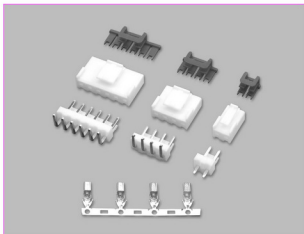
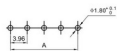

### HX39601-A (VH)

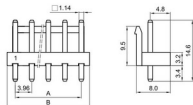

### HX39601-WAP (VH)

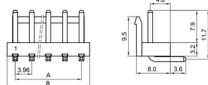

### HX39601-WAG (VH)

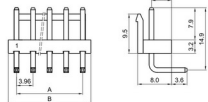

### 孔座 HOUSIN (VH)

线数 Poles	型号 Type	尺寸 Dimensions(mm)			
		A	B	C	D
2	HX39600-2Y	3.96	8.06	6.85	7.95
3	HX39600-3Y	7.92	11.92	10.7	11.80
4	HX39600-4Y	11.88	15.88	10.7	15.76
5	HX39600-5Y	15.84	19.84	10.7	19.72
6	HX39600-6Y	19.80	23.80	10.7	23.68
7	HX39600-7Y	23.76	27.76	10.7	27.64
8	HX39600-8Y	27.72	31.72	10.7	31.60
9	HX39600-9Y	31.68	35.68	10.7	35.56
10	HX39600-10Y	35.64	39.64	10.7	39.52
11	HX39600-11Y	39.60	43.60	10.7	43.48
12	HX39600-12Y	43.56	47.56	10.7	47.44
13	HX39600-13Y	47.52	51.52		
15	HX39600-15Y	55.44	59.44		

### 针座 WAFER (VH)

线数 Poles	型号 Type	尺寸 Dimensions(mm)		
		式式 (180°)	式式 (90°)	
2	HX39601-2A	HX39601-2WA	3.96	7.92
3	HX39601-3A	HX39601-3WA	7.92	11.88
4	HX39601-4A	HX39601-4WA	11.88	15.84
5	HX39601-5A	HX39601-5WA	15.84	19.80
6	HX39601-6A	HX39601-6WA	19.80	23.76
7	HX39601-7A	HX39601-7WA	23.76	27.72
8	HX39601-8A	HX39601-8WA	27.72	31.68
9	HX39601-9A	HX39601-9WA	31.68	35.64
10	HX39601-10A	HX39601-10WA	35.64	39.60
11	HX39601-11A	HX39601-11WA	39.60	43.56
12	HX39601-12A	HX39601-12WA	43.56	47.52
13	HX39601-13A	HX39601-13WA	47.52	51.48
15	HX39601-15A	HX39601-15WA	55.44	59.40

### ■ 技术参数 SPECIFICATIONS

- 线数 (Poles) : 2~15
- 适用线规 (Applicable wires) : AWG26#~18#
- 温度范围 (Temperature range) : -25℃~85℃
- 额定电压 (Voltage rating) : 250V.Ac/Dc
- 额定电流 (Current rating) : 7.5A
- 接触电阻 (Contact resistance) :  $\leq 0.02\Omega$
- 绝缘电阻 (Insulation resistance) :  $\geq 1000M\Omega$
- 耐压 (Withstand voltage) : 1500V.Ac/min
- 材料 (Material) :
  - 插头 (Plug housing) : 尼龙 (PA66) UL94V-2(0)
  - 插座 (Receptacle housing) : 尼龙 (PA66) UL94V-2(0)
  - 插片 (Retainer) : 尼龙 (PA66) UL94V-2(0)
  - 端子 (Terminal) : 磷青铜 (Phos.bronze Tin/plated)  
黄铜 (Brass Tin/plated)

### 端子 TERMINAL(VH)

型号 Type	适用线规 Applicable wires mm <sup>2</sup> AWG#	电线外径 O.D of wire ins mm	数量 Quantity
HX39600-PT	0.33~0.83	22~18	3000PCS/盘
HX39600-RT	0.33~0.83	22~18	3000PCS/盘
HX39600-GT	0.33~0.83	26~22	3000PCS/盘

### ■ 端子 TERMINAL

端子与HX39600-PT (VH) 型端子通用 (P93)  
Terminal is interchangeable with HX39600-PT (VH) Terminal.(P93)

### ■ 插头 PLUG HOUSING

孔座与HX39600-Y (VH) 型插头通用 (P93)  
Housing is interchangeable with HX39600-Y (VH) Plug housing.(P93)

### HX39600-GT (VH)

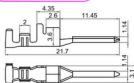

### HX39600-G (VH)

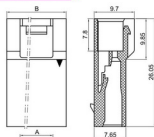

### HX39600-GS (VH)

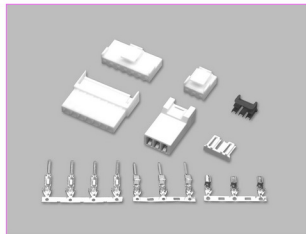
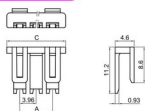

### HX39600-RT (VH/SMT396)

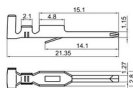

### HX39600-R (VH/SMP396)

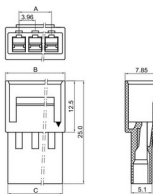

### 插座 RECEPTACLE HOUSING (VH)

线数 Poles	型号 Type	尺寸 Dimensions (mm)		
		A	B	C
2	HX39600-2G/GS	3.96	10.40	10.24
3	HX39600-3G/GS	7.92	14.36	14.20
4	HX39600-4G/GS	11.88	18.32	18.16
5	HX39600-5G/GS	15.84	22.28	22.12
6	HX39600-6G/GS	19.80	26.24	26.08
7	HX39600-7G/GS	23.76	30.20	30.04
8	HX39600-8G/GS	27.72	34.16	34.0
9	HX39600-9G/GS	31.68	38.12	37.96
10	HX39600-10G/GS	35.64	42.08	41.92
11	HX39600-11G/GS	39.60	46.04	45.88
12	Hx39600-12G/GS	43.56	50.0	49.84
13	HX39600-13G/GS	47.52	53.96	53.80
14	HX39600-14G/GS	51.48	57.92	57.76
15	HX39600-15G/GS	55.44	61.88	61.72

### 插座 RECEPTACLE HOUSING (VH/SMP396)

线数 Poles	型号 Type	尺寸 Dimensions (mm)		
		A	B	C
2	HX39600-2R	3.96	10.54	9.34
3	HX39600-3R	7.92	14.50	13.30
4	HX39600-4R	11.88	18.46	17.26
5	HX39600-5R	15.84	22.42	21.22
6	HX39600-6R	19.80	26.38	25.18
7	HX39600-7R	23.76	30.34	29.14
8	HX39600-8R	27.72	34.30	33.10
9	HX39600-9R	31.68	38.26	37.06
10	HX39600-10R	35.64	42.22	41.02
11	HX39600-11R	39.60	46.18	44.98
12	HX39600-12R	43.56	50.14	48.94
13	HX39600-13R	47.52	54.10	52.90
14	HX39600-14R	51.48	58.06	56.86
15	HX39600-15R	55.44	62.02	60.82

## X-ON Electronics

Largest Supplier of Electrical and Electronic Components

*Click to view similar products for [Headers & Wire Housings](#) category:*

*Click to view products by [Hongxing](#) manufacturer:*

Other Similar products are found below :

[57102-F02-18ULF](#) [58102-G61-06LF](#) [582553-1](#) [009176003701906](#) [01.001.5753.1](#) [0050291907](#) [02.125.8002.8](#) [609-3404](#) [61062-3](#)  
[CSU011177004](#) [622-0430](#) [622-3653LF](#) [63453-116](#) [636-1030](#) [636-1427](#) [636-3427](#) [636-4007](#) [641938-9](#) [644827-2](#) [65495-038](#) [65692-001LF](#)  
[65781-018](#) [65781-047](#) [65817-010LF](#) [65817-015LF](#) [66207-023LF](#) [67095-007LF](#) [67601157](#) [68631-112](#) [68645-018](#) [699319-000](#)  
[M90C108951C](#) [70.362.1628.0](#) [70-4210](#) [70-4226B](#) [70-4853B](#) [707-5028](#) [71.350.2428.0](#) [71961-016LF](#) [733-134](#) [733-162](#) [754199-000](#) [760-](#)  
[3052](#) [80.063.4001.1](#) [800-90-001-10-001000](#) [800-90-010-10-002000](#) [801-43-002-10-013000](#) [801-43-006-10-002000](#) [803-41-018-10-001000](#)  
[803-43-024-10-001000](#)