

技术参数 SPECIFICATIONS

- 线数 (Poles) : 2~12
- 适用线规 (Applicable wires) : AWG26#~18#
- 温度范围 (Temperature range) : -25℃~85℃
- 额定电压 (Voltage rating) : 250V.Ac/Dc
- 额定电流 (Current rating) : 7.5A
- 接触电阻 (Contact resistance) : $\leq 0.015\Omega$
- 绝缘电阻 (Insulation resistance) : $\geq 1000M\Omega$
- 耐压 (Withstand voltage) : 1500V.Ac/1min
- 材料 (Material) :
 - 孔座 (Housing) : 尼龙 (Nylon) UL94V-2(0)
 - 针座 (Wafer) : PA-9T UL94V-0
 - 端子 (Terminal) : 磷青铜 (Phos.bronze Tin/plated)
- 包装方式 (Package) : 贴片 (Wafer)
 - 散表 Loosen Package
 - 管装 Pipe Package
 - 磁带 Tape And Reel Package

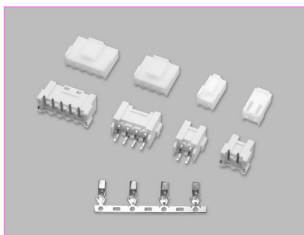

端子 TERMINAL (VH)

| 型号 Type | 适用线规 Applicable wires mm ² | AWG# | 电线外径 O.D of wire ins mm | 数量 Quantity |
|--------------|---|-------|-------------------------------|----------------|
| HX39600-01PT | 0.13~0.33 | 26~22 | 1.2~1.8 | 3000PCS/盘 |
| HX39600-PT | 0.33~0.83 | 22~18 | 1.7~3.0 | 3000PCS/盘 |

HX39600-PT (VH)

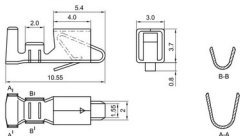

HX39600-Y (VH)

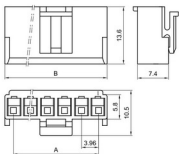

HX39601-AB (VH 立贴)

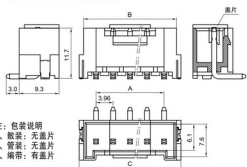

注: 包装说明
1、散表: 无盖片
2、管装: 无盖片
3、磁带: 有盖片

HX39601-AWB (VH 卧贴)

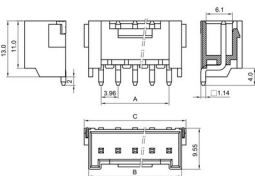

安装尺寸 MOUNTING MEASUREMENT

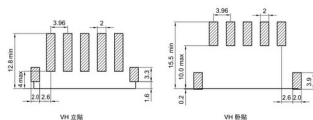

孔座 HOUSING (VH)

| 线数 Poles | 型号 Type | 尺寸 Dimensions (mm) | |
|-------------|-------------|--------------------|-------|
| | | A | B |
| 2 | HX39600-2Y | 3.96 | 8.06 |
| 3 | HX39600-3Y | 7.92 | 11.92 |
| 4 | HX39600-4Y | 11.88 | 15.88 |
| 5 | HX39600-5Y | 15.84 | 19.84 |
| 6 | HX39600-6Y | 19.80 | 23.80 |
| 7 | HX39600-7Y | 23.76 | 27.76 |
| 8 | HX39600-8Y | 27.72 | 31.72 |
| 9 | HX39600-9Y | 31.68 | 35.68 |
| 10 | HX39600-10Y | 35.64 | 39.64 |
| 11 | HX39600-11Y | 39.60 | 43.60 |
| 12 | HX39600-12Y | 43.56 | 47.56 |

针座 WAFER (VH)

| 线数 Poles | 型号 Type | | | 尺寸 Dimensions (mm) | | |
|-------------|--------------|---------------|--|--------------------|-------|-------|
| | 立贴 (180°) | 卧贴 (90°) | | A | B | C |
| 2 | HX39601-2AB | HX39601-2AWB | | 3.96 | 9.82 | 11.82 |
| 3 | HX39601-3AB | HX39601-3AWB | | 7.92 | 13.78 | 15.78 |
| 4 | HX39601-4AB | HX39601-4AWB | | 11.88 | 17.74 | 19.74 |
| 5 | HX39601-5AB | HX39601-5AWB | | 15.84 | 21.70 | 23.70 |
| 6 | HX39601-6AB | HX39601-6AWB | | 19.80 | 25.66 | 27.66 |
| 7 | HX39601-7AB | HX39601-7AWB | | 23.76 | 29.62 | 31.62 |
| 8 | HX39601-8AB | HX39601-8AWB | | 27.72 | 33.58 | 35.58 |
| 9 | HX39601-9AB | HX39601-9AWB | | 31.68 | 37.54 | 39.54 |
| 10 | HX39601-10AB | HX39601-10AWB | | 35.64 | 41.50 | 43.50 |
| 11 | HX39601-11AB | HX39601-11AWB | | 39.60 | 45.46 | 47.46 |
| 12 | HX39601-12AB | HX39601-12AWB | | 43.56 | 49.42 | 51.42 |



技术参数 SPECIFICATIONS

- 线数 (Poles) : 2~13, 15
- 适用线规 (Applicable wires) : AWG26#~18#
- 适应基板厚度 (Applicable PC board thickness) : 1.6mm
- 温度范围 (Temperature range) : -25°C~85°C
- 额定电压 (Voltage rating) : 250V.Ac/Dc
- 额定电流 (Current rating) : 7.5A
- 接触电阻 (Contact resistance) : $\leq 0.015\Omega$
- 绝缘电阻 (Insulation resistance) : $\geq 1000M\Omega$
- 耐压 (Withstand voltage) : 1500V.Ac/min
- 材料 (Material) :
 - 孔座 (Housing) : 尼龙 (PA66) UL94V-2 (0)
 - 针座 (Wafer) : 尼龙 (PA66) UL94V-2 (0)
 - 端子 (Terminal) : 磷青铜 (Phos.bronze Tin/plated)

端子 (TERMINAL)(VH) 端子与 HX3960-PT (VH) 型端子通用 (P93)

| 型号 Type | 适用线规 Applicable wires | 电线外径 O.D of wire ins | 数量 Quantity |
|-------------|--------------------------|-------------------------|----------------|
| HX3960-01PT | 0.12~0.35 AWG# 26~22 | 1.2~1.8 mm | 3000PCS/包 |
| HX3960-PT | 0.33~0.83 22~18 | 1.7~3.0 | 3000PCS/包 |

HX39600-Y (VH)



HX39601-BH (VH)



HX39601-WBH (VH)



HX39601-WAD (VH)

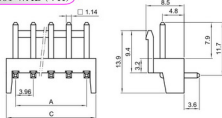

HX39601-WAH (VH)

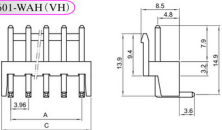

安装尺寸 MOUNTING MEASUREMENT



孔座 HOUSING(VH)

| 线数 Poles | 型号 Type | 尺寸Dimensions(mm) | |
|-------------|-------------|------------------|-------|
| | | A | B |
| 2 | HX39600-2Y | 3.96 | 8.06 |
| 3 | HX39600-3Y | 7.92 | 11.92 |
| 4 | HX39600-4Y | 11.88 | 15.88 |
| 5 | HX39600-5Y | 15.84 | 19.84 |
| 6 | HX39600-6Y | 19.80 | 23.80 |
| 7 | HX39600-7Y | 23.76 | 27.76 |
| 8 | HX39600-8Y | 27.72 | 31.72 |
| 9 | HX39600-9Y | 31.68 | 35.68 |
| 10 | HX39600-10Y | 35.64 | 39.64 |
| 11 | HX39600-11Y | 39.60 | 43.60 |
| 12 | HX39600-12Y | 43.56 | 47.56 |
| 13 | HX39600-13Y | 47.52 | 51.52 |
| 15 | HX39600-15Y | 55.44 | 59.44 |

针座 WAFER(VH)

| 线数 Poles | 型号 Type | 尺寸Dimension(mm) | | | |
|-------------|--------------|------------------|-------|-------|-------|
| | | 定位弯针 | 加高型针 | A B C | |
| 2 | HX39601-2WA | HX39601-2BH/WBH | 3.96 | 9.80 | 7.96 |
| 3 | HX39601-3WA | HX39601-3BH/WBH | 7.92 | 13.76 | 11.92 |
| 4 | HX39601-4WA | HX39601-4BH/WBH | 11.88 | 17.72 | 15.88 |
| 5 | HX39601-5WA | HX39601-5BH/WBH | 15.84 | 21.68 | 19.84 |
| 6 | HX39601-6WA | HX39601-6BH/WBH | 19.80 | 25.64 | 23.80 |
| 7 | HX39601-7WA | HX39601-7BH/WBH | 23.76 | 29.60 | 27.76 |
| 8 | HX39601-8WA | HX39601-8BH/WBH | 27.72 | 33.56 | 31.72 |
| 9 | HX39601-9WA | HX39601-9BH/WBH | 31.68 | 37.52 | 35.68 |
| 10 | HX39601-10WA | HX39601-10BH/WBH | 35.64 | 41.48 | 39.64 |
| 11 | HX39601-11WA | HX39601-11BH/WBH | 39.60 | 45.44 | 43.60 |
| 12 | HX39601-12WA | HX39601-12BH/WBH | 43.56 | 49.40 | 47.56 |
| 13 | HX39601-13WA | HX39601-13BH/WBH | 47.52 | 53.36 | 51.48 |
| 15 | HX39601-15WA | HX39601-15BH/WBH | 55.44 | 61.28 | 59.40 |

技术参数 SPECIFICATIONS

- 线数 (Poles) : 2~13, 15
- 适用线规 (Applicable wires) : AWG26#~18#
- 适应基板厚度 (Applicable PC board thickness) : 1.6mm
- 温度范围 (Temperature range) : -25°C~85°C
- 额定电压 (Voltage rating) : 250V.Ac/Dc
- 额定电流 (Current rating) : 7.5A
- 接触电阻 (Contact resistance) : $\leq 0.015\Omega$
- 绝缘电阻 (Insulation resistance) : $\geq 1000M\Omega$
- 耐压 (Withstand voltage) : 1500V.Ac/min
- 材料 (Material) :
 - 孔座 (Housing) : 尼龙 (PA66) UL94V-2 (0)
 - 针座 (Wafer) : 尼龙 (PA66) UL94V-2 (0)
 - 锁片 (Retainer) : 尼龙 (PA66) UL94V-2 (0)
 - 端子 (Terminal) : 磷青铜 (PHos.brnz) Tin/plated

端子 TERMINAL(VH)

| 型号 Type | 适用线规 Applicable wires | 电线外径 O.D of wire ins | 数量 Quantity |
|--------------|--------------------------|-------------------------|----------------|
| HX39600-01PT | 0.12~0.35 | 26~22 | 3000PCS/盘 |
| HX39600-PT | 0.33~0.83 | 22~18 | 3000PCS/盘 |

HX39600-PT (VH)

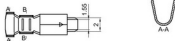
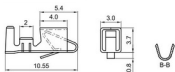

HX39600-Y (VH)

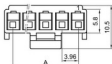

HX39600-HS (VH)

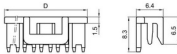

安装尺寸 MOUNTING MEASUREMENT

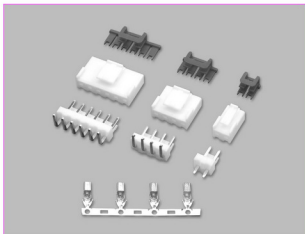

HX39601-A (VH)

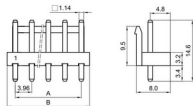

HX39601-WAP (VH)

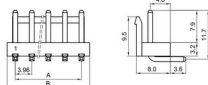

HX39601-WAG (VH)

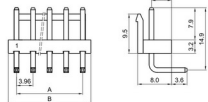

孔座 HOUSIN (VH)

| 线数 Poles | 型号 Type | 尺寸 Dimensions(mm) | | | |
|-------------|-------------|-------------------|-------|------|-------|
| | | A | B | C | D |
| 2 | HX39600-2Y | 3.96 | 8.06 | 6.85 | 7.95 |
| 3 | HX39600-3Y | 7.92 | 11.92 | 10.7 | 11.80 |
| 4 | HX39600-4Y | 11.88 | 15.88 | 10.7 | 15.76 |
| 5 | HX39600-5Y | 15.84 | 19.84 | 10.7 | 19.72 |
| 6 | HX39600-6Y | 19.80 | 23.80 | 10.7 | 23.68 |
| 7 | HX39600-7Y | 23.76 | 27.76 | 10.7 | 27.64 |
| 8 | HX39600-8Y | 27.72 | 31.72 | 10.7 | 31.60 |
| 9 | HX39600-9Y | 31.68 | 35.68 | 10.7 | 35.56 |
| 10 | HX39600-10Y | 35.64 | 39.64 | 10.7 | 39.52 |
| 11 | HX39600-11Y | 39.60 | 43.60 | 10.7 | 43.48 |
| 12 | HX39600-12Y | 43.56 | 47.56 | 10.7 | 47.44 |
| 13 | HX39600-13Y | 47.52 | 51.52 | | |
| 15 | HX39600-15Y | 55.44 | 59.44 | | |

针座 WAFER (VH)

| 线数 Poles | 型号 Type | 尺寸 Dimensions(mm) | |
|-------------|-------------|-------------------|-------|
| | | A | B |
| 2 | HX39601-2A | 3.96 | 7.92 |
| 3 | HX39601-3A | 7.92 | 11.88 |
| 4 | HX39601-4A | 11.88 | 15.84 |
| 5 | HX39601-5A | 15.84 | 19.80 |
| 6 | HX39601-6A | 19.80 | 23.76 |
| 7 | HX39601-7A | 23.76 | 27.72 |
| 8 | HX39601-8A | 27.72 | 31.68 |
| 9 | HX39601-9A | 31.68 | 35.64 |
| 10 | HX39601-10A | 35.64 | 39.60 |
| 11 | HX39601-11A | 39.60 | 43.56 |
| 12 | HX39601-12A | 43.56 | 47.52 |
| 13 | HX39601-13A | 47.52 | 51.48 |
| 15 | HX39601-15A | 55.44 | 59.40 |

X-ON Electronics

Largest Supplier of Electrical and Electronic Components

Click to view similar products for [Headers & Wire Housings](#) category:

Click to view products by [Hongxing](#) manufacturer:

Other Similar products are found below :

[57102-F02-18ULF](#) [58102-G61-06LF](#) [582553-1](#) [009176003701906](#) [01.001.5753.1](#) [0050291907](#) [02.125.8002.8](#) [609-3404](#) [61062-3](#)
[CSU011177004](#) [622-0430](#) [622-3653LF](#) [63453-116](#) [636-1030](#) [636-1427](#) [636-3427](#) [636-4007](#) [641938-9](#) [644827-2](#) [65495-038](#) [65692-001LF](#)
[65781-018](#) [65781-047](#) [65817-010LF](#) [65817-015LF](#) [66207-023LF](#) [67095-007LF](#) [67601157](#) [68631-112](#) [68645-018](#) [699319-000](#)
[M90C108951C](#) [70.362.1628.0](#) [70-4210](#) [70-4226B](#) [70-4853B](#) [707-5028](#) [71.350.2428.0](#) [71961-016LF](#) [733-134](#) [733-162](#) [754199-000](#) [760-](#)
[3052](#) [80.063.4001.1](#) [800-90-001-10-001000](#) [800-90-010-10-002000](#) [801-43-002-10-013000](#) [801-43-006-10-002000](#) [803-41-018-10-001000](#)
[803-43-024-10-001000](#)