

POLES	P/N	A	B
2	0.8T-2P-WT	0.80	3.80
3	0.8T-3P-WT	1.60	4.60
4	0.8T-4P-WT	2.40	5.40
5	0.8T-5P-WT	3.20	6.20
6	0.8T-6P-WT	4.00	7.00
7	0.8T-7P-WT	4.80	7.80
8	0.8T-8P-WT	5.60	8.60
9	0.8T-9P-WT	6.40	9.40
10	0.8T-10P-WT	7.20	10.20
11	0.8T-11P-WT	8.00	11.00
12	0.8T-12P-WT	8.80	11.80
13	0.8T-13P-WT	9.60	12.60
14	0.8T-14P-WT	10.40	13.40
15	0.8T-15P-WT	11.20	14.20
16	0.8T-16P-WT	12.00	15.00
17	0.8T-17P-WT	12.80	15.80
18	0.8T-18P-WT	13.60	16.60
19	0.8T-19P-WT	14.40	17.40
20	0.8T-20P-WT	15.20	18.20
21	0.8T-21P-WT	16.00	19.00
22	0.8T-22P-WT	16.80	19.80
23	0.8T-23P-WT	17.60	20.60
24	0.8T-24P-WT	18.40	21.40
25	0.8T-25P-WT	19.20	22.20
26	0.8T-26P-WT	20.00	23.00
27	0.8T-27P-WT	20.80	23.80
28	0.8T-28P-WT	21.60	24.60

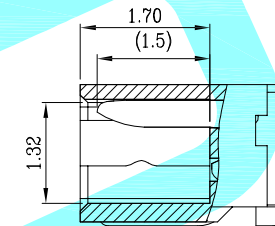

SECTION A-A

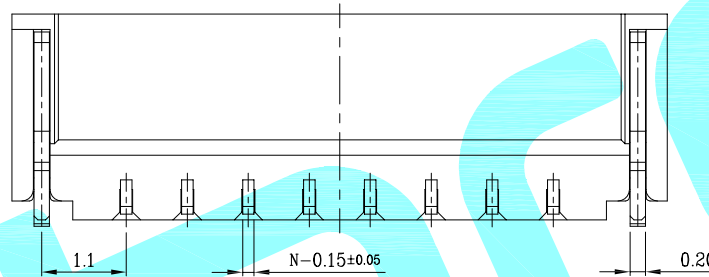
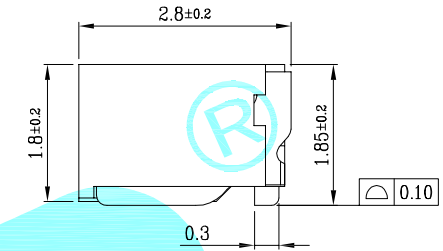
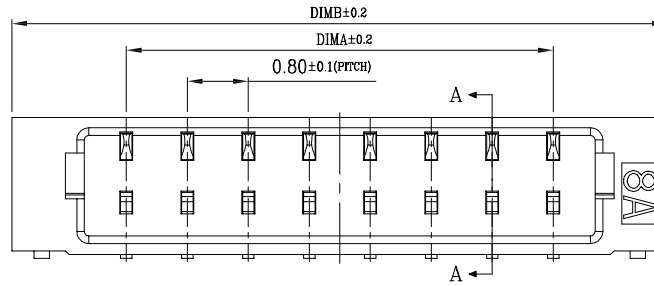
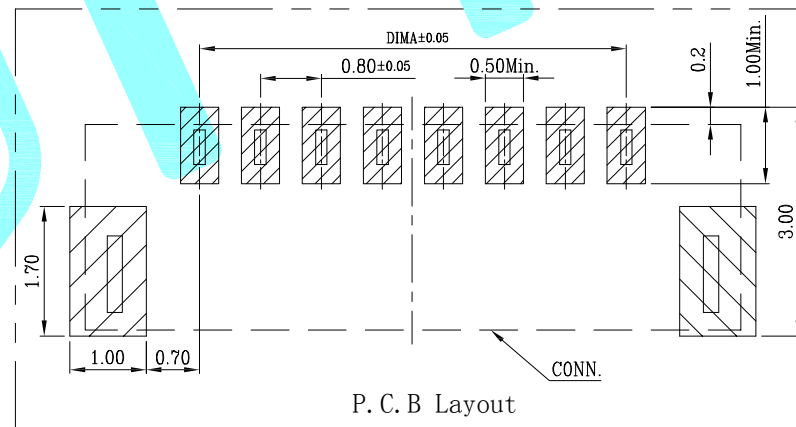

P. C. B Layout

■ 技术参数 (SPECIFICATIONS)

- ◆ 额定电压: 30V AC DC
Voltage rating: 30V AC DC
- ◆ 额定电流: 0.5A AC DC(28AWG)
Current rating: 0.5A AC DC(28AWG)
- ◆ 耐压值: 200V AC/minute
Withstand voltage: 200V AC/minute
- ◆ 绝缘电阻: 100MΩ MIN.
Insulation resistance: 100MΩ MIN.
- ◆ 接触电阻: 20mΩ MAX.(初始值)
Contact resistance: 20mΩ MAX.(Initial)
- ◆ 工作温度: -25°C~+85°C
Working Temperature: -25°C~+85°C
- ◆ 间距: 0.8 mm
Pitch: 0.8mm

■ 材料 (MATERIAL)

- ◆ 绝缘体: LCP UL94V-0
Insulator: LCP UL94V-0
- ◆ 焊片: 磷青铜镀锡
Solder tab: Phosphor bronze TIN-Plating
- ◆ 接触针: 磷青铜镀锡
Contact PIN: Phosphor bronze TIN-Plating

APPROVALS		DATE
DRAWN	LIUCAN	2023.8.11
CHECKED		
APPROVALS		



TITLE: Bar Connector Series
PART NO. 0.8T-nP-WT

TOLERANCES ARE	ANGLE
30~以上 ±0.30	±2'
10~30 ±0.20	
5~10 ±0.15	
~ 5 ±0.10	

UNIT: mm SCALE: 1:1 PROJ: DRAWING NO. SHEET 1 OF 1

ECN NO.	REV.	DATE.	DESCRIPTION.	CHANGE.	CHECK.	APPRO.
	A		NEW			

X-ON Electronics

Largest Supplier of Electrical and Electronic Components

Click to view similar products for [Headers & Wire Housings](#) category:

Click to view products by [HRO parts](#) manufacturer:

Other Similar products are found below :

[0015917161](#) [0022155065](#) [57102-F02-18ULF](#) [58102-G61-06LF](#) [582553-1](#) [01.001.5753.1](#) [0050291907](#) [02.125.8002.8](#) [609-3404](#) [61062-3](#)
[CSU011177004](#) [622-0430](#) [622-3653LF](#) [63453-116](#) [636-1030](#) [636-1427](#) [636-3427](#) [636-4007](#) [641938-9](#) [65495-038](#) [65692-001LF](#) [65781-018](#)
[65781-047](#) [65817-010LF](#) [65817-015LF](#) [67095-007LF](#) [67601157](#) [68631-112](#) [68645-018](#) [699319-000](#) [70.362.1628.0](#) [70-4210](#) [70-4226B](#) [70-](#)
[4853B](#) [71.350.2428.0](#) [733-134](#) [733-162](#) [760-3052](#) [MHR-64-VUAL](#) [80.063.4001.1](#) [800-90-001-10-001000](#) [801-43-002-10-013000](#)
[801-43-006-10-002000](#) [803-43-024-10-001000](#) [803-93-012-10-001000](#) [8-1437020-4](#) [819-22-004-30-001101](#) [820-22-006-30-001101](#)
[820-22-008-30-001101](#) [821-22-002-10-001101](#)