

POLES	P/N	A	B	C
2	1.0T-2P-WV	1.00	2.50	4.00
3	1.0T-3P-WV	2.00	3.50	5.00
4	1.0T-4P-WV	3.00	4.50	6.00
5	1.0T-5P-WV	4.00	5.50	7.00
6	1.0T-6P-WV	5.00	6.50	8.00
7	1.0T-7P-WV	6.00	7.50	9.00
8	1.0T-8P-WV	7.00	8.50	10.00
9	1.0T-9P-WV	8.00	9.50	11.00
10	1.0T-10P-WV	9.00	10.50	12.00
11	1.0T-11P-WV	10.00	11.50	13.00
12	1.0T-12P-WV	11.00	12.50	14.00
13	1.0T-13P-WV	12.00	13.50	15.00
14	1.0T-14P-WV	13.00	14.50	16.00
15	1.0T-15P-WV	14.00	15.50	17.00
16	1.0T-16P-WV	15.00	16.50	18.00
17	1.0T-17P-WV	16.00	17.50	19.00
18	1.0T-18P-WV	17.00	18.50	20.00
19	1.0T-19P-WV	18.00	19.50	21.00
20	1.0T-20P-WV	19.00	20.50	22.00
22	1.0T-22P-WV	21.00	22.50	24.00
24	1.0T-24P-WV	23.00	24.50	26.00
26	1.0T-26P-WV	25.00	26.50	28.00

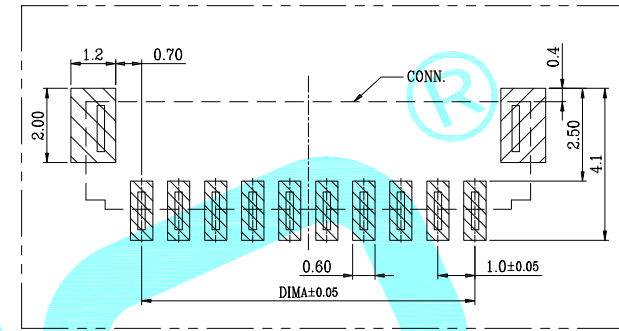

P.C.B LAYOUT

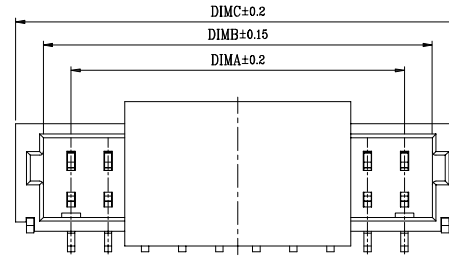
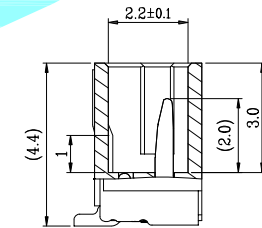
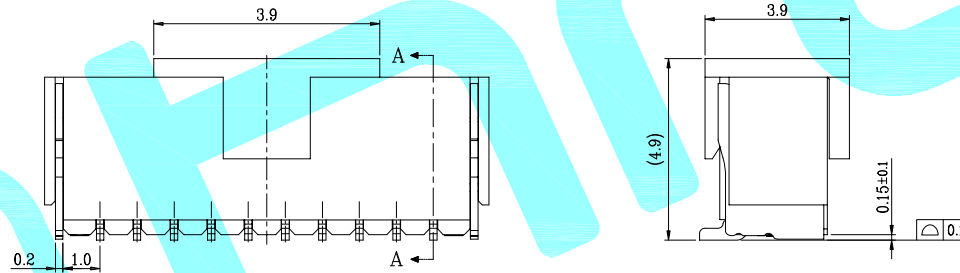

SECTION A-A

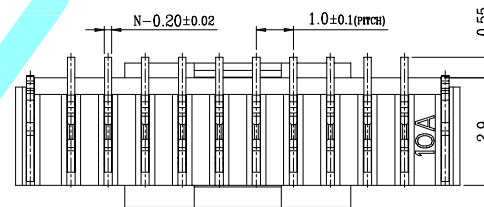

■ 技术参数 (SPECIFICATIONS)

- ◆ 额定电压: 50V AC DC
Voltage rating: 50V AC DC
- ◆ 额定电流: 1.0A AC DC(28AWG)
Current rating: 1.0A AC DC(28AWG)
- ◆ 耐压值: 500V AC/minute
Withstand voltage 500V AC/minute
- ◆ 绝缘电阻: 100MΩ MIN.
Insulation resistance: 100MΩ MIN.
- ◆ 接触电阻: 20mΩ MAX.(初始值)
Contact resistance: 20mΩ MAX.(Initial)
- ◆ 工作温度: -25°C~+85°C
Working Temperature: -25°C~+85°C
- ◆ 间距: 1.0 mm
Pitch: 1.0mm

■ 材料 (MATERIAL)

- ◆ 绝缘体: LCP UL94V-0
Insulator: LCP UL94V-0
- ◆ 焊片: 磷青铜镀锡
Solder tab: Phosphor bronze TIN-Plating
- ◆ 接触针: 磷青铜镀锡
Contact PIN: Phosphor bronze TIN-Plating

APPROVALS		DATE			
DRAWN	LIUCAN	2023.9.10			
CHECKED			PART NO.	1.0T-nP-WV	
APPROVALS			UNIT: mm	SCALE: 1:1	PROJ:
TOLERANCES ARE	30~以上	±0.30	ANGLE	DRAWING NO.	SHEET 1 OF 1
	10~30	±0.20			
	5~10	±0.15	±2'		
	~ 5	±0.10			

ECN NO.	REV.	DATE.	DESCRIPTION.	CHANGE.	CHECK.	APPRO.
	A		NEW			

X-ON Electronics

Largest Supplier of Electrical and Electronic Components

Click to view similar products for [Headers & Wire Housings](#) category:

Click to view products by [HRO parts](#) manufacturer:

Other Similar products are found below :

[0015917161](#) [0022155065](#) [57102-F02-18ULF](#) [58102-G61-06LF](#) [582553-1](#) [01.001.5753.1](#) [0050291907](#) [02.125.8002.8](#) [609-3404](#) [61062-3](#)
[CSU011177004](#) [622-0430](#) [622-3653LF](#) [63453-116](#) [636-1030](#) [636-1427](#) [636-3427](#) [636-4007](#) [641938-9](#) [65495-038](#) [65692-001LF](#) [65781-018](#)
[65781-047](#) [65817-010LF](#) [65817-015LF](#) [67095-007LF](#) [67601157](#) [68631-112](#) [68645-018](#) [699319-000](#) [70.362.1628.0](#) [70-4210](#) [70-4226B](#) [70-](#)
[4853B](#) [71.350.2428.0](#) [733-134](#) [733-162](#) [760-3052](#) [MHR-64-VUAL](#) [80.063.4001.1](#) [800-90-001-10-001000](#) [801-43-002-10-013000](#)
[801-43-006-10-002000](#) [803-43-024-10-001000](#) [803-93-012-10-001000](#) [8-1437020-4](#) [819-22-004-30-001101](#) [820-22-006-30-001101](#)
[820-22-008-30-001101](#) [821-22-002-10-001101](#)