

$B \pm 0.1 = 2.54 \times (P - 1)$

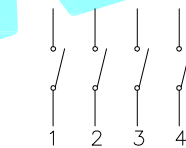
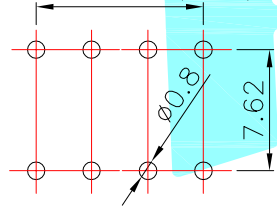

Circuit Diagram

PCB Layout(Pattern Side)

NOTES:

1.Specification:

- 1.1 Operation force: 500gf Max.
- 1.2 Operation Temperature:  $-30^{\circ}\text{C}$  to  $+85^{\circ}\text{C}$ .
- 1.3 Storage Temperature:  $-40^{\circ}\text{C}$  to  $+85^{\circ}\text{C}$ .
- 1.4 Mechanical Life: 3000 cycles operations.
- 1.5 Resistance to Soldering:  $250 \pm 5^{\circ}\text{C}$  for 3-5 Seconds.

2.ELECTRICAL:

- 2.1 Non-switch Rating: 100mA at 50V DC.
- 2.2 Switching Rating: 25mA at 24V DC.
- 2.3 Contact Resistance: Initial 50mΩ Max.  
Contact Resistance: After life 100mΩ Max.
- 2.4 Insulation Resistance: 1000MΩ Min at 500VDC.
- 2.5 Dielectric Strength: 500V AC for 60seconds.
- 2.6 Switch Capacitance: 5PF Max at 1MHZ.

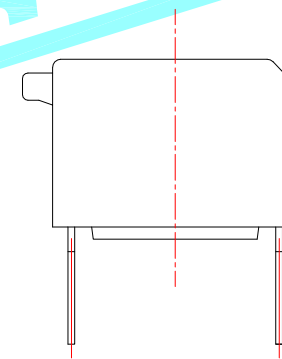

凸柄(P)

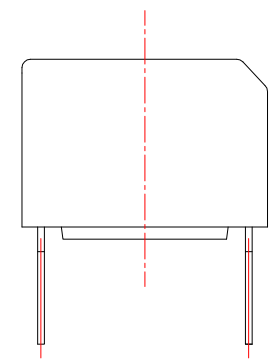

短柄(S)

Position(位数)	2P	3P	4P	5P	6P	7P	8P	10P	12P	
DIM.A(长度)	6.48	9.02	11.56	14.10	16.64	19.18	21.72	26.80	31.88	
DIM.B(长度)	2.54	5.08	7.62	10.16	12.70	15.24	17.78	22.86	27.94	
PART NO. 盖子/黑色(B)	凸柄(P)	DH-02BP	DH-03BP	DH-04BP	DH-05BP	DH-06BP	DH-07BP	DH-08BP	DH-10BP	DH-12BP
	短柄(S)	DH-02BS	DH-03BS	DH-04BS	DH-05BS	DH-06BS	DH-07BS	DH-08BS	DH-10BS	DH-12BS

⑤	Gum Water	—	—	Epikote	Black	—
④	Terminal	—	—	Phosphor bronze	Au Plating	—
③	Base	—	1	PPS	Black	—
②	Cover	—	1	PPS	Black	—
①	Keystoke	—	—	Nylon	White	—
ITEM	PART NAME	TER'NO.	QTY.	MATERIAL	FINISHING	REMARK

APPROVALS		DATE		 ELECTRONICS CO.,LTD		
DRAWN	LIUCAN	2021.9.30				
CHECKED				PART NO.	DH-□□□□	
APPROVALS				TOLERANCES ARE	ANGLE	UNIT: mm
		30~以上	±0.30	±2'	DRAWING NO.	SCALE: 1:1
		10~30	±0.20			
		5~10	±0.15			
		~ 5	±0.10			PROJ:

ECN NO.	REV.	DATE.	DESCRIPTION.	CHANGE.	CHECK.	APPRO.
	A		NEW			

## X-ON Electronics

Largest Supplier of Electrical and Electronic Components

*Click to view similar products for [DIP Switches/SIP Switches](#) category:*

*Click to view products by [HRO parts manufacturer](#):*

Other Similar products are found below :

[79B10T](#) [8136-475G4T](#) [G7G-1A2-CB-DC12](#) [DRS4016](#) [1825444-1](#) [193005MS](#) [195010MS](#) [200183](#) [206002](#) [208004](#) [208007ST](#) [208008](#)  
[25.350.0653.0](#) [SDA10H1BDA](#) [97R06ST](#) [A2C-2A5](#) [1825444-7](#) [ADE12S04](#) [206005RAS](#) [206007](#) [209005LPST](#) [2-1825058-8](#) [219002LPST](#)  
[219002MSTJRF](#) [219012MST](#) [25.352.0353.0](#) [CXDRIVEV2X](#) [LA2-002-DC24](#) [DSR02T](#) [193004MS](#) [E2FMX2D1M1TGJ03M](#) [NDI10H](#) [219-](#)  
[9MSTP](#) [219008LPSTR](#) [EPM02FV](#) [206010RAST](#) [76SB05](#) [TD06H0SK1](#) [Z7.255.9027.0](#) [1-1825058-3](#) [1825428-4](#) [219-10LPSTF](#)  
[E3ZG6111D03M](#) [G4D212PUSTV2DC5](#) [HARW0002](#) [EPG301BT06](#) [1-1825058-6](#) [E3TSL23M5J03M](#) [Y5795](#) [7R0060](#)