

- NOTE:
- 1.Rating: 24V 25mA DC
  - 2.Insulation Resistance:  $\geq 100 \text{ M}\Omega$
  - 3.Withstand voltage: AC 500V 1Minute
  - 4.Operating Force Range: 400gf Max
  - 5.Mechanical Life: 3,000 Cycles
  - 6.Operating Temperature range  $-20^{\circ}\sim +70^{\circ}\text{C}$
  - 7.Ambient Humidity used:  $\leq 85\% \text{RH}$

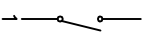

Circuit Diagram

PCB Layout(Pattern Side)

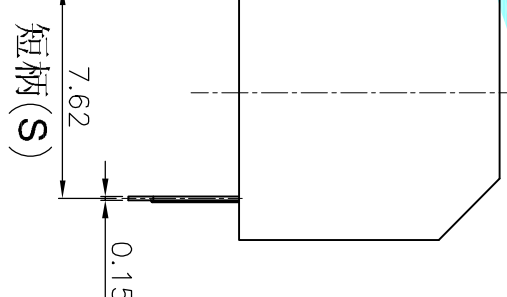
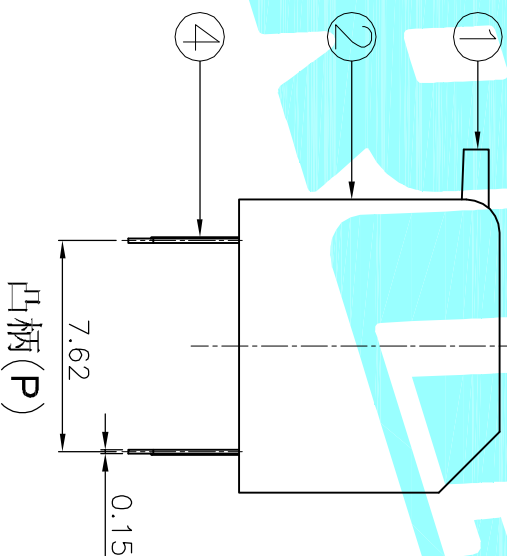
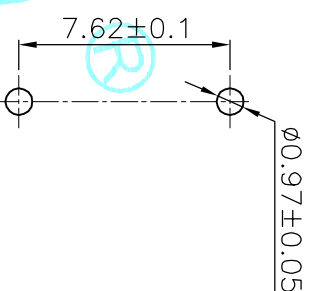

Position(位敷)		1P	
PART NO:	凸柄(P)	DP-01RP	
番子/红色(R)	短柄(S)	DP-01RS	
PART NO:	凸柄(P)	DP-01BP	
番子/蓝色(B)	短柄(S)	DP-01BS	

ITEM	PART NAME	TER'NO.	QTY.	MATERIAL	FINISHING	REMARK
⑤	Gum Water	—	—	Epicote	Black	—
④	Terminal	—	2	Phosphor bronze	Au Plating	—
③	Base	—	1	PBT	Black	—
②	Cover	—	1	PBT	Red/Blue	—
①	Keystroke	—	1	PBT	White	—

APPROVALS		DATE		TITLE	
DRAWN	J.X.Zhang	2013/11/8		MULTIFUNCTIONAL SWITCHES	
CHECKED				ELECTRONICS CO.,LTD	
APPROVALS				PART NO.	DP-01□□
TOLERANCES ARE		30 $\mu$ 以上	±0.30	ANGLE	
	10 $\sim$ 30	±0.20		UNIT: mm	SCALE: 1:1
	5 $\sim$ 10	±0.15		DRAWING NO.	PROJ:
	~5	±0.10			SHEET 1 OF 1

ECN NO.	REV.	DATE.	DESCRIPTION.
	A		NEW

CHANGE.	CHECK.	APPRO.



ELECTRONICS CO.,LTD

## X-ON Electronics

Largest Supplier of Electrical and Electronic Components

*Click to view similar products for [DIP Switches/SIP Switches](#) category:*

*Click to view products by [HRO parts](#) manufacturer:*

Other Similar products are found below :

[78M03S](#) [79B10T](#) [8136-475G4T](#) [G7G-1A2-CB-DC12](#) [A7SS-M](#) [DBP 2110](#) [DBP 2112](#) [DBS1008](#) [DHN02FTVTR](#) [DHN10T](#) [DHS108](#)  
[DPL08TN](#) [DRD16CSE04](#) [DRR4010](#) [DRR60016](#) [DRS4016](#) [BD06E](#) [1825008-1](#) [1825444-1](#) [25.350.0653.0](#) [LA2-DC12](#) [SBS 5004 TG](#)  
[SDA10H1BDA](#) [97R06ST](#) [A2C-2A5](#) [1825444-7](#) [ADE08SA04](#) [ADE12S04](#) [2161391-1](#) [2-1825058-8](#) [CCVA 2.5/ 4-G-5.08](#) [P26THRR32](#)  
[25.330.0653.1](#) [25.352.0353.0](#) [MDG305ST](#) [IKN0600000](#) [IKN0800000](#) [LA2-002-DC24](#) [DBP2008](#) [DBS1003](#) [DBS2008](#) [438872000](#)  
[DRD10CRAE04](#) [DRS1604](#) [DSR02T](#) [DSS 208 N](#) [5-1825033-1](#) [106-SDN06-EV](#) [1-1437507-6](#) [E2FMX2D1M1TGJ03M](#)  
[E3ZMCT81M1TJ03M](#)