

INGRESS PROTECTION:IP67

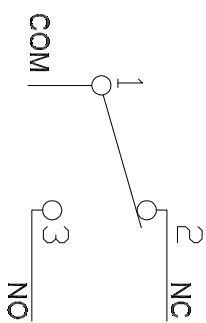

Circuit Diagram

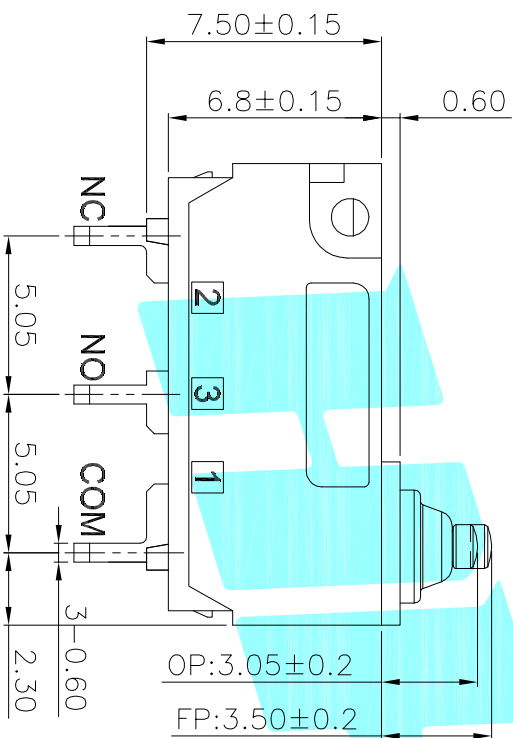
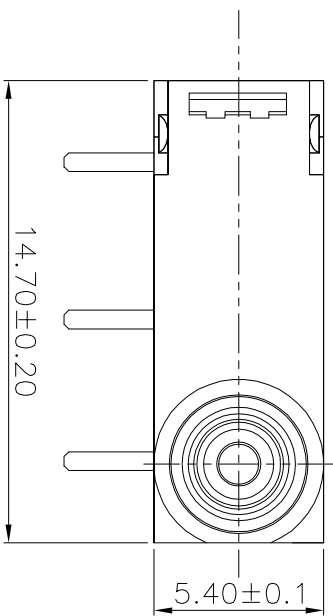
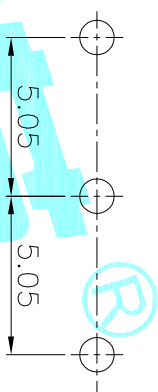
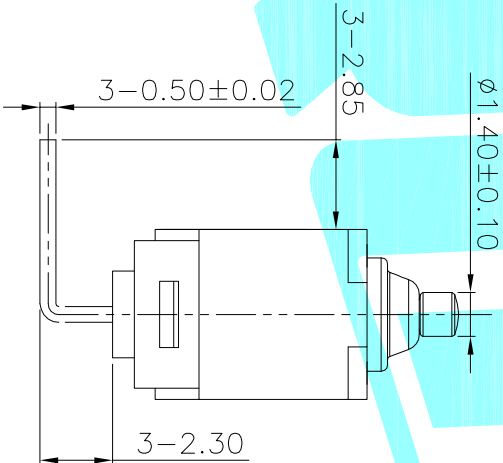

P.C.B layout

- NOTE:
1. Rating:DC12V 3A
 2. Rating:48V DC/125V AC/250V AC 0.1A
 3. Operating force:130gf MAX
 4. Electric Life:10,000
 5. Mechanical Life:1,000,000

⑦	Shrapnel	1	Brass	Plating silver	
⑥	Contact	1	Ag		
⑤	Sealed Circle	1	Silicone Rubber		
④	Terminal	3	Brass(0.50t)	Plating silver	
③	Plunger	1	POM	Black	
②	Cose	1	PA	Black	
①	Cover	1	PA	Black	

APPROVALS	DATE	MATERIAL	FINISHING	REMARK
DRAWN J.X.Zhang	2018/8/1			
CHECKED		TITLE: MICRO SWITCHS		
APPROVALS		PART NO. K9-1801G		
TOLERANCES ARE		SCALE: 1:1		
30~R/L	±0.30	ANGLE	UNIT: mm	PROD.
10~S0	±0.20			
5~T0	±0.15	±2'	DRAWING NO.	SHEET 1 OF 1
~ 5	±0.10			



ELECTRONICS CO.,LTD

MICRO SWITCHS

K9-1801G

SCALE: 1:1

UNIT: mm

ANGLE ±2'

±0.30 ±0.20 ±0.15 ±0.10

APPROVALS

DATE

MATERIAL

FINISHING

REMARK

DRAWN J.X.Zhang

2018/8/1

CHECKED

TITLE: MICRO SWITCHS

APPROVALS

PART NO. K9-1801G

TOLERANCES ARE

SCALE: 1:1

UNIT: mm

ANGLE ±2'

±0.30 ±0.20 ±0.15 ±0.10

~ 5 ±0.10

DRAWING NO.

SHEET 1 OF 1

DESCRIPTION. NEW

CHANGE.

CHECK.

APPRO.

ECN NO.

REV. A

DATE.

X-ON Electronics

Largest Supplier of Electrical and Electronic Components

Click to view similar products for [Basic / Snap Action Switches](#) category:

Click to view products by [HRO parts manufacturer](#):

Other Similar products are found below :

[5SM901-S12](#) [5SM9-S12N195](#) [602EN532](#) [602EN535-RB](#) [602HE5-RB1](#) [604HE223-6B](#) [624HE17-RB](#) [6HM82](#) [6SE1](#) [6SX1-H58](#) [71051](#) [714-0293](#) [MBH2731](#) [79211923](#) [79218589](#) [MIL30126AB6BBMD4A12XAU](#) [ML-1155](#) [ML-1376](#) [831010C3.0](#) [831090C2.EL](#) [83131904](#) [84212012](#) [8AS239](#) [8HM73-3](#) [8SX26-H33](#) [914CE1-6G](#) [11SM1077-H4](#) [11SM1077-H58](#) [11SM1-TN107](#) [11SM405](#) [11SM703-T](#) [11SM8423-H2](#) [11SX37-T](#) [11SX48-H58](#) [11SM2442-T](#) [11SM76-T](#) [11SM77-H58](#) [11SM77-T](#) [11SM863-T](#) [11SM866](#) [121EN188-R](#) [1245.0120](#) [125EN56-RB](#) [D433V3RD](#) [1267.0101](#) [1267.7101](#) [D4BFC1](#) [12SM4-T2](#) [12SX2-T2](#) [1298.0101](#)