

ROHS

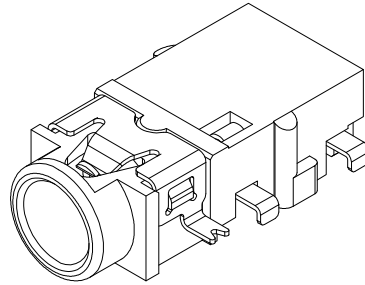

3D VIEW

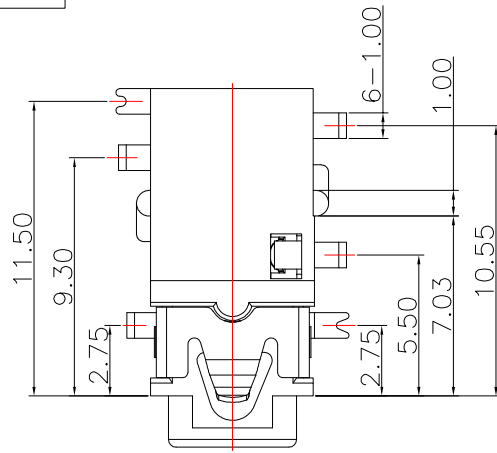
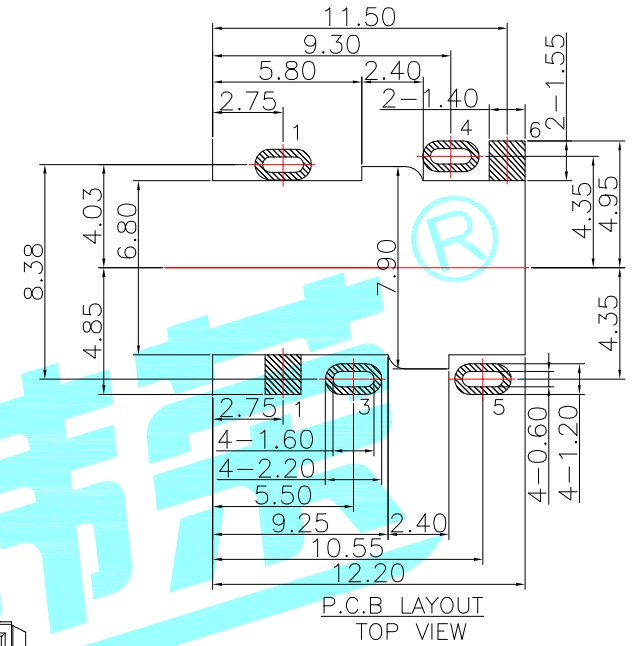

P.C.B. LAYOUT
TOP VIEW

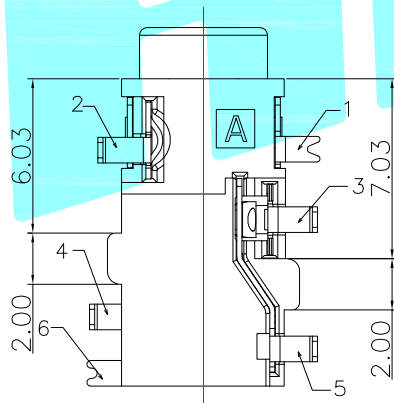
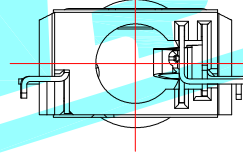
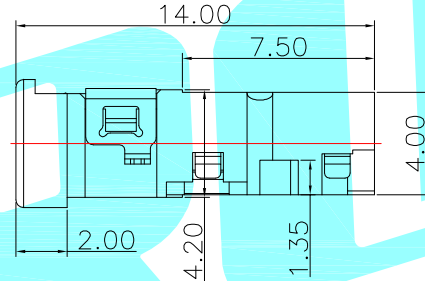
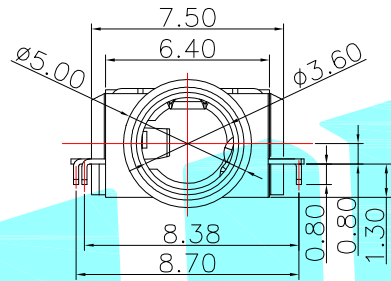

NOTES:

1. REQUEST OF THE SPECIFICATION:
 - 1.1 CONTACT CURRENT RATING: 1A;
 - 1.2 CONTACT RESISTANCE: 100 mΩ MAX.;
 - 1.3 INSULATION RESISTANCE: 100MΩ MIN.;
 - 1.4 DIELECTRIC WITHSTANDING: 500V AC MIN.;
 - 1.5 DURABILITY: 5,000 CYCLES MIN.;
 - 1.6 CONNECTOR MATING FORCES: 30N MAX.;
 - 1.7 CONNECTOR UNMATING FORCES: 3N MIN.;

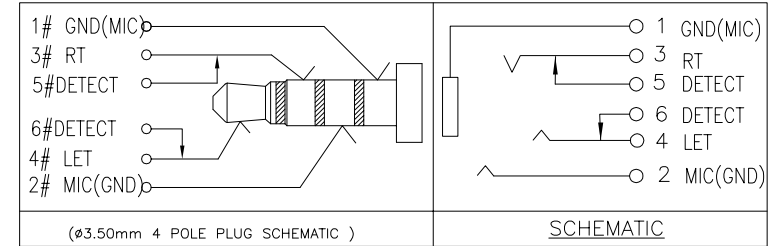

(φ3.50mm 4 POLE PLUG SCHEMATIC)

SCHEMATIC

③	Other Terminal	_____	4	SUS	Au Plating	_____
②	Terminal 2#4#	_____	2	Copper Alloy	Au Plating	_____
①	Housing	_____	1	LCP	Black	_____
ITEM	PART NAME	Serial number	QTY.	MATERIAL	FINISHING	REMARK

APPROVALS		DATE		 ELECTRONICS CO.,LTD				
DRAWN	LIUCAN	2023.2.28					TITLE:	PHONE JACKES
APPROVALS							PART NO.	PJ-399Q
TOLERANCES ARE		30~以上	±0.30	ANGLE	UNIT: mm	SCALE: 1:1		
		10~30	±0.20					
		5~10	±0.15	±2'	DRAWING NO.	SHEET 1 OF 1		
		~ 5	±0.10					

_____	A	_____	NEW	_____	_____	_____
ECN NO.	REV.	DATE.	DESCRIPTION.	CHANGE.	CHECK.	APPRO.

X-ON Electronics

Largest Supplier of Electrical and Electronic Components

Click to view similar products for [HDMI, Displayport & DVI Connectors](#) category:

Click to view products by [HRO parts manufacturer](#):

Other Similar products are found below :

[30-528](#) [30-504](#) [33DVIR-24S1B](#) [47648-2000](#) [TC142X](#) [1932649-1](#) [HAGBH](#) [AABII](#) [ABIBG](#) [AAIBH](#) [52355](#) [XHLJQ-00026](#) [HDMI-019R](#)
[G46M2013201AWEU](#) [ST-0277D00-052-142](#) [HC-PJ-320A-3P-D](#) [HC-PJ-3133-5P-D](#) [PJ-342](#) [141](#) [PJ-320A-4P DIP](#) [HC-PJ-325C-5P](#) [HC-PJ-](#)
[320D-4P-S](#) [HC-PJ-3133-6P-S](#) [D-SUB-DR-9PCM-CB](#) [ST-0275S00-082-182](#) [HC-PJ-320A-4P-D](#) [HC-PJ-325A-5P](#) [HC-PJ-3134-6P-D](#) [HDR-](#)
[HX-102DIP](#) [HDMI-GD-121PWB](#) [C2939191](#) [C2939584](#) [PJ-208](#) [PJ-2040](#) [PJ-3580A-6A](#) [PJ-399M](#) [PJ-3200A-3A](#) [PJ-328B-4B](#) [PJ-3930-7A](#)
[PJ-615-5A](#) [PJ-332-6A](#) [KH-HDMI-0001](#) [KH-PJ-209-SMT](#) [KH-HDMI-0035-XK](#) [KH-PJ-328A-5P](#) [KH-PJ-322](#) [KH-PJ-327E-SMT](#) [KH-PJ-](#)
[320A-5.6](#) [KH-HDR15P-F3.08](#) [KH-HDMI-0005A-SMT](#) [KH-HDMI-0021-JBS](#)