

# CRYSTAL UNIT

## JU2060

### Applications Features

- SmartWearable
- IOT Communication.
- Dimensions: 2.00 x 6.00 x H mm .
- Standard Frequency: 32.768 KHz
- High precision and high frequency stability.
- Extremely good for reducing EMI effect .



### 规格 Specifications

频率范围 Standard Frequency	32.768 KHz
振动模式 Vibration Mode	AT Fundamental
负载电容 Load Capacitance	6pF, 9 pF, 12.5pF, 15pF
频率差值 Frequency Tolerance (at 25℃ )	± 10ppm ~ ±30ppm
温度频差 Frequency Stability	±20ppm ~ ±30ppm
工作温度 Operating Temperature	-40~+85℃, -40~+125℃
储存温度 Storage Temperature	-55~+125℃
静态电容 Shunt Capacitance	0.85 pF Typ.
激励电平 Level of Drive	1.0μWMax.
温度系数 Temperature coefficient	-0.04 × 10 <sup>-6</sup> / C <sup>2</sup> Max.
串联电阻 Equivalent Series Resistance	60K Ω Max.
串联电容 Equivalent Series Capacitance	2.0 fF Typ.
年老化率 Aging (at 25℃ )	±3ppm/year Max.

### 外形尺寸 Dimensions and Patterns [unit: mm]

Package Size – Dimensions (Unit: mm)

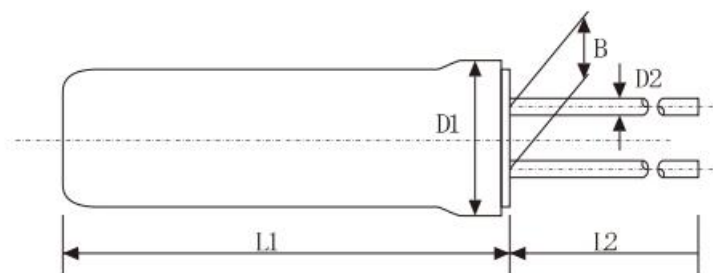

型号	L1	L2	D1	D2	B
JU206	6.0 ± 0.2	10.0 ± 0.5	φ 2.1 ± 0.08	φ 0.2 ± 0.05	0.7 ± 0.2

该产品在过回流焊时最高温度 < 245℃，并且过回流焊次数 < 2次。

## X-ON Electronics

Largest Supplier of Electrical and Electronic Components

*Click to view similar products for [Crystals](#) category:*

*Click to view products by [huaxindianzi](#) manufacturer:*

Other Similar products are found below :

[CX3225GB25000M0PPSZ1](#) [718-13.2-1](#) [7A-40.000MAAE-T](#) [FL2000085](#) [99-BU](#) [9B-15.360MBBK-B](#) [9C-7.680MBBK-T](#) [H10S-12.000-18-EXT-TR](#) [ABC2-6.000MHZ-D4Z-T](#) [ABLS-20.000MHZ-D2-T](#) [ABS071-32.768KHZ-6-T](#) [R38-32.768-12.5-5PPM-NPB](#) [BTD1062E05A-513](#) [21U15A-21.4MHZ](#) [RTX-781DF1-S-20.950](#) [LFXTAL066198Cutt](#) [9C-14.31818MBBK-T](#) [A-11.000MHZ-27](#) [ABL-27.000MHZ-B4Y-T](#) [ABM11-132-24.000MHZ-T3](#) [ABM3B1-25.000MHZ-D2Y-T](#) [SPT2A-.032768B](#) [SPT2A.032768G](#) [LFXTAL065253Cutt](#) [LFXTAL066431Cutt](#) [XT9S20ANA14M7456](#) [XT9SNLANA16M](#) [7A-24.576MBBK-T](#) [7B-30.000MBBK-T](#) [CX2520DB16000H0HPQCC](#) [MMCC2R32.7680KHZ](#) [6504-202-1501](#) [6526-202-1501](#) [ABLS-12.000MHZ-B2Y-T](#) [7A-10.000MBBK-T](#) [SG636PCE-20.000MC](#) [3404](#) [CM315D32768EZFT](#) [C1E-24.000-7-2020-R](#) [C1E-19.200-12-1530-X-R](#) [C1E-16.000-12-1530-X-R](#) [ABM11-16.000MHZ-9-B1U-T](#) [FL5000014](#) [EUCA18-3.1872M](#) [FX0800015](#) [425F35E027M0000](#) [FP0800018](#) [MS3V-T1R-32.768kHz-7pF-20PPM-TA-QC-Au](#) [VXM7-1C1-16M000](#) [MS3V-T1R-32.768kHz-9pF-20PPM-TA-QC-Au](#)