

**NONMETALLIC SHEATHED CABLE CONNECTORS
SNAP-IN TYPE**



Application

- For use in dry locations for connecting Nonmetallic Sheathed Cable (NMSC) to a box or an enclosure

Product Features

- One-piece nonmetallic construction -resists corrosion and offers insulation protection
- Snap-in design for 1/2" K.O.'s – locks into the knockout securely. No need to waste time with installing locknuts
- Captive locking wedge – no need to worry about missing components
- Easier to install than a standard die cast NMSC connector. No need to remove and retighten locknuts and cable clip screws. Just snap our connector into a box, insert the cable and compress the locking wedge
- Multipurpose design - offers installation flexibility. These connectors can accommodate a single run of 14-2 to 10-3 cable, a double run of 14-2 to 12-2 cable, and one or more .300 inch or one .600 inch diameter cord
- Innovative packaging configurations - Bulk packaging option saves volume users time and money. Smaller size carton quantities offer purchasing flexibility
- UPC bar coded fittings are individually polybagged with a preprinted UPC-A bar code and packaged in pre-scored tear top cartons for an attractive presentation

Compliances

-  – Standard 514B
-  – For single cable and cord only

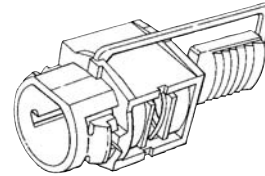

**SNAP-IN TYPE
NONMETALLIC**

ORDERING INFORMATION - DIMENSIONS

SNAP-IN TYPE - NONMETALLIC					
CATALOG NUMBER	TRADE SIZE	NONMETALLIC CABLE SIZE	UNIT CTN. QTY.	SHIP CTN. QTY.	UPC BAR CODE
4712	1/2"	Single 14-2 min to 10-3 max, Double 14-2 min to 12-2 max. Flexible Cord Single .300 to .600 dia. Two cords @ .300 dia.	500	500	—
4713	1/2"	Single 14-2 min to 10-3 max, Double 14-2 min to 12-2 max. Flexible Cord Single .300 to .600 dia. Two cords @ .300 dia.	50	200	—
4712-8	1/2"	Single 14-2 min to 10-3 max, Double 14-2 min to 12-2 max. Flexible Cord Single .300 to .600 dia. Two cords @ .300 dia.	10 pcs per bag	10 bags per ctn	

DIMENSIONS			
CATALOG NUMBER	A	B	C
4712	1-11/32"	1/2"	1-3/32"
4712-8	1-11/32"	1/2"	1-3/32"
4713	1-11/32"	1/2"	1-3/32"

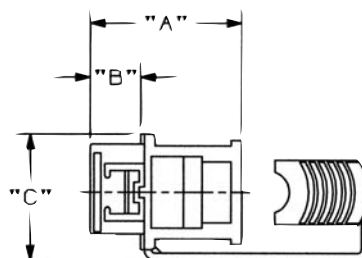

A = Overall length
B = Length snap-in hub
C = Maximum body width

RACO COMMERCIAL FITTINGS

X-ON Electronics

Largest Supplier of Electrical and Electronic Components

Click to view similar products for [hubbell](#) manufacturer:

Other Similar products are found below :

[CFB7TALU](#) [03301045](#) [02216024](#) [03301047](#) [5369VY](#) [5461](#) [WSS1P](#) [00322005LPK50](#) [01304055](#) [M001SG000](#) [M001SG00P](#) [M11MSP](#)
[01301013](#) [02201005](#) [02203007](#) [02203064](#) [02206012](#) [02211019](#) [02402005](#) [02406006](#) [02407008](#) [CS1223GY](#) [CS6360C](#) [CS6370](#)
[M5200CS1R](#) [7310](#) [MCMA14110](#) [7485VBLK](#) [7585](#) [7716](#) [7967](#) [FF3I](#) [PF2004PA005](#) [PFOLT312](#) [PH2003PA010](#) [PH2304PB050](#) [PH6598W](#)
[9308](#) [GFP2305](#) [GFR5352IA](#) [GFR5362WTR](#) [GFR8300SNAPBKNA](#) [PM3004PA015](#) [PS05GYKIT](#) [PT2X2BRS3](#) [AA2030PS](#) [HBL13R12D](#)
[HBL16LEDR](#) [HBL18201WCN](#) [HBL20GBA612IV](#)