

## Wall Plates

# Weatherproof Plates for Receptacles and Inlets

For FS/FD Box Mounting



**IP44**  
SUITABILITY

### For Receptacles with Face Diameters of 2.28" - 2.44" (57.9-62.0)

Description	Catalog Numbers
Thermoplastic, 2-gang, WET LOCATIONS with cover "closed," gray.	<b>HBL7777A▲</b>
Thermoplastic, 2-gang, WET LOCATIONS with cover "closed," yellow.	<b>HBL77CM77A▲</b>
Thermoplastic, 2-gang, WET LOCATIONS with cover "closed," gray.	<b>HBL7777▽</b>



HBL7777A

### For Receptacles with Face Diameters of 2.09" - 2.13" (53.1-54.1)

Description	Catalog Numbers
Cast aluminum, WET LOCATIONS with cover "closed."	<b>HBL9420</b>
Cast aluminum, no lift cover, NOT weatherproof.	<b>HBL9419</b>



HBL7774WO

### For 50A Twist-Lock® Single Receptacles

Description	Catalog Numbers
Thermoplastic, WET LOCATIONS with cover "open," gray.	<b>HBL7774WO*</b>
Thermoplastic, WET LOCATIONS with cover "open," yellow.	<b>HBL77CM74WO*</b>
Cast aluminum, WET LOCATIONS with cover "closed."	<b>HBL7770</b>
Galvanized Steel, fits 4" square, 4 11/16" or 2 gang box.	<b>HBL50SC</b>



HBL20405

### For 30A, 4 Wire Hubbellock® Receptacles

Description	Catalog Numbers
Cast aluminum, WET LOCATIONS with cover "closed."	<b>HBL20405</b>
Cast aluminum, WET LOCATIONS with cover "closed," red	<b>HBL20446</b>
Cast aluminum, no lift cover, NOT weatherproof.	<b>HBL20406</b>

▲ Will fit FS/FD boxes having plate mounting holes on 3.25" x 3.75" (82.6 x 95.3) centers.

▽ Will only fit old style porcelain face devices.

\*Note: The "CS" versions of 50A Twist-Lock® will only fit these plates.

### Weatherproof Covers For Single Receptacles

#### For Use On FS/FD Boxes

Note: All weatherproof plates are UL Listed for WET LOCATIONS WITH COVER CLOSED, for intermittent use in wet locations or use in damp locations. Those with suffix WO are listed for WET LOCATIONS with cover open in continuous use. All plates are gasketed and self-closing.



HBL20405

### Accessories

Description	Catalog Numbers
Sub-plate for mounting and weatherproofing flanged inlets such as HBL5278, HBL7556, HBL4716, etc. when used with a HBL7420 or HBL7425WOA type weatherproof plate.	<b>7452</b>
Adapter plate for mounting HBL7423WO, HBL7424WO, HBL7425WOA or HBL7420 plates to standard boxes.	<b>HBL7349</b>

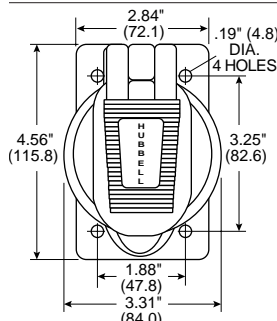

HBL7349

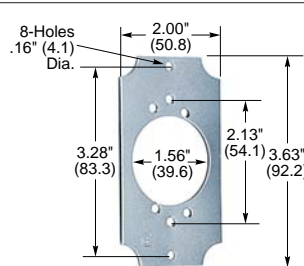

7452



HBL7770

### Typical Plate, Single Gang

Dimensions in Inches (mm)



## X-ON Electronics

Largest Supplier of Electrical and Electronic Components

*Click to view similar products for [hubbell](#) manufacturer:*

Other Similar products are found below :

[CFB7TALU](#) [03301045](#) [02216024](#) [03301047](#) [5369VY](#) [5461](#) [WSS1P](#) [00322005LPK50](#) [01304055](#) [M001SG000](#) [M001SG00P](#) [M11MSP](#)  
[01301013](#) [02201005](#) [02202008](#) [02203007](#) [02203064](#) [02206012](#) [02211003](#) [02211019](#) [02402005](#) [02406006](#) [02407008](#) [CS1223GY](#) [CS6360C](#)  
[CS6370](#) [7310](#) [MCMA14110](#) [7485VBLK](#) [7585](#) [7716](#) [7967](#) [FF3I](#) [PF2004PA005](#) [PFOLT312](#) [PH2003PA010](#) [PH2304PB050](#) [PH6598W](#) [9308](#)  
[GFP2305](#) [GFR5352IA](#) [GFR5362WTR](#) [GFR8300SNAPBKNA](#) [PM3004PA015](#) [HBL13R12D](#) [HBL16LEDR](#) [HBL18201WCN](#)  
[HBL20GBA612IV](#) [HBL20IG606GY](#) [HBL23007](#)