

Between Series Adaptor 33_716-N-50-51/-33_N

Description

Adaptor plug/jack
7/16-precision plug (male) / N-precision jack (female)

For Test & Measurement applications
Precision adaptor

Interface standards
Series 7/16-precision - SUHNER-716
Series N-precision - IEC 60169-16_MIL-STD-348A/402_CECC 22210

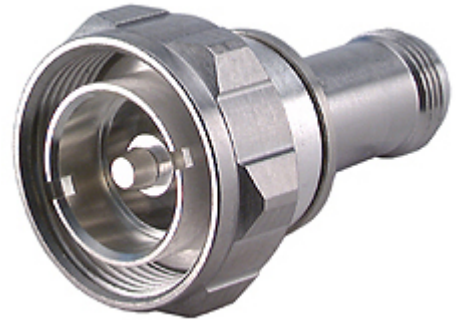

Technical Data

Electrical Data

Impedance	50 Ω
Interface frequency max.	7.5 GHz
VSWR	DC - 7.5 GHz ≤ 1.03 + 0.004 f (GHz)

Mechanical Data

Number of matings	500
Weight	0.1141 kg

Environmental Data

Operating temperature	-65 °C to 165 °C
2011/65/EU (RoHS - including 2015/863 and 2017/2102)	compliant

Material Data

Interface - 7/16-precision plug (male)

Piece Parts	Material	Surface Plating
Centre contact	Brass	Silver Plating
Outer contact	Brass	SUCOPLATE (R) Plating
Body	Brass	SUCOPLATE (R) Plating
Insulator	PFA / PTFE	
Coupling nut	Brass	SUCOPLATE (R) Plating

Interface - N-precision jack (female)

Piece Parts	Material	Surface Plating
Centre contact	Copper Beryllium Alloy	SUCOPRO Plating
Outer contact	Brass	SUCOPLATE (R) Plating
Body	Brass	SUCOPLATE (R) Plating
Insulator	PFA / PTFE	

Related Documents

Catalogue drawing	DCA-00014419
-------------------	--------------

Ordering Information

Single package	33_716-N-50-51/-33_NE
----------------	-----------------------

X-ON Electronics

Largest Supplier of Electrical and Electronic Components

Click to view similar products for [RF Adapters - Between Series category:](#)

Click to view products by [Huber & Suhner manufacturer:](#)

Other Similar products are found below :

[5945-9503-000](#) [MCX/F-SMA/M](#) [R192417010](#) [ADBJ20-E1-BJ379](#) [ADM2](#) [ADPL75-A1-PL75](#) [242191](#) [9317505](#) [29-3835P](#) [AD130](#) [ADBJ20-E1-PL74](#) [ADBJ20-E2-BJ79](#) [ADBJ77-A1-PL375](#) [ADBJ77-E1-UPL20](#) [ADRMF370](#) [242215](#) [242228](#) [R125680000W](#) [R192430000](#) [UAD95](#) [1057367-1](#) [8311505](#) [R114704000](#) [R451034500](#) [R451030500](#) [R451543000](#) [HDVDPN](#) [ADBJ20-K1-PL20](#) [R451570000](#) [R451034000](#) [J9](#) [J3WE-5](#) [R451032500](#) [242201RP](#) [17K132-K00S5](#) [AD-RSMAF-RTNC](#) [53K156-K00N5](#) [02K119-K00E3](#) [29S132-K01N5](#) [53S156-K00N5](#) [02S119-S00E3](#) [28K132-K00N5](#) [02S109-K00S3](#) [27-8200TP](#) [242235](#) [ADBJ20-E1-BJ89](#) [000-2900](#) [321-102-003 \(SMA-50/2-H155/W1.03 AU\)](#) [1057377-1](#) [321-350-001 \(SMA-50-R/2-RG316/N2.01\)](#)