

## Ex CABLE GLANDS



HUMMEL offers a wide range of cable glands for explosion protection areas. This includes cable glands for ignition protection types Ex d and Ex e. For areas where "Increased Safety" (Ex e) is prescribed, HUMMEL offers plastic and metal cable glands, also with multi or flat cable inserts. Cable glands for ignition type Ex d meet the requirements for "Pressure-tight Encapsulation". This prevents transfer of an explosion in the housing interior to the exterior.

*In this chapter, you will find:*

- // HSK-K-Ex-Active, the plastic cable gland for ex-areas
- // Ex e metal cable glands with various inserts
- // Ex d metal cable glands for pressure-tight encapsulation

HUMMEL has many years of experience in handling components for explosion-protection areas. This is why we have a sophisticated range of explosion area products in a range of materials and designs.



# Ex e PLASTIC CABLE GLANDS

HSK-K-Ex-Active

Metr.



|                       |  |
|-----------------------|--|
| Material              | Polyamide, fiber reinforced                        |
| Seal                  | Buna-N   |
| O-Ring                | Buna-N   |
| Protection            | IP 68 – 10 bar within the specified clamping range |
| Operating Temperature | -20 °C – 85 °C (-4 °F – 185 °F)                    |
| Colors                | black (RAL 9005) / blue-black (RAL 5012)           |

- // FKM and VMQ O-Ring upon request
- // With pre-assembled dust disc upon request



II 2G Ex eb IIC Gb  
II 1D Ex ta IIIC Da

Class I Div 2 Groups A, B, C, D  
Class II Div 1 Groups E, F, G

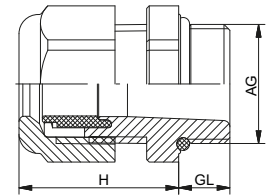

| AG         | ∅ <sub>k</sub><br>mm | H<br>mm | <br>mm | GL<br>mm | Number<br>black | Number<br>blue-black | GL<br>mm | Number<br>black<br>elongated | Number<br>blue-black<br>elongated |
|------------|----------------------|---------|--------|----------|-----------------|----------------------|----------|------------------------------|-----------------------------------|
| M 12 x 1,5 | 3–6,5                | 21      | 15     | 8        | 1.292.1201.50   | 1.292.1202.50        | 15       | 1.292.1201.30                | 1.292.1202.30                     |
| M 12 x 1,5 | 2–5                  | 21      | 15     | 8        | 1.292.1201.51   | 1.292.1202.51        | 15       | 1.292.1201.31                | 1.292.1202.31                     |
| M 16 x 1,5 | 4–8                  | 22      | 19     | 8        | 1.292.1601.50   | 1.292.1602.50        | 15       | 1.292.1601.30                | 1.292.1602.30                     |
| M 16 x 1,5 | 3–6                  | 22      | 19     | 8        | 1.292.1601.51   | 1.292.1602.51        | 15       | 1.292.1601.31                | 1.292.1602.31                     |
| M 16 x 1,5 | 5–10                 | 25      | 22     | 8        | 1.292.1611.50   | 1.292.1612.50        | 15       | 1.292.1611.30                | 1.292.1612.30                     |
| M 16 x 1,5 | 3–7                  | 25      | 22     | 8        | 1.292.1611.51   | 1.292.1612.51        | 15       | 1.292.1611.31                | 1.292.1612.31                     |
| M 20 x 1,5 | 6–12                 | 27      | 24     | 9        | 1.292.2001.50   | 1.292.2002.50        | 15       | 1.292.2001.30                | 1.292.2002.30                     |
| M 20 x 1,5 | 5–9                  | 27      | 24     | 9        | 1.292.2001.51   | 1.292.2002.51        | 15       | 1.292.2001.31                | 1.292.2002.31                     |
| M 20 x 1,5 | 10–14                | 28      | 27     | 9        | 1.292.2016.50   | 1.292.2017.50        | 15       | 1.292.2016.30                | 1.292.2017.30                     |
| M 20 x 1,5 | 7–12                 | 28      | 27     | 9        | 1.292.2016.51   | 1.292.2017.51        | 15       | 1.292.2016.31                | 1.292.2017.31                     |
| M 25 x 1,5 | 13–18                | 31      | 33     | 11       | 1.292.2501.50   | 1.292.2502.50        | 15       | 1.292.2501.30                | 1.292.2502.30                     |
| M 25 x 1,5 | 9–16                 | 31      | 33     | 11       | 1.292.2501.51   | 1.292.2502.51        | 15       | 1.292.2501.31                | 1.292.2502.31                     |
| M 32 x 1,5 | 18–25                | 39      | 42     | 11       | 1.292.3201.50   | 1.292.3202.50        | 15       | 1.292.3201.30                | 1.292.3202.30                     |
| M 32 x 1,5 | 13–20                | 39      | 42     | 11       | 1.292.3201.51   | 1.292.3202.51        | 15       | 1.292.3201.31                | 1.292.3202.31                     |
| M 40 x 1,5 | 22–32                | 48      | 53     | 13       | 1.292.4001.50   | 1.292.4002.50        | 18       | 1.292.4001.30                | 1.292.4002.30                     |
| M 40 x 1,5 | 20–26                | 48      | 53     | 13       | 1.292.4001.51   | 1.292.4002.51        | 18       | 1.292.4001.31                | 1.292.4002.31                     |
| M 50 x 1,5 | 32–38                | 49      | 60     | 13       | 1.292.5001.50   | 1.292.5002.50        | 18       | 1.292.5001.30                | 1.292.5002.30                     |
| M 50 x 1,5 | 25–31                | 49      | 60     | 13       | 1.292.5001.51   | 1.292.5002.51        | 18       | 1.292.5001.31                | 1.292.5002.31                     |
| M 63 x 1,5 | 37–44                | 49      | 65/68  | 14       | 1.292.6301.50   | 1.292.6302.50        | 18       | 1.292.6301.30                | 1.292.6302.30                     |
| M 63 x 1,5 | 29–35                | 49      | 65/68  | 14       | 1.292.6301.51   | 1.292.6302.51        | 18       | 1.292.6301.31                | 1.292.6302.31                     |

## HSK-K-Ex-Active

## NPT



|                       |  |
|-----------------------|--|
| Material              | Polyamide, fiber reinforced                        |
| Seal                  | Buna-N   |
| O-Ring                | Buna-N   |
| Protection            | IP 68 – 10 bar within the specified clamping range |
| Operating Temperature | -20 °C – 85 °C (-4 °F – 185 °F)                    |
| Colors                | black (RAL 9005) / blue-black (RAL 5012)           |

- // FKM and VMQ O-Ring upon request
- // With pre-assembled dust disc upon request



II 2G Ex eb IIC Gb  
II 1D Ex ta IIIC Da

Class I Div 2 Groups A, B, C, D  
Class II Div 1 Groups E, F, G

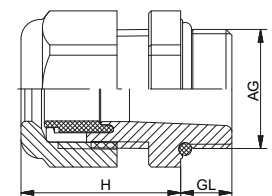

| AG            | ∅k<br>mm | GL<br>mm | H<br>mm | ⌀<br>mm | Number<br>black | Number<br>blue-black |
|---------------|----------|----------|---------|---------|-----------------|----------------------|
| NPT 3/8"      | 4–8      | 15       | 22      | 19 / 22 | 1.292.3801.70   | 1.292.3802.70        |
| NPT 3/8"      | 3–6      | 15       | 22      | 19 / 22 | 1.292.3801.71   | 1.292.3802.71        |
| NPT 1/2"      | 6–12     | 13       | 27      | 24      | 1.292.1201.70   | 1.292.1202.70        |
| NPT 1/2"      | 5–9      | 13       | 27      | 24      | 1.292.1201.71   | 1.292.1202.71        |
| NPT 1/2" (16) | 10–14    | 13       | 28      | 27      | 1.292.1216.70   | 1.292.1217.70        |
| NPT 1/2" (16) | 7–12     | 13       | 28      | 27      | 1.292.1216.71   | 1.292.1217.71        |
| NPT 3/4"      | 13–18    | 14       | 31      | 33      | 1.292.3401.70   | 1.292.3402.70        |
| NPT 3/4"      | 9–16     | 14       | 31      | 33      | 1.292.3401.71   | 1.292.3402.71        |
| NPT 1"        | 18–25    | 19       | 39      | 42      | 1.292.1001.70   | 1.292.1002.70        |
| NPT 1"        | 13–20    | 19       | 39      | 42      | 1.292.1001.71   | 1.292.1002.71        |
| NPT 1 1/4"    | 18–25    | 16       | 39      | 42 / 46 | 1.292.5401.70   | 1.292.5402.70        |
| NPT 1 1/4"    | 13–20    | 16       | 39      | 42 / 46 | 1.292.5401.71   | 1.292.5402.71        |
| NPT 1 1/2"    | 22–32    | 20       | 48      | 53      | 1.292.6401.70   | 1.292.6402.70        |
| NPT 1 1/2"    | 20–26    | 20       | 48      | 53      | 1.292.6401.71   | 1.292.6402.71        |

# Ex e PLASTIC CABLE GLANDS

HSK-K-Multi-Ex-Active

Metr., NPT



|                       |  |
|-----------------------|--|
| Material              | Polyamide, fiber reinforced                        |
| Seal                  | Elastomer  |
| O-Ring                | Buna-N   |
| Protection            | IP 68 – 10 bar within the specified clamping range |
| Operating Temperature | -20 °C – 85 °C (-4 °F – 185 °F)                    |
| Colors                | black (RAL 9005) / blue-black (RAL 5012)           |

- // FKM and VMQ O-Ring upon request
- // The inserts shown are samples, more inserts upon request

**Installation Instructions:** Cable diameter should not be less than 20% of hole diameter and the difference between cable diameter and hole should never exceed 1 mm (.04").



II 2G Ex eb IIC Gb  
II 1D Ex ta IIIC Da

Class I Div 2 Groups A, B, C, D  
Class II Div 1 Groups E, F, G

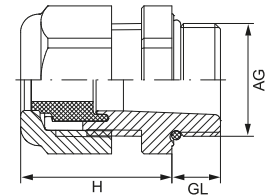

| AG            | GL mm | H mm | Ø mm  | Number of holes x d | Number black  | Number blue-black | Number of holes x d | Number black  | Number blue-black |
|---------------|-------|------|-------|---------------------|---------------|-------------------|---------------------|---------------|-------------------|
| M 16 x 1,5    | 8     | 22   | 19    | 4 x 1,4             | 1.581.1600.51 | 1.581.1600.52     | 2 x 3               | 1.581.1601.51 | 1.581.1601.52     |
| M 20 x 1,5    | 9     | 27   | 24    | 6 x 3               | 1.581.2001.51 | 1.581.2001.52     | 2 x 5               | 1.581.2003.51 | 1.581.2003.52     |
| M 25 x 1,5    | 11    | 31   | 33    | 4 x 6               | 1.581.2500.51 | 1.581.2500.52     | 3 x 7               | 1.581.2501.51 | 1.581.2501.52     |
| M 32 x 1,5    | 11    | 39   | 42    | 6 x 6,5             | 1.581.3200.51 | 1.581.3200.52     | 4 x 9               | 1.581.3201.51 | 1.581.3201.52     |
| M 40 x 1,5    | 13    | 48   | 53    | 7 x 9               | 1.581.4001.51 | 1.581.4001.52     | 2 x 15              | 1.581.4003.51 | 1.581.4003.52     |
| M 50 x 1,5    | 13    | 49   | 60    |                     | 1.581.5099.51 | 1.581.5099.52     |                     |               |                   |
| M 63 x 1,5    | 14    | 49   | 65/68 | 6 x 12              | 1.581.6301.51 | 1.581.6301.52     | 3 x 18              | 1.581.6302.51 | 1.581.6302.52     |
| NPT 3/8"      | 15    | 22   | 19/22 | 4 x 1,4             | 1.581.3800.71 | 1.581.3800.72     | 2 x 3               | 1.581.3801.71 | 1.581.3801.72     |
| NPT 1/2"      | 13    | 27   | 24    | 3 x 4               | 1.581.1202.71 | 1.581.1202.72     | 2 x 5               | 1.581.1203.71 | 1.581.1203.72     |
| NPT 1/2" (16) | 13    | 28   | 27    | 6 x 4               | 1.581.1220.71 | 1.581.1220.72     | 2 x 6               | 1.581.1221.71 | 1.581.1221.72     |
| NPT 3/4"      | 14    | 31   | 33    | 4 x 6               | 1.581.3400.71 | 1.581.3400.72     | 3 x 7               | 1.581.3401.71 | 1.581.3401.72     |
| NPT 1"        | 19    | 39   | 42    | 6 x 6,5             | 1.581.1000.71 | 1.581.1000.72     | 4 x 9               | 1.581.1001.71 | 1.581.1001.72     |
| NPT 1 1/4"    | 16    | 39   | 42/46 |                     | 1.581.5499.71 | 1.581.5499.72     |                     |               |                   |
| NPT 1 1/2"    | 20    | 48   | 53    | 5 x 9               | 1.581.6400.71 | 1.581.6400.72     | 7 x 9               | 1.581.6401.71 | 1.581.6401.72     |

## HSK-K-Flaka-Ex-Active

Metr., NPT



|                       |  |
|-----------------------|--|
| Material              | Polyamide, fiber reinforced                        |
| Seal                  | Elastomer  |
| O-Ring                | Buna-N   |
| Protection            | IP 68 – 10 bar within the specified clamping range |
| Operating Temperature | -20 °C – 85 °C (-4 °F – 185 °F)                    |
| Colors                | black (RAL 9005) / blue-black (RAL 5012)           |

- // FKM and VMQ O-Ring upon request
- // The inserts shown are samples, more inserts upon request

**Installation Instructions:** The clamping range of the cable used may not deviate from the manufacturer-specified minimum values by more than 1 mm in length and 1 mm in width. The geometries of the cable and the insert hole must be compatible (semicircular or straight at the sides).



II 2G Ex eb IIC Gb  
II 1D Ex ta IIIC Da

Class I Div 2 Groups A, B, C, D  
Class II Div 1 Groups E, F, G

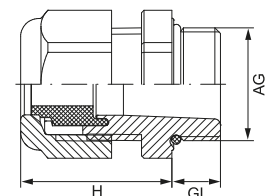

| AG            | GL mm | H mm | Ø mm  | Dimensions w x h mm | Number black  | Number blue-black | Dimensions w x h mm | Number black  | Number blue-black |
|---------------|-------|------|-------|---------------------|---------------|-------------------|---------------------|---------------|-------------------|
| M 20 x 1,5    | 9     | 28   | 27    | 12 x 7              | 1.582.2017.51 | 1.582.2017.52     | 14 x 6              | 1.582.2018.51 | 1.582.2018.52     |
| M 25 x 1,5    | 11    | 31   | 33    | 14 x 6              | 1.582.2500.51 | 1.582.2500.52     | 14,5 x 7,2          | 1.582.2501.51 | 1.582.2501.52     |
| M 32 x 1,5    | 11    | 39   | 42    | 22 x 8              | 1.582.3200.51 | 1.582.3200.52     |                     |               |                   |
| M 40 x 1,5    | 13    | 48   | 53    | 28,5 x 10           | 1.582.4000.51 | 1.582.4000.52     | 29 x 5,5            | 1.582.4001.51 | 1.582.4001.52     |
| M 40 x 1,5    | 13    | 48   | 53    | 30,5 x 12           | 1.582.4002.51 | 1.582.4002.52     | 31 x 7,5            | 1.582.4003.51 | 1.582.4003.52     |
| M 50 x 1,5    | 13    | 49   | 60    | 33,5 x 11,5         | 1.582.5000.51 | 1.582.5000.52     |                     |               |                   |
| NPT 1/2" (16) | 13    | 28   | 27    | 12 x 7              | 1.582.1217.71 | 1.582.1217.72     | 14 x 6              | 1.582.1218.71 | 1.582.1218.72     |
| NPT 3/4"      | 14    | 31   | 33    | 14 x 6              | 1.582.3400.71 | 1.582.3400.72     |                     |               |                   |
| NPT 1"        | 19    | 39   | 42    | 22 x 8              | 1.582.1000.71 | 1.582.1000.72     |                     |               |                   |
| NPT 1 1/4"    | 16    | 39   | 42/46 | 22 x 8              | 1.582.5400.71 | 1.582.5400.72     |                     |               |                   |
| NPT 1 1/2"    | 16    | 48   | 53    | 28,5 x 10           | 1.582.6400.71 | 1.582.6400.72     | 29 x 5,5            | 1.582.6401.71 | 1.582.6401.72     |
| NPT 1 1/2"    | 20    | 48   | 53    | 30,5 x 12           | 1.582.6402.71 | 1.582.6402.72     | 31 x 7,5            | 1.582.6403.71 | 1.582.6403.72     |

# Ex e PLASTIC CABLE GLANDS

## HSK-K-MZ-Ex Metr.



|                       |   |
|-----------------------|---|
| Material              | Polyamide-AL                                |
| Seal                  | Buna-N                                      |
| O-Ring                | Buna-N                                      |
| Protection            | IP 68 – 10 bar / IP 69K (NEMA 6 – 150 PSIG) |
| Operating Temperature | -20 °C – 70 °C (-4 °F – 158 °F)             |



II 2G 1D

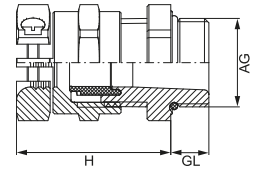

| AG         | $\varnothing$<br>mm | GL<br>mm | H<br>mm | <br>mm  | Number        |
|------------|---------------------|----------|---------|---------|---------------|
| M 16 x 1,5 | 4–8                 | 15       | 29      | 19      | 1.215.1601.50 |
| M 20 x 1,5 | 7–12                | 15       | 35,5    | 24      | 1.215.2001.50 |
| M 25 x 1,5 | 13–18               | 11       | 41      | 33      | 1.215.2501.50 |
| M 32 x 1,5 | 18–25               | 11       | 49      | 42      | 1.215.3201.50 |
| M 40 x 1,5 | 22–32               | 13       | 58      | 53      | 1.215.4001.50 |
| M 50 x 1,5 | 32–38               | 13       | 61,5    | 60      | 1.215.5001.50 |
| M 63 x 1,5 | 37–44               | 14       | 62      | 65 / 68 | 1.215.6301.50 |

## HSK-K-MZ-Ex

PG



|                       |   |
|-----------------------|---|
| Material              | Polyamide-AL                                |
| Seal                  | Buna-N                                      |
| O-Ring                | Buna-N                                      |
| Protection            | IP 68 – 10 bar / IP 69K (NEMA 6 – 150 PSIG) |
| Operating Temperature | -20 °C – 70 °C (-4 °F – 158 °F)             |

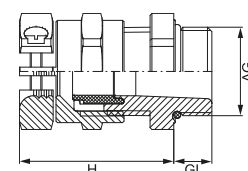

| AG      | $\varnothing$<br>mm | GL<br>mm | H<br>mm | <br>mm | Number        |
|---------|---------------------|----------|---------|--------|---------------|
| PG 9    | 4–8                 | 15       | 29      | 19     | 1.215.0901.14 |
| PG 11   | 6–10                | 15       | 32,5    | 22     | 1.215.1101.14 |
| PG 13,5 | 7–12                | 15       | 35,5    | 24     | 1.215.1301.14 |
| PG 16   | 10–14               | 10       | 37,5    | 27     | 1.215.1601.14 |
| PG 21   | 13–18               | 11       | 41      | 33     | 1.215.2101.14 |
| PG 29   | 18–25               | 11       | 49      | 42     | 1.215.2901.14 |
| PG 36   | 22–32               | 13       | 58      | 53     | 1.215.3601.14 |
| PG 42   | 32–38               | 13       | 61,5    | 60     | 1.215.4201.14 |
| PG 48   | 37–44               | 14       | 62      | 65     | 1.215.4801.14 |

# Ex e METAL CABLE GLANDS

## HSK-M-Ex / HSK-M-PVDF-Ex Metr.



|                       |   |
|-----------------------|---|
| Material              | Nickel plated brass   |
| Clamping insert       | Polyamide / PVDF  |
| Seal                  | Buna-N / FKM  |
| O-Ring                | Buna-N / FKM  |
| Protection            | IP 68 – 10 bar / IP 69K (NEMA 6 – 150 PSIG)   |
| Operating Temperature | -20 °C – 95 °C (-4 °F – 203 °F) (PA)<br>-60 °C – 95 °C (-76 °F – 203 °F) (PA) / -20 °C – 130 °C (-4 °F – 266 °F) (PVDF) |

// With pre-assembled dust disc upon request

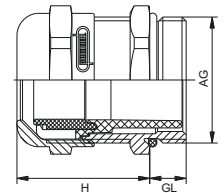

| AG         | ∅ <sub>k</sub><br>mm | GL<br>mm | H<br>mm | mm      | Number<br>HSK-M-Ex<br>-20 °C – 95 °C | Number<br>HSK-M-Ex<br>-60 °C – 95 °C | Number<br>HSK-M-PVDF-Ex<br>-20 °C – 130 °C |
|------------|----------------------|----------|---------|---------|--------------------------------------|--------------------------------------|--|
| M 12 x 1,5 | 3–6,5                | 6,5      | 19      | 14      | 1.610.1200.50                        | 1.640.1200.50                        | 1.660.1200.50                              |
| M 12 x 1,5 | 2–5                  | 6,5      | 19      | 14      | 1.610.1200.51                        | 1.640.1200.51                        | 1.660.1200.51                              |
| M 16 x 1,5 | 4–8                  | 6        | 21      | 17 / 19 | 1.610.1600.50                        | 1.640.1600.50                        | 1.660.1600.50                              |
| M 16 x 1,5 | 2–6                  | 6        | 21      | 17 / 19 | 1.610.1600.51                        | 1.640.1600.51                        | 1.660.1600.51                              |
| M 16 x 1,5 | 6–10                 | 6        | 22      | 20      | 1.610.1611.50                        | 1.640.1611.50                        | 1.660.1611.50                              |
| M 16 x 1,5 | 3–7                  | 6        | 22      | 20      | 1.610.1611.51                        | 1.640.1611.51                        | 1.660.1611.51                              |
| M 20 x 1,5 | 7–12                 | 6        | 23      | 22      | 1.610.2000.50                        | 1.640.2000.50                        | 1.660.2000.50                              |
| M 20 x 1,5 | 5–9                  | 6        | 23      | 22      | 1.610.2000.51                        | 1.640.2000.51                        | 1.660.2000.51                              |
| M 20 x 1,5 | 10–14                | 6        | 24      | 24      | 1.610.2016.50                        | 1.640.2016.50                        | 1.660.2016.50                              |
| M 20 x 1,5 | 7–12                 | 6        | 24      | 24      | 1.610.2016.51                        | 1.640.2016.51                        | 1.660.2016.51                              |
| M 25 x 1,5 | 14–18                | 7        | 26      | 30      | 1.610.2500.50                        | 1.640.2500.50                        | 1.660.2500.50                              |
| M 25 x 1,5 | 10–16                | 7        | 26      | 30      | 1.610.2500.51                        | 1.640.2500.51                        | 1.660.2500.51                              |
| M 32 x 1,5 | 20–25                | 8        | 31      | 40      | 1.610.3200.50                        | 1.640.3200.50                        | 1.660.3200.50                              |
| M 32 x 1,5 | 13–20                | 8        | 31      | 40      | 1.610.3200.51                        | 1.640.3200.51                        | 1.660.3200.51                              |
| M 40 x 1,5 | 22–32                | 8        | 37      | 50      | 1.610.4000.50                        | 1.640.4000.50                        | 1.660.4000.50                              |
| M 40 x 1,5 | 20–26                | 8        | 37      | 50      | 1.610.4000.51                        | 1.640.4000.51                        | 1.660.4000.51                              |
| M 50 x 1,5 | 32–38                | 9        | 37      | 57      | 1.610.5000.50                        | 1.640.5000.50                        |  |
| M 50 x 1,5 | 25–31                | 9        | 37      | 57      | 1.610.5000.51                        | 1.640.5000.51                        |  |
| M 63 x 1,5 | 37–44                | 10       | 38      | 64 / 68 | 1.610.6300.50                        | 1.640.6300.50                        |  |
| M 63 x 1,5 | 29–35                | 10       | 38      | 64 / 68 | 1.610.6300.51                        | 1.640.6300.51                        |  |



## HSK-M-Ex / HSK-M-PVDF-Ex

## Metr.-elongated



|                       |   |
|-----------------------|---|
| Material              | Nickel plated brass   |
| Clamping insert       | Polyamide / PVDF  |
| Seal                  | Buna-N / FKM  |
| O-Ring                | Buna-N / FKM  |
| Protection            | IP 68 – 10 bar / IP 69K (NEMA 6 – 150 PSIG)   |
| Operating Temperature | -20 °C – 95 °C (-4 °F – 203 °F) (PA)<br>-60 °C – 95 °C (-76 °F – 203 °F) (PA) / -20 °C – 130 °C (-4 °F – 266 °F) (PVDF) |

// With pre-assembled dust disc upon request

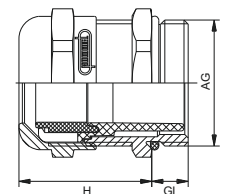

| AG         | $\varnothing k$<br>mm | GL<br>mm | H<br>mm | $\varnothing$<br>mm | Number<br>HSK-M-Ex<br>-20 °C – 95 °C | Number<br>HSK-M-Ex<br>-60 °C – 95 °C | Number<br>HSK-M-PVDF-Ex<br>-20 °C – 130 °C |
|------------|-----------------------|----------|---------|---------------------|--------------------------------------|--------------------------------------|--|
| M 12 x 1,5 | 3–6,5                 | 10       | 19      | 14                  | 1.610.1200.30                        | 1.640.1200.30                        | 1.660.1200.30                              |
| M 12 x 1,5 | 2–5                   | 10       | 19      | 14                  | 1.610.1200.31                        | 1.640.1200.31                        | 1.660.1200.31                              |
| M 16 x 1,5 | 4–8                   | 10       | 21      | 17 / 19             | 1.610.1600.30                        | 1.640.1600.30                        | 1.660.1600.30                              |
| M 16 x 1,5 | 2–6                   | 10       | 21      | 17 / 19             | 1.610.1600.31                        | 1.640.1600.31                        | 1.660.1600.31                              |
| M 16 x 1,5 | 6–10                  | 10       | 22      | 20                  | 1.610.1611.30                        | 1.640.1611.30                        | 1.660.1611.30                              |
| M 16 x 1,5 | 3–7                   | 10       | 22      | 20                  | 1.610.1611.31                        | 1.640.1611.31                        | 1.660.1611.31                              |
| M 20 x 1,5 | 7–12                  | 10       | 23      | 22                  | 1.610.2000.30                        | 1.640.2000.30                        | 1.660.2000.30                              |
| M 20 x 1,5 | 5–9                   | 10       | 23      | 22                  | 1.610.2000.31                        | 1.640.2000.31                        | 1.660.2000.31                              |
| M 20 x 1,5 | 10–14                 | 10       | 24      | 24                  | 1.610.2016.30                        | 1.640.2016.30                        | 1.660.2016.30                              |
| M 20 x 1,5 | 7–12                  | 10       | 24      | 24                  | 1.610.2016.31                        | 1.640.2016.31                        | 1.660.2016.31                              |
| M 25 x 1,5 | 14–18                 | 12       | 26      | 30                  | 1.610.2500.30                        | 1.640.2500.30                        | 1.660.2500.30                              |
| M 25 x 1,5 | 10–16                 | 12       | 26      | 30                  | 1.610.2500.31                        | 1.640.2500.31                        | 1.660.2500.31                              |
| M 32 x 1,5 | 20–25                 | 12       | 31      | 40                  | 1.610.3200.30                        | 1.640.3200.30                        | 1.660.3200.30                              |
| M 32 x 1,5 | 13–20                 | 12       | 31      | 40                  | 1.610.3200.31                        | 1.640.3200.31                        | 1.660.3200.31                              |
| M 40 x 1,5 | 22–32                 | 15       | 37      | 50                  | 1.610.4000.30                        | 1.640.4000.30                        | 1.660.4000.30                              |
| M 40 x 1,5 | 20–26                 | 15       | 37      | 50                  | 1.610.4000.31                        | 1.640.4000.31                        | 1.660.4000.31                              |
| M 50 x 1,5 | 32–38                 | 15       | 37      | 57                  | 1.610.5000.30                        | 1.640.5000.30                        |  |
| M 50 x 1,5 | 25–31                 | 15       | 37      | 57                  | 1.610.5000.31                        | 1.640.5000.31                        |  |
| M 63 x 1,5 | 37–44                 | 15       | 38      | 64 / 68             | 1.610.6300.30                        | 1.640.6300.30                        |  |
| M 63 x 1,5 | 29–35                 | 15       | 38      | 64 / 68             | 1.610.6300.31                        | 1.640.6300.31                        |  |

# Ex e METAL CABLE GLANDS

HSK-M-Ex / HSK-M-PVDF-Ex

PG, NPT



|                       |   |
|-----------------------|---|
| Material              | Nickel plated brass   |
| Clamping insert       | Polyamide / PVDF  |
| Seal                  | Buna-N / FKM  |
| O-Ring                | Buna-N / FKM  |
| Protection            | IP 68 – 10 bar / IP 69K (NEMA 6 – 150 PSIG)   |
| Operating Temperature | -20 °C – 95 °C (-4 °F – 203 °F) (PA)<br>-60 °C – 95 °C (-76 °F – 203 °F) (PA) / -20 °C – 130 °C (-4 °F – 266 °F) (PVDF) |

// With pre-assembled dust disc upon request

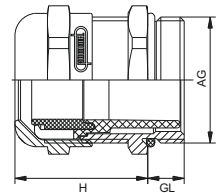

| AG       | ∅ <sub>k</sub><br>mm | GL<br>mm | H<br>mm | ⌀ <sub>R</sub><br>mm | Number<br>HSK-M-Ex<br>-20 °C – 95 °C | Number<br>HSK-M-Ex<br>-60 °C – 95 °C | Number<br>HSK-M-PVDF-Ex<br>-20 °C – 130 °C |
|----------|----------------------|----------|---------|----------------------|--------------------------------------|--------------------------------------|--|
| PG 7     | 3–6,5                | 5        | 19      | 14                   | 1.610.0700.01                        | 1.640.0700.01                        | 1.660.0700.01                              |
| PG 7     | 2–5                  | 5        | 19      | 14                   | 1.610.0700.15                        | 1.640.0700.15                        | 1.660.0700.15                              |
| PG 9     | 4–8                  | 6        | 21      | 17                   | 1.610.0900.01                        | 1.640.0900.01                        | 1.660.0900.01                              |
| PG 9     | 2–6                  | 6        | 21      | 17                   | 1.610.0900.15                        | 1.640.0900.15                        | 1.660.0900.15                              |
| PG 11    | 6–10                 | 6        | 22      | 20                   | 1.610.1100.01                        | 1.640.1100.01                        | 1.660.1100.01                              |
| PG 11    | 3–7                  | 6        | 22      | 20                   | 1.610.1100.15                        | 1.640.1100.15                        | 1.660.1100.15                              |
| PG 13,5  | 7–12                 | 6,5      | 24      | 22                   | 1.610.1300.01                        | 1.640.1300.01                        | 1.660.1300.01                              |
| PG 13,5  | 5–9                  | 6,5      | 24      | 22                   | 1.610.1300.15                        | 1.640.1300.15                        | 1.660.1300.15                              |
| PG 16    | 10–14                | 6,5      | 23      | 24                   | 1.610.1600.01                        | 1.640.1600.01                        | 1.660.1600.01                              |
| PG 16    | 7–12                 | 6,5      | 23      | 24                   | 1.610.1600.15                        | 1.640.1600.15                        | 1.660.1600.15                              |
| PG 21    | 14–18                | 7        | 24      | 30                   | 1.610.2100.01                        | 1.640.2100.01                        | 1.660.2100.01                              |
| PG 21    | 10–16                | 7        | 24      | 30                   | 1.610.2100.15                        | 1.640.2100.15                        | 1.660.2100.15                              |
| PG 29    | 20–25                | 8        | 29      | 40                   | 1.610.2900.01                        | 1.640.2900.01                        | 1.660.2900.01                              |
| PG 29    | 13–20                | 8        | 29      | 40                   | 1.610.2900.15                        | 1.640.2900.15                        | 1.660.2900.15                              |
| PG 36    | 22–32                | 8        | 35      | 50                   | 1.610.3600.01                        | 1.640.3600.01                        | 1.660.3600.01                              |
| PG 36    | 20–26                | 8        | 35      | 50                   | 1.610.3600.15                        | 1.640.3600.15                        | 1.660.3600.15                              |
| PG 42    | 32–38                | 9        | 37      | 57                   | 1.610.4200.01                        | 1.640.4200.01                        | 1.660.4200.01                              |
| PG 42    | 25–31                | 9        | 37      | 57                   | 1.610.4200.15                        | 1.640.4200.15                        | 1.660.4200.15                              |
| PG 48    | 37–44                | 10       | 38      | 64                   | 1.610.4800.01                        | 1.640.4800.01                        | 1.660.4800.01                              |
| PG 48    | 29–35                | 10       | 38      | 64                   | 1.610.4800.15                        | 1.640.4800.15                        | 1.660.4800.15                              |
| NPT 3/8" | 4–8                  | 15       | 21      | 17 / 19              | 1.610.3800.70                        | 1.640.3800.70                        | 1.660.3800.70                              |
| NPT 3/8" | 2–6                  | 15       | 21      | 17 / 19              | 1.610.3800.71                        | 1.640.3800.71                        | 1.660.3800.71                              |
| NPT 1/2" | 7–12                 | 13       | 24      | 22 / 24              | 1.610.1200.70                        | 1.640.1200.70                        | 1.660.1200.70                              |
| NPT 1/2" | 5–9                  | 13       | 24      | 22 / 24              | 1.610.1200.71                        | 1.640.1200.71                        | 1.660.1200.71                              |
| NPT 3/4" | 14–18                | 13       | 25      | 30                   | 1.610.3400.70                        | 1.640.3400.70                        | 1.660.3400.70                              |
| NPT 3/4" | 10–16                | 13       | 25      | 30                   | 1.610.3400.71                        | 1.640.3400.71                        | 1.660.3400.71                              |
| NPT 1"   | 20–25                | 19       | 29      | 40                   | 1.610.1000.70                        | 1.640.1000.70                        | 1.660.1000.70                              |
| NPT 1"   | 13–20                | 19       | 29      | 40                   | 1.610.1000.71                        | 1.640.1000.71                        | 1.660.1000.71                              |

## HSK-M-Ex / HSK-M-PVDF-Ex

## PG-elongated



|                       |   |
|-----------------------|---|
| Material              | Messing vernickelt  |
| Clamping insert       | Polyamide / PVDF  |
| Seal                  | Buna-N / FKM  |
| O-Ring                | Buna-N / FKM  |
| Protection            | IP 68 – 10 bar / IP 69K (NEMA 6 – 150 PSIG)   |
| Operating Temperature | -20 °C – 95 °C (-4 °F – 203 °F) (PA)<br>-60 °C – 95 °C (-76 °F – 203 °F) (PA) / -20 °C – 130 °C (-4 °F – 266 °F) (PVDF) |

// With pre-assembled dust disc upon request

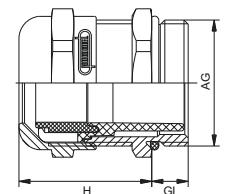

| AG      | $\varnothing k$<br>mm | GL<br>mm | H<br>mm | $\varnothing$<br>mm | Number<br>HSK-M-Ex<br>-20 °C – 95 °C | Number<br>HSK-M-Ex<br>-60 °C – 95 °C | Number<br>HSK-M-PVDF-Ex<br>-20 °C – 130 °C |
|---------|-----------------------|----------|---------|---------------------|--------------------------------------|--------------------------------------|--|
| PG 7    | 3–6,5                 | 10       | 19      | 14                  | 1.610.0700.60                        | 1.640.0700.60                        | 1.660.0700.60                              |
| PG 7    | 2–5                   | 10       | 19      | 14                  | 1.610.0700.61                        | 1.640.0700.61                        | 1.660.0700.61                              |
| PG 9    | 4–8                   | 10       | 21      | 17                  | 1.610.0900.60                        | 1.640.0900.60                        | 1.660.0900.60                              |
| PG 9    | 2–6                   | 10       | 21      | 17                  | 1.610.0900.61                        | 1.640.0900.61                        | 1.660.0900.61                              |
| PG 11   | 6–10                  | 10       | 22      | 20                  | 1.610.1100.60                        | 1.640.1100.60                        | 1.660.1100.60                              |
| PG 11   | 3–7                   | 10       | 22      | 20                  | 1.610.1100.61                        | 1.640.1100.61                        | 1.660.1100.61                              |
| PG 13,5 | 7–12                  | 10       | 24      | 22                  | 1.610.1300.60                        | 1.640.1300.60                        | 1.660.1300.60                              |
| PG 13,5 | 5–9                   | 10       | 24      | 22                  | 1.610.1300.61                        | 1.640.1300.61                        | 1.660.1300.61                              |
| PG 16   | 10–14                 | 10       | 23      | 24                  | 1.610.1600.60                        | 1.640.1600.60                        | 1.660.1600.60                              |
| PG 16   | 7–12                  | 10       | 23      | 24                  | 1.610.1600.61                        | 1.640.1600.61                        | 1.660.1600.61                              |
| PG 21   | 14–18                 | 12       | 24      | 30                  | 1.610.2100.60                        | 1.640.2100.60                        | 1.660.2100.60                              |
| PG 21   | 10–16                 | 12       | 24      | 30                  | 1.610.2100.61                        | 1.640.2100.61                        | 1.660.2100.61                              |
| PG 29   | 20–25                 | 12       | 29      | 40                  | 1.610.2900.60                        | 1.640.2900.60                        | 1.660.2900.60                              |
| PG 29   | 13–20                 | 12       | 29      | 40                  | 1.610.2900.61                        | 1.640.2900.61                        | 1.660.2900.61                              |
| PG 36   | 22–32                 | 15       | 35      | 50                  | 1.610.3600.60                        | 1.640.3600.60                        | 1.660.3600.60                              |
| PG 36   | 20–26                 | 15       | 35      | 50                  | 1.610.3600.61                        | 1.640.3600.61                        | 1.660.3600.61                              |
| PG 42   | 32–38                 | 15       | 37      | 57                  | 1.610.4200.60                        | 1.640.4200.60                        | 1.660.4200.60                              |
| PG 42   | 25–31                 | 15       | 37      | 57                  | 1.610.4200.61                        | 1.640.4200.61                        | 1.660.4200.61                              |
| PG 48   | 37–44                 | 15       | 38      | 64                  | 1.610.4800.60                        | 1.640.4800.60                        | 1.660.4800.60                              |
| PG 48   | 29–35                 | 15       | 38      | 64                  | 1.610.4800.61                        | 1.640.4800.61                        | 1.660.4800.61                              |

# Ex e METAL CABLE GLANDS

## HSK-M-Multi-Ex

Metr., PG, NPT



|                       |                                 |
|-----------------------|---------------------------------|
| Material              | Nickel plated brass             |
| Clamping insert       | Polyamide                       |
| Seal                  | Elastomer                       |
| O-Ring                | Buna-N                          |
| Protection            | IP 68                           |
| Operating Temperature | -20 °C – 95 °C (-4 °F – 203 °F) |

- // INOX upon request
- // The inserts shown are samples, more inserts upon request

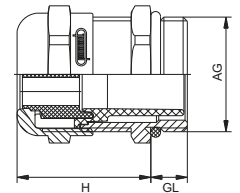

| AG         | GL mm | H mm | ⌀ mm  | Number of holes x d | Number        | Number of holes x d | Number        |
|------------|-------|------|-------|---------------------|---------------|---------------------|---------------|
| M 16 x 1,5 | 6     | 21   | 17/19 | 4 x 1,4             | 1.687.1600.50 | 2 x 3               | 1.687.1601.50 |
| M 20 x 1,5 | 6     | 23   | 22    | 6 x 3               | 1.687.2001.50 | 2 x 5               | 1.687.2003.50 |
| M 25 x 1,5 | 7     | 26   | 30    | 4 x 6               | 1.687.2500.50 | 3 x 7               | 1.687.2501.50 |
| M 32 x 1,5 | 8     | 31   | 40    | 6 x 6,5             | 1.687.3200.50 | 4 x 9               | 1.687.3201.50 |
| M 40 x 1,5 | 8     | 37   | 50    | 7 x 9               | 1.687.4001.50 | 2 x 15              | 1.687.4003.50 |
| M 50 x 1,5 | 9     | 37   | 57    |                     |               |                     | 1.687.5099.50 |
| M 63 x 1,5 | 10    | 38   | 64/68 | 6 x 12              | 1.687.6301.50 | 3 x 18              | 1.687.6302.50 |
| PG 9       | 6     | 21   | 17    | 4 x 1,4             | 1.687.0900.01 | 2 x 3               | 1.687.0901.01 |
| PG 11      | 6     | 22   | 20    | 2 x 4               | 1.687.1102.01 | 3 x 3               | 1.687.1101.01 |
| PG 13,5    | 6,5   | 24   | 22    | 3 x 4               | 1.687.1302.01 | 2 x 5               | 1.687.1303.01 |
| PG 16      | 6,5   | 23   | 24    | 4 x 4               | 1.687.1602.01 | 6 x 4               | 1.687.1604.01 |
| PG 16      | 6,5   | 23   | 24    | 3 x 5,6             | 1.687.1606.01 | 2 x 6               | 1.687.1605.01 |
| PG 21      | 7     | 24   | 30    | 4 x 6               | 1.687.2100.01 | 3 x 7               | 1.687.2101.01 |
| PG 29      | 8     | 29   | 40    | 6 x 6,5             | 1.687.2900.01 | 4 x 9               | 1.687.2901.01 |
| PG 36      | 8     | 35   | 50    | 7 x 9               | 1.687.3601.01 | 2 x 15              | 1.687.3603.01 |
| PG 48      | 10    | 38   | 64    | 6 x 12              | 1.687.4801.01 | 3 x 18              | 1.687.4802.01 |
| NPT 3/8"   | 15    | 21   | 17/19 | 4 x 1,4             | 1.687.3800.70 | 2 x 3               | 1.687.3801.70 |
| NPT 1/2"   | 13    | 24   | 24    | 3 x 4               | 1.687.1220.70 | 2 x 5               | 1.687.1203.70 |
| NPT 3/4"   | 13    | 25   | 30    | 4 x 6               | 1.687.3400.70 | 3 x 7               | 1.687.3401.70 |
| NPT 1"     | 19    | 29   | 40    | 6 x 6,5             | 1.687.1000.70 | 4 x 9               | 1.687.1001.70 |

## HSK-M-Flaka-Ex

Metr., PG, NPT



|                       |                                 |
|-----------------------|---------------------------------|
| Material              | Nickel plated brass             |
| Clamping insert       | Polyamide                       |
| Seal                  | Elastomer                       |
| O-Ring                | Buna-N                          |
| Operating Temperature | -20 °C – 95 °C (-4 °F – 203 °F) |



II 2G 1D

- // INOX upon request
- // The inserts shown are samples, more inserts upon request

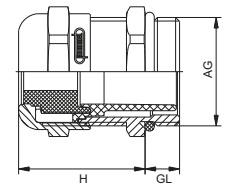

| AG         | GL<br>mm | H<br>mm | mm    | w x h<br>mm | Number        | w x h<br>mm | Number        |
|------------|----------|---------|-------|-------------|---------------|-------------|---------------|
| M 20 x 1,5 | 6        | 24      | 24    | 12 x 7      | 1.689.2017.50 | 14 x 6      | 1.689.2018.50 |
| M 25 x 1,5 | 7        | 26      | 30    | 14 x 6      | 1.689.2500.50 | 14 x 7      | 1.689.2501.50 |
| M 32 x 1,5 | 8        | 31      | 40    | 22 x 8      | 1.689.3200.50 |             |               |
| M 40 x 1,5 | 8        | 37      | 50    | 28,5 x 10   | 1.689.4000.50 | 29 x 5,5    | 1.689.4001.50 |
| M 40 x 1,5 | 8        | 37      | 50    | 30,5 x 12   | 1.689.4002.50 | 31 x 7,5    | 1.689.4003.50 |
| M 50 x 1,5 | 9        | 37      | 57    | 33,5 x 11,5 | 1.689.5000.50 |             |               |
| M 63 x 1,5 | 10       | 38      | 64/68 | 38 x 12     | 1.689.6300.50 |             |               |
| PG 16      | 6,5      | 23      | 24    | 12 x 7      | 1.689.1601.01 | 14 x 6      | 1.689.1602.01 |
| PG 21      | 7        | 24      | 30    | 14 x 6      | 1.689.2100.01 | 14 x 7      | 1.689.2101.01 |
| PG 29      | 8        | 29      | 40    | 22 x 8      | 1.689.2900.01 |             |               |
| PG 36      | 8        | 35      | 50    | 28,5 x 10   | 1.689.3600.01 | 29 x 5,5    | 1.689.3601.01 |
| PG 36      | 8        | 35      | 50    | 30,5 x 12   | 1.689.3602.01 | 31 x 7,5    | 1.689.3603.01 |
| PG 42      | 9        | 37      | 57    | 33,5 x 11,5 | 1.689.4200.01 |             |               |
| PG 48      | 10       | 38      | 64    | 38 x 12     | 1.689.4802.01 |             |               |
| NPT 3/4"   | 13       | 25      | 30    | 14 x 6      | 1.689.3400.70 | 14 x 7      | 1.689.3401.70 |
| NPT 1"     | 19       | 29      | 40    | 22 x 8      | 1.689.1000.70 |             |               |

# Ex e METAL CABLE GLANDS

HSK-MZ-Ex / HSK-MZ-PVDF-Ex

Metr., PG, NPT



|                       |  |
|-----------------------|--|
| Material              | Nickel plated brass  |
| Clamping insert       | Polyamide / PVDF   |
| Seal                  | Buna-N / FKM   |
| O-Ring                | Buna-N / FKM   |
| Protection            | IP 68 – 10 bar / IP 69K (NEMA 6 – 150 PSIG)  |
| Operating Temperature | -20 °C – 95 °C (-4 °F – 203 °F)<br>-60 °C – 95 °C (-76 °F – 203 °F) (PA) / -20 °C – 130 °C (-4 °F – 266 °F) (PVDF) |

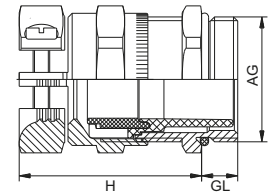

| AG         | $\varnothing$ mm | GL mm | H mm | $\varnothing$ mm | Number<br>HSK-MZ-Ex<br>-20 °C – 95 °C | Number<br>HSK-MZ-Ex<br>-60 °C – 95 °C | Number<br>HSK-MZ-PVDF-Ex<br>-20 °C – 130 °C |
|------------|------------------|-------|------|------------------|---------------------------------------|---------------------------------------|---|
| M 12 x 1,5 | 3–6,5            | 6,5   | 26   | 14               | 1.611.1200.50                         | 1.641.1200.50                         | 1.661.1200.50                               |
| M 16 x 1,5 | 4–8              | 6     | 28   | 19               | 1.611.1600.50                         | 1.641.1600.50                         | 1.661.1600.50                               |
| M 16 x 1,5 | 6–10             | 6     | 30   | 20               | 1.611.1611.50                         | 1.641.1611.50                         | 1.661.1611.50                               |
| M 20 x 1,5 | 7–12             | 6     | 33   | 22               | 1.611.2000.50                         | 1.641.2000.50                         | 1.661.2000.50                               |
| M 20 x 1,5 | 10–14            | 6     | 33   | 24               | 1.611.2016.50                         | 1.641.2016.50                         | 1.661.2016.50                               |
| M 25 x 1,5 | 14–18            | 7     | 37   | 30               | 1.611.2500.50                         | 1.641.2500.50                         | 1.661.2500.50                               |
| M 32 x 1,5 | 20–25            | 8     | 43   | 40               | 1.611.3200.50                         | 1.641.3200.50                         | 1.661.3200.50                               |
| M 40 x 1,5 | 24–32            | 8     | 50   | 50               | 1.611.4000.50                         | 1.641.4000.50                         | 1.661.4000.50                               |
| M 50 x 1,5 | 32–38            | 9     | 51   | 57               | 1.611.5000.50                         | 1.641.5000.50                         |   |
| M 63 x 1,5 | 37–44            | 10    | 52   | 64 / 68          | 1.611.6300.50                         | 1.641.6300.50                         |   |
| PG 7       | 3–6,5            | 5     | 26   | 14               | 1.611.0700.01                         | 1.641.0700.01                         | 1.661.0700.01                               |
| PG 9       | 4–8              | 6     | 28   | 17               | 1.611.0900.01                         | 1.641.0900.01                         | 1.661.0900.01                               |
| PG 11      | 6–10             | 6     | 30   | 20               | 1.611.1100.01                         | 1.641.1100.01                         | 1.661.1100.01                               |
| PG 13,5    | 7–12             | 6     | 33   | 22               | 1.611.1300.01                         | 1.641.1300.01                         | 1.661.1300.01                               |
| PG 16      | 10–14            | 6     | 33   | 24               | 1.611.1600.01                         | 1.641.1600.01                         | 1.661.1600.01                               |
| PG 21      | 13–18            | 7     | 37   | 30               | 1.611.2100.01                         | 1.641.2100.01                         | 1.661.2100.01                               |
| PG 29      | 20–25            | 8     | 43   | 40               | 1.611.2900.01                         | 1.641.2900.01                         | 1.661.2900.01                               |
| PG 36      | 24–32            | 8     | 50   | 50               | 1.611.3600.01                         | 1.641.3600.01                         | 1.661.3600.01                               |
| PG 42      | 32–38            | 9     | 51   | 57               | 1.611.4200.01                         | 1.641.4200.01                         | 1.661.4200.01                               |
| PG 48      | 37–44            | 10    | 52   | 64               | 1.611.4800.01                         | 1.641.4800.01                         | 1.661.4800.01                               |
| NPT 3/8"   | 4–8              | 15    | 28   | 17 / 19          | 1.611.3800.70                         | 1.641.3800.70                         | 1.661.3800.70                               |
| NPT 1/2"   | 7–12             | 13    | 33   | 22 / 24          | 1.611.1200.70                         | 1.641.1200.70                         | 1.661.1200.70                               |
| NPT 3/4"   | 13–18            | 13    | 37   | 30               | 1.611.3400.70                         | 1.641.3400.70                         | 1.661.3400.70                               |
| NPT 1"     | 20–25            | 19    | 43   | 40               | 1.611.1000.70                         | 1.641.1000.70                         |   |

## HSK-INOX-Ex / HSK-INOX-PVDF-Ex

Metr., PG



|                       |  |
|-----------------------|--|
| Material              | INOX 1.4305  |
| Clamping insert       | Polyamid / PVDF  |
| Seal                  | NBR / FKM  |
| O-Ring                | NBR / FKM  |
| Protection            | IP 68 – 10 bar / IP 69K  |
| Operating Temperature | -20 °C – 95 °C (-4 °F – 203 °F)<br>-60 °C – 95 °C (-76 °F – 203 °F) (PA) / -20 °C – 130 °C (-4 °F – 266 °F) (PVDF) |

- // INOX 1.4404 upon request
- // With pre-assembled dust disc upon request

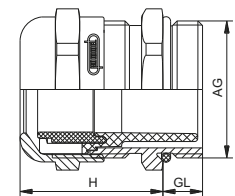

| AG         | ∅ <sub>k</sub><br>mm | GL<br>mm | H<br>mm | <br>mm | Number<br>HSK-INOX-Ex<br>-20 °C – 95 °C | Number<br>HSK-INOX-Ex<br>-60 °C – 95 °C | Number<br>HSK-INOX-PVDF-Ex<br>-20 °C – 130 °C |
|------------|----------------------|----------|---------|--------|---|---|---|
| M 12 x 1,5 | 3–6,5                | 6,5      | 19      | 14     | 1.612.1200.50                           | 1.642.1200.50                           | 1.662.1200.50                                 |
| M 12 x 1,5 | 2–5                  | 6,5      | 19      | 14     | 1.612.1200.51                           | 1.642.1200.51                           | 1.662.1200.51                                 |
| M 16 x 1,5 | 5–10                 | 6        | 22      | 22     | 1.612.1600.50                           | 1.642.1600.50                           | 1.662.1600.50                                 |
| M 16 x 1,5 | 3–7                  | 6        | 22      | 22     | 1.612.1600.51                           | 1.642.1600.51                           | 1.662.1600.51                                 |
| M 20 x 1,5 | 10–14                | 6        | 23      | 24     | 1.612.2000.50                           | 1.642.2000.50                           | 1.662.2000.50                                 |
| M 20 x 1,5 | 7–12                 | 6        | 23      | 24     | 1.612.2000.51                           | 1.642.2000.51                           | 1.662.2000.51                                 |
| M 25 x 1,5 | 13–18                | 7        | 24      | 30     | 1.612.2500.50                           | 1.642.2500.50                           | 1.662.2500.50                                 |
| M 25 x 1,5 | 9–16                 | 7        | 24      | 30     | 1.612.2500.51                           | 1.642.2500.51                           | 1.662.2500.51                                 |
| M 32 x 1,5 | 20–25                | 8        | 29      | 41     | 1.612.3200.50                           | 1.642.3200.50                           | 1.662.3200.50                                 |
| M 32 x 1,5 | 13–20                | 8        | 29      | 41     | 1.612.3200.51                           | 1.642.3200.51                           | 1.662.3200.51                                 |
| M 40 x 1,5 | 22–32                | 8        | 35      | 50     | 1.612.4000.50                           | 1.642.4000.50                           | 1.662.4000.50                                 |
| M 40 x 1,5 | 20–26                | 8        | 35      | 50     | 1.612.4000.51                           | 1.642.4000.51                           | 1.662.4000.51                                 |
| PG 7       | 3–6,5                | 5        | 19      | 14     | 1.612.0700.01                           | 1.642.0700.01                           | 1.662.0700.01                                 |
| PG 7       | 2–5                  | 5        | 19      | 14     | 1.612.0700.15                           | 1.642.0700.15                           | 1.662.0700.15                                 |
| PG 9       | 4–8                  | 6        | 21      | 17     | 1.612.0900.01                           | 1.642.0900.01                           | 1.662.0900.01                                 |
| PG 9       | 2–6                  | 6        | 21      | 17     | 1.612.0900.15                           | 1.642.0900.15                           | 1.662.0900.15                                 |
| PG 11      | 5–10                 | 6        | 22      | 22     | 1.612.1100.01                           | 1.642.1100.01                           | 1.662.1100.01                                 |
| PG 11      | 3–7                  | 6        | 22      | 22     | 1.612.1100.15                           | 1.642.1100.15                           | 1.662.1100.15                                 |
| PG 13,5    | 7–12                 | 6        | 24      | 22     | 1.612.1300.01                           | 1.642.1300.01                           | 1.662.1300.01                                 |
| PG 13,5    | 5–9                  | 6        | 24      | 22     | 1.612.1300.15                           | 1.642.1300.15                           | 1.662.1300.15                                 |
| PG 16      | 10–14                | 6        | 23      | 24     | 1.612.1600.01                           | 1.642.1600.01                           | 1.662.1600.01                                 |
| PG 16      | 7–12                 | 6        | 23      | 24     | 1.612.1600.15                           | 1.642.1600.15                           | 1.662.1600.15                                 |
| PG 21      | 13–18                | 7        | 24      | 30     | 1.612.2100.01                           | 1.642.2100.01                           | 1.662.2100.01                                 |
| PG 21      | 9–16                 | 7        | 24      | 30     | 1.612.2100.15                           | 1.642.2100.15                           | 1.662.2100.15                                 |
| PG 29      | 20–25                | 8        | 29      | 41     | 1.612.2900.01                           | 1.642.2900.01                           | 1.662.2900.01                                 |
| PG 29      | 13–20                | 8        | 29      | 41     | 1.612.2900.15                           | 1.642.2900.15                           | 1.662.2900.15                                 |
| PG 36      | 22–32                | 8        | 35      | 50     | 1.612.3600.01                           | 1.642.3600.01                           | 1.662.3600.01                                 |
| PG 36      | 20–26                | 8        | 35      | 50     | 1.612.3600.15                           | 1.642.3600.15                           | 1.662.3600.15                                 |

Plastic  
Metal  
EMC  
Special applications, DIN  
Accessories  
Ex  
EMC-Ex  
Ex Accessories  
EXIOS



## Ex d METAL CABLE GLANDS

### HSK-M-Ex d / HSK-M-PVDF-Ex d

Metr.



|                       |   |
|-----------------------|---|
| Material              | Nickel plated brass   |
| Clamping insert       | Polyamide / PVDF  |
| Seal / O-Ring         | FKM   |
| Protection            | IP 68 – 10 bar / IP 69K (NEMA 6 – 150 PSIG)                                       |
| Operating Temperature | -60 °C – 105 °C (-76 °F – 221 °F) (PA)<br>-20 °C – 130 °C (-4 °F – 266 °F) (PVDF) |



II 2G 1D Ex d IIC

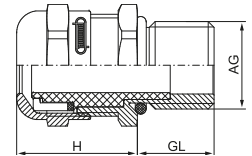

| AG         | $\varnothing$ mm | GL mm | H mm | $\varnothing$ mm | Number HSK-M-Ex d<br>-60 °C – 105 °C | Number HSK-M-PVDF-Ex d<br>-20 °C – 130 °C |
|------------|------------------|-------|------|------------------|--------------------------------------|---|
| M 12 x 1,5 | 3–6,5            | 16    | 18,7 | 14               | 1.622.1200.50                        | 1.634.1200.50                             |
| M 12 x 1,5 | 2–5              | 16    | 18,7 | 14               | 1.622.1200.51                        | 1.634.1200.51                             |
| M 16 x 1,5 | 5–10             | 16    | 22   | 20               | 1.622.1600.50                        | 1.634.1600.50                             |
| M 16 x 1,5 | 3–7              | 16    | 22   | 20               | 1.622.1600.51                        | 1.634.1600.51                             |
| M 20 x 1,5 | 10–14            | 16    | 25   | 24               | 1.622.2000.50                        | 1.634.2000.50                             |
| M 20 x 1,5 | 7–12             | 16    | 25   | 24               | 1.622.2000.51                        | 1.634.2000.51                             |
| M 25 x 1,5 | 13–18            | 16    | 26,5 | 30               | 1.622.2500.50                        | 1.634.2500.50                             |
| M 25 x 1,5 | 9–16             | 16    | 26,5 | 30               | 1.622.2500.51                        | 1.634.2500.51                             |
| M 32 x 1,5 | 18–25            | 16    | 32   | 40               | 1.622.3200.50                        | 1.634.3200.50                             |
| M 32 x 1,5 | 14–20            | 16    | 32   | 40               | 1.622.3200.51                        | 1.634.3200.51                             |
| M 40 x 1,5 | 22–32            | 16    | 38,5 | 50               | 1.622.4000.50                        | 1.634.4000.50                             |
| M 40 x 1,5 | 20–26            | 16    | 38,5 | 50               | 1.622.4000.51                        | 1.634.4000.51                             |

### HSK-M-Ex d / HSK-M-PVDF-Ex d

NPT



|                       |   |
|-----------------------|---|
| Material              | Nickel plated brass   |
| Clamping insert       | Polyamide / PVDF  |
| Seal                  | FKM   |
| Protection            | IP 68 – 10 bar / IP 69K (NEMA 6 – 150 PSIG)                                       |
| Operating Temperature | -60 °C – 105 °C (-76 °F – 221 °F) (PA)<br>-20 °C – 130 °C (-4 °F – 266 °F) (PVDF) |



II 2G 1D Ex d IIC

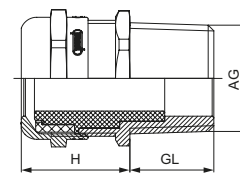

| AG         | $\varnothing$ mm | GL mm | H mm | $\varnothing$ mm | Number HSK-M-Ex d<br>-60 °C – 105 °C | Number HSK-M-PVDF-Ex d<br>-20 °C – 130 °C |
|------------|------------------|-------|------|------------------|--------------------------------------|---|
| NPT 3/8"   | 5–10             | 16    | 22   | 20               | 1.622.3800.70                        | 1.634.3800.70                             |
| NPT 3/8"   | 3–7              | 16    | 22   | 20               | 1.622.3800.71                        | 1.634.3800.71                             |
| NPT 1/2"   | 10–14            | 20    | 25   | 24               | 1.622.1200.70                        | 1.634.1200.70                             |
| NPT 1/2"   | 7–12             | 20    | 25   | 24               | 1.622.1200.71                        | 1.634.1200.71                             |
| NPT 3/4"   | 13–18            | 20,5  | 26,5 | 30               | 1.622.3400.70                        | 1.634.3400.70                             |
| NPT 3/4"   | 9–16             | 20,5  | 26,5 | 30               | 1.622.3400.71                        | 1.634.3400.71                             |
| NPT 1"     | 18–25            | 25    | 32   | 40               | 1.622.1000.70                        | 1.634.1000.70                             |
| NPT 1"     | 14–20            | 25    | 32   | 40               | 1.622.1000.71                        | 1.634.1000.71                             |
| NPT 1 1/4" | 22–32            | 26    | 38,5 | 50               | 1.622.5400.70                        | 1.634.5400.70                             |
| NPT 1 1/4" | 20–26            | 26    | 38,5 | 50               | 1.622.5400.71                        | 1.634.5400.71                             |
| NPT 1 1/2" | 22–32            | 26,5  | 38,5 | 50               | 1.622.6400.70                        | 1.634.6400.70                             |
| NPT 1 1/2" | 20–26            | 26,5  | 38,5 | 50               | 1.622.6400.71                        | 1.634.6400.71                             |



## HSK-MZ-Ex d

Metr.



|                       |   |
|-----------------------|---|
| Material              | Nickel plated brass                         |
| Clamping insert       | Polyamide                                   |
| Seal / O-Ring         | FKM   |
| Protection            | IP 68 – 10 bar / IP 69K (NEMA 6 – 150 PSIG) |
| Operating Temperature | -60 °C – 105 °C (-76 °F – 221 °F)           |

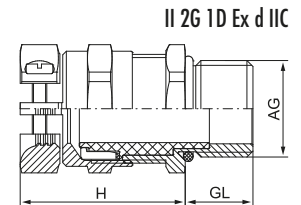

| AG         | $\varnothing$<br>mm | GL<br>mm | H<br>mm | $\varnothing$<br>mm | Number<br>HSK-MZ-Ex d<br>-60 °C – 105 °C |
|------------|---------------------|----------|---------|---------------------|--|
| M 12 x 1,5 | 3–6,5               | 16       | 26      | 14                  | 1.628.1200.50                            |
| M 16 x 1,5 | 5–10                | 16       | 30,2    | 20                  | 1.628.1600.50                            |
| M 20 x 1,5 | 10–14               | 16       | 34      | 24                  | 1.628.2000.50                            |
| M 25 x 1,5 | 13–18               | 16       | 37,8    | 30                  | 1.628.2500.50                            |
| M 32 x 1,5 | 18–25               | 16       | 44      | 40                  | 1.628.3200.50                            |
| M 40 x 1,5 | 22–32               | 16       | 51,5    | 50                  | 1.628.4000.50                            |

## HSK-MZ-Ex d

NPT



|                       |   |
|-----------------------|---|
| Material              | Nickel plated brass                         |
| Clamping insert       | Polyamide                                   |
| Seal                  | FKM   |
| Protection            | IP 68 – 10 bar / IP 69K (NEMA 6 – 150 PSIG) |
| Operating Temperature | -60 °C – 105 °C (-76 °F – 221 °F)           |

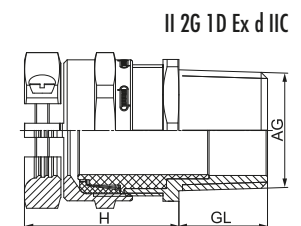

| AG         | $\varnothing$<br>mm | GL<br>mm | H<br>mm | $\varnothing$<br>mm | Number<br>HSK-MZ-Ex d<br>-60 °C – 105 °C |
|------------|---------------------|----------|---------|---------------------|--|
| NPT 3/8"   | 5–10                | 16       | 30      | 20                  | 1.628.3800.70                            |
| NPT 1/2"   | 10–14               | 20       | 33,6    | 24                  | 1.628.1200.70                            |
| NPT 3/4"   | 13–18               | 20,5     | 37,8    | 30                  | 1.628.3400.70                            |
| NPT 1"     | 18–25               | 25       | 44      | 40                  | 1.628.1000.70                            |
| NPT 1 1/4" | 22–32               | 26       | 51,5    | 50                  | 1.628.5400.70                            |
| NPT 1 1/2" | 22–32               | 26,5     | 51,5    | 50                  | 1.628.6400.70                            |

## Ex d METAL CABLE GLANDS

### HSK-INOX-Ex d / HSK-INOX-PVDF-Ex d

Metr.



|                       |   |
|-----------------------|---|
| Material              | INOX 1.4404   |
| Clamping insert       | Polyamide / PVDF  |
| Seal / O-Ring         | FKM   |
| Protection            | IP 68 – 10 bar / IP 69K (NEMA 6 – 150 PSIG)                                       |
| Operating Temperature | -60 °C – 105 °C (-76 °F – 221 °F) (PA)<br>-20 °C – 130 °C (-4 °F – 266 °F) (PVDF) |



II 2G 1D Ex d IIC

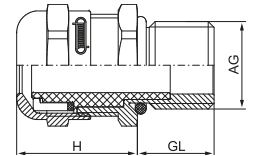

| AG         | $\varnothing$ mm | GL mm | H mm | $\varnothing$ mm | Number<br>HSK-INOX-Ex d<br>-60 °C – 105 °C | Number<br>HSK-INOX-PVDF-Ex d<br>-20 °C – 130 °C |
|------------|------------------|-------|------|------------------|--|---|
| M 12 x 1,5 | 3–6,5            | 16    | 19   | 14               | 1.632.1200.50                              | 1.633.1200.50                                   |
| M 12 x 1,5 | 2–5              | 16    | 19   | 14               | 1.632.1200.51                              | 1.633.1200.51                                   |
| M 16 x 1,5 | 5–10             | 16    | 22   | 20               | 1.632.1600.50                              | 1.633.1600.50                                   |
| M 16 x 1,5 | 3–7              | 16    | 22   | 20               | 1.632.1600.51                              | 1.633.1600.51                                   |
| M 20 x 1,5 | 10–14            | 16    | 25   | 24               | 1.632.2000.50                              | 1.633.2000.50                                   |
| M 20 x 1,5 | 7–12             | 16    | 25   | 24               | 1.632.2000.51                              | 1.633.2000.51                                   |
| M 25 x 1,5 | 13–18            | 16    | 26,5 | 30               | 1.632.2500.50                              | 1.633.2500.50                                   |
| M 25 x 1,5 | 9–16             | 16    | 26,5 | 30               | 1.632.2500.51                              | 1.633.2500.51                                   |
| M 32 x 1,5 | 18–25            | 16    | 32   | 40               | 1.632.3200.50                              | 1.633.3200.50                                   |
| M 32 x 1,5 | 14–20            | 16    | 32   | 40               | 1.632.3200.51                              | 1.633.3200.51                                   |
| M 40 x 1,5 | 22–32            | 16    | 38,5 | 50               | 1.632.4000.50                              | 1.633.4000.50                                   |
| M 40 x 1,5 | 20–26            | 16    | 38,5 | 50               | 1.632.4000.51                              | 1.633.4000.51                                   |

### HSK-INOX-Ex d / HSK-INOX-PVDF-Ex d

NPT



|                       |   |
|-----------------------|---|
| Material              | INOX 1.4404   |
| Clamping insert       | Polyamide / PVDF  |
| Seal                  | FKM   |
| Protection            | IP 68 – 10 bar / IP 69K (NEMA 6 – 150 PSIG)                                       |
| Operating Temperature | -60 °C – 105 °C (-76 °F – 221 °F) (PA)<br>-20 °C – 130 °C (-4 °F – 266 °F) (PVDF) |



II 2G 1D Ex d IIC

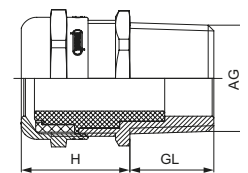

| AG       | $\varnothing$ mm | GL mm | H mm | $\varnothing$ mm | Number<br>HSK-INOX-Ex d<br>-60 °C – 105 °C | Number<br>HSK-INOX-PVDF-Ex d<br>-20 °C – 130 °C |
|----------|------------------|-------|------|------------------|--|---|
| NPT 3/8" | 5–10             | 16    | 22   | 20               | 1.632.3800.70                              | 1.633.3800.70                                   |
| NPT 3/8" | 3–7              | 16    | 22   | 20               | 1.632.3800.71                              | 1.633.3800.71                                   |
| NPT 1/2" | 10–14            | 20    | 25   | 24               | 1.632.1200.70                              | 1.633.1200.70                                   |
| NPT 1/2" | 7–12             | 20    | 25   | 24               | 1.632.1200.71                              | 1.633.1200.71                                   |
| NPT 3/4" | 13–18            | 20,5  | 26,5 | 30               | 1.632.3400.70                              | 1.633.3400.70                                   |
| NPT 3/4" | 9–16             | 20,5  | 26,5 | 30               | 1.632.3400.71                              | 1.633.3400.71                                   |

# EMC-Ex e CABLE GLANDS



Safe EMC protection plus explosion area approval: This is what EMC Ex e cable glands deliver. HUMMEL also offers a range of designs for particular requirements here too. These include cable glands for high-temperature applications, designs for very easy fitting and also stainless steel versions.

**In this chapter, you will find:**

- // HSK-M-EMC-Ex: Cable glands with excellent shielding properties
- // HSK-M-EMC-D-Ex: Fast, easy fitting, combined with maximum EMC protection
- // HSK-M-PVDF-EMC-Ex: High-temperature cable glands with EMC connection and explosion protection
- // HSK-INOX-EMC-Ex: Stainless steel cable glands
- // HSK-MZ-EMC-Ex: Glands with a high level of tension-relief, EMC and explosion protection

HUMMEL has many years of experience in handling components for explosion-protection areas. This is why we have a sophisticated range of explosion area products in a range of materials and designs.

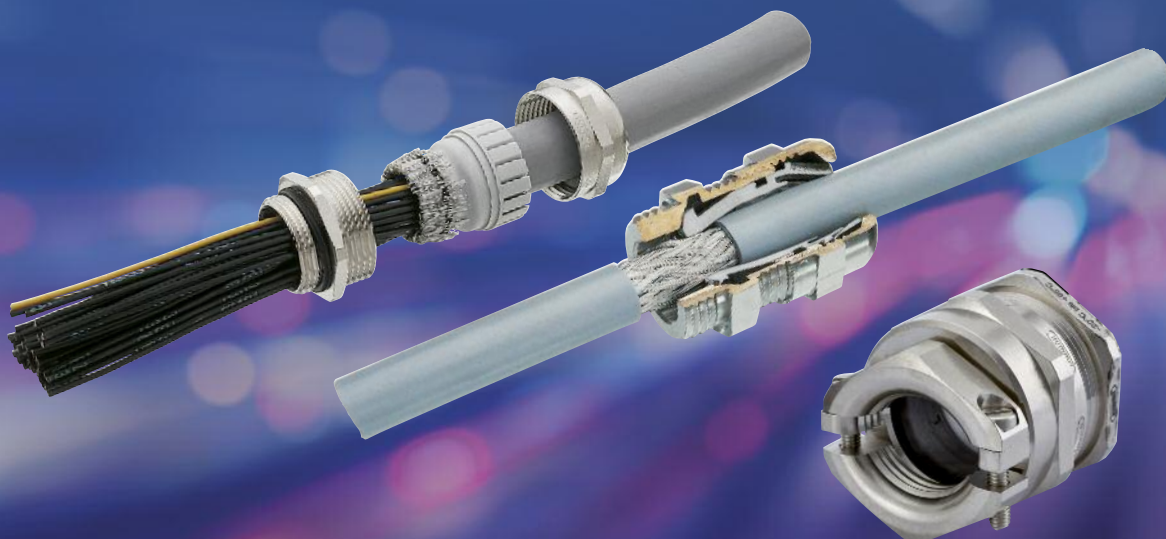

# EMC-Ex e CABLE GLANDS

## HSK-M-EMC-D-Ex Metr.



// With pre-assembled dust disc upon request

|                       |   |
|-----------------------|---|
| Material              | Nickel plated brass   |
| Clamping insert       | Metallized Polyamide  |
| Seal / O-Ring         | Buna-N  |
| Protection            | IP 68 – 10 bar / IP 69K (NEMA 6 – 150 PSIG)                         |
| Operating Temperature | -20 °C – 95 °C (-4 °F – 203 °F)<br>-60 °C – 95 °C (-76 °F – 203 °F) |

| AG         | $\varnothing$ mm | GL mm | H mm | $\varnothing$ mm | Number HSK-M-EMC-D-Ex -20 °C – 95 °C | Number HSK-M-EMC-D-Ex -60 °C – 95 °C |
|------------|------------------|-------|------|------------------|--------------------------------------|--------------------------------------|
| M 16 x 1,5 | 5–10             | 6     | 29   | 20               | 1.636.1600.50                        | 1.637.1600.50                        |
| M 20 x 1,5 | 10–14            | 6     | 31   | 24               | 1.636.2000.50                        | 1.637.2000.50                        |
| M 25 x 1,5 | 13–18            | 7     | 38   | 30               | 1.636.2500.50                        | 1.637.2500.50                        |
| M 32 x 1,5 | 18–25            | 8     | 43   | 40               | 1.636.3200.50                        | 1.637.3200.50                        |
| M 40 x 1,5 | 24–32            | 8     | 51   | 50               | 1.636.4000.50                        | 1.637.4000.50                        |

## HSK-M-EMC-D-Ex Metr.-elongated



// With pre-assembled dust disc upon request

|                       |   |
|-----------------------|---|
| Material              | Nickel plated brass   |
| Clamping insert       | Metallized Polyamide  |
| Seal / O-Ring         | Buna-N  |
| Protection            | IP 68 – 10 bar / IP 69K (NEMA 6 – 150 PSIG)                         |
| Operating Temperature | -20 °C – 95 °C (-4 °F – 203 °F)<br>-60 °C – 95 °C (-76 °F – 203 °F) |

| AG         | $\varnothing$ mm | GL mm | H mm | $\varnothing$ mm | Number HSK-M-EMC-D-Ex -20 °C – 95 °C | Number HSK-M-EMC-D-Ex -60 °C – 95 °C |
|------------|------------------|-------|------|------------------|--------------------------------------|--------------------------------------|
| M 16 x 1,5 | 5–10             | 10    | 29   | 20               | 1.636.1600.30                        | 1.637.1600.30                        |
| M 20 x 1,5 | 10–14            | 10    | 31   | 24               | 1.636.2000.30                        | 1.637.2000.30                        |
| M 25 x 1,5 | 13–18            | 12    | 38   | 30               | 1.636.2500.30                        | 1.637.2500.30                        |
| M 32 x 1,5 | 18–25            | 12    | 43   | 40               | 1.636.3200.30                        | 1.637.3200.30                        |
| M 40 x 1,5 | 24–32            | 15    | 51   | 50               | 1.636.4000.30                        | 1.637.4000.30                        |

## HSK-M-EMC-D-Ex

PG



|                       |   |
|-----------------------|---|
| Material              | Nickel plated brass   |
| Clamping insert       | Metallized Polyamide  |
| Seal                  | Buna-N  |
| O-Ring                | NBR   |
| Protection            | IP 68 – 10 bar / IP 69K (NEMA 6 – 150 PSIG)                         |
| Operating Temperature | -20 °C – 95 °C (-4 °F – 203 °F)<br>-60 °C – 95 °C (-76 °F – 203 °F) |

// With pre-assembled dust disc upon request

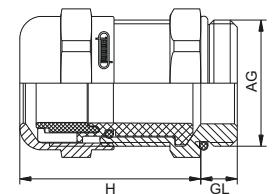

| AG      | $\varnothing$ mm | GL mm | H mm | $\varnothing$ mm | Number<br>HSK-M-EMC-D-Ex<br>-20 °C – 95 °C | Number<br>HSK-M-EMC-D-Ex<br>-60 °C – 95 °C |
|---------|------------------|-------|------|------------------|--|--|
| PG 11   | 5–10             | 6     | 29   | 20               | 1.636.1100.01                              | 1.637.1100.01                              |
| PG 13,5 | 7–12             | 6,5   | 31   | 22               | 1.636.1300.01                              | 1.637.1300.01                              |
| PG 16   | 10–14            | 6,5   | 32   | 24               | 1.636.1600.01                              | 1.637.1600.01                              |
| PG 21   | 13–18            | 7     | 38   | 30               | 1.636.2100.01                              | 1.637.2100.01                              |
| PG 29   | 18–25            | 8     | 43   | 40               | 1.636.2900.01                              | 1.637.2900.01                              |
| PG 36   | 22–32            | 8     | 48   | 50               | 1.636.3600.01                              | 1.637.3600.01                              |

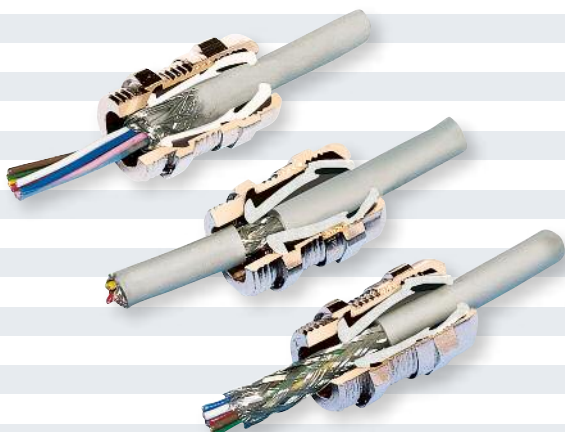

# EMC-Ex e CABLE GLANDS

## HSK-M-EMC-Ex Metr.



|                       |   |
|-----------------------|---|
| Material              | Nickel plated brass   |
| Clamping insert       | Polyamide   |
| Seal                  | Buna-N  |
| O-Ring                | Buna-N  |
| Protection            | IP 68 – 10 bar / IP 69K (NEMA 6 – 150 PSIG)                         |
| Operating Temperature | -20 °C – 95 °C (-4 °F – 203 °F)<br>-60 °C – 95 °C (-76 °F – 203 °F) |

// With pre-assembled dust disc upon request

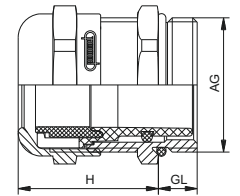

| AG         | $\varnothing$ mm | GL mm | H mm | $\varnothing$ mm | Number<br>HSK-M-EMC-Ex<br>-20 °C – 95 °C | Number<br>HSK-M-EMC-Ex<br>-60 °C – 95 °C |
|------------|------------------|-------|------|------------------|--|--|
| M 12 x 1,5 | 3–6,5            | 6,5   | 19   | 14               | 1.616.1200.50                            | 1.646.1200.50                            |
| M 12 x 1,5 | 2–5              | 6,5   | 19   | 14               | 1.616.1200.51                            | 1.646.1200.51                            |
| M 16 x 1,5 | 6–10             | 6     | 22   | 20               | 1.616.1600.50                            | 1.646.1600.50                            |
| M 16 x 1,5 | 3–7              | 6     | 22   | 20               | 1.616.1600.51                            | 1.646.1600.51                            |
| M 20 x 1,5 | 10–14            | 6     | 23   | 24               | 1.616.2000.50                            | 1.646.2000.50                            |
| M 20 x 1,5 | 7–12             | 6     | 23   | 24               | 1.616.2000.51                            | 1.646.2000.51                            |
| M 25 x 1,5 | 14–18            | 7     | 24   | 30               | 1.616.2500.50                            | 1.646.2500.50                            |
| M 25 x 1,5 | 10–16            | 7     | 24   | 30               | 1.616.2500.51                            | 1.646.2500.51                            |
| M 32 x 1,5 | 20–25            | 8     | 31   | 40               | 1.616.3200.50                            | 1.646.3200.50                            |
| M 32 x 1,5 | 13–20            | 8     | 31   | 40               | 1.616.3200.51                            | 1.646.3200.51                            |
| M 40 x 1,5 | 22–32            | 8     | 37   | 50               | 1.616.4000.50                            | 1.646.4000.50                            |
| M 40 x 1,5 | 20–26            | 8     | 37   | 50               | 1.616.4000.51                            | 1.646.4000.51                            |
| M 50 x 1,5 | 32–38            | 9     | 37   | 57               | 1.616.5000.50                            | 1.646.5000.50                            |
| M 50 x 1,5 | 25–31            | 9     | 37   | 57               | 1.616.5000.51                            | 1.646.5000.51                            |
| M 63 x 1,5 | 37–44            | 10    | 38   | 64/68            | 1.616.6300.50                            | 1.646.6300.50                            |
| M 63 x 1,5 | 29–35            | 10    | 38   | 64/68            | 1.616.6300.51                            | 1.646.6300.51                            |

## HSK-M-EMC-Ex / HSK-M-EMC-PVDF-Ex

PG, NPT



|                       |   |
|-----------------------|---|
| Material              | Nickel plated brass   |
| Clamping insert       | Polyamide / PVDF  |
| Seal                  | Buna-N / FKM  |
| O-Ring                | Buna-N / FKM  |
| Protection            | IP 68 – 10 bar / IP 69K (NEMA 6 – 150 PSIG)   |
| Operating Temperature | -20 °C – 95 °C (-4 °F – 203 °F)<br>-60 °C – 95 °C (-76 °F – 203 °F) / -20 °C – 130 °C (-4 °F – 266 °F) (PVDF) |

// With pre-assembled dust disc upon request

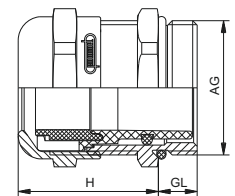

| AG       | $\varnothing$ mm | GL mm | H mm | $\varnothing$ mm | Number<br>HSK-M-EMC-Ex<br>-20 °C – 95 °C | Number<br>HSK-M-EMC-Ex<br>-60 °C – 95 °C | Number<br>HSK-M-PVDF-EMC-Ex<br>-20 °C – 130 °C |
|----------|------------------|-------|------|------------------|--|--|--|
| PG 7     | 3–6,5            | 5     | 19   | 14               | 1.616.0700.01                            | 1.646.0700.01                            | 1.666.0700.01                                  |
| PG 7     | 2–5              | 5     | 19   | 14               | 1.616.0700.15                            | 1.646.0700.15                            | 1.666.0700.15                                  |
| PG 9     | 4–8              | 6     | 21   | 17               | 1.616.0900.01                            | 1.646.0900.01                            | 1.666.0900.01                                  |
| PG 9     | 2–6              | 6     | 21   | 17               | 1.616.0900.15                            | 1.646.0900.15                            | 1.666.0900.15                                  |
| PG 11    | 6–10             | 6     | 22   | 20               | 1.616.1100.01                            | 1.646.1100.01                            | 1.666.1100.01                                  |
| PG 11    | 3–7              | 6     | 22   | 20               | 1.616.1100.15                            | 1.646.1100.15                            | 1.666.1100.15                                  |
| PG 13,5  | 7–12             | 6,5   | 24   | 22               | 1.616.1300.01                            | 1.646.1300.01                            | 1.666.1300.01                                  |
| PG 13,5  | 5–9              | 6,5   | 24   | 22               | 1.616.1300.15                            | 1.646.1300.15                            | 1.666.1300.15                                  |
| PG 16    | 10–14            | 6,5   | 23   | 24               | 1.616.1600.01                            | 1.646.1600.01                            | 1.666.1600.01                                  |
| PG 16    | 7–12             | 6,5   | 23   | 24               | 1.616.1600.15                            | 1.646.1600.15                            | 1.666.1600.15                                  |
| PG 21    | 14–18            | 7     | 24   | 30               | 1.616.2100.01                            | 1.646.2100.01                            | 1.666.2100.01                                  |
| PG 21    | 10–16            | 7     | 24   | 30               | 1.616.2100.15                            | 1.646.2100.15                            | 1.666.2100.15                                  |
| PG 29    | 20–25            | 8     | 29   | 40               | 1.616.2900.01                            | 1.646.2900.01                            | 1.666.2900.01                                  |
| PG 29    | 13–20            | 8     | 29   | 40               | 1.616.2900.15                            | 1.646.2900.15                            | 1.666.2900.15                                  |
| PG 36    | 22–32            | 8     | 35   | 50               | 1.616.3600.01                            | 1.646.3600.01                            | 1.666.3600.01                                  |
| PG 36    | 20–26            | 8     | 35   | 50               | 1.616.3600.15                            | 1.646.3600.15                            | 1.666.3600.15                                  |
| PG 42    | 32–38            | 9     | 37   | 57               | 1.616.4200.01                            | 1.646.4200.01                            | 1.666.4200.01                                  |
| PG 42    | 25–31            | 9     | 37   | 57               | 1.616.4200.15                            | 1.646.4200.15                            | 1.666.4200.15                                  |
| PG 48    | 37–44            | 10    | 38   | 64               | 1.616.4800.01                            | 1.646.4800.01                            | 1.666.4800.01                                  |
| PG 48    | 29–35            | 10    | 38   | 64               | 1.616.4800.15                            | 1.646.4800.15                            | 1.666.4800.15                                  |
| NPT 3/8" | 4–8              | 15    | 21   | 17/19            | 1.616.3800.70                            | 1.646.3800.70                            | 1.666.3800.70                                  |
| NPT 3/8" | 2–6              | 15    | 21   | 17/19            | 1.616.3800.71                            | 1.646.3800.71                            | 1.666.3800.71                                  |
| NPT 1/2" | 7–12             | 13    | 24   | 22/24            | 1.616.1200.70                            | 1.646.1200.70                            | 1.666.1200.70                                  |
| NPT 1/2" | 5–9              | 13    | 24   | 22/24            | 1.616.1200.71                            | 1.646.1200.71                            | 1.666.1200.71                                  |
| NPT 3/4" | 14–18            | 13    | 25   | 30               | 1.616.3400.70                            | 1.646.3400.70                            | 1.666.3400.70                                  |
| NPT 3/4" | 10–16            | 13    | 25   | 30               | 1.616.3400.71                            | 1.646.3400.71                            | 1.666.3400.71                                  |



# EMC-Ex e CABLE GLANDS

## HSK-MZ-EMC-Ex Metr.



|                       |   |
|-----------------------|---|
| Material              | Nickel plated brass   |
| Clamping insert       | Polyamide   |
| Seal                  | Buna-N  |
| O-Ring                | Buna-N  |
| Protection            | IP 68 – 10 bar / IP 69K (NEMA 6 – 150 PSIG)                         |
| Operating Temperature | -20 °C – 95 °C (-4 °F – 203 °F)<br>-60 °C – 95 °C (-76 °F – 203 °F) |

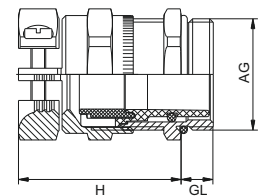

| AG         | $\varnothing$<br>mm | GL<br>mm | H<br>mm | <br>mm | Number<br>HSK-M-EMC-Ex<br>-20 °C – 95 °C | Number<br>HSK-M-EMC-Ex<br>-60 °C – 95 °C |
|------------|---------------------|----------|---------|--------|--|--|
| M 12 x 1,5 | 3–6,5               | 6,5      | 26      | 14     | 1.617.1200.50                            | 1.647.1200.50                            |
| M 16 x 1,5 | 6–10                | 6        | 29      | 20     | 1.617.1600.50                            | 1.647.1600.50                            |
| M 20 x 1,5 | 10–14               | 6        | 32      | 24     | 1.617.2000.50                            | 1.647.2000.50                            |
| M 25 x 1,5 | 14–18               | 7        | 35      | 30     | 1.617.2500.50                            | 1.647.2500.50                            |
| M 32 x 1,5 | 20–25               | 8        | 41      | 40     | 1.617.3200.50                            | 1.647.3200.50                            |
| M 40 x 1,5 | 24–32               | 8        | 48      | 50     | 1.617.4000.50                            | 1.647.4000.50                            |
| M 50 x 1,5 | 32–38               | 9        | 51      | 57     | 1.617.5000.50                            | 1.647.5000.50                            |
| M 50 x 1,5 | 28–31               | 9        | 51      | 57     | 1.617.5000.51                            | 1.647.5000.51                            |
| M 63 x 1,5 | 37–44               | 10       | 52      | 68     | 1.617.6300.50                            | 1.647.6300.50                            |
| M 63 x 1,5 | 32–35               | 10       | 52      | 68     | 1.617.6300.51                            | 1.647.6300.51                            |







|                       |   |
|-----------------------|---|
| Material              | INOX 1.4305                                 |
| Clamping insert       | Polyamide                                   |
| Seal                  | Buna-N                                      |
| O-Ring                | Buna-N                                      |
| Protection            | IP 68 – 10 bar / IP 69K (NEMA 6 – 150 PSIG) |
| Operating Temperature | -60 °C – 95 °C (-76 °F – 203 °F)            |

// With pre-assembled dust disc upon request

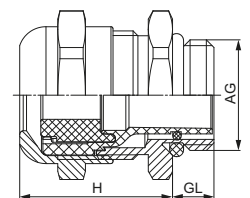

| AG         | $\text{Øk}$<br>mm | GL<br>mm | H<br>mm | $\text{Ø}$<br>mm | Number        |
|------------|-------------------|----------|---------|------------------|---------------|
| M 12 x 1,5 | 3–6,5             | 6,5      | 19      | 14               | 1.673.1200.50 |
| M 12 x 1,5 | 2–5               | 6,5      | 19      | 14               | 1.673.1200.51 |
| M 16 x 1,5 | 5–10              | 6        | 21      | 20               | 1.673.1600.50 |
| M 16 x 1,5 | 3–7               | 6        | 21      | 20               | 1.673.1600.51 |
| M 20 x 1,5 | 10–14             | 6        | 23      | 24               | 1.673.2000.50 |
| M 20 x 1,5 | 7–12              | 6        | 23      | 24               | 1.673.2000.51 |
| M 25 x 1,5 | 13–18             | 7        | 26      | 30               | 1.673.2500.50 |
| M 25 x 1,5 | 9–16              | 7        | 26      | 30               | 1.673.2500.51 |
| M 32 x 1,5 | 18–25             | 8        | 31      | 41               | 1.673.3200.50 |
| M 32 x 1,5 | 13–20             | 8        | 31      | 41               | 1.673.3200.51 |
| M 40 x 1,5 | 22–32             | 8        | 37      | 50               | 1.673.4000.50 |
| M 40 x 1,5 | 20–26             | 8        | 37      | 50               | 1.673.4000.51 |
| PG 7       | 3–6,5             | 5        | 19      | 14               | 1.673.0700.01 |
| PG 7       | 2–5               | 5        | 19      | 14               | 1.673.0700.15 |
| PG 9       | 4–8               | 6        | 21      | 17               | 1.673.0900.01 |
| PG 9       | 2–6               | 6        | 21      | 17               | 1.673.0900.15 |
| PG 11      | 5–10              | 6        | 22      | 22               | 1.673.1100.01 |
| PG 11      | 3–7               | 6        | 22      | 22               | 1.673.1100.15 |
| PG 13,5    | 7–12              | 6,5      | 24      | 22               | 1.673.1300.01 |
| PG 13,5    | 5–9               | 6,5      | 24      | 22               | 1.673.1300.15 |
| PG 16      | 10–14             | 6,5      | 23      | 24               | 1.673.1600.01 |
| PG 16      | 7–12              | 6,5      | 23      | 24               | 1.673.1600.15 |
| PG 21      | 13–18             | 7        | 24      | 30               | 1.673.2100.01 |
| PG 21      | 9–16              | 7        | 24      | 30               | 1.673.2100.15 |
| PG 29      | 18–25             | 8        | 29      | 41               | 1.673.2900.01 |
| PG 29      | 13–20             | 8        | 29      | 41               | 1.673.2900.15 |
| PG 36      | 22–32             | 8        | 35      | 50               | 1.673.3600.01 |
| PG 36      | 20–26             | 8        | 35      | 50               | 1.673.3600.15 |

# Ex ACCESSORIES



Cable glands for explosion protection areas also demand accessories specifically designed for those areas. HUMMEL has a wide range of accessories specially developed for this sector. These accessories meet all the requirements for ex-areas and are backed up by all the necessary certification and approvals.

*In this chapter, you will find:*

- // Accessories in plastic, brass and stainless steel
- // Plugs with explosion area approval
- // Reduction fittings in a wide range of different sizes

The accessories come in a range of materials, sizes and thread types.



## Plug V-Ex Metr.



|                       |   |
|-----------------------|---|
| Material              | Polyamide, fiber reinforced                 |
| O-Ring                | Buna-N                                      |
| Protection            | IP 68 – 10 bar / IP 69K (NEMA 6 – 150 PSIG) |
| Operating Temperature | -20 °C – 95 °C (-4 °F – 203 °F)             |
| Colors                | black (RAL 9005)                            |

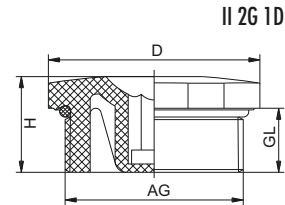

| AG         | GL<br>mm | H<br>mm | D<br>mm |    |   | Number        |
|------------|----------|---------|---------|----|---|---------------|
| M 12 x 1,5 | 8,5      | 13      | 16,5    | 15 | 6 | 1.297.1201.50 |
| M 16 x 1,5 | 8,5      | 13      | 20,5    | 19 | 8 | 1.297.1601.50 |
| M 20 x 1,5 | 9        | 14,5    | 25,5    | 24 | 8 | 1.297.2001.50 |
| M 25 x 1,5 | 10,5     | 16      | 30,5    | 28 | 8 | 1.297.2501.50 |
| M 32 x 1,5 | 11,5     | 17,5    | 38      | 36 | 8 | 1.297.3201.50 |
| M 40 x 1,5 | 11,5     | 18      | 48      | 46 | 8 | 1.297.4001.50 |
| M 50 x 1,5 | 13,5     | 20      | 60      | 55 | 8 | 1.297.5001.50 |
| M 63 x 1,5 | 14,5     | 21      | 75      | 70 | 8 | 1.297.6301.50 |

## Plug V-Ex PG



|                       |   |
|-----------------------|---|
| Material              | Polyamide, fiber reinforced                 |
| O-Ring                | Buna-N                                      |
| Protection            | IP 68 – 10 bar / IP 69K (NEMA 6 – 150 PSIG) |
| Operating Temperature | -20 °C – 95 °C (-4 °F – 203 °F)             |
| Colors                | black (RAL 9005)                            |

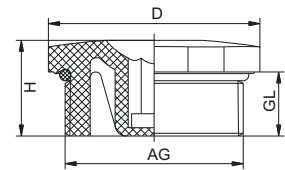

| AG      | GL<br>mm | H<br>mm | D<br>mm |    |   | Number        |
|---------|----------|---------|---------|----|---|---------------|
| PG 7    | 8,5      | 13      | 16,5    | 15 | 6 | 1.297.0701.11 |
| PG 9    | 8,5      | 13      | 20,5    | 19 | 8 | 1.297.0901.11 |
| PG 11   | 9        | 14,5    | 25,5    | 24 | 8 | 1.297.1101.11 |
| PG 13,5 | 9        | 14,5    | 25,5    | 24 | 8 | 1.297.1301.11 |
| PG 16   | 10,5     | 16      | 30,5    | 28 | 8 | 1.297.1601.11 |
| PG 21   | 11,5     | 17,5    | 38      | 36 | 8 | 1.297.2101.11 |
| PG 29   | 11,5     | 18      | 48      | 46 | 8 | 1.297.2901.11 |
| PG 36   | 13,5     | 20      | 60      | 55 | 8 | 1.297.3601.11 |
| PG 42   | 13,5     | 20      | 65      | 60 | 8 | 1.297.4201.11 |
| PG 48   | 14,5     | 21      | 75      | 70 | 8 | 1.297.4801.11 |

## Plug HSK-V-Ex

Metr., PG, NPT



|                       |                                  |
|-----------------------|----------------------------------|
| Material              | Elastomer                        |
| Operating Temperature | -40 °C – 95 °C (-40 °F – 203 °F) |
| Colors                | black (RAL 9005)                 |

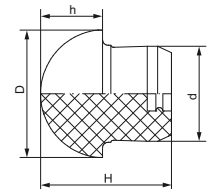

| Fits the following sizes |            |                   | D<br>mm | d<br>mm | H<br>mm | h<br>mm | Number        |
|--------------------------|------------|-------------------|---------|---------|---------|---------|---------------|
| PG 7                     | M 12 x 1,5 |                   | 9,5     | 6,3     | 11,5    | 4,5     | 1.296.0701.11 |
| PG 9                     | M 16 x 1,5 | NPT 3/8"          | 11      | 7,8     | 13,5    | 5,5     | 1.296.0901.11 |
| PG 11                    | M 16 x 1,5 |                   | 13,5    | 9,8     | 14,5    | 5,5     | 1.296.1101.11 |
| PG 13,5                  | M 20 x 1,5 | NPT 1/2"          | 16      | 11,8    | 18      | 8       | 1.296.1301.11 |
| PG 16                    | M 20 x 1,5 | NPT 1/2"/16       | 18,5    | 13,8    | 19      | 9       | 1.296.1601.11 |
| PG 21                    | M 25 x 1,5 | NPT 3/4"          | 22      | 17,8    | 22      | 11      | 1.296.2101.11 |
| PG 29                    | M 32 x 1,5 | NPT 1" NPT 1 1/4" | 29      | 25      | 25      | 10      | 1.296.2901.11 |
| PG 36                    | M 40 x 1,5 | NPT 1 1/2"        | 38      | 32      | 28      | 11      | 1.296.3601.11 |
| PG 42                    | M 50 x 1,5 |                   | 43      | 38      | 30      | 12      | 1.296.4201.11 |
| PG 48                    | M 63 x 1,5 |                   | 49      | 44      | 30      | 12      | 1.296.4801.11 |

## Plug HSK-V-Ex MZ version

Metr., PG, NPT



|                       |                                  |
|-----------------------|----------------------------------|
| Material              | Elastomer                        |
| Operating Temperature | -40 °C – 95 °C (-40 °F – 203 °F) |
| Colors                | black (RAL 9005)                 |

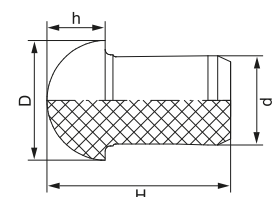

// This plug is suitable in all HSK glands with additional strain relief

| Fits the following sizes |            |                   | D<br>mm | d<br>mm | H<br>mm | h<br>mm | Number        |
|--------------------------|------------|-------------------|---------|---------|---------|---------|---------------|
| PG 7                     | M 12 x 1,5 |                   | 9,5     | 6,3     | 18      | 4,5     | 1.296.0701.61 |
| PG 9                     | M 16 x 1,5 | NPT 3/8"          | 11      | 7,8     | 20,5    | 5,5     | 1.296.0901.61 |
| PG 11                    | M 16 x 1,5 |                   | 13,5    | 9,8     | 22      | 5,5     | 1.296.1101.61 |
| PG 13,5                  | M 20 x 1,5 | NPT 1/2"          | 16      | 11,8    | 26,5    | 8       | 1.296.1301.61 |
| PG 16                    | M 20 x 1,5 | NPT 1/2"/16       | 18,5    | 13,8    | 28,4    | 9       | 1.296.1601.61 |
| PG 21                    | M 25 x 1,5 | NPT 3/4"          | 22      | 17,8    | 32      | 11      | 1.296.2101.61 |
| PG 29                    | M 32 x 1,5 | NPT 1" NPT 1 1/4" | 29      | 25      | 35,5    | 10      | 1.296.2901.61 |
| PG 36                    | M 40 x 1,5 | NPT 1 1/2"        | 38      | 32      | 39      | 11      | 1.296.3601.61 |

# Ex ACCESSORIES

## Plug V-Ms-Ex / V-Ms-FKM-Ex / V-Ms-VMQ-Ex

Metr.



|                       |  |
|-----------------------|--|
| Material              | Nickel plated brass  |
| Protection            | IP 68 – 10 bar / IP 69K (NEMA 6 – 150 PSIG)  |
| V-Ms-Ex O-Ring        | Buna-N   |
| V-Ms-FKM-Ex O-Ring    | FKM  |
| V-Ms-VMQ-Ex O-Ring    | VMQ  |
| Operating Temperature | -20 °C – 95 °C (-4 °F – 203 °F) (Buna-N)<br>-20 °C – 180 °C (-4 °F – 356 °F) (FKM) / -60 °C – 180 °C (-76 °F – 356 °F) (VMQ) |



II 2G 1D

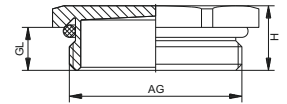

| AG         | GL<br>mm | H<br>mm |    | Number<br>V-Ms-Ex<br>-20 °C – 95 °C | Number<br>V-Ms-FKM-Ex<br>-20 °C – 180 °C | Number<br>V-Ms-VMQ-Ex<br>-60 °C – 180 °C |
|------------|----------|---------|----|-------------------------------------|--|--|
| M 12 x 1,5 | 6,5      | 9,5     | 14 | 1.197.1200.50                       | 1.198.1200.50                            | 1.199.1200.50                            |
| M 16 x 1,5 | 6        | 9       | 19 | 1.197.1600.50                       | 1.198.1600.50                            | 1.199.1600.50                            |
| M 20 x 1,5 | 6        | 9,5     | 22 | 1.197.2000.50                       | 1.198.2000.50                            | 1.199.2000.50                            |
| M 25 x 1,5 | 7        | 10,5    | 30 | 1.197.2500.50                       | 1.198.2500.50                            | 1.199.2500.50                            |
| M 32 x 1,5 | 8        | 12,5    | 41 | 1.197.3200.50                       | 1.198.3200.50                            | 1.199.3200.50                            |
| M 40 x 1,5 | 8        | 13      | 46 | 1.197.4000.50                       | 1.198.4000.50                            | 1.199.4000.50                            |
| M 50 x 1,5 | 9        | 15      | 55 | 1.197.5000.50                       | 1.198.5000.50                            | 1.199.5000.50                            |
| M 63 x 1,5 | 10       | 16,5    | 70 | 1.197.6300.50                       | 1.198.6300.50                            | 1.199.6300.50                            |

## Plug V-Ms-Ex / V-Ms-FKM-Ex / V-Ms-VMQ-Ex

PG



|                       |  |
|-----------------------|--|
| Material              | Nickel plated brass  |
| Protection            | IP 68 – 10 bar / IP 69K (NEMA 6 – 150 PSIG)  |
| V-Ms-Ex O-Ring        | Buna-N   |
| V-Ms-FKM-Ex O-Ring    | FKM  |
| V-Ms-VMQ-Ex O-Ring    | VMQ  |
| Operating Temperature | -20 °C – 95 °C (-4 °F – 203 °F) (Buna-N)<br>-20 °C – 180 °C (-4 °F – 356 °F) (FKM) / -60 °C – 180 °C (-76 °F – 356 °F) (VMQ) |



II 2G 1D

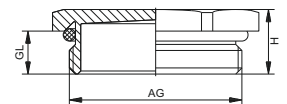

| AG      | GL<br>mm | H<br>mm |    | Number<br>V-Ms-Ex<br>-20 °C – 95 °C | Number<br>V-Ms-FKM-Ex<br>-20 °C – 180 °C | Number<br>V-Ms-VMQ-Ex<br>-60 °C – 180 °C |
|---------|----------|---------|----|-------------------------------------|--|--|
| PG 7    | 5        | 8       | 14 | 1.197.0700.01                       | 1.198.0700.01                            | 1.199.0700.01                            |
| PG 9    | 6        | 9       | 17 | 1.197.0900.01                       | 1.198.0900.01                            | 1.199.0900.01                            |
| PG 11   | 6        | 9,5     | 20 | 1.197.1100.01                       | 1.198.1100.01                            | 1.199.1100.01                            |
| PG 13,5 | 6,5      | 10      | 22 | 1.197.1300.01                       | 1.198.1300.01                            | 1.199.1300.01                            |
| PG 16   | 6,5      | 10      | 24 | 1.197.1600.01                       | 1.198.1600.01                            | 1.199.1600.01                            |
| PG 21   | 7        | 10,5    | 30 | 1.197.2100.01                       | 1.198.2100.01                            | 1.199.2100.01                            |
| PG 29   | 8        | 12,5    | 41 | 1.197.2900.01                       | 1.198.2900.01                            | 1.199.2900.01                            |
| PG 36   | 8        | 13      | 50 | 1.197.3600.01                       | 1.198.3600.01                            | 1.199.3600.01                            |
| PG 42   | 9        | 15      | 58 | 1.197.4200.01                       | 1.198.4200.01                            | 1.199.4200.01                            |
| PG 48   | 10       | 16,5    | 65 | 1.197.4800.01                       | 1.198.4800.01                            | 1.199.4800.01                            |

## Adapter RSD-MS-Ex

Metr.



|                       |   |
|-----------------------|---|
| Material              | Nickel plated brass   |
| O-Ring                | Buna-N / VMQ  |
| Protection            | IP 68 – 10 bar / IP 69K (NEMA 6 – 150 PSIG)   |
| Operating Temperature | -20 °C – 95 °C (-4 °F – 203 °F) (Buna-N)<br>-60 °C – 180 °C (-76 °F – 356 °F) (VMQ) |

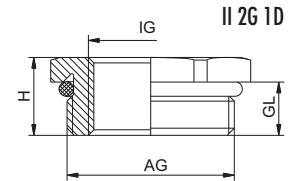

| AG         | IG         | GL<br>mm |    | Number<br>NBR<br>-20 °C – 95 °C | Number<br>VMQ<br>-60 °C – 180 °C |
|------------|------------|----------|----|---------------------------------|----------------------------------|
| M 16 x 1,5 | M 12 x 1,5 | 5        | 17 | 1.078.1612.50                   | 1.079.1612.50                    |
| M 20 x 1,5 | M 12 x 1,5 | 6        | 22 | 1.078.2012.50                   | 1.079.2012.50                    |
| M 20 x 1,5 | M 16 x 1,5 | 6        | 22 | 1.078.2016.50                   | 1.079.2016.50                    |
| M 25 x 1,5 | M 16 x 1,5 | 7        | 29 | 1.078.2516.50                   | 1.079.2516.50                    |
| M 25 x 1,5 | M 20 x 1,5 | 7        | 29 | 1.078.2520.50                   | 1.079.2520.50                    |
| M 32 x 1,5 | M 16 x 1,5 | 8        | 34 | 1.078.3216.50                   | 1.079.3216.50                    |
| M 32 x 1,5 | M 20 x 1,5 | 8        | 34 | 1.078.3220.50                   | 1.079.3220.50                    |
| M 32 x 1,5 | M 25 x 1,5 | 8        | 34 | 1.078.3225.50                   | 1.079.3225.50                    |
| M 40 x 1,5 | M 20 x 1,5 | 8        | 43 | 1.078.4020.50                   | 1.079.4020.50                    |
| M 40 x 1,5 | M 25 x 1,5 | 8        | 43 | 1.078.4025.50                   | 1.079.4025.50                    |
| M 40 x 1,5 | M 32 x 1,5 | 8        | 43 | 1.078.4032.50                   | 1.079.4032.50                    |
| M 50 x 1,5 | M 25 x 1,5 | 9        | 55 | 1.078.5025.50                   | 1.079.5025.50                    |

| AG         | IG         | GL<br>mm |    | Number<br>NBR<br>-20 °C – 95 °C | Number<br>VMQ<br>-60 °C – 180 °C |
|------------|------------|----------|----|---------------------------------|----------------------------------|
| M 50 x 1,5 | M 32 x 1,5 | 9        | 55 | 1.078.5032.50                   | 1.079.5032.50                    |
| M 50 x 1,5 | M 40 x 1,5 | 9        | 55 | 1.078.5040.50                   | 1.079.5040.50                    |
| M 63 x 1,5 | M 32 x 1,5 | 10       | 65 | 1.078.6332.50                   | 1.079.6332.50                    |
| M 63 x 1,5 | M 40 x 1,5 | 10       | 65 | 1.078.6340.50                   | 1.079.6340.50                    |
| M 63 x 1,5 | M 50 x 1,5 | 10       | 65 | 1.078.6350.50                   | 1.079.6350.50                    |

## Adapter RSD-MS-Ex

PG



|                       |   |
|-----------------------|---|
| Material              | Nickel plated brass   |
| O-Ring                | Buna-N / VMQ  |
| Protection            | IP 68 – 10 bar / IP 69K (NEMA 6 – 150 PSIG)   |
| Operating Temperature | -20 °C – 95 °C (-4 °F – 203 °F) (Buna-N)<br>-60 °C – 180 °C (-76 °F – 356 °F) (VMQ) |

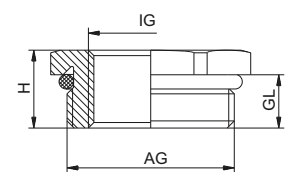

| AG      | IG      | GL<br>mm | H<br>mm |    | Number<br>NBR<br>-20 °C – 95 °C | Number<br>VMQ<br>-60 °C – 180 °C |
|---------|---------|----------|---------|----|---------------------------------|----------------------------------|
| PG 9    | PG 7    | 6        | 8,8     | 17 | 1.078.0907.01                   | 1.079.0907.01                    |
| PG 11   | PG 7    | 6        | 9       | 20 | 1.078.1107.01                   | 1.079.1107.01                    |
| PG 11   | PG 9    | 6        | 9       | 20 | 1.078.1109.01                   | 1.079.1109.01                    |
| PG 13,5 | PG 9    | 6,5      | 9,5     | 22 | 1.078.1309.01                   | 1.079.1309.01                    |
| PG 16   | PG 9    | 6,5      | 9,5     | 24 | 1.078.1609.01                   | 1.079.1609.01                    |
| PG 16   | PG 11   | 6,5      | 9,5     | 24 | 1.078.1611.01                   | 1.079.1611.01                    |
| PG 16   | PG 13,5 | 6,5      | 9,5     | 24 | 1.078.1613.01                   | 1.079.1613.01                    |
| PG 21   | PG 11   | 7        | 10,3    | 30 | 1.078.2111.01                   | 1.079.2111.01                    |
| PG 21   | PG 13,5 | 7        | 10,3    | 30 | 1.078.2113.01                   | 1.079.2113.01                    |
| PG 21   | PG 16   | 7        | 10,3    | 30 | 1.078.2116.01                   | 1.079.2116.01                    |
| PG 29   | PG 16   | 8        | 11,5    | 40 | 1.078.2916.01                   | 1.079.2916.01                    |
| PG 29   | PG 21   | 8        | 11,5    | 40 | 1.078.2921.01                   | 1.079.2921.01                    |

| AG    | IG    | GL<br>mm | H<br>mm |    | Number<br>NBR<br>-20 °C – 95 °C | Number<br>VMQ<br>-60 °C – 180 °C |
|-------|-------|----------|---------|----|---------------------------------|----------------------------------|
| PG 36 | PG 21 | 9        | 12,5    | 50 | 1.078.3621.01                   | 1.079.3621.01                    |
| PG 36 | PG 29 | 9        | 12,5    | 50 | 1.078.3629.01                   | 1.079.3629.01                    |
| PG 42 | PG 29 | 10       | 13,5    | 57 | 1.078.4229.01                   | 1.079.4229.01                    |
| PG 42 | PG 36 | 10       | 13,5    | 57 | 1.078.4236.01                   | 1.079.4236.01                    |
| PG 48 | PG 36 | 10       | 13,5    | 64 | 1.078.4836.01                   | 1.079.4836.01                    |
| PG 48 | PG 42 | 10       | 13,5    | 64 | 1.078.4842.01                   | 1.079.4842.01                    |

## Plug V-Ms-Ex d

Metr., NPT



|                       |  |
|-----------------------|--|
| Material              | Nickel plated brass  |
| O-Ring                | Buna-N /FKM /VMQ   |
| Protection            | IP 68 – 10 bar /IP 69K (NEMA 6 – 150 PSIG)   |
| Operating Temperature | -20 °C – 95 °C (-4 °F – 203 °F) (Buna-N)<br>-20 °C – 180 °C (-4 °F – 356 °F) (FKM) / -60 °C – 180 °C (-76 °F – 356 °F) (VMQ) |



II 2G 1D

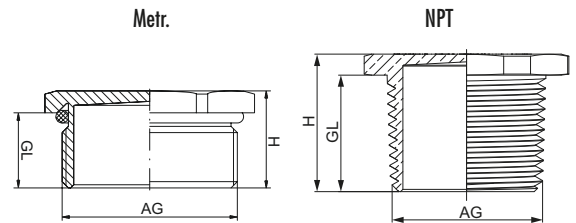

| AG         | GL<br>mm | H<br>mm |    | Number<br>without O-Ring | Number<br>Buna-N<br>-20 °C – 95 °C | Number<br>FKM<br>-20 °C – 180 °C | Number<br>VMQ<br>-60 °C – 180 °C |
|------------|----------|---------|----|--------------------------|------------------------------------|----------------------------------|----------------------------------|
| M 12 x 1,5 | 16       | 21      | 14 |                          | 1.875.1200.50                      | 1.876.1200.50                    | 1.877.1200.50                    |
| M 16 x 1,5 | 16       | 20      | 19 |                          | 1.875.1600.50                      | 1.876.1600.50                    | 1.877.1600.50                    |
| M 20 x 1,5 | 16       | 19,5    | 22 |                          | 1.875.2000.50                      | 1.876.2000.50                    | 1.877.2000.50                    |
| M 25 x 1,5 | 16       | 19,5    | 30 |                          | 1.875.2500.50                      | 1.876.2500.50                    | 1.877.2500.50                    |
| M 32 x 1,5 | 16       | 20,5    | 41 |                          | 1.875.3200.50                      | 1.876.3200.50                    | 1.877.3200.50                    |
| M 40 x 1,5 | 16       | 21      | 46 |                          | 1.875.4000.50                      | 1.876.4000.50                    | 1.877.4000.50                    |
| M 50 x 1,5 | 16       | 22      | 55 |                          | 1.875.5000.50                      | 1.876.5000.50                    | 1.877.5000.50                    |
| M 63 x 1,5 | 16       | 22,5    | 70 |                          | 1.875.6300.50                      | 1.876.6300.50                    | 1.877.6300.50                    |
| NPT 3/8"   | 16       | 20      | 16 | 1.877.3800.70            |                                    |                                  |                                  |
| NPT 1/2"   | 20       | 23,5    | 24 | 1.877.1200.70            |                                    |                                  |                                  |
| NPT 3/4"   | 20,5     | 24      | 30 | 1.877.3400.70            |                                    |                                  |                                  |
| NPT 1"     | 25       | 29,5    | 41 | 1.877.1000.70            |                                    |                                  |                                  |
| NPT 1 1/4" | 26       | 31      | 46 | 1.877.5400.70            |                                    |                                  |                                  |
| NPT 1 1/2" | 26,5     | 32,5    | 55 | 1.877.6400.70            |                                    |                                  |                                  |



## Adapter RSD-MS-Ex d

Metr.

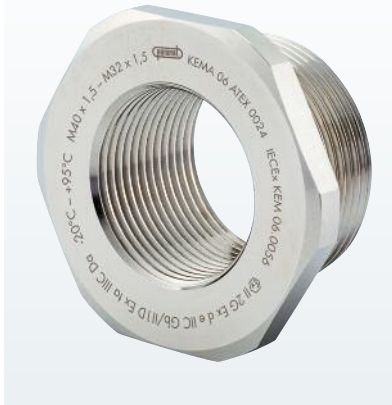

|                       |   |
|-----------------------|---|
| Material              | Nickel plated brass   |
| O-Ring                | Buna-N / FKM  |
| Protection            | IP 68 – 10 bar / IP 69K (NEMA 6 – 150 PSIG)   |
| Operating Temperature | -20 °C – 95 °C (-4 °F – 203 °F) (Buna-N)<br>-60 °C – 180 °C (-76 °F – 356 °F) (VMQ) |



II 2G 1D Ex d IIC

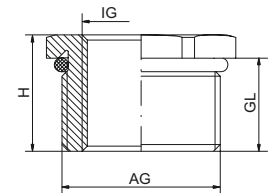

| AG         | IG         | GL<br>mm | H<br>mm | mm | Number<br>Buna-N<br>-20 °C – 95 °C | Number<br>VMQ<br>-60 °C – 180 °C |
|------------|------------|----------|---------|----|------------------------------------|----------------------------------|
| M 16 x 1,5 | M 12 x 1,5 | 16       | 19      | 19 | 1.878.1612.50                      | 1.879.1612.50                    |
| M 20 x 1,5 | M 12 x 1,5 | 16       | 19,5    | 22 | 1.878.2012.50                      | 1.879.2012.50                    |
| M 20 x 1,5 | M 16 x 1,5 | 16       | 19,5    | 22 | 1.878.2016.50                      | 1.879.2016.50                    |
| M 25 x 1,5 | M 16 x 1,5 | 16       | 19,5    | 30 | 1.878.2516.50                      | 1.879.2516.50                    |
| M 25 x 1,5 | M 20 x 1,5 | 16       | 19,5    | 30 | 1.878.2520.50                      | 1.879.2520.50                    |
| M 32 x 1,5 | M 16 x 1,5 | 16       | 20,5    | 41 | 1.878.3216.50                      | 1.879.3216.50                    |
| M 32 x 1,5 | M 20 x 1,5 | 16       | 20,5    | 41 | 1.878.3220.50                      | 1.879.3220.50                    |
| M 32 x 1,5 | M 25 x 1,5 | 16       | 20,5    | 41 | 1.878.3225.50                      | 1.879.3225.50                    |
| M 40 x 1,5 | M 20 x 1,5 | 16       | 21      | 46 | 1.878.4020.50                      | 1.879.4020.50                    |
| M 40 x 1,5 | M 25 x 1,5 | 16       | 21      | 46 | 1.878.4025.50                      | 1.879.4025.50                    |
| M 40 x 1,5 | M 32 x 1,5 | 16       | 21      | 46 | 1.878.4032.50                      | 1.879.4032.50                    |
| M 50 x 1,5 | M 25 x 1,5 | 16       | 21      | 55 | 1.878.5025.50                      | 1.879.5025.50                    |
| M 50 x 1,5 | M 32 x 1,5 | 16       | 21      | 55 | 1.878.5032.50                      | 1.879.5032.50                    |

Plastic

Metal

EMC

Special applications, DIN

Accessories

Ex

EMC-Ex

Ex Accessories

EXIOS

# Ex ACCESSORIES

## Plug V-INOX-Ex Metr.



|                       |  |
|-----------------------|--|
| Material              | INOX 1.4305  |
| Protection            | IP 68 – 10 bar / IP 69K (NEMA 6 – 150 PSIG)  |
| V-INOX-Ex O-Ring      | Buna-N   |
| V-INOX-FKM-Ex O-Ring  | FKM  |
| V-INOX-VMQ-Ex O-Ring  | VMQ  |
| Operating Temperature | -20 °C – 95 °C (-4 °F – 203 °F) (Buna-N)<br>-20 °C – 180 °C (-4 °F – 356 °F) (FKM) / -60 °C – 180 °C (-76 °F – 356 °F) (VMQ) |



II 2G 1D

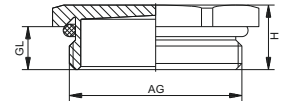

| AG         | GL<br>mm | H<br>mm | ⌀<br>mm | Number<br>V-INOX-Ex<br>-20 °C – 95 °C | Number<br>V-INOX-FKM-Ex<br>-20 °C – 180 °C | Number<br>V-INOX-VMQ-Ex<br>-60 °C – 180 °C |
|------------|----------|---------|---------|---------------------------------------|--|--|
| M 12 x 1,5 | 6,5      | 9,5     | 14      | 1.192.1200.50                         | 1.193.1200.50                              | 1.194.1200.50                              |
| M 16 x 1,5 | 6        | 9       | 19      | 1.192.1600.50                         | 1.193.1600.50                              | 1.194.1600.50                              |
| M 20 x 1,5 | 6        | 9,5     | 22      | 1.192.2000.50                         | 1.193.2000.50                              | 1.194.2000.50                              |
| M 25 x 1,5 | 7        | 10,5    | 30      | 1.192.2500.50                         | 1.193.2500.50                              | 1.194.2500.50                              |
| M 32 x 1,5 | 8        | 12,5    | 41      | 1.192.3200.50                         | 1.193.3200.50                              | 1.194.3200.50                              |
| M 40 x 1,5 | 8        | 13      | 46      | 1.192.4000.50                         | 1.193.4000.50                              | 1.194.4000.50                              |
| M 50 x 1,5 | 9        | 15      | 55      | 1.192.5000.50                         | 1.193.5000.50                              | 1.194.5000.50                              |
| M 63 x 1,5 | 10       | 16,5    | 70      | 1.192.6300.50                         | 1.193.6300.50                              | 1.194.6300.50                              |

## Plug V-INOX-Ex PG



|                       |  |
|-----------------------|--|
| Material              | INOX 1.4305  |
| Protection            | IP 68 – 10 bar / IP 69K (NEMA 6 – 150 PSIG)  |
| V-INOX-Ex O-Ring      | Buna-N   |
| V-INOX-FKM-Ex O-Ring  | FKM  |
| V-INOX-VMQ-Ex O-Ring  | VMQ  |
| Operating Temperature | -20 °C – 95 °C (-4 °F – 203 °F) (Buna-N)<br>-20 °C – 180 °C (-4 °F – 356 °F) (FKM) / -60 °C – 180 °C (-76 °F – 356 °F) (VMQ) |



II 2G 1D

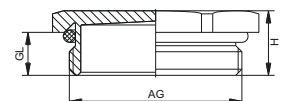

| AG      | GL<br>mm | H<br>mm | ⌀<br>mm | Number<br>V-INOX-Ex<br>-20 °C – 95 °C | Number<br>V-INOX-FKM-Ex<br>-20 °C – 180 °C | Number<br>V-INOX-VMQ-Ex<br>-60 °C – 180 °C |
|---------|----------|---------|---------|---------------------------------------|--|--|
| PG 7    | 5        | 8       | 14      | 1.192.0700.01                         | 1.193.0700.01                              | 1.194.0700.01                              |
| PG 9    | 6        | 9       | 17      | 1.192.0900.01                         | 1.193.0900.01                              | 1.194.0900.01                              |
| PG 11   | 6        | 9,5     | 20      | 1.192.1100.01                         | 1.193.1100.01                              | 1.194.1100.01                              |
| PG 13,5 | 6,5      | 10      | 22      | 1.192.1300.01                         | 1.193.1300.01                              | 1.194.1300.01                              |
| PG 16   | 6,5      | 10      | 24      | 1.192.1600.01                         | 1.193.1600.01                              | 1.194.1600.01                              |
| PG 21   | 7        | 10,5    | 30      | 1.192.2100.01                         | 1.193.2100.01                              | 1.194.2100.01                              |
| PG 29   | 8        | 12,5    | 41      | 1.192.2900.01                         | 1.193.2900.01                              | 1.194.2900.01                              |
| PG 36   | 8        | 13      | 50      | 1.192.3600.01                         | 1.193.3600.01                              | 1.194.3600.01                              |
| PG 42   | 9        | 15      | 58      | 1.192.4200.01                         | 1.193.4200.01                              | 1.194.4200.01                              |
| PG 48   | 10       | 16,5    | 65      | 1.192.4800.01                         | 1.193.4800.01                              | 1.194.4800.01                              |

## Plug RSD-INOX-Ex

Metr.

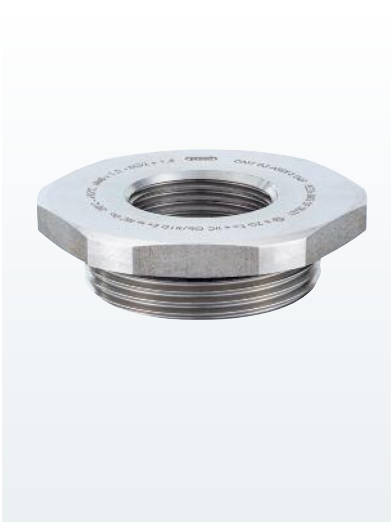

|                       |   |
|-----------------------|---|
| Material              | INOX 1.4305   |
| O-Ring                | Buna-N / VMQ  |
| Protection            | IP 68 – 10 bar / IP 69K (NEMA 6 – 150 PSIG)   |
| Operating Temperature | -20 °C – 95 °C (-4 °F – 203 °F) (Buna-N)<br>-60 °C – 180 °C (-76 °F – 356 °F) (VMQ) |

ATEX Ex

II 2G 1D

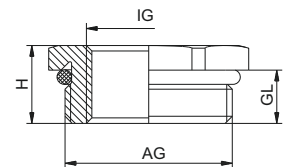

| AG         | IG         | GL<br>mm |    | Number                   |                        |
|------------|------------|----------|----|--------------------------|------------------------|
|            |            |          |    | Buna-N<br>-20 °C – 95 °C | VMQ<br>-60 °C – 180 °C |
| M 16 x 1,5 | M 12 x 1,5 | 5        | 19 | 1.098.1612.50            | 1.099.1612.50          |
| M 20 x 1,5 | M 12 x 1,5 | 6        | 22 | 1.098.2012.50            | 1.099.2012.50          |
| M 20 x 1,5 | M 16 x 1,5 | 6        | 22 | 1.098.2016.50            | 1.099.2016.50          |
| M 25 x 1,5 | M 16 x 1,5 | 7        | 30 | 1.098.2516.50            | 1.099.2516.50          |
| M 25 x 1,5 | M 20 x 1,5 | 7        | 30 | 1.098.2520.50            | 1.099.2520.50          |
| M 32 x 1,5 | M 16 x 1,5 | 8        | 41 | 1.098.3216.50            | 1.099.3216.50          |
| M 32 x 1,5 | M 20 x 1,5 | 8        | 41 | 1.098.3220.50            | 1.099.3220.50          |
| M 32 x 1,5 | M 25 x 1,5 | 8        | 41 | 1.098.3225.50            | 1.099.3225.50          |
| M 40 x 1,5 | M 20 x 1,5 | 8        | 46 | 1.098.4020.50            | 1.099.4020.50          |
| M 40 x 1,5 | M 25 x 1,5 | 8        | 46 | 1.098.4025.50            | 1.099.4025.50          |
| M 40 x 1,5 | M 32 x 1,5 | 8        | 46 | 1.098.4032.50            | 1.099.4032.50          |
| M 50 x 1,5 | M 25 x 1,5 | 9        | 55 | 1.098.5025.50            | 1.099.5025.50          |
| M 50 x 1,5 | M 32 x 1,5 | 9        | 55 | 1.098.5032.50            | 1.099.5032.50          |
| M 63 x 1,5 | M 32 x 1,5 | 10       | 65 | 1.098.6332.50            | 1.099.6332.50          |
| M 63 x 1,5 | M 50 x 1,5 | 10       | 65 | 1.098.6350.50            | 1.099.6350.50          |

Plastic

Metal

EMC

Special applications, DIN

Accessories

Ex

EMC-Ex

Ex Accessories

EXIOS

## Plug RSD-INOX-Ex

PG



|                       |   |
|-----------------------|---|
| Material              | INOX 1.4305   |
| O-Ring                | Buna-N / VMQ  |
| Protection            | IP 68 – 10 bar / IP 69K (NEMA 6 – 150 PSIG)   |
| Operating Temperature | -20 °C – 95 °C (-4 °F – 203 °F) (Buna-N)<br>-60 °C – 180 °C (-76 °F – 356 °F) (VMQ) |

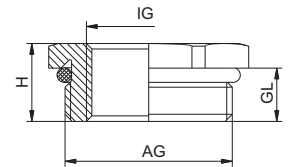

| AG      | IG      | GL<br>mm | H<br>mm | ⌀<br>mm | Number<br>Buna-N<br>-20 °C – 95 °C | Number<br>VMQ<br>-60 °C – 180 °C |
|---------|---------|----------|---------|---------|------------------------------------|----------------------------------|
| PG 9    | PG 7    | 6        | 8,8     | 17      | 1.098.0907.01                      | 1.099.0907.01                    |
| PG 11   | PG 7    | 6        | 9       | 20      | 1.098.1107.01                      | 1.099.1107.01                    |
| PG 11   | PG 9    | 6        | 9       | 20      | 1.098.1109.01                      | 1.099.1109.01                    |
| PG 13,5 | PG 9    | 6,5      | 9,5     | 22      | 1.098.1309.01                      | 1.099.1309.01                    |
| PG 13,5 | PG 11   | 6,5      | 9,5     | 22      | 1.098.1311.01                      | 1.099.1311.01                    |
| PG 16   | PG 9    | 6,5      | 9,5     | 24      | 1.098.1609.01                      | 1.099.1609.01                    |
| PG 16   | PG 11   | 6,5      | 9,5     | 24      | 1.098.1611.01                      | 1.099.1611.01                    |
| PG 16   | PG 13,5 | 6,5      | 9,5     | 24      | 1.098.1613.01                      | 1.099.1613.01                    |
| PG 21   | PG 11   | 7        | 10,3    | 30      | 1.098.2111.01                      | 1.099.2111.01                    |
| PG 21   | PG 13,5 | 7        | 10,3    | 30      | 1.098.2113.01                      | 1.099.2113.01                    |
| PG 21   | PG 16   | 7        | 10,3    | 30      | 1.098.2116.01                      | 1.099.2116.01                    |
| PG 29   | PG 16   | 8        | 11,5    | 40      | 1.098.2916.01                      | 1.099.2916.01                    |
| PG 29   | PG 21   | 8        | 11,5    | 40      | 1.098.2921.01                      | 1.099.2921.01                    |
| PG 36   | PG 21   | 9        | 12,5    | 50      | 1.098.3621.01                      | 1.099.3621.01                    |
| PG 36   | PG 29   | 9        | 12,5    | 50      | 1.098.3629.01                      | 1.099.3629.01                    |
| PG 42   | PG 29   | 10       | 13,5    | 57      | 1.098.4229.01                      | 1.099.4229.01                    |
| PG 42   | PG 36   | 10       | 13,5    | 57      | 1.098.4236.01                      | 1.099.4236.01                    |
| PG 48   | PG 36   | 10       | 13,5    | 64      | 1.098.4836.01                      | 1.099.4836.01                    |
| PG 48   | PG 42   | 10       | 13,5    | 64      | 1.098.4842.01                      | 1.099.4842.01                    |

## Plug V-INOX-Ex d

Metr., NPT



|                       |  |
|-----------------------|--|
| Material              | INOX 1.4404  |
| O-Ring                | Buna-N /FKM /VMQ   |
| Protection            | IP 68 – 10 bar /IP 69K (NEMA 6 – 150 PSIG)   |
| Operating Temperature | -20 °C – 95 °C (-4 °F – 203 °F) (Buna-N)<br>-20 °C – 180 °C (-4 °F – 356 °F) (FKM) / -60 °C – 180 °C (-76 °F – 356 °F) (VMQ) |



II 2G 1D Ex d IIC

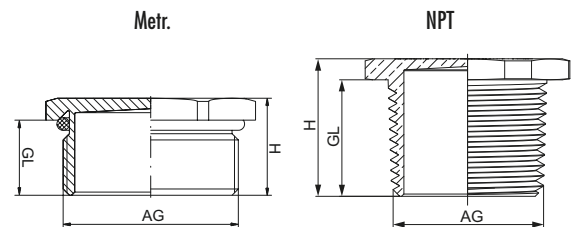

| AG         | GL<br>mm | H<br>mm |    | Number<br>without O-Ring<br>self sealing | Number<br>Buna-N<br>-20 °C – 95 °C | Number<br>FKM<br>-20 °C – 180 °C | Number<br>VMQ<br>-60 °C – 180 °C |
|------------|----------|---------|----|--|------------------------------------|----------------------------------|----------------------------------|
| M 12 x 1,5 | 16       | 19      | 14 |  | 1.895.1200.50                      | 1.896.1200.50                    | 1.897.1200.50                    |
| M 16 x 1,5 | 16       | 19      | 19 |  | 1.895.1600.50                      | 1.896.1600.50                    | 1.897.1600.50                    |
| M 20 x 1,5 | 16       | 19,5    | 22 |  | 1.895.2000.50                      | 1.896.2000.50                    | 1.897.2000.50                    |
| M 25 x 1,5 | 16       | 19,5    | 30 |  | 1.895.2500.50                      | 1.896.2500.50                    | 1.897.2500.50                    |
| M 32 x 1,5 | 16       | 20,5    | 41 |  | 1.895.3200.50                      | 1.896.3200.50                    | 1.897.3200.50                    |
| M 40 x 1,5 | 16       | 21      | 46 |  | 1.895.4000.50                      | 1.896.4000.50                    | 1.897.4000.50                    |
| M 50 x 1,5 | 16       | 22      | 55 |  | 1.895.5000.50                      | 1.896.5000.50                    | 1.897.5000.50                    |
| M 63 x 1,5 | 16       | 22,5    | 70 |  | 1.895.6300.50                      | 1.896.6300.50                    | 1.897.6300.50                    |
| NPT 3/8"   | 16       | 20      | 19 | 1.897.3800.70                            |                                    |                                  |                                  |
| NPT 1/2"   | 20       | 23,5    | 24 | 1.897.1200.70                            |                                    |                                  |                                  |
| NPT 3/4"   | 20,5     | 24      | 30 | 1.897.3400.70                            |                                    |                                  |                                  |
| NPT 1"     | 25       | 29,5    | 41 | 1.897.1000.70                            |                                    |                                  |                                  |
| NPT 1 1/4" | 26       | 31      | 46 | 1.897.5400.70                            |                                    |                                  |                                  |
| NPT 1 1/2" | 26,5     | 32,5    | 55 | 1.897.6400.70                            |                                    |                                  |                                  |

## Adapter RSD-INOX-Ex d Metr.

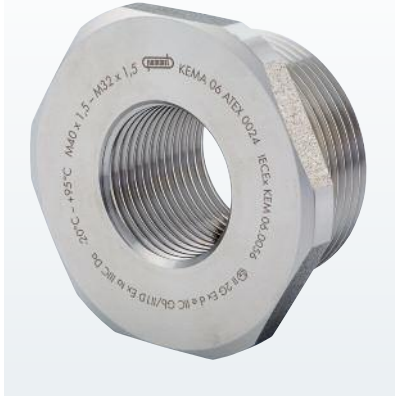

|                       |   |
|-----------------------|---|
| Material              | INOX 1.4404   |
| O-Ring                | Buna-N / FKM  |
| Protection            | IP 68 – 10 bar / IP 69K (NEMA 6 – 150 PSIG)   |
| Operating Temperature | -20 °C – 95 °C (-4 °F – 203 °F) (Buna-N)<br>-60 °C – 180 °C (-76 °F – 356 °F) (VMQ) |



II 2G 1D Ex d IIC

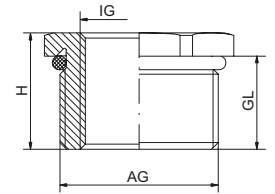

| AG         | IG         | GL<br>mm | H<br>mm | <br>mm | Number<br>Buna-N<br>-20 °C – 95 °C | Number<br>VMQ<br>-60 °C – 180 °C |
|------------|------------|----------|---------|--------|------------------------------------|----------------------------------|
| M 16 x 1,5 | M 12 x 1,5 | 16       | 19      | 19     | 1.898.1612.50                      | 1.899.1612.50                    |
| M 20 x 1,5 | M 12 x 1,5 | 16       | 19,5    | 22     | 1.898.2012.50                      | 1.899.2012.50                    |
| M 20 x 1,5 | M 16 x 1,5 | 16       | 19,5    | 22     | 1.898.2016.50                      | 1.899.2016.50                    |
| M 25 x 1,5 | M 16 x 1,5 | 16       | 19,5    | 30     | 1.898.2516.50                      | 1.899.2516.50                    |
| M 25 x 1,5 | M 20 x 1,5 | 16       | 19,5    | 30     | 1.898.2520.50                      | 1.899.2520.50                    |
| M 32 x 1,5 | M 16 x 1,5 | 16       | 20,5    | 41     | 1.898.3216.50                      | 1.899.3216.50                    |
| M 32 x 1,5 | M 20 x 1,5 | 16       | 20,5    | 41     | 1.898.3220.50                      | 1.899.3220.50                    |
| M 32 x 1,5 | M 25 x 1,5 | 16       | 20,5    | 41     | 1.898.3225.50                      | 1.899.3225.50                    |
| M 40 x 1,5 | M 20 x 1,5 | 16       | 21      | 46     | 1.898.4020.50                      | 1.899.4020.50                    |
| M 40 x 1,5 | M 25 x 1,5 | 16       | 21      | 46     | 1.898.4025.50                      | 1.899.4025.50                    |
| M 40 x 1,5 | M 32 x 1,5 | 16       | 21      | 46     | 1.898.4032.50                      | 1.899.4032.50                    |

## X-ON Electronics

Largest Supplier of Electrical and Electronic Components

*Click to view similar products for [Cable Glands, Strain Reliefs & Cord Grips](#) category:*

*Click to view products by [Hummel](#) manufacturer:*

Other Similar products are found below :

[120-116-1-1-20BP](#) [120-116-1-1-32BE](#) [120-117-40](#) [120-123-14](#) [120-123-16](#) [120-125-16](#) [120-125-16R](#) [120-125-16Y](#) [120-125-24Y](#) [120-125-28](#) [120-125-28R](#) [120-125-32](#) [120-125-32R](#) [120-125-40](#) [120-125-56](#) [120-126-14](#) [120-126-16](#) [120-126-20](#) [120-126-20BL](#) [120-126-20R](#) [120-126-24](#) [120-126-28](#) [120-126-32](#) [120-126-40BL](#) [120-116-1-1-06BP-509](#) [120-116-1-1-06CP](#) [120-116-1-1-16BE](#) [120-116-1-1-28BP](#) [120-123-20](#) [120-123-24](#) [120-123-32](#) [120-125-20](#) [120-125-20Y](#) [120-125-24](#) [120-125-24R](#) [120-125-28Y](#) [120-126-14BL](#) [120-126-16R](#) [120-126-16Y](#) [120-126-24BL](#) [120-126-28BL](#) [120-126-32BL](#) [120-126-40](#) [120-126-48](#) [120-126-48BL](#) [1300980012](#) [1300980105](#) [DBZM-6828](#) [1498](#) [15190-103 R2](#)