

规格 Specifications

| | | |
|----------------------------|--------------------------|---------------|
| 额定负荷 Rating | DC 12V/50mA | |
| 接触电阻 Contact Resistance | 100mΩ max. | |
| 绝缘电阻 Insulation resistance | DC100V 60S 100MΩ min. | |
| 抗电强度 Dielectric strength | AC250V(50~60HZ) 60S min. | |
| 操作力 Operation force | 160±30gf | 250±50gf |
| 寿命试验 Operating Life | 100,000 cycles | 70,000 cycles |
| 行程 Travels | 0.25±0.1mm | |

RECOMMENDED P.C.B. LAYOUT

安装尺寸图

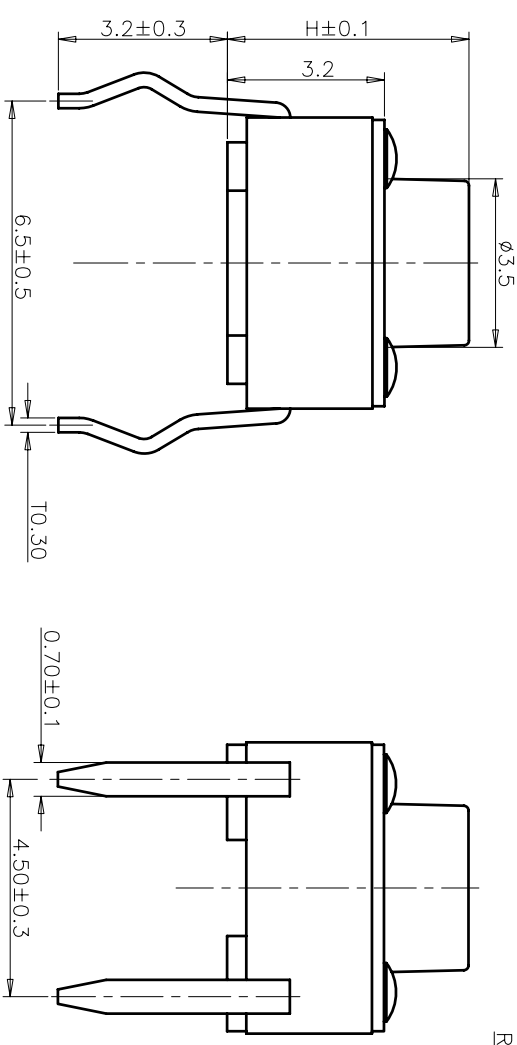

PRODUCT NO.: 1TS005A*****-CT

- 轻触开关
- 系列
- 外形:
- 按钮颜色:
- 底座颜色:
- 盖板颜色:
- 初始颜色, 则不启用
- 操作力度:
- 120=120gf
- 160=160gf
- 250=250gf
- 手感:
- 0=常规(弹片)
- 材质:
- 0=初始材质
- 1=新增材质
- 依次增加
- 产品高度(H):
- 430=4.3mm
- 700=7.0mm
- 编织
- 非编织, 不启用

| ITEM | PART NAME | QUANTITY | MATERIAL | FINISH |
|------|-----------|----------|--------------------|-----------|
| 5 | COVER | 1 | Stainless Steel | NATURAL |
| 4 | ACTUATOR | 1 | PPA | BLACK |
| 3 | DOVE | 1 | Phosphor Bronze/Ag | Ag-PLATED |
| 2 | TERMINAL | 1 | BRASS | Ag-PLATED |
| 1 | HOUSING | 1 | PPA | BLACK |

| X. ± | 0.3 | X' ± | 3' | UNITS | MM |
|--------|------|---------|------|--------|----|
| .X ± | 0.2 | .X' ± | 2' | MAT'L | |
| .XX ± | 0.1 | .XX' ± | 1' | FINISH | |
| .XXX ± | 0.05 | .XXX' ± | 0.5' | | |

THESE DRAWINGS AND SPECIFICATIONS ARE THE PROPERTY OF HON YUAN PRECISION IND. CO., LTD. AND SHALL NOT BE REPRODUCED, COPIED OR USED IN ANY MANNER WITHOUT PERMISSION IN WRITING OF HON YUAN PRECISION IND. CO., LTD.

| | |
|--------------------|----------------------------------|
| Q'TY | |
| NAME(INTENDED USE) | HON YUAN |
| TACT SWITCH | HON YUAN PRECISION IND. CO.,LTD. |
| | SHENZHEN, CHINA, R.O.C. |
| TITLE: | PRODUCT DRAWING |
| APPD: | ZO 2013/06/29 |
| CHKD: | M.H.LI 2013/06/29 |
| DR.Y.Y.Chen | 2013/06/29 |
| DWG NO.: | 1TS005A |



X-ON Electronics

Largest Supplier of Electrical and Electronic Components

Click to view similar products for [Tactile Switches](#) category:

Click to view products by [HYP](#) manufacturer:

Other Similar products are found below :

[5GTH92001](#) [5GTH9202242](#) [1-1977120-4](#) [ADTSA62NV](#) [ADTSA62RV](#) [B3F-3123](#) [1977177-8](#) [1977266-1](#) [ADTSA63NV](#) [ADTSM21NSVTR](#)
[ADTSM25RVTR](#) [ADTSM32NVTR](#) [ADTSMW64RV](#) [FSMRA4JHA04](#) [GS4.70F300QP](#) [3ESH9R](#) [KSC241J SP DELTA LFS](#) [3FTL600RAS](#)
[3FTL640RAS](#) [Y96K132V0FPLFS](#) [5GSH92001](#) [5GTH9658222](#) [ADTSM31NVTR](#) [2-1977120-7](#) [TSJW-5.2-260-TR](#) [KMT011MNGJLHS](#)
[ADTSG648NV](#) [ADTSM62KSVTR](#) [ADTSM648NV](#) [95C06E3RAT](#) [3ATH9Q](#) [FSM4JSMLXTR](#) [FSM4JSMXL](#) [FSMRA8JHA04](#) [HARS0073](#)
[Y97HS12A5RAFP](#) [Y97BT23B2HAFP](#) [Y33R411N9FPLFT](#) [Y31C01402FPLFS](#) [PTS645SK50SMTR92](#) [ADTSM32NVB](#) [KMS233GPWTLFG](#)
[Y78B42324FP](#) [Y33R21116FPLFT](#) [Y31B43131FPLFG](#) [Y78B64124FP](#) [Y71243251FP](#) [Y33R31119FPLFT](#) [Y97HS12A5TAFP](#)
[PTS638SK25SMTR2LFS](#)