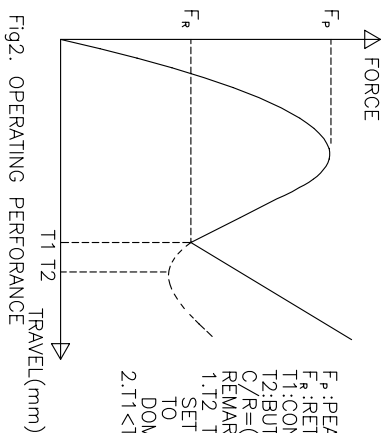
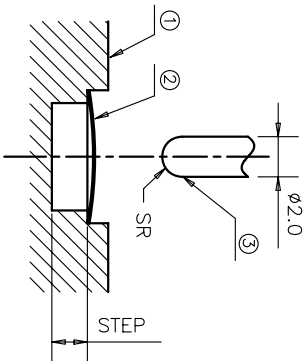

Fig1. MEASURING METHOD



NOTES:  
 1. ALL THE OPERATING PERFORMANCE SPEC. IN BELLOW TABLE SHOULD BE MET. THE MEASURE METHOD IS SHOWN AS Fig.1.  
 OPERATE THE DOME 10 TIMES BEFORE MEASURING.

REV	ECN NO.	APPD
A	HC060009	ZO
B	HC100097	ZO
C	HC150011	ZO

F<sub>p</sub>: PEAK FORCE  
 F<sub>r</sub>: RETURN FORCE  
 T1: CONTACT POINT  
 T2: BUTTON POINT  
 C/R=(F<sub>p</sub>-F<sub>r</sub>)/F<sub>p</sub>\*100%  
 REMARK:  
 1. T2 TESTED WHEN THE SETP IS DEEP ENOUGH TO NOT CONTACT WITH DOME DURING MEASURING.  
 2. T1 < T2

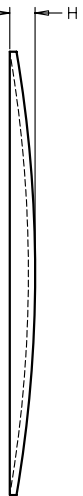

- 1) TEST SPEED : 120 SPM
- 2) TEST FORCE : F<sub>p</sub>
- 3) MATERIAL : ALUMINIUM.
2. OBVIOUS BURR, SCRATCHES, CRACKES IS FORBIDDEN.
3. DIMENSIONS MARKED ∇ SHOULD BE CHECKED BY Q.C. AND P.E.
4. DIMENSIONING SHALL BE INTERPRETED PER ANSI Y14.5M-1982.
5. HARMFUL MATERIAL CONTROL PLEASE FOLLOW DOC."HY-QW-02".
6. PART PERFORMANCE TABLE

PART NAME	D	W	H	P.F.(gf)	C/R(%)
610-5***-***	∅5 ±0.05	3.7±0.05	0.25±0.05	CP±15	C/R±10
610-C***-***	∅4.5 ±0.05	3.3±0.05	0.22±0.05	CP±15	C/R±10
610-4***-***	∅4 ±0.05	2.8±0.05	0.2±0.05	CP±15	C/R±10
610-F***-***	∅2.4 ±0.05	2.2±0.05	0.15±0.05	CP±15	C/R±10
610-D***-***	∅2.2 ±0.05	1.6±0.05	0.13±0.05	CP±15	C/R±10
610-2***-***	∅2 ±0.05	1.5±0.05	0.12±0.05	CP±15	C/R±10

TYPE:	DIMPLE:	D:	C/R:	STEP:	MATERIAL:	CP:
□ 1	0	2=∅2.0mm	0=60%	0=0.00mm	9=SUS	060=060gf
□ 3	1	3=∅3.0mm	1=65%	1=0.01mm	0=Ni-SUS	080=080gf
□ 4	2	4=∅4.0mm	2=55%	2=0.02mm	S=AG-SUS	100=100gf
□ 5	3	5=∅5.0mm	3=45%	3=0.03mm	1=PB	130=130gf
□ B	4	6=∅6.0mm	4=35%	4=0.04mm	2=BECU	160=160gf
□ N	5	A=∅2.5mm	5=25%	5=0.05mm		180=180gf
□ D	6	B=∅3.5mm	6=15%	6=0.06mm		200=200gf
□ G		C=∅4.5mm		7=0.07mm		250=250gf
□ N		D=∅2.3mm		8=0.08mm		
□ D		E=∅2.2mm		9=0.09mm		
□ M		F=∅2.4mm		A=0.10mm		
□ E		G=∅2.7mm				
		H=∅2.8mm				
		J=∅2.9mm				
		K=∅2.85mm				
		L=∅2.92mm				

X. ± 0.2	X. ± 0.1	X. ± 0.05	X. ± 0.03	UNITS	FINISH	Q'TY	NAME(INTENDED USE)	TITLE	DWG NO.:	SCALE	SHEET	REV.
.X ± 0.2	.X ± 0.1	.XX ± 0.05	.XXX ± 0.03	MM			METAL DOME FOR TACT SWITCH	HON YUAN	610-0000-000	1/1	1/5	C
							610-*****	DOME CUSTOMER DRAWING	ZO 6/04/2015			
							APPD: ZO 6/04/2015					
							CHKD: M.H.L: 6/04/2015					
							DR: WP.Lu 6/03/2015					



HON YUAN  
 HON YUAN PRECISION IND. CO.,LTD.  
 SHENZHEN, CHINA, R.O.C.

DOME CUSTOMER DRAWING

DWG NO.: 610-0000-000

SCALE SHEET REV. 1/1 1/5 C

## X-ON Electronics

Largest Supplier of Electrical and Electronic Components

*Click to view similar products for [Tactile Switches](#) category:*

*Click to view products by [HYP](#) manufacturer:*

Other Similar products are found below :

[5GTH92001](#) [5GTH9202242](#) [6407-250V-25273P](#) [ADTSA62NV](#) [ADTSA62RV](#) [B3F-3123](#) [1977177-8](#) [1977266-1](#) [ADTSA63NV](#)  
[ADTSM21NSVTR](#) [ADTSM25RVTR](#) [ADTSM32NVTR](#) [ADTSMW64RV](#) [FSMRA4JHA04](#) [GS4.70F300QP](#) [KSC241J SP DELTA LFS](#)  
[3FTL600RAS](#) [3FTL640RAS](#) [Y96K132V0FPLFS](#) [5GTH9658222](#) [6407-250V-25343P](#) [ADTSM31NVTR](#) [2-1977120-7](#) [TSJW-5.2-260-TR](#)  
[KMT011MNGJLHS](#) [B3WN6002S](#) [70-201.0](#) [ADTSG648NV](#) [ADTSM62KSVTR](#) [ADTSM648NV](#) [95C06E3RAT](#) [5GTH96561](#) [3ATH9Q](#)  
[FSMRA8JHA04](#) [HARS0073](#) [Y33R411N9FPLFT](#) [Y31C01402FPLFS](#) [PTS645SK50SMTR92](#) [ADTSM32NVB](#) [KMS233GPWTLFG](#)  
[Y78B64124FP](#) [Y96D113G0FP LFS](#) [Y33A812C5FP LFT](#) [Y56B2D120FP LFS](#) [PTS645 DVM83-BN125-2 LFS](#) [B3W 1000G](#) [KSC621G OL](#)  
[LFS](#) [B3F 1002C](#) [B3F 0047H](#) [B3F 1000G](#)