

1D31A Series Class D Inductors

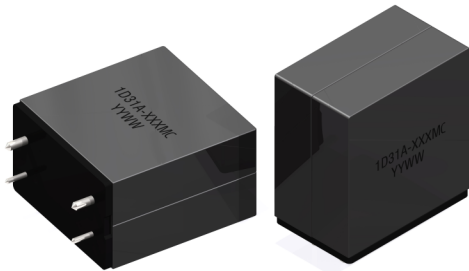

FEATURES

- Small Footprint
- Shielded Design for Low EMI
- Ferrite Material Designed for Audio Applications

APPLICATIONS

- Class D Audio Amplifiers

PACKAGING

Pieces/Tray: 40

Trays/Box: 4

Pieces/Box: 160

Mechanical Drawing

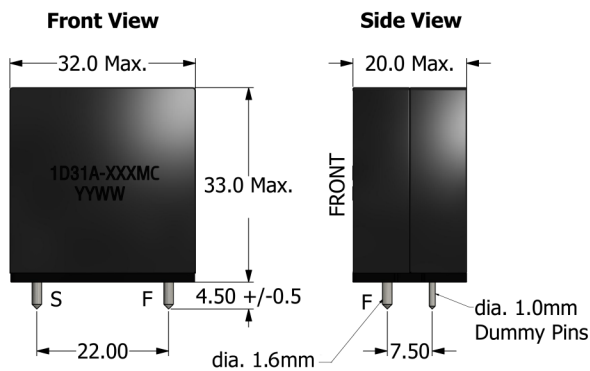

Footprint

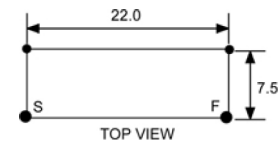

Schematic

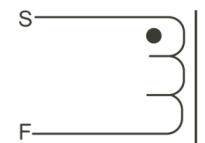

Unit: mm

Electrical Specifications

Part Number	L_s^1 ($\mu\text{H} \pm 20\%$)	DCR (m Ω , Max.)	I_{DC}^4 (A _{DC})	I_{SAT}^5 (A _{DC})
1D31A-100MC	10	6.3	12.5	50.0 min
1D31A-120MC	12	6.3	12.5	50.0 min
1D31A-150MC	15	6.9	12.0	42.0
1D31A-180MC	18	6.3	12.5	32.0
1D31A-220MC	22	6.9	12.0	31.0

NOTES:

1. Tested at 100kHz, 1 Vrms, Series.
2. Electrical specifications at 25°C.
3. Operating range: -40°C to +130°C. This is a combination of ambient plus temperature rise.
4. DC current through the winding to cause a 40°C temperature rise at 25°C ambient.
5. DC current through the winding to cause a 25% (Typ.) drop in inductance.
6. Meets UL 94V-0.

Specifications subject to change without prior notice.



X-ON Electronics

Largest Supplier of Electrical and Electronic Components

Click to view similar products for [Fixed Inductors](#) category:

Click to view products by [ICE](#) manufacturer:

Other Similar products are found below :

[CR32NP-100KC](#) [CR43NP-680KC](#) [CR54NP-820KC](#) [CR54NP-8R5MC](#) [CTX32CT-100](#) [70F224AI](#) [MGDQ4-00004-P](#) [MHL1ECTTP18NJ](#)
[MHL1JCTTD12NJ](#) [PE-51506NL](#) [PE-53601NL](#) [PE-53602NL](#) [PE-53630NL](#) [PE-53824SNLT](#) [PE-62892NL](#) [PE-92100NL](#) [PG0434.801NLT](#)
[PG0936.113NLT](#) [9310-16](#) [PM06-2N7](#) [PM06-39NJ](#) [A01TK](#) [1206CS-471XJ](#) [HC2-2R2TR](#) [HC2LP-R47-R](#) [HC3-2R2-R](#) [1206CS-151XG](#)
[RCH664NP-140L](#) [RCH664NP-4R7M](#) [RCH8011NP-221L](#) [RCP1317NP-332L](#) [RCP1317NP-391L](#) [RCR1010NP-470M](#) [RCR110DNP-331L](#)
[DH2280-4R7M](#) [DS1608C-106](#) [ASPI-4020HI-R10M-T](#) [B10TJ](#) [B82477P4333M](#) [B82498B3101J000](#) [B82498B3680J000](#) [ELJ-RE27NJF2](#)
[1812CS-153XJ](#) [1812CS-183XJ](#) [1812CS-223XJ](#) [1812LS-104XJ](#) [1812LS-105XJ](#) [1812LS-124XJ](#) [1812LS-154XJ](#) [1812LS-223XJ](#)